

C22

## SUBDIVISION REVIEW SHEET

**CASE NO.:** C8-2010-0057.0A

**P.C. DATE:** 6-22-10

**SUBDIVISION NAME:** Dolan Resubdivision; Westfield "A", Resub of the North 175 Ft of Lt 4, Blk 5

**AREA:** .8396

**LOT(S):** 2

**OWNER/APPLICANT:** Michael J. Dolan & Malia M. Lemond **AGENT:** LAND ANSWERS, Inc.  
(Jim Wittliff)

**ADDRESS OF SUBDIVISION:** 2301 Enfield Rd

**GRIDS:** MH24

**COUNTY:**

**WATERSHED:** Johnson Creek

**JURISDICTION:** Full Purpose

**EXISTING ZONING:**

**MRPD:** N/A

**NEIGHBORHOOD PLAN:**

**PROPOSED LAND USE:** Single Family

**ADMINISTRATIVE WAIVERS:** None

**VARIANCES:** None

**SIDEWALKS:** Sidewalks will be provided on both sides of all internal streets and the subdivision side of boundary streets.

**DEPARTMENT COMMENTS:** The request is for approval of the Dolan Resubdivision; Westfield "A", Resub of the North 175 Ft of Lt 4, Blk 5. The proposed plat is composed of 2 lots on .8396 acres.

**STAFF RECOMMENDATION:** The staff recommends disapproval of the plat. This plat does not meet all applicable State and City of Austin LDC requirements.

**PLANNING COMMISSION ACTION:**

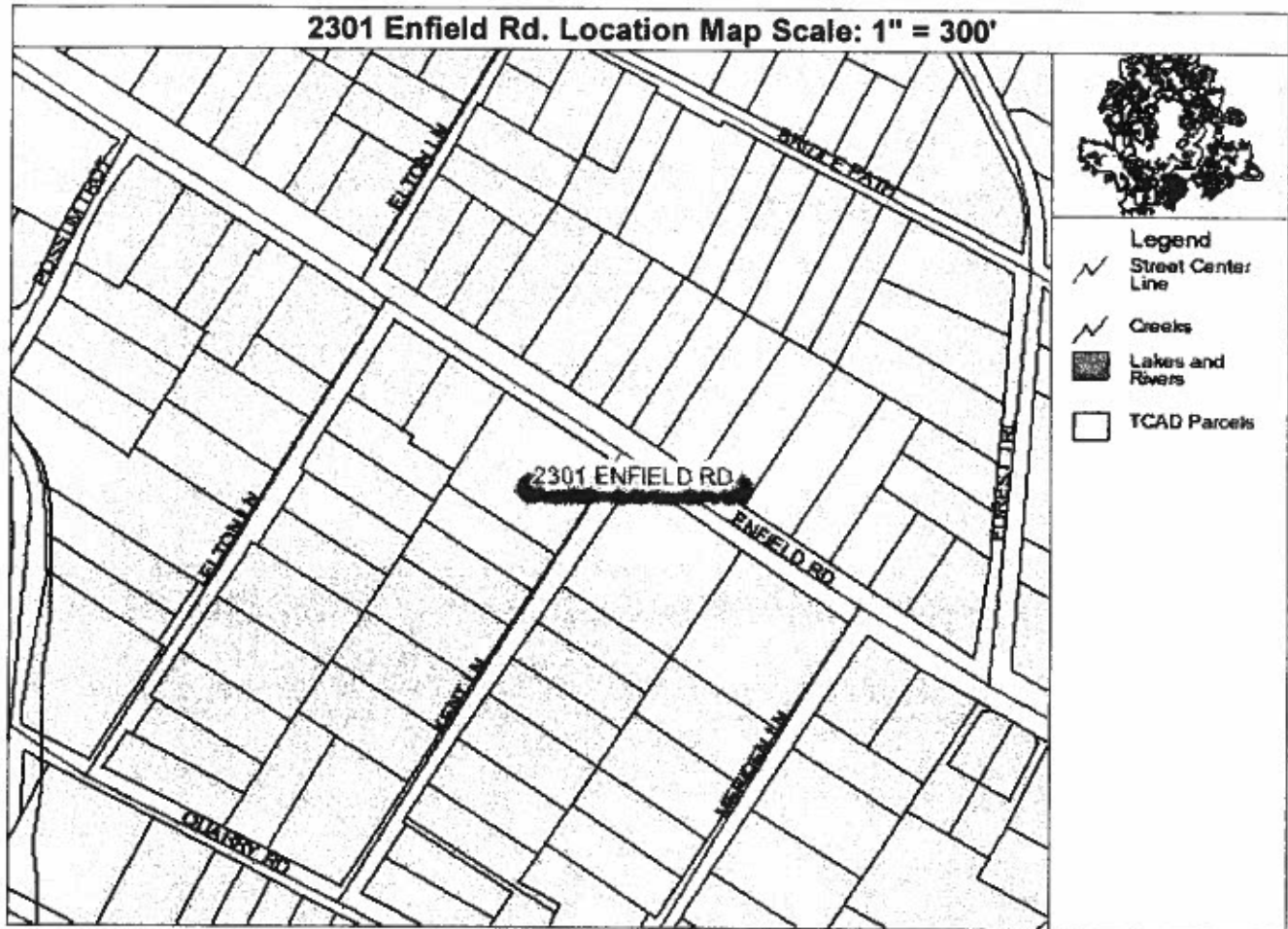

PC # 1044877 - Polan