

C17
1

SUBDIVISION REVIEW SHEET

CASE NO: C8-2010-0081.0A

Z & P DATE: September 7, 2010

SUBDIVISION NAME: AMENDED PLAT OF LOT 15, CASAS GRANDES SUBDIVISION

AREA: 2.76 Acres

LOTS: (21)

APPLICANT: D Martin Homes, LLC
(David Martin)

AGENT: LOC Consultants
(Sergio Lozano)

ADDRESS OF SUBDIVISION: 3115 Sacbe Cove

GRIDS: ME16

COUNTY: Travis

WATERSHED: S. Boggy/Williamson Creek

JURISDICTION: Full Purpose

EXISTING ZONING: SF-4A

PROPOSED LAND USE: Single Family

ADMINISTRATIVE WAIVERS: None

VARIANCES: None

SIDEWALKS

Sidewalks will be provided on both sides of all internal streets and the subdivision side of all boundary streets.

DEPARTMENT COMMENTS:

The request is for disapproval of the final without preliminary plan. The subdivision is composed of (21) lots into (2.76) lots on 3.05 acres. COA will provide water service and wastewater service as well as electric service.

STAFF RECOMMENDATION:

The staff recommends disapproval of the final without preliminary plan. The plat does not meet all applicable State and City of Austin LDC requirements. Staff will continue to work with the applicant to ensure compliance.

ZONING & PLATTING COMMISSION ACTION:

CASE MANAGER:

PHONE:

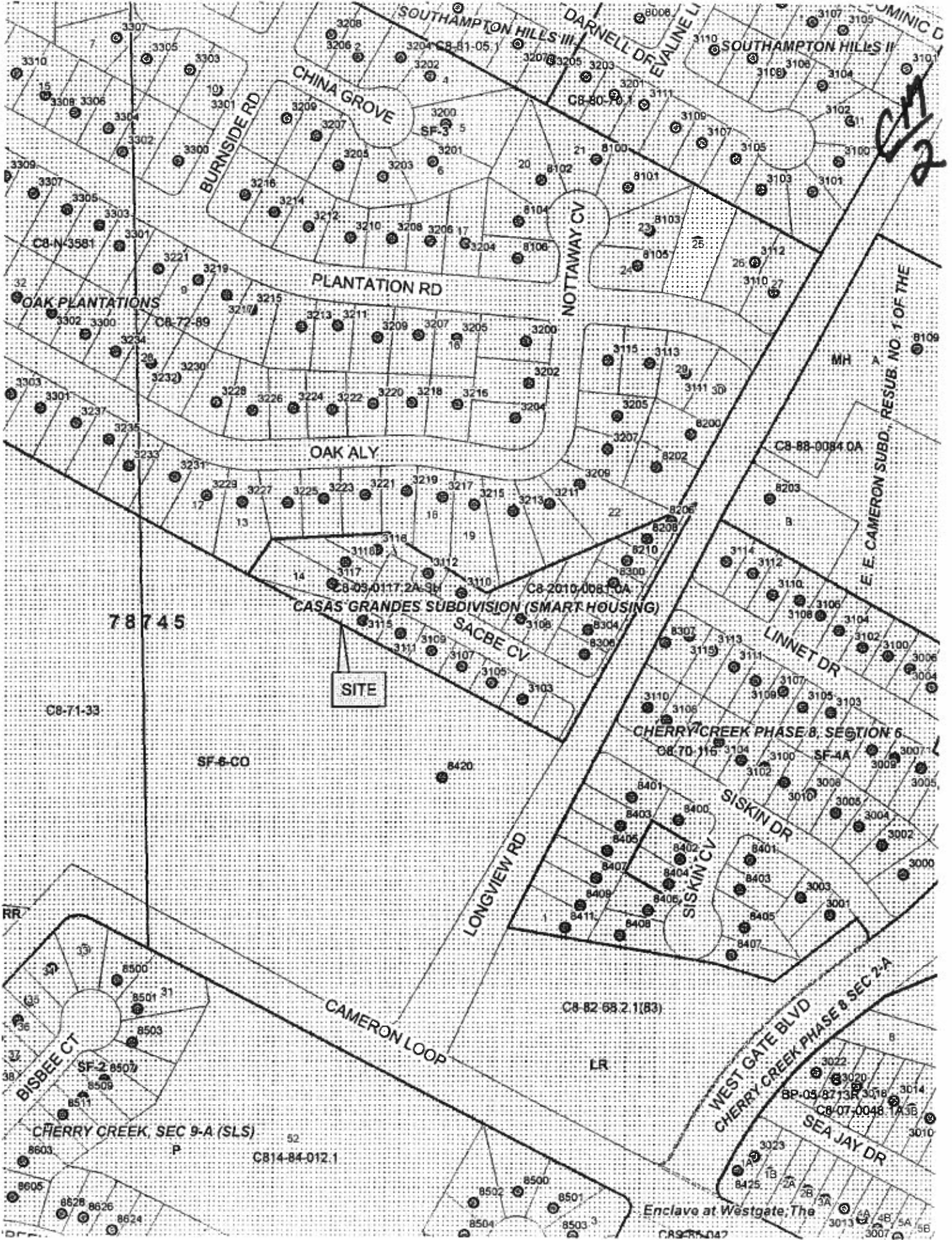

2

SITE

78745

CB-71-33

SF-6-CO

CB-82-68.2.1(83)

LR

CB14-84-012.1

Enclave at Westgate, The

CAS-047

CB-07-0048.1A.3B

BP-03-87.3R

CHERRY CREEK, SEC 9-A (SLS)

SF-2-8507

CHERRY CREEK PHASE 8 SEC 2-A

WEST GATE BLVD

SISKIN DR

CHERRY CREEK PHASE 8, SECTION 6

CB-70-115

LINNET DR

SACBE CV

CASAS GRANDES SUBDIVISION (SMART HOUSING)

CB-09-0117.2A.3A

CB-2010-0081.0A

OAK ALY

PLANTATION RD

OAK PLANTATIONS

CB-77-89

CHINA GROVE

CB-81-05.1

DARNELL DR

SOUTHAMPTON HILLS II

SOUTHAMPTON HILLS III

DOMINIC DR