

PLANT LIST

NO.	SIZE	DESCRIPTION	TAG NO.	SIZE	DESCRIPTION
18N	15N	14N CHINA BERRY	783	4N	4N 3N 3N CREPE MYRTLE-BUSH
9N	16N	MULBERRY	784	7N	5N 4N CREPE MYRTLE
11N	12N	13N CHINA BERRY	785	4N	4N 5N CREPE MYRTLE-BUSH
15N		HACKBERRY	786	14N	SPANISH OAK
9N		CHERRY LAUREL	787	19N	LIVE OAK
9N		MAPLE	788	6N	SPANISH OAK-DEAD
9N		MAPLE	791	2N	CREPE MYRTLE
8N		MAPLE-DEAD	884	12N	6N MULBERRY
9N		MAPLE	885	11N	10N 5N 5N 3N MULBERRY
7N		MAPLE-SICK	886	9N	6N 6N 5N 5N MULBERRY
18N	21N	LIVE OAK	888	8N	SPANISH OAK
4N	6N	MEXICAN PLUM	889	12N	BUR OAK
4N	3N	3N 2N MEXICAN PLUM	900	14N	SPANISH OAK
7N	5N	5N MEXICAN PLUM-SICK	901	8N	7N 6N 6N 3N CHINESE TALLOW
14N		BUR OAK	902	9N	6N 7N 7N 6N 5N CHINESE TALLOW
19N		AMERICAN ELM	903	4N	2N 2N HACKBERRY
35N		CHINESE TALLOW	(NIC)1170	9N	BUR OAK
CREPE MYRTLE-BUSH			(NIC)1171	7N	JUNIPER
CREPE MYRTLE-BUSH			(NIC)1172	7N	JUNIPER
CREPE MYRTLE-BUSH			(NIC)1173	7N	JUNIPER
CREPE MYRTLE-BUSH			(NIC)1174	14N	CEDAR ELM
MOUNTAIN LAUREL-BUSH			(NIC)1175	14N	CEDAR ELM
19N		MULBERRY	(NIC)1176	20N	HACKBERRY
11N		HACKBERRY	(NIC)1180	8N	CHINESE TALLOW
4N	4N	6N 6N REDBUD-DEAD	(NIC)1429	5N	YALPON HOLLY
6N	6N	AMERICAN ELM	(NIC)1431	34N	STADIUMORE
4N		MEXICAN BUCKEYE	(NIC)1432	37N	BUR OAK
8N		BUR OAK	(NIC)1433	30N	TALLOW
2N	3N	3N MEXICAN BUCKEYE	(NIC)1498	49N	COTTONWOOD
4N	3N	3N 2N CREPE MYRTLE-BUSH	(NIC)1700	37N	AMERICAN ELM
4N	3N	3N CREPE MYRTLE-BUSH	(NIC)1701	11N	HACKBERRY
3N	3N	3N 2N CREPE MYRTLE-BUSH	(TBD)1702	6N	BUR OAK
7N	6N	6N 3N CREPE MYRTLE-BUSH	(TBD)1703	24N	HACKBERRY
2N	4N	4N CREPE MYRTLE-BUSH	(TBD)1704	16N	15N HACKBERRY
4N	4N	4N 3N CREPE MYRTLE-BUSH	(NIC)1705	16N	HACKBERRY

NOTE:
 (T) TREE TO BE REMOVED
 (NIC) TREE TO BE TRANSPANTED
 (NIC) NOT IN CONTRACT
 (TBD) TO BE DETERMINED

CONSTRUCTION SEQUENCING:

COORDINATE ALL START-UP WORK WITH OWNER. ASSIGN ENVIRONMENTAL PROJECT MANAGER WHO WILL BE ON-SITE GREATER THAN 90% OF THE TIME DURING CONSTRUCTION ACTIVITY, AND BE RESPONSIBLE FOR ITEMS LISTED UNDER SECTION 1.2.3.3 OF THE ENVIRONMENTAL CRITERIA MANUAL.

INSTALL EROSION CONTROLS AND TREE PROTECTION PER APPROVED PLANS.

SILT AND SEDIMENT SHALL BE REMOVED AFTER ANY SIGNIFICANT RAINFALL OR WHEN THE DEPTH OF SILT/SEDIMENT IS 4" AT ANY ROCK BERM OR SILT FENCE.

ANY DISTURBED AREA IS NOT TO BE WORKED ON FOR MORE THAN 14 DAYS. DISTURBED AREAS NEEDS TO BE STABILIZED BY REVEGETATION, MULCH, TARP OR REVEGETATION MATTING.

THE ENVIRONMENTAL PROJECT MANAGER MUST CONTACT THE CITY OF AUSTIN SUPERVISOR OF ENVIRONMENTAL INSPECTION AT 974-2278 TO ARRANGE A MID-CONSTRUCTION MEETING AT LEAST THREE DAYS IN ADVANCE OF STARTING CONSTRUCTION. EROSION CONTROLS WILL BE REVISED, IF NEEDED, TO COMPLY WITH INSPECTOR'S DIRECTIVES, AND REVISED CONSTRUCTION SCHEDULE RELATIVE TO THE WATER QUALITY PLAN REQUIREMENTS AND EROSION PLAN.

ROUGH OUT WATER QUALITY PONDS (RAIN GARDEN/BIOFILTRATION). THE BIOFILTRATION MEDIA MUST BE DELIVERED TO, OR MIXED AT, THE SITE PRIOR TO THE MID-CONSTRUCTION CONFERENCE. THE MEDIA MUST BE CERTIFIED AS MEETING THE REQUIRED SPECIFICATIONS BY THE PROJECT ENGINEER, OR HIS/HER DESIGNEE, AND APPROVED BY THE CITY INSPECTOR. THE MEDIA MUST BE STORED ON-SITE SEPARATE FROM OTHER MATERIALS, AND COVERED TO PREVENT EROSION OF THE MIXTURE BY RAINFALL AND WINDOFF. THE MEDIA MUST HAVE A PROMINENT TAG AFFIXED THAT READS "BIOFILTRATION MEDIA FOR WATER QUALITY POND".

ENVIRONMENTAL PROJECT MANAGER WILL SCHEDULE A MID-CONSTRUCTION CONFERENCE TO CO-ORDINATE CHANGES IN THE CONSTRUCTION SCHEDULE AND EVALUATE EFFECTIVENESS OF THE EROSION CONTROL PLAN AFTER POSSIBLE CONSTRUCTION ALTERATIONS TO THE SITE. PARTICIPANTS SHALL INCLUDE THE CITY INSPECTOR, PROJECT ENGINEER, GENERAL CONTRACTOR, AND ENVIRONMENTAL PROJECT MANAGER. THE ANTICIPATED COMPLETE AND FINAL CONSTRUCTION SEQUENCE AND INSPECTION SCHEDULE WILL BE COORDINATED WITH THE APPROPRIATE CITY INSPECTOR. A MID-CONSTRUCTION CONFERENCE IS REQUIRED FOR EACH PHASE, WITH THE WATERSHED PROTECTION DEPARTMENT STAFF, WHICH WILL BE COORDINATED BASED ON COMPLETION OF BUILDINGS, DRAINAGE, FACILITIES, WATER QUALITY CONTROLS, AND TEMPORARY EROSION CONTROLS BY PHASE.

BEGIN DEMOLITION AND SITE CLEARING.

CONSTRUCTION AREAS SHALL BE STRIPPED OF ALL VEGETATION, LOOSE TOPSOIL, COBBLES, AND BOULDERS.

ROUGH GRADE SITE IN ACCORDANCE WITH PLANS AND SPECIFICATIONS.

INSTALL UTILITIES IMPROVEMENTS.

CONSTRUCT BUILDING PAD.

OBTAIN CERTIFICATION AND ACCEPTANCE OF BIOFILTRATION MEDIA AND OTHER BIOFILTRATION MEANS.

COMPLETE GRADING, DRAINAGE, WATER QUALITY POND AND PAVING. INSTALLATION OF BASE MATERIALS AND/OR PAVING SHOULD OCCUR AS SOON AS IT IS FEASIBLE TO DO SO.

HYDROMULCH OR SOO ALL DISTURBED AREAS AND CLEAN UP THE SITE.

FINALIZE ALL SITE IMPROVEMENTS.

COMPLETE CONSTRUCTION AND STABILIZE ALL AREAS DRAINING TO THE BIOFILTRATION BASIN. PERMANENT CONTROLS WILL BE CLEANED OUT AND FILTER MEDIA WILL BE INSTALLED AFTER STABILIZATION OF THE SITE. PRE-SOAK THE INPLACE BIOFILTRATION MEDIA AND ADD ADDITIONAL MEDIA AS NEEDED UNTIL 18" DESIGN DEPTH IS ACHIEVED. PROVIDE MATERIAL TAGS FOR THE VEGETATION TO THE CITY INSPECTOR PRIOR TO PLANTING. THE PROJECT ENGINEER MUST BE PRESENT DURING INSTALLATION OF THE BIOFILTRATION MEDIA AND PLANTINGS, AND APPROVED INSTALLATION.

PROJECT ENGINEER AND LANDSCAPE ARCHITECT SHALL SCHEDULE FINAL INSPECTION OF SITE WITH ENVIRONMENTAL INSPECTOR, AND SUBMIT CONCURRENCE LETTERS TO THE CITY OF AUSTIN. REMOVE ANY TEMPORARY EROSION/SEDIMENTATION CONTROLS AND TREE PROTECTION. RESTORE ANY AREAS DISTURBED DURING REMOVAL OF EROSION/SEDIMENTATION CONTROLS. ar 20

FINAL CLEANING OF EROSION AND SEDIMENTATION CONTROLS AND STORM DRAIN STRIPWAYS. THE SILENT PERIOD BEGINS TO THE PROJECT.

CITY OF AUSTIN
 TRACT 4*
 VOL. 081, PG. 199
 D.R.T.C.T.

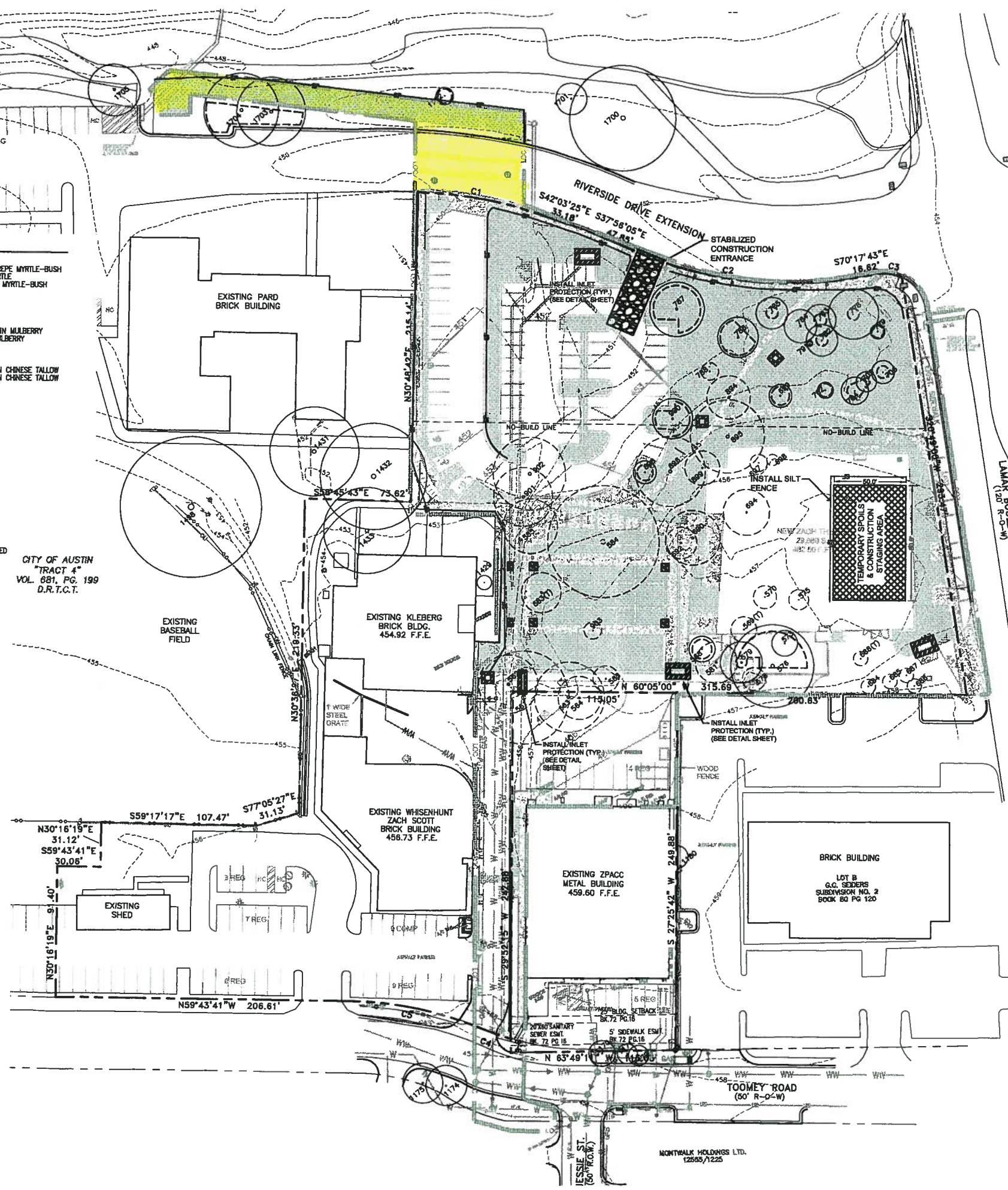

SCALE: 1" = 40'
 0 20 40 60 80

LEGEND:

- PROPERTY LINE
- - - - -758- EXISTING CONTOUR
- - - - -750- PROPOSED CONTOUR
- LDC --- LIMITS OF CONSTRUCTION (137,024 SF)
- SF --- SILT FENCE (1,135 LF)
- [Symbol] STABILIZED CONSTRUCTION ENTRANCE (1 EA)
- [Symbol] INLET PROTECTION (13 EA)
- [Symbol] TEMPORARY SPOILS & CONSTRUCTION STAGING AREA
- [Symbol] AREA OF REVEGETATION (3,860 SQ. YD.)
- (T34) TREE TO BE REMOVED
- (T34) EXISTING TREE WITH TREE FENCING

NOTES:

1. THE EROSION/SEDIMENTATION CONTROL NOTES ARE SHOWN ON THE GENERAL NOTES SHEET.
2. ALL EROSION/SEDIMENTATION CONTROL DETAILS ARE FOUND ON DETAIL SHEET(S).
3. EXISTING UTILITY INFORMATION IS BASED ON THE BEST AVAILABLE DATA AT THE TIME THE PLANS WERE PREPARED. PRIOR TO COMMENCING CONSTRUCTION, THE CONTRACTOR MUST CALL THE ONE CALL CENTER (472-2822) TO OBTAIN THE HORIZONTAL LOCATION OF ALL EXISTING UTILITIES (WHETHER UTILITY IS SHOWN OR NOT).
4. ANY DIRT, MUD, ROCKS, DEBRIS, ETC. THAT IS SPILLED, TRACKED, OR OTHERWISE DEPOSITED ON ANY EXISTING PAVED STREETS SHALL BE CLEANED UP IMMEDIATELY.
5. THE STABILIZED CONSTRUCTION ENTRANCE SHALL BE MAINTAINED IN A CONDITION THAT WILL PREVENT TRACKING OR FLOWING OF SEDIMENT ONTO PUBLIC ROADWAY (REFER TO ECM 1.4.2(N)(5)).
6. THE ENVIRONMENTAL INSPECTOR HAS THE AUTHORITY TO ADD AND/OR MODIFY EROSION/SEDIMENTATION CONTROLS ON SITE TO KEEP THE PROJECT IN COMPLIANCE WITH CITY OF AUSTIN RULES AND REGULATIONS (REFER TO LDC 25-8-183).
7. CONTRACTOR SHALL UTILIZE DUST CONTROL MEASURES DURING SITE CONSTRUCTION SUCH AS IRRIGATION TRUCKS AND MULCHING AS PER ECM 1.4.5 (D), OR DIRECTED BY THE ENVIRONMENTAL INSPECTOR.
8. SILT FENCE INSTALLATION SHALL COMPLY WITH ECM 1.4.2 (G). SILT FENCE TYPE SHALL BE HANES GEO COMPONENTS LSP1 SILT FENCE OR APPROVED EQUAL.
9. THE SWPPP IS TO BE KEPT ON-SITE AND MADE AVAILABLE TO THE ENVIRONMENTAL INSPECTOR UPON REQUEST.

u.e
 CONSULTANTS, INC.

7401 B Hwy 71 West
 Suite 200
 Austin, Texas 78735
 Phone: 512.583.2634
 Fax: 512.583.2601

TBPE Registered Firm No. F-5653

THIS DOCUMENT IS RELEASED FOR THE PURPOSE OF PRELIMINARY REVIEW UNDER THE AUTHORITY OF JOAN DIANE TERNUS, P.E. TEXAS LICENSE NO. 92477, ON AUGUST 28, 2010. THIS DOCUMENT IS NOT TO BE USED FOR BIDDING OR CONSTRUCTION PURPOSES.

ZACH
 ZACHRY GROUP, INC.

THE NEW THEATRE AT ZACH
 202 SOUTH LAMAR BLVD.
 AUSTIN, TX 78704

ANDERSSON-WISE
 Anderson-Wise Architects
 807 Brazos Street, Suite 800
 Austin, Texas 78701
 tel 512.476.5780 fax 512.476.0858

Date: 26-AUG-10
 Drawn: MM
 Checked: JT
 Revisions:

95%
CONSTRUCTION DOCUMENTS

EROSION & SEDIMENTATION CONTROL AND TREE PROTECTION PLAN

SHEET: