

C12
/1

SUBDIVISION REVIEW SHEET

CASE NO.: C8-2011-0104.0A

P.C. DATE: August 23, 2011

SUBDIVISION NAME: Crestview Station, Phase 1, Lot 7; Resubdivision

AREA: 9.164

LOT(S): 90

OWNER/APPLICANT: Trammel Crow Central Texas
Development Inc.
(James Matoushek)

AGENT: Gray-Jansing & Assc.
(James Brewer)

ADDRESS OF SUBDIVISION: 950 Banyon Street

GRIDS: MK28

COUNTY: Travis

WATERSHED: Waller Creek

JURISDICTION: Full Purpose

EXISTING ZONING: N/A

MUD: N/A

NEIGHBORHOOD PLAN: Crestview/Wooten Combined

PROPOSED LAND USE: SF, Park/Open Space, Alley, Row, Private Street

ADMINISTRATIVE WAIVERS: None

VARIANCES: None

SIDEWALKS: Sidewalks will be provided on both sides of all internal streets and the subdivision side of boundary streets.

DEPARTMENT COMMENTS: The request is for approval of the Crestview Station, Phase 1, Lot 7; Resubdivision. The proposed plat is composed of 90 lots on 9.164 acres.

STAFF RECOMMENDATION: The staff recommends disapproval of the plat. This plat does not meet all applicable State and City of Austin LDC requirements.

PLANNING COMMISSION/ZONING AND PLATING ACTION:

Crestview Station, Phase I, Lot 7; C8-2011-0104-0A
RESUB.

C12
2

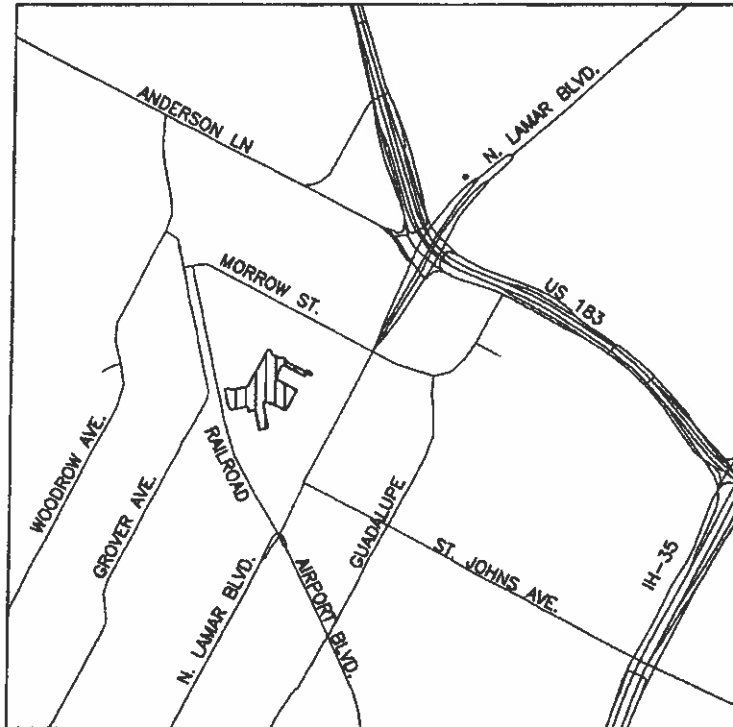

LOCATION MAP
N.T.S.

RESUBDIVISION OF LOT 7, PHASE I
CRESTVIEW STATION SUBDIVISION
AUSTIN, TRAVIS COUNTY, TEXAS



GRAY & JANSING & ASSOCIATES, INC.
Consulting Engineers
8217 Shoal Creek Blvd., Suite 200
Austin, Texas 78757-7592
(512)452-0571 FAX(512)454-9933
TBPB FIRM #2946

#10633914 PC