

C18
1

ZONING CHANGE REVIEW SHEET

CASE: C14-2011-0082 - Southern Walnut Creek Hike & Bike Trail

P.C. DATE: 10/11/2011

ADDRESS: 5707-1/2 Jain Lane

OWNER/APPLICANT: City of Austin Parks and Recreation Department (Gregory Montes)

ZONING FROM: SF-3-NP

TO: P-NP

AREA: 66.36 acres (2,890,641 ft²)

SUMMARY STAFF RECOMMENDATION: Staff recommends approval of the rezoning request to (P-NP) Public – Neighborhood Plan combining district zoning.

DEPARTMENT COMMENTS: The Parks and Recreation Department (PARD) is requesting that this section of the Southern Walnut Creek Trail project be rezoned to a public zoning designation which will facilitate the completion of construction for the 7.3 mile trail from Govalle Park to Johnny Morris Road and Daffan Lane.

EXISTING ZONING AND LAND USES:

	ZONING	LAND USES
<i>Site</i>	SF-3-NP	Park
<i>North</i>	SF-3-NP, CS-NP	Single Family, Vehicle storage and maintenance.
<i>South</i>	LR-MU-NP, SF-NP	Private Secondary Education, Single Family
<i>East</i>	SF-3-NP	Single Family
<i>West</i>	SF-3-NP	Single Family

TIA: Waived

WATERSHED: Boggy Creek

DESIRED DEVELOPMENT ZONE: Yes

CAPITOL VIEW CORRIDOR: No

HILL COUNTRY ROADWAY: No

NEIGHBORHOOD ORGANIZATIONS:

- Austin Neighborhoods Council
- East MLK Combined Neighborhood Association
- Johnston Terrace/Boggy Creek Neighborhood Association
- Edward Joseph Homeowners Association, Inc.
- M.E.T.S.A. Neighborhood Association
- FRS Property Owners Association
- Lower Boggy Creek Neighborhood Association

C18
1/2

BASIS FOR RECOMMENDATION

1. *Zoning changes should promote compatibility with adjacent and nearby uses and should not result in detrimental impacts to the neighborhood character.*

The requested rezoning of this section of the Southern Walnut Creek Trail project will facilitate the completion of construction for the 7.3 mile trail from Govalle Park to Johnny Morris Road and Daffan Lane.

EXISTING CONDITIONS

Environmental

The site is not located over the Edwards Aquifer Recharge Zone. The site is located in the Fort Branch, Tannehill Branch, and Boggy Creek Watersheds of the Colorado River Basin, which are classified as Urban Watersheds by Chapter 25-8 of the City's Land Development Code. It is in the Desired Development Zone.

Impervious cover is not limited in this watershed class; therefore the zoning district impervious cover limits will apply.

This site is required to provide on-site structural water quality controls (or payment in lieu of) for all development and/or redevelopment when 5,000 s.f. cumulative is exceeded, and detention for the two-year storm. At this time, no information has been provided as to whether this property has any pre-existing approvals which would preempt current water quality or Code requirements.

According to flood plain maps, there is a flood plain within the project area.

Numerous trees will likely be impacted with a proposed development associated with this rezoning case. Please be aware that an approved rezoning status does not eliminate a proposed development's requirements to meet the intent of the tree ordinances. If further explanation or specificity is needed, please contact the City Arborist at 974-1876. At this time, site specific information is unavailable regarding other vegetation, areas of steep slope, or other environmental features such as bluffs, springs, canyon rimrock, caves, sinkholes, and wetlands.

Standard landscaping and tree protection will be required in accordance with LDC 25-2 and 25-8 for all development and/or redevelopment.

Water and Wastewater

If the landowner intends to serve the site with City of Austin water and wastewater utilities, the landowner, at own expense will be responsible for providing the water and wastewater utility improvements, offsite main extensions, system upgrades, utility relocations and or abandonments required. The water and wastewater plan must be in accordance with the City of Austin utility design criteria. The water and wastewater utility plan must be reviewed and approved by the Austin Water Utility. All water and wastewater construction must be inspected by the City of Austin. The landowner must pay the City inspection fee with the utility construction. The landowner must pay the tap and impact fee once the landowner makes an application for a City of Austin water and wastewater utility tap permit.

C18
3

Stormwater Detention

At the time a final subdivision plat, subdivision construction plans, or site plan is submitted, the developer must demonstrate that the proposed development will not result in additional identifiable flooding of other property. Any increase in stormwater runoff will be mitigated through on-site stormwater detention ponds, or participation in the City of Austin Regional Stormwater Management Program if available.

Transportation:

Existing Street Characteristics:

Name	ROW	Pavement	Classification	Daily Traffic
Jain Lane	Varies	30'	Collector	Not Available
Ed Bluestein Boulevard (US 183)	Varies	2@33'	Arterial	56,000 (TxDOT, 2009)
Gardner Cove	60'	37'	Local	Not Available

No additional right-of-way is needed at this time.

The traffic impact analysis for this site was waived because this is a City of Austin initiated project.

There are existing sidewalks along Jain Lane.

There are no existing sidewalks along Gardner Cove and Ed Bluestein Boulevard (US 183).

According to the Austin 2009 Bicycle Plan Update approved by Austin City Council in June, 2009, bicycle facilities are existing and/or recommended along the adjoining streets as follows:

Street Name	Existing Bicycle Facilities	Recommended Bicycle Facilities
Jain Lane	None	None
Ed Bluestein Boulevard (US 183)	Wide Shoulder	Wide Shoulder
Gardner Cove	None	None

Capital Metro bus service (route no. 17) is available along Gardner Road at Jain Lane.

Site Plan:

Any new development is subject to Subchapter E: Design Standards and Mixed Use. Additional comments will be made when the site plan is submitted.

There is a site plan currently under review for this property (SPC-2010-0367C) which provides for approximately 7 miles of a hike and bike trail, with parking and other associated improvement.

The site is subject to compatibility standards. Along all property lines adjacent to single family, the following standards will apply with any future development:

- No structure may be built within 25 feet of the property line.

C18/4

- No structure in excess of two stories or 30 feet in height may be constructed within 50 feet of the property line.
- No structure in excess of three stories or 40 feet in height may be constructed within 100 feet of the property line.
- No parking or driveways are allowed within 25 feet of the property line.
- A landscape area is required along the property line. In addition, a fence, berm, or dense vegetation must be provided to screen adjoining properties from views of parking, mechanical equipment, storage, and refuse collection.
- An intensive recreational use, including a swimming pool, tennis court, ball court, or playground, may not be constructed 50 feet or less from adjoining property used or zoned as SF-5 or more restrictive. [Sec. 25-2-1067(F)]
- If a community recreation use is a conditional use, baseball, softball, and football fields and other similar outdoor athletic fields must be at least 300 feet from an SF-5 or more restrictive zoning district. [Sec. 25-2-837(E)]
- Additional design regulations will be enforced at the time a site plan is submitted.

Additional design regulations will be enforced at the time a site plan is submitted.

CITY COUNCIL DATE: 11/3/11

ACTION:

ORDINANCE READINGS: 1st

2nd

3rd

ORDINANCE NUMBER:

CASE MANAGER: Stephen Rye

PHONE: 974-7604
stephen.rye@austintexas.gov

Sirwaitis, Sherri

C18
/5

From: Nasib Naser [Nasib.Naser@synopsys.com]
Sent: Tuesday, October 04, 2011 3:07 PM
To: Sirwaitis, Sherri
Cc: nasib@synopsys.com; Deyab Oweis; Almazan, Joe
Subject: Regarding zoning case - C14-20110111

To Zoning and platting commissioner Betty Baker – regarding zoning case – C14-20110111.

I am requesting a postponement for this case until Oct18th to look into a transportation issue that was brought to my attention today.

Many thanks and regards,
Nasib Naser

10/4/2011

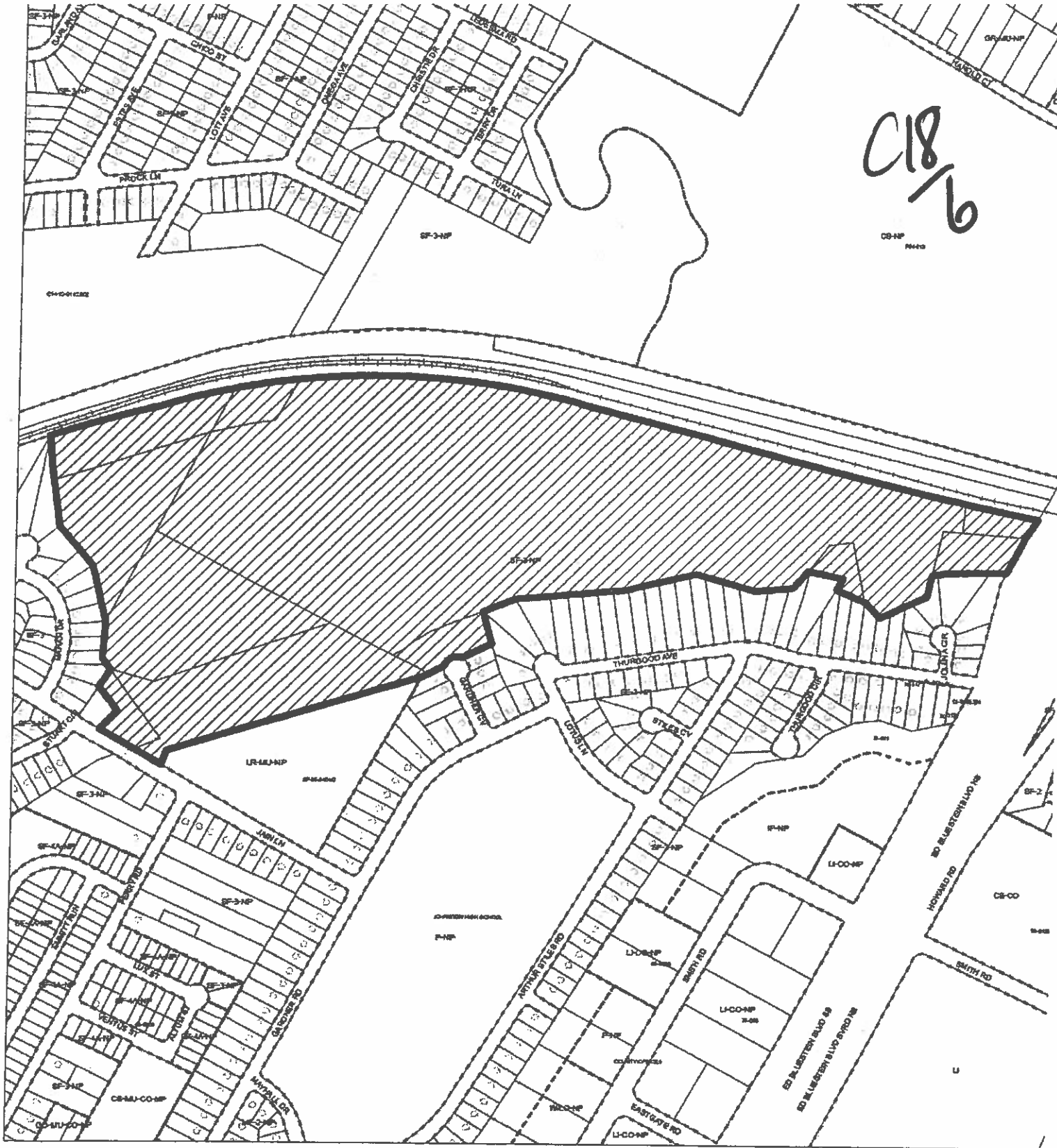

C18
/6

ZONING

- N
- SUBJECT TRACT
- PENDING CASE
- ZONING BOUNDARY

ZONING CASE#: C14-2011-0082
 LOCATION: 5702-1/2 JAIN LN
 SUBJECT AREA: 66.36 ACRES
 GRID: M21, M22
 MANAGER: STEPHEN RYE



1" = 500'

This map has been produced by the Communications Technology Management Dept. on behalf of the Planning Development Review Dept. for the sole purpose of geographic reference. No warranty is made by the City of Austin regarding specific accuracy or completeness.

