

C28  
1

**SUBDIVISION REVIEW SHEET**

**CASE NO.:** C8-2011-0136.0A

**P.C. DATE:** 11-8-11

**SUBDIVISION NAME:** Lifeworks Subdivision, Block A, Lot 1; Resubdivision

**AREA:** 5.889

**LOT(S):** 2

**OWNER/APPLICANT:** Youth and Family Alliance, dba LifeWorks **AGENT:** Bury & Partners  
(Susan McDowell) (Alastair Jenkin)

**ADDRESS OF SUBDIVISION:** 835 N PLEASANT VALLEY RD

**GRIDS:** ML22

**COUNTY:**

**WATERSHED:** Boggy Creek

**JURISDICTION:** Full Purpose

**EXISTING ZONING:**

**MUD:** N/A

**NEIGHBORHOOD PLAN:**

**PROPOSED LAND USE:** OFC/MF

**ADMINISTRATIVE WAIVERS:** None

**VARIANCES:** None

**SIDEWALKS:** Sidewalks will be provided on both sides of all internal streets and the subdivision side of boundary streets.

**DEPARTMENT COMMENTS:** The request is for approval of the Lifeworks Subdivision, Block A, Lot 1; Resubdivision. The proposed plat is composed of 2 lots on 5.889 acres.

**STAFF RECOMMENDATION:** The staff recommends disapproval of the plat. This plat does not meet all applicable State and City of Austin LDC requirements.

**PLANNING COMMISSION ACTION:**

# 10663481

PC

C28  
2

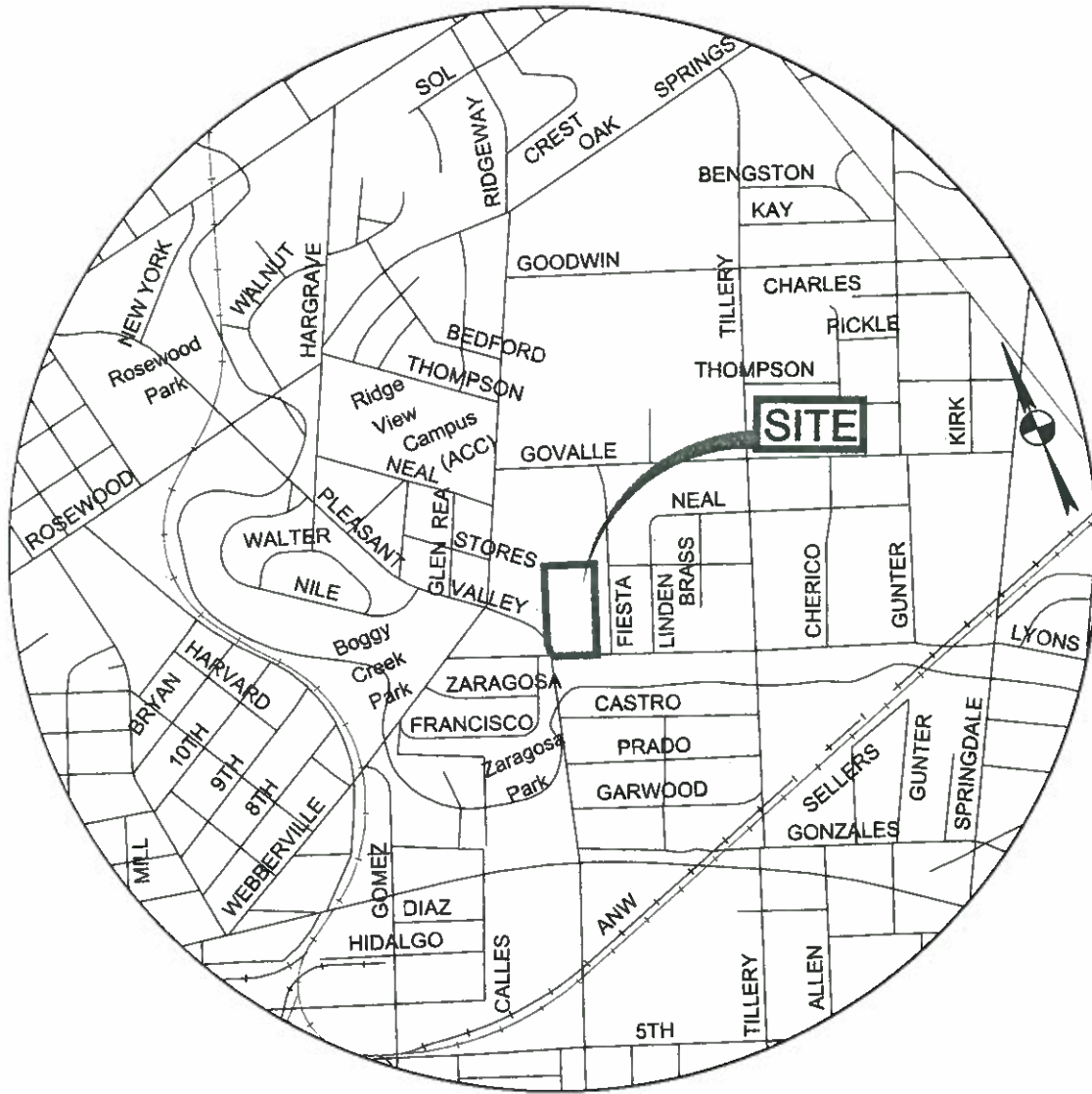

SITE LOCATION MAP

**Bury+Partners**  
 ENGINEERING SOLUTIONS  
 221 West Sixth Street, Suite 600  
 Austin, Texas 78701  
 Tel. (512)328-0011 Fax (512)328-0325  
 TPE Registration Number F1048  
 Bury+Partners, Inc. ©Copyright 2010