

C12  
/1

**SUBDIVISION REVIEW SHEET**

**CASE NO.:** C8-2011-0152.0A

**Z.A.P. DATE:** December 20, 2011

**SUBDIVISION NAME:** Triangle-Tract 5

**AREA:** 1.718

**LOT(S):** 1

**OWNER/APPLICANT:** State of Texas  
(Hal Croft)

**AGENT:** Bury + Partners, Inc.  
(Paulo Misi)

**ADDRESS OF SUBDIVISION:** 4527-1/2 N. Lamar Blvd.

**GRIDS:** MJ26

**COUNTY:** Travis

**WATERSHED:** Waller Creek

**JURISDICTION:** Full-Purpose

**EXISTING ZONING:** N/A

**MUD:** N/A

**NEIGHBORHOOD PLAN:** N/A

**PROPOSED LAND USE:** MF

**ADMINISTRATIVE WAIVERS:** None

**VARIANCES:** None

**SIDEWALKS:** Sidewalks will be provided on both sides of all internal streets and the subdivision side of boundary streets.

**DEPARTMENT COMMENTS:** The request is for approval of the Triangle-Tract 5. The proposed plat is composed of 1 lots on 1.718 acres.

**STAFF RECOMMENDATION:** The staff recommends disapproval of the plat. This plat does not meet all applicable State and City of Austin LDC requirements.

**PLANNING COMMISSION / ZONING AND PLATTING ACTION:**

C12  
2

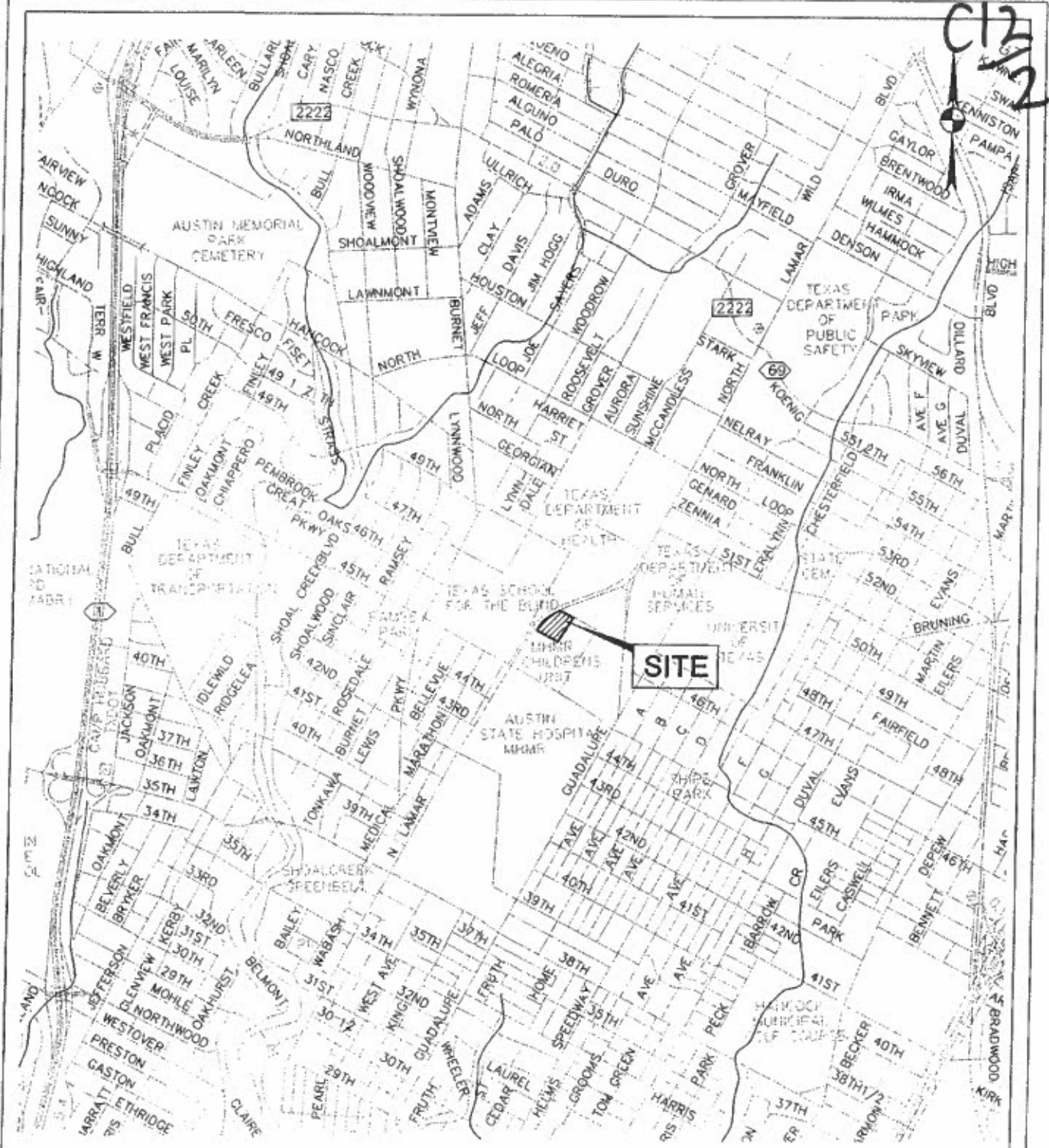

**Bury+Partners**  
ENGINEERING SOLUTIONS  
221 West Sixth Street, Suite 400  
Austin, Texas 78701  
Tel: (512)328-0011 Fax: (512)328-0325  
TBPPE Registration Number P-1046  
Bury+Partners, Inc. © Copyright 2011

**TRIANGLE TRACT**  
**904 WEST 45TH STREET**

**SITE LOCATION EXHIBIT**

**TRIANGLE TRACT**