

C11  
1

**SUBDIVISION REVIEW SHEET**

**CASE NO:** C8J-2012-0013.0A

**ZAP:** February 21, 2012

**SUBDIVISION NAME:** RIDGEVIEW PHASE 1, BLOCK 3. REPLAT OF LOTS 53 & 56,  
BLOCK A, 7, 8, & 9, BLOCK D

**AREA:** 1.447 Acres

**LOTS:** (8)

**APPLICANT:** Ashton Austin Residential LLC  
(Elliot Jones)

**AGENT:** LJA Engineering & Surveying, Inc.  
(Dan Ryan)

**ADDRESS OF SUBDIVISION:** 8500 Vantage Point Dr.

**GRIDS:** MA19

**COUNTY:** Travis

**WATERSHED:** Slaughter/Williamson Creek

**JURISDICTION:** 2 Mile ETJ

**EXISTING ZONING:** N/A

**PROPOSED LAND USE:** Single Family, Public, Amenity Center

**ADMINISTRATIVE WAIVERS:** None

**VARIANCES:** None

**SIDEWALKS**

Sidewalks will be provided on both sides of all internal streets and the subdivision side of all boundary streets.

**DEPARTMENT COMMENTS:**

The request is for disapproval of the final without preliminary plan. The subdivision is composed of (8) lots on 1.447 acres. PEC will provide electric service. COA will provide water service and wastewater service.

**STAFF RECOMMENDATION:**

The staff recommends disapproval of the final without preliminary plan. The plat does not meet all applicable State and City of Austin LDC requirements. Staff will continue to work with the applicant to ensure compliance.

**ZONING AND PLATTING ACTION:**

**CASE MANAGER:**

**PHONE:**

#10714824  
ZAP

C11  
1/2

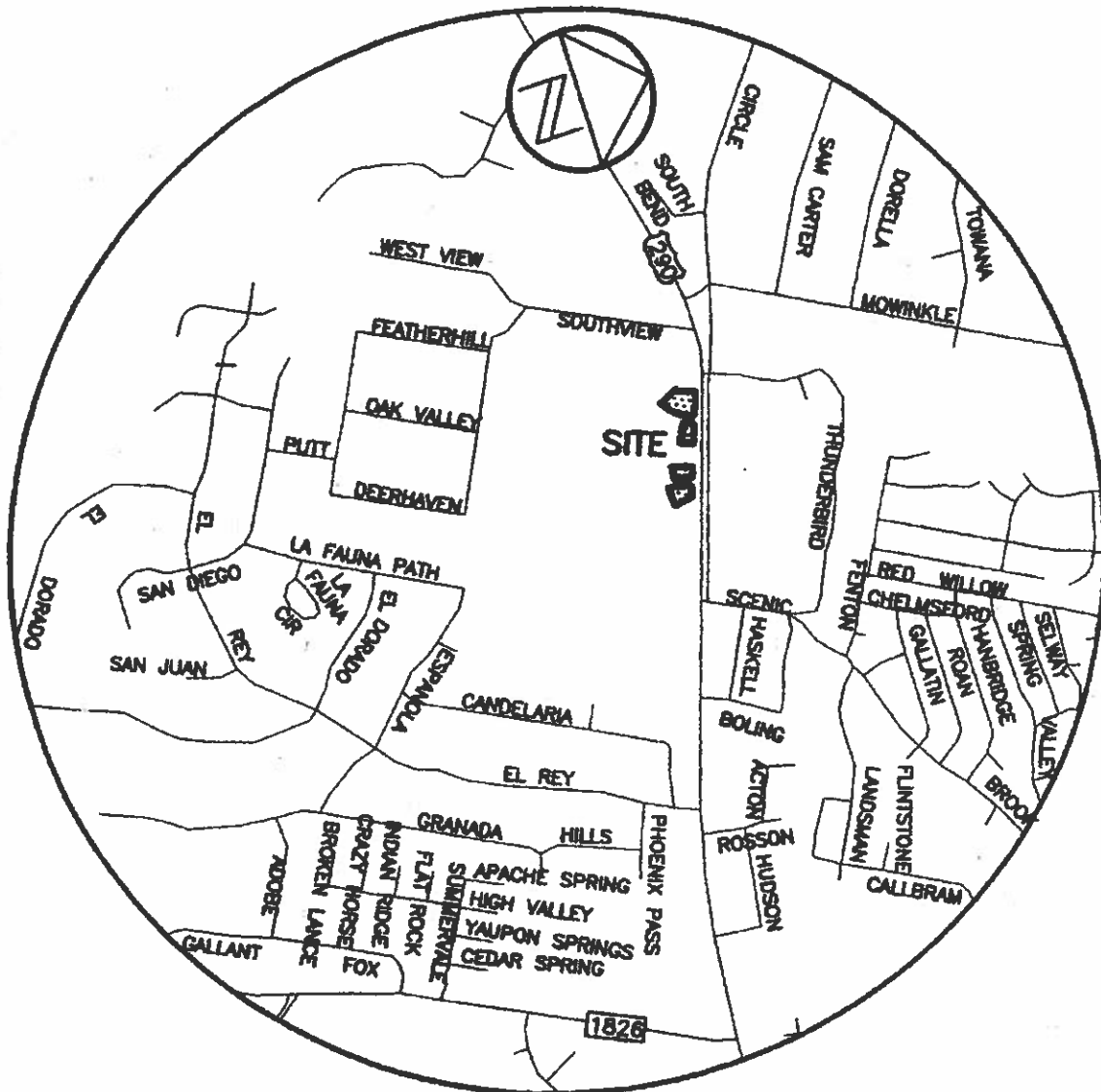

LOCATION MAP  
NOT TO SCALE