

AUSTIN WATER TREATMENT PLANT SITE

SECURITY HARDENING PROJECT

ULLRICH WATER TREATMENT PLANT

OWNER:
 CITY of AUSTIN WATER UTILITY
 ATTN: KATHI FLOWERS
 625 E. 10TH St.
 AUSTIN, TX 78701
 512-972-0213

ENGINEER:
 LCRA
 CARROLL COWAN
 3825 LAKE AUSTIN BLVD.
 AUSTIN, TX 78703

CONTACT:
 SCOTT STEPHENS, CPP
 625 E. 10TH ST.
 AUSTIN, TX 78701
 512-972-0134

SHEET INDEX

SHEET NO.	DESCRIPTION
1.	G-1 COVER SHEET
2.	C-1 SITE PLAN



PROJECT
 LOCATION
 1000 FORREST VIEW DR.
 78746

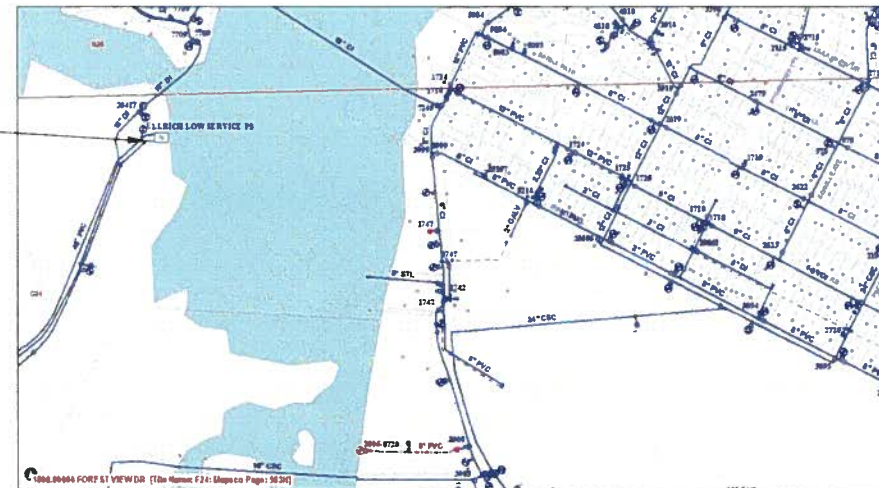

All areas disturbed with the shoreline setback shall be restored in accordance with City of Austin specifications.

WATERSHED STATUS: This site is located in Lake Austin Watershed, is classified as a water supply rural and water supply suburban and shall be developed constructed and maintained in conformance with Chapter 25 of the Land Development Code

SMART GROWTH ZONE: Drinking water protection zone

FLOODPLAIN INFORMATION: This project is within the 100 year flood plain as shown on the F.E.M.A. panel 48453CO445H effective September 26, 2008.

LEGAL DESCRIPTION: ABS 21 SUR 1 SPARKS W ACR 87.2

DEED: Vol. 587, PG. 305

USE: Industrial

Release of this application does not constitute a verification of all data, information and calculations supplied by the applicant. The engineer of record is solely responsible for the completeness, accuracy and adequacy of this submittal, whether of not the application is review for Code compliance by City Engineers.

Site Plan subject to City of Austin Watershed Protection Regulations.

APPROVED BY:

 PARKS & RECREATION BOARD DATE

APPROVED BY:

 FOR DIRECTOR, PLANNING AND DEVELOPMENT REVIEW DEPT. DATE

 PROJECT MANAGER DATE
 DEPARTMENT OF PUBLIC WORKS AND TRANSPORTATION

 SITE PLAN/DEVELOPMENT PERMIT NUMBER DATE

M:\NIGCO\Ullrich\Ullrich-Corr.dwg Feb. 03.2012 6:35am browali



GENERAL NOTES:

1. ALL WORK SHALL OCCUR WITHIN THE LIMITS OF CONSTRUCTION AS SHOWN ON THE PLAN, AND NOT MATERIALS OR EQUIPMENT WILL BE DELIVERED TO THE SITE FROM THE LANDWARD SIDE OF THIS PROJECT.
2. NO SHORELINE IMPROVEMENTS ARE AUTHORIZED WITH THIS SITE PLAN. SHORELINE EDGE TO REMAIN UNCHANGED.

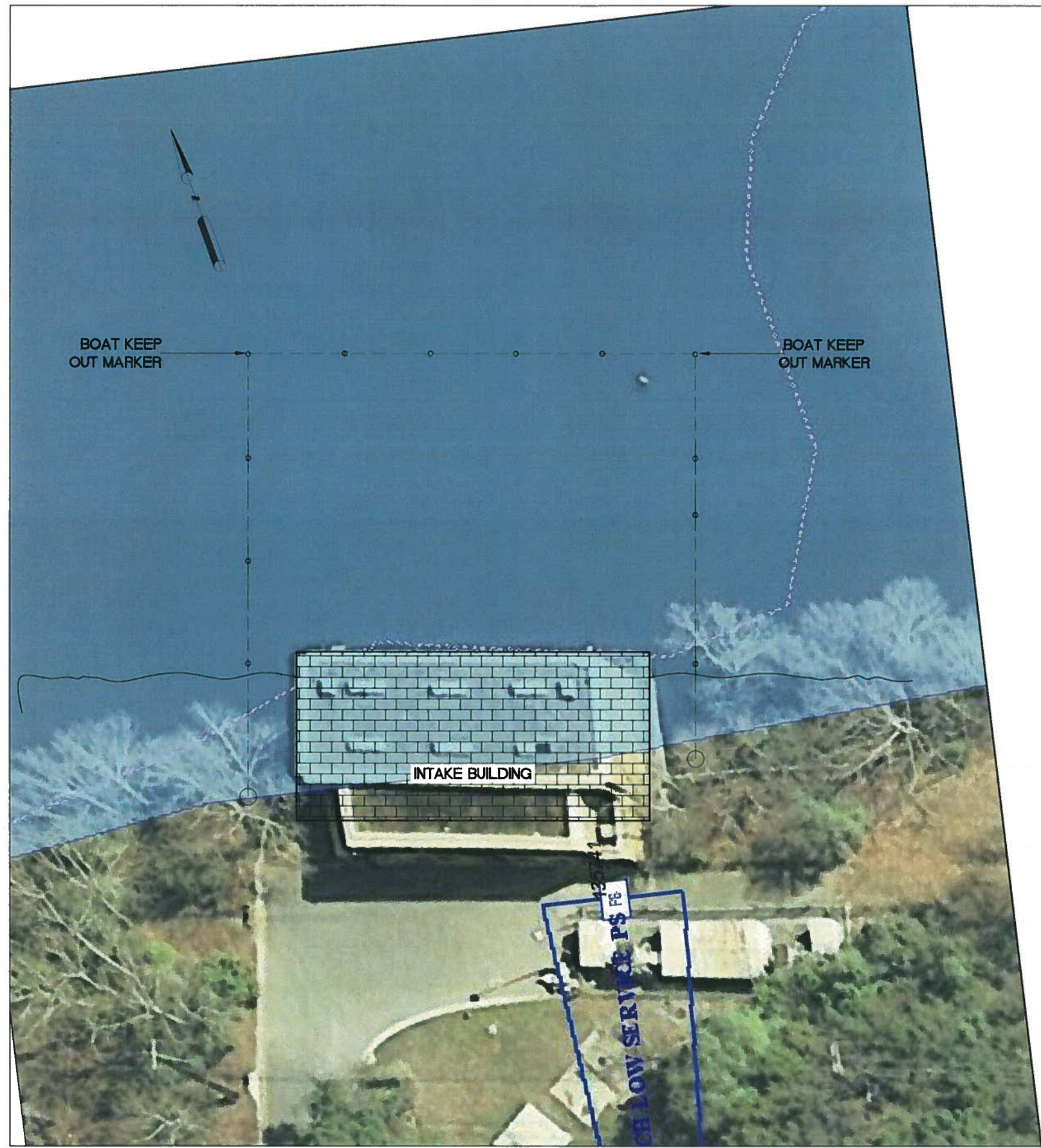

SIDE VIEW
SCALE 1:50

ULRICH INTAKE BUOY PROJECT

ULRICH WATER TREATMENT PLANT

SCALE: AS NOTED
DATE: 2/3/2012
FILE NAME: ULRICH-SITE
SHEET NO. 2 of 2
DRAWN BY: H.K.B.
DESIGNED BY: H.K.B.
CIP NO.: