

C12
1

SUBDIVISION REVIEW SHEET

CASE NO.: C8J-2012-0020.0A

Z.A.P. DATE: March 20, 2012

SUBDIVISION NAME: Wells Branch Center

AREA: 45.58

LOT(S): 14

OWNER/APPLICANT: North IH35 Business Park, LP
(William Schults)

AGENT: Thrower Design
(Neslie Cook)

ADDRESS OF SUBDIVISION: N I35

GRIDS: M37

COUNTY: Travis

WATERSHED: Walnut Creek

JURISDICTION: 2-Mile ETJ

EXISTING ZONING: Vacant

MUD: N/A

NEIGHBORHOOD PLAN: N/A

PROPOSED LAND USE: MF, RET, OFC, IND

ADMINISTRATIVE WAIVERS: None

VARIANCES: None

SIDEWALKS: Sidewalks will be provided on both sides of all internal streets and the subdivision side of boundary streets.

DEPARTMENT COMMENTS: The request is for approval of the Wells Branch Center. The proposed plat is composed of 14 lots on 45.58 acres.

STAFF RECOMMENDATION: The staff recommends disapproval of the plat. This plat does not meet all applicable State and City of Austin LDC requirements.

PLANNING COMMISSION / ZONING AND PLATTING ACTION:

Tracking #

10723237

ZAP

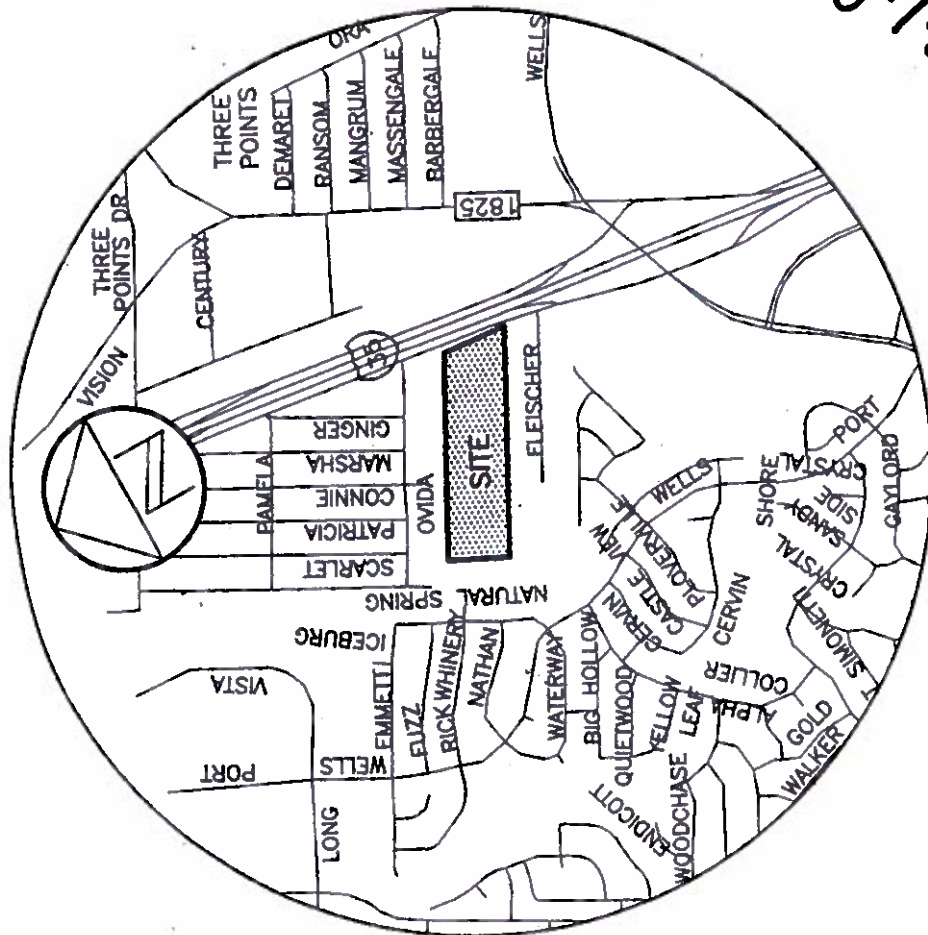

LOCATION MAP
NOT TO SCALE

C12/2