

**HISTORIC LANDMARK COMMISSION  
MARCH 26, 2012  
DEMOLITION AND RELOCATION PERMITS  
HDP-2012-0020  
2600 CANTERBURY STREET**

**PROPOSAL**

---

Demolish a ca. 1937 house.

**ARCHITECTURE**

---

One-story, rectangular-plan side-gabled frame cottage with a central, front-gabled overdoor hood; single 1:1 fenestration.

**RESEARCH**

---

City building permit records and city directories indicate a construction date of 1937 for this house, which was built by Marvin Braswell as a rental unit. The house is listed as vacant in the 1939 city directory, the first time the address appears, then was home to a wide variety of renters, including UT students, carpenters, a shipping clerk, a sheet metal worker, and a tile-setter. With only one exception, the tenants lived in this house for around 2 years each.

**STAFF COMMENTS**

---

The house does not appear in any city survey. The applicant has attempted to contact interested parties in the neighborhood but has not been successful in securing a meeting.

**STAFF RECOMMENDATION**

---

Release the demolition permit. The house has neither the architectural nor the historical significance to warrant individual designation as a historic landmark and is a common type of mid- to late 1930s working class housing.

## LOCATION MAP

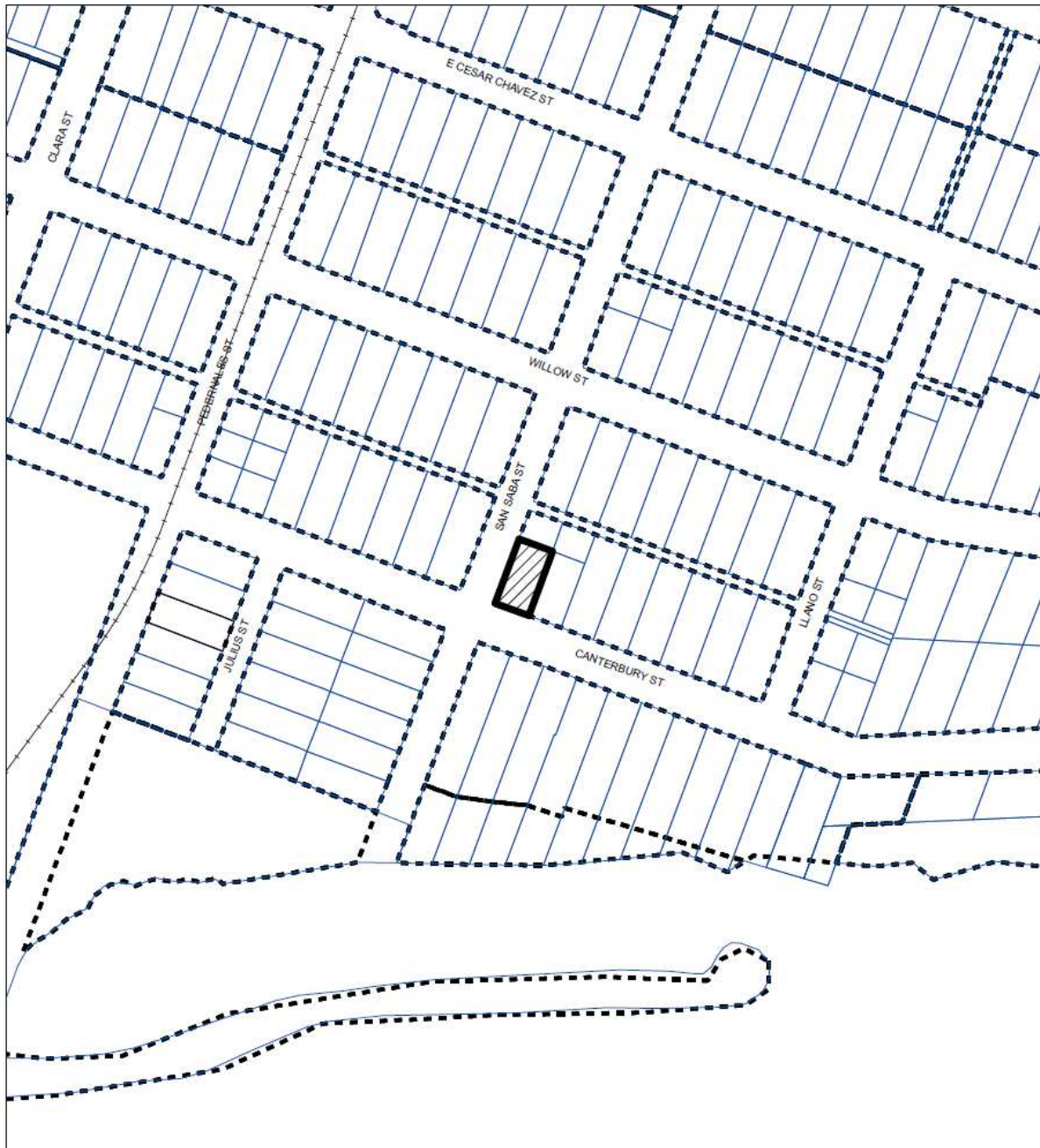

SUBJECT TRACT



ZONING BOUNDARY

CASE#: HDP-12-0020  
LOCATION: 2600 Canterbury Street



This product is for informational purposes and may not have been prepared for or be suitable for legal, engineering, or surveying purposes. It does not represent an on-the-ground survey and represents only the approximate relative location of property boundaries.

This product has been produced by the Planning and Development Review Department for the sole purpose of geographic reference. No warranty is made by the City of Austin regarding specific accuracy or completeness.

2600 Canterbury Street  
ca. 1937



OCCUPANCY HISTORY  
2600 Canterbury Street

City Directory Research, Austin History Center  
By City Historic Preservation Office  
February, 2012

1992	Erasto Jacobo, renter No occupation listed NOTE: The directory indicates that Erasto Jacobo was a new resident at this address.
1985-86	Diann Rios, renter No occupation listed NOTE: The directory indicates that Diann Rios was a new resident at this address.
1981	No return
1975	Hermينو and Irene S. Gomez, renters Truck helper, City Sanitation Division
1970	Brigido and Helinda Lopez, renters No occupation listed
1966	Vacant

1962 Aubrey E. and Sarah J. Jones, renters  
Tile setter

1959 Aubrey E. and Sarah J. Jones, renters  
Tile setter

1955 No return

1952 William G. and Patsy R. Swain, renters  
Sheet metal worker

1949 Edward H. and Margaret L. Fehrenkamp, renters  
Edward: Student, University of Texas  
Margaret: Receptionist, Stanford Furniture

1947 Walter and Florence Moegelin, owners  
Shipping clerk, H.E. Butt Grocery Company

1944-45 Gerhard T. and Selma Schotte, owners  
Carpenter, City Health Department, Typhus Control

1942 Raymond and Ora McKamy, renters  
Carpenter

1941 James E. Sousares, renters  
Student, University of Texas

1939 Vacant

1937 The address is not listed in the directory.

Marvin Braswell 2600 Canterbury St.  
S. 100' of  
18 41 5 16 -  
Riverview Addn.  
frame res.  
202n - 9-25-37  
4

Building permit to Marvin Braswell for the construction of this house (1937)  
NOTE: Marvin Braswell is listed as a contractor in the 1937 city directory – his office was at 1504 South Congress Avenue; he lived at 2230 E. 1<sup>st</sup> Street.



Unless the Plumbing is done in strict accordance with City Ordinances, do not turn on the water.

# PERMIT FOR WATER SERVICE

**AUSTIN, TEXAS**

NO. 6068

M. M. B. Braswell

Address 2600

Plumber Horton

### Size of Tap

1/2 Date

Date \_\_\_\_\_

NW II

### Foreman's Report

Date of Connection 10-18-37

Size of Tap Made  $\frac{3}{4}$ 

Size Service Made 3/4

Size Main Tapped 6"

*From Front Prop. Line to Curb Co*

From S Prop. Line to Curb Co

Location of Meter CURB

Type of Box LOCK

Depth of Main in St. 3'

Depth of Service Line 18"

*From Curb Cock to Tap on Main...*

Checked by Engr. Dept. 10-

INDEXED *U*

INDEXED

VPS

No. Fittings	Size.	
1 Curb Cock	$3\frac{1}{2}$ "	
Elbow		
St. Elbow	$3\frac{1}{2}$ "	
1 Bushing	$3\frac{1}{2}$ "	
1 Pattern $\frac{1}{2}$ Sleeve		
32" Pipe	$3\frac{1}{2}$ " Coplin	
1 Lead Comp. & Coplin Corp.		
1 Wipps & Coplin to man		
Union		
Plug		
1 Iron 5th Main	1955	
Stop		
Box		
Lid		
Values		
Req. No.		2037

Foreman's Signature

Exhibit

Water service permit to M.B [Marvin] Braswell for this house (1937)