

C12
1

SUBDIVISION REVIEW SHEET

CASE NO.: C8-85-086.02.4A

Z.A.P. DATE: 4-3-12

SUBDIVISION NAME: Springfield Section 7 (Resubmittal of C8-85-086.02.1A)

AREA: 32.76

LOT(S): 108

OWNER/APPLICANT: RKS Texas Investments, LP
(Rick Sheldon)

AGENT: Pape-Dawson Engineer, Inc.
(Dustin Goss)

ADDRESS OF SUBDIVISION: MC KINNEY FALLS PKWY

GRIDS: J13, J14

COUNTY:

WATERSHED: Marble/Onion Creek

JURISDICTION: Full Purpose

EXISTING ZONING:

MUD: N/A

NEIGHBORHOOD PLAN:

PROPOSED LAND USE: SF, ROW, PUB

ADMINISTRATIVE WAIVERS: None

VARIANCES: None

SIDEWALKS: Sidewalks will be provided on both sides of all internal streets and the subdivision side of boundary streets.

DEPARTMENT COMMENTS: The request is for approval of the Springfield Section 7 (Resubmittal of C8-85-086.02.1A). The proposed plat is composed of 108 lots on 32.76 acres.

STAFF RECOMMENDATION: The staff recommends disapproval of the plat. This plat does not meet all applicable State and City of Austin LDC requirements.

ZONING AND PLATTING ACTION:

ZAP #16733862

CD
2

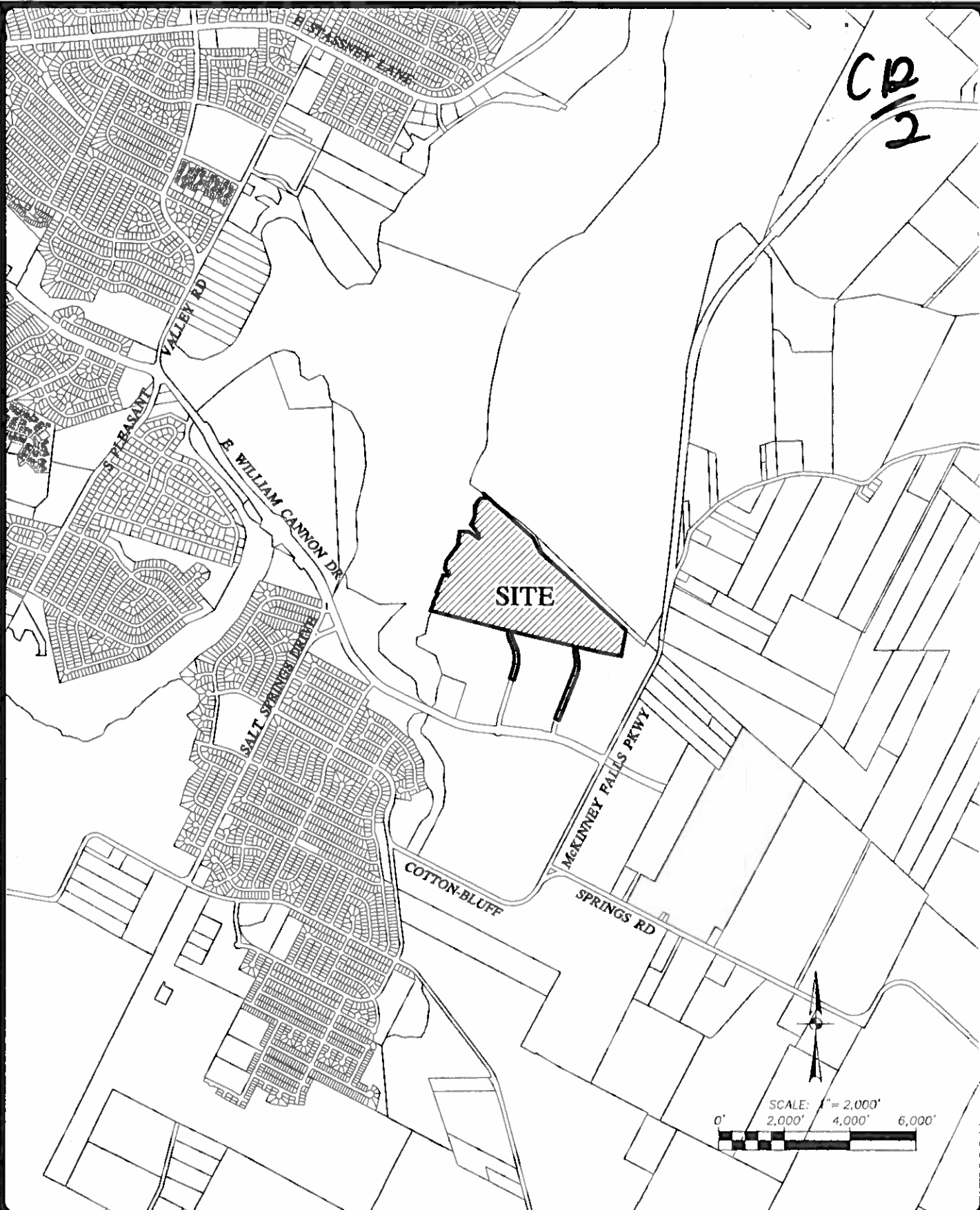

Date: Feb 28, 2011, 2:40pm User ID: D:\Gosha
File: H:\500719\00\1330 Preliminary\Exhibits\EX110222 - Vicinity Map.dwg

JOB NO. 50719-00
DATE 02/22/2011
DESIGNER
CHECKED BRANN JAH
SHEET EXHIBIT 1

**SPRINGFIELD 7, 8 & 9
SUBDIVISION**
EXHIBIT 1: VICINITY MAP

**PAPE-DAWSON
ENGINEERS**

7800 SHOAL CREEK BLVD | AUSTIN, TEXAS 78757 | PHONE: 512.454.8711
SUITE 220 WEST | FAX: 512.459.8867
TEXAS BOARD OF PROFESSIONAL ENGINEERS, FIRM REGISTRATION # 470