

ZONING CHANGE REVIEW SHEET

CASE: C14-2011-0116

P.C. DATE: January 24, 2012

(Coronado Hills Neighborhood Planning Area Rezoning)

AREA: Approximately 353 acres

ADDRESS OF PROPOSED ZONING CHANGE: The boundaries of Coronado Hills Neighborhood Planning Area are:

North – U.S. Highway 183

Southeast – U.S. Highway 290

West – Cameron Road

APPLICANT: City of Austin (City-initiated)

AGENT: Planning and Development Review Department

(Dee Dee Quinnelly/ Greg Dutton/ Wendy Rhoades)

SUMMARY STAFF RECOMMENDATION:

The staff recommends that a Neighborhood Plan Combining District (NPCD) be created covering the entire plan area. Under the proposed **Coronado Hills NPCD**, the following design tools will be applied area-wide: parking placement and impervious cover restrictions, garage placement, and front porch setback. The following special use option is proposed to be applied area-wide: small-lot amnesty. Other special use options proposed to be applied on a parcel specific basis include: residential infill, and neighborhood urban center. The following special use options will be applied in a subdistrict: cottage lot, and urban home. The subdistrict is generally bounded by Coronado Hills Drive and the lot line (includes TCAD parcel 230586) to the north, US Hwy 290 to the south, Creekside Drive to the east, and Cameron Road to the west. Other special use options that could be recommended by Planning Commission and approved by City Council include secondary apartment, corner store, and neighborhood mixed-use building. The following infill options will be applied to Tracts Y, Z, and AA: residential infill. The following infill options will be applied to Tracts W and X: neighborhood urban center. In addition mobile food establishment restrictions are proposed area-wide.

In addition, the staff recommends base district zoning changes for the 14 tracts (78.8 acres) shown on the attached Coronado Hills Neighborhood Planning Area map (Please see Attachment G). The Rezoning Tract Chart lists the property address, current zoning, and proposed zoning (Please see Attachment H). A description of the existing and proposed conditional overlays follows the tract chart (Please see Attachment I).

PLANNING COMMISSION RECOMMENDATION:

January 24, 2012: *APPROVED THE REZONINGS AS RECOMMENDED BY STAFF WITH THE FOLLOWING TRACTS DISCUSSED SEPARATELY: TRACT 108, 113, 114, 115, 116, 117, 118 AND 119.*

FOR TRACTS 108, APPROVED GO-NP;

FOR TRACTS 113, APPROVED GR-NP & CS-NP;

FOR TRACTS 114, APPROVED CS-NP;

FOR TRACTS 115, 116, 117, APPROVED GR-MU-NP;

FOR TRACT 118, APPROVED LR-MU-CO-NP;

FOR TRACT 119, APPROVED LR-MU-NP.

ACTION ALSO INCLUDES RECOMMENDING ADOPTION OF SMALL LOT AMNESTY FOR THE ENTIRE CORONADO HILLS NPCD, RESIDENTIAL INFILL ON TRACTS Y, Z, AND AA; NEIGHBORHOOD URBAN CENTER ON TRACTS W AND X, COTTAGE LOT AND URBAN HOME INFILL AS DESCRIBED IN THE CORONADO HILLS SUBDISTRICT. ACTION ALSO INCLUDES RECOMMENDING ADOPTION FOR THE ENTIRE CORONADO HILLS NPCD FOR THE FOLLOWING DESIGN TOOLS: IMPERVIOUS COVER AND PARKING PLACEMENT RESTRICTIONS, GARAGE PLACEMENT, AND FRONT PORCH SETBACK.

[Please see Motion Sheet for votes taken]

ISSUES:

The owners of Tract 108 (22.21 acres), located at 7424 Highway 290 East (22.213 acres), have requested CS-MU-CO-NP district zoning. The owner's proposed CO would prohibit the following uses: adult-oriented businesses, campground, commercial blood plasma center, community events, drop-off recycling collection facility, hospital services, pawn shop services, transitional housing, and vehicle storage. The property is zoned family residence (SF-3) and is recommended by the Staff, Neighborhood Stakeholders and the Planning Commission for GO-NP district zoning. The owners have met with representatives of the Coronado Hills Contact Team to further discuss their request for CS-MU-CO-NP zoning, and attended their February 27th and March 8th, 2012 meetings. Staff understands that no agreements between the owners and the Contact Team have been reached. A valid petition of 100% has been filed by the property owners in opposition to anything other than CS-MU-CO-NP zoning. Please refer to Attachment O.

Tracts 113 and 114 (2.13 acres and 2.62 acres, respectively) is an existing mobile home park that has GR and CS zoning. These tracts are proposed for MH-NP zoning in order to bring the use into conformance with the zoning code. Some stakeholders, including the Board of Old Town Homeowners Association are opposed to the Staff recommendation of MH-NP zoning and the Planning Commission's recommendation of GR-NP and CS-NP district zoning. Please note that the addition of the -NP combining district to the existing GR and CS zoning base districts would not constitute a petition unless 20 percent of either: 1) all property owners within the Coronado Hills NPA or 2) all property owners within a 200 foot radius outside of the Coronado Hills NPA presented a written petition in objection. The

Board of Old Town Homeowners Association has recommended SF-6-NP district zoning for this property. Please refer to Attachment O.

DEPARTMENT COMMENTS:

The St. John / Coronado Hills Combined Neighborhood Plan was initiated by Council resolution (#20061214-014) in December 2006. The first planning workshop was held on February 2009. Since that workshop, Planning and Development Review Department (PDRD) staff worked with community members to conduct approximately 30 public meetings. These meetings addressed planning issue areas such as: community life (including crime and code enforcement issues), parks, trees and the environment, transportation and infrastructure, and land use and zoning along major corridors in the planning area. Notes from all meetings were posted on the St. John/Coronado Hills Combined Neighborhood Planning Area's (SJCHCNPA) website, and the information gathered from these meetings became the foundation for the recommendations in the SJCHCNPA plan. Throughout the land use and zoning workshops, PDRD staff worked with stakeholders to formulate the zoning recommendations for specific sites in the SJCHCNPA. At the September 15, 2011, Final Open House, staff presented the final draft of the neighborhood plan, a draft Future Land Use Map (FLUM), and the zoning recommendations that had been formulated as part of the two and one-half year planning process in the SJCHCNPA.

Please note that this case is scheduled for the February 9, 2012 City Council Meeting, concurrently with the hearing of the proposed Neighborhood Plan.

LIST OF ATTACHMENTS:

- A. Overview of the St. John/Coronado Hills Combined Neighborhood Plan
- B. GIS Staff Zoning Map for St. John Neighborhood Planning Area
- C. Current Zoning Map
- D. Aerial Map of Plan Area
- E. Current Land Use Map
- F. Future Land Use Map
- G. Map of Recommended Zoning Changes
- H. Rezoning Tract Chart
- I. Existing and Proposed Conditional Overlays
- J. Description of Infill Options and Design Tool Recommendations
- K. Map of Special Use Infill Tracts
- L. Special Use Infill Tract Chart
- M. Map of Coronado Hills Subdistrict
- N. Responses and Comments from Property Owners
- O. Petitions Against Proposed Rezoning
- P. Preliminary Affordability Impact Statement from NHCD

AREA STUDY: St. John / Coronado Hills Combined Neighborhood Planning Area

TIA: Is not required

WATERSHEDS: Buttermilk Branch; **DESIRED DEVELOPMENT ZONE:** Yes
 Fort Branch;
 Little Walnut Creek – Urban

CAPITOL VIEW CORRIDOR: N/A **HILL COUNTRY ROADWAY:** N/A

SCHOOLS:

JJ Pickle Elementary School Webb Middle School Reagan High School

NEIGHBORHOOD ORGANIZATIONS:

Coronado Hills/Creeside Neighborhood Association
 Harris Branch Master Association, Inc.
 Manor ISD Population and Survey Analysts
 Coronado Hills Neighborhood Association
 Old Town Homeowners Association
 Austin Parks Foundation
 Austin Neighborhoods Council
 Austin Independent School District
 Home Builders Association of Greater Austin
 Homeless Neighborhood Association
 League of Bicycling Voters
 Super Duper Neighborhood Objectors and Appealers Organization
 Austin Monorail Project
 Sierra Group, Austin Regional Group
 The Real Estate Council of Austin, Inc.
 Austin Heritage Tree Foundation
 Edward Joseph Development, Ltd.
 SEL Texas

RELATED CASES:

NP-2011-0029 – St. John / Coronado Hills Combined Neighborhood Planning Area
 C14-2011-0115 – St. John Neighborhood Plan Area Rezonings

ABUTTING STREETS:

| Name | ROW | Pavement | Classification | ADT |
|----------------------|---------|----------|----------------|--------|
| Cameron Road | Varies | MAD-6 | Major Arterial | 18,318 |
| Berkman Drive | 60 feet | MNR-4 | Minor Arterial | 5,250 |
| Coronado Hills Drive | 70 feet | 41 feet | Collector | 1,796 |
| Reagan Hill Drive | 60 feet | 40 feet | Collector | 1,412 |

- Cameron Road is classified in the Bicycle Plan as Bike Route No. 59. Coronado Hills Drive and Berkman Drive are classified in the Bicycle Plan as Bike Route No. 57.
- Capital Metro bus service (Routes No. 161, 300, 339, and No. 485) is available along Cameron Road, Coronado Hills Drive, and Berkman Drive.
- There are existing sidewalks along Cameron Road, Coronado Hills Drive, Reagan Hill Drive, and Berkman Drive.

CITY COUNCIL DATE: February 9, 2012

ACTION: Approved a Postponement request by Staff to March 1, 2012 (6-0), Council Member Spelman – off the dais.

March 1, 2012

The motion to postpone action on Tracts 108, 113 and 114 to April 5, 2012, was approved on Council Member Riley's motion, Council Member Spelman's second on a 6-1 vote. Council Member Spelman voted nay.

The public hearing was conducted and the motion to close the public hearing and adopt the first reading of the ordinance for rezonings for the Coronado Hills Neighborhood Plan Combining District as recommended by the Planning Commission including small lot amnesty for the entire Coronado Hills NPCD; residential infill on Tracts Y, Z, and AA; neighborhood urban center on Tracts W and X, cottage lot and urban home infill as described in the Coronado Hills Drive subdistrict, and impervious cover and parking placement restrictions, garage placement and front porch setback as design tools for the entire Coronado Hills NPCD was approved on Mayor Pro Tem Cole's motion, Council Member Riley's second on a 7-0 vote.

April 5, 2012

ORDINANCE READINGS: 1st March 1, 2012

2nd

3rd

ORDINANCE NUMBERS:

ZONING CASE MANAGER: Wendy Rhoades **PHONE:** 974-7719
E-MAIL: wendy.rhoades@austintexas.gov

NEIGHBORHOOD PLANNER: Dee Dee Quinnelly **PHONE:** 974-2976
E-MAIL: kathryn.quinnelly@austintexas.gov

NEIGHBORHOOD PLANNER: Greg Dutton **PHONE:** 974-3509
E-MAIL: greg.dutton@austintexas.gov

NEIGHBORHOOD PLANNER: Paul DiGiuseppe **PHONE:** 974-2865
E-MAIL: paul.digiuseppe@austintexas.gov

STAFF RECOMMENDATION

The staff recommends that a Neighborhood Plan Combining District (NPCD) be created covering the entire plan area. Under the proposed **Coronado Hills NPCD**, the following design tools will be applied area-wide: parking placement and impervious cover restrictions, garage placement, and front porch setback. The following special use option is proposed to be applied area-wide: small-lot amnesty. Other special use options proposed to be applied on a parcel specific basis include: residential infill, and neighborhood urban center. The following special use options will be applied in a subdistrict: cottage lot, and urban home. The subdistrict is generally bounded by Coronado Hills Drive and the lot line (includes TCAD parcel 230586) to the north, US Hwy 290 to the south, Creekside Drive to the east, and Cameron Road to the west. Other special use options that could be recommended by Planning Commission and approved by City Council include secondary apartment, corner store, and neighborhood mixed-use building. The following infill options will be applied to Tracts Y, Z, and AA: residential infill. The following infill options will be applied to Tracts W and X: neighborhood urban center. In addition mobile food establishment restrictions are proposed area-wide.

In addition, the staff recommends base district zoning changes for the 11 tracts (79.2 acres) shown on the attached Coronado Hills Neighborhood Planning Area map (Please see Attachment G). The Rezoning Tract Chart lists the property address, current zoning, and proposed zoning (Please see Attachment H). A description of the existing and proposed conditional overlays follows the tract chart (Please see Attachment I).

BACKGROUND

The Austin City Council passed a resolution on December 14, 2006, which initiated the St. John / Coronado Hills Combined Neighborhood planning process. Following a kickoff meeting on February 28, 2009, staff and residents, property owners, business owners, and representatives of area institutions have been attending meetings and developing the plan for the past twenty-eight months.

The plan's goals, objectives, and action items were developed at numerous St. John / Coronado Hills Combined Neighborhood Planning meetings. The Neighborhood Plan will be considered concurrently with the subject rezoning cases.

The proposed zoning change creates a Neighborhood Plan Combining District (NP) covering the entire area. The purpose of the NP is to allow infill development by implementing a neighborhood plan that has been adopted by Council as an amendment to the City's Comprehensive Plan. The NP modifies the base district of an individual parcel. Within the Coronado Hills Neighborhood Planning Area, the opportunity for the parking placement and impervious cover restrictions, garage placement, and front porch setback *design tools*, and the small-lot amnesty *special use option* is proposed area-wide. On a parcel specific basis, the residential infill and neighborhood urban center *special use options* are proposed to be applied. The cottage lot and urban home *special use options* are proposed to be applied within the Coronado Hill subdistrict, which is generally bounded by Coronado Hills Drive

and the lot line to the north, U.S. Highway 290 to the south, Creekside Drive to the east and Cameron Road to the west. In addition, mobile food establishment restrictions are proposed area-wide.

BASIS FOR LAND USE RECOMMENDATION (ZONING PRINCIPLES)

The staff's basis for recommendation is derived from the goals and objectives for land use in the Coronado Hills NP as described in the St. John / Coronado Hills Combined Neighborhood Plan:

Goal: **Land Use Goal**

- **Promote a land use pattern that benefits everybody in the SJCHCNPA by enhancing neighborhood character, sense of community, pedestrian-friendliness and connectivity to neighborhood-serving amenities.**

Objective L.1: Preserve existing use, character and integrity of residential neighborhoods.

Recommendation 178: Preserve the single-family land use in the established core Single Family neighborhoods in the Planning Area.

Recommendation 179: Preserve the Multi Family land use and PUD land use in the established owner occupied, townhome and condominium neighborhoods in the Planning Area.

Recommendation 180: Consider the use of vegetated buffers and landscaping to provide a buffer between existing residential neighborhoods and the more intense, non-residential land uses.

Recommendation 181: Non-residential uses should not encroach into established neighborhoods in the SJCHCNPA.

Objective L.2: Ensure future housing development compliments (in style and character) existing housing stock.

Recommendation 183: Residential infill development tools should be utilized by developers/property owners to ensure new housing compliments the character and scale of the existing housing stock.

Recommendation 184: Design tools should be utilized by developers/property owners to ensure new housing development strengthens a neighborhood "sense of place".

Objective L.3: Strengthen the community building role Civic land uses play in the SJCHCNPA community.

Recommendation 185: Designate all AISD schools in the SJCHCNPA community as Civic land uses.

Recommendation 186: Designate all large-scale churches and/or places of worship in the SJCHCNPA community as Civic land uses.

Recommendation 187: Designate all parks and open spaces in the SJCHCNPA community as Parks and Open Space land use. **Note:** Further direction for the future vision of parks and open space can be found in the Parks, Trees and Environment chapter.

Recommendation 189: Designate other community uses as Civic land Use.

Recommendation 190: Incorporate pedestrian friendly, mixed use concepts adjacent to Civic uses, where designated, to strengthen walkability and community connectivity.

Objective L.4: Provide adequate transitions and buffers between the intensity of US HWY 183, US HWY 290 and IH 35 and community life in SJCHCNPA.

Recommendation 191: Use Mixed Use land use and Commercial land use to soften the transition between US HWY 183, US HWY 290 and IH 35 and residential uses.

Recommendation 192: Consider the use of vegetated buffers and landscaping to provide a buffer between existing residential neighborhoods and the more intense, commercial uses.

Objective L.5: Increase neighborhood connectivity with a specific focus on the pedestrian environment in SJCHCNPA.

Recommendation 193: While preserving the Residential Cores (see section in plan), use Mixed Use land use to facilitate a more pedestrian friendly development pattern in SJCHCNPA (see St. John/Coronado Hills Combined Neighborhood Planning Area - Future Land Use Map).

Recommendation 194: Designate Cameron Road Corridor as a Core Transit Corridor (CTC) to enhance the pedestrian environment via implementation of design considerations such as wider sidewalks and street trees to name a few.

Objective L.6: Support community oriented business development along major commercial corridors.

Recommendation 195: Use Neighborhood Mixed-Use land use to facilitate community oriented neighborhood scale businesses and services in SJCHCNPA.

Recommendation 196: Use Neighborhood Commercial land use at facilitate community oriented, neighborhood scale businesses and services in SJCHCNPA.

Objective L.7: Maintain and expand affordable housing options in the SJCHCNPA community.

Recommendation 197: Ensure the current Multi Family (i.e. rental housing) stock is maintained through Multi Family land use and/or Mixed Use land use.

Recommendation 199: Maintain affordable housing options in the Coronado Hills NPA by designating Multi Family developments as either Multi Family or Mixed Use land use.

Recommendation 201: Adopt the small lot amnesty Infill Option in the entire Coronado Hills NPA.

Recommendation 202: Adopt the cottage lot and urban home Infill Options for designated areas in the Coronado Hills NPA.

Recommendation 203: Adopt the Residential Infill and Neighborhood Urban Center Infill Options on specific tracts in the SJCHCNPA (Map 7).

EXISTING CONDITIONSExisting Land Use for the Combined Neighborhood Plan area:

| Land Use | Acres and % | St. John NPA | Coronado Hills NPA | SJCHCHNPA |
|----------------------|--------------|--------------|--------------------|---------------|
| Single Family | Acres | 142 | 52.2 | 194.2 |
| | % | 26% | 19% | 17% |
| Multi Family | Acres | 84.9 | 72.9 | 157.9 |
| | % | 16% | 27% | 14% |
| Mobile Home | Acres | .6 | 2.1 | 2.8 |
| | % | .1% | .8% | .2% |
| Commercial | Acres | 139.8 | 24.4 | 164.1 |
| | % | 26% | 9% | 15% |
| Office | Acres | 72.2 | 5.3 | 77.6 |
| | % | 13% | 2% | 7% |
| Industrial | Acres | 7.9 | 4 | 11.9 |
| | % | 2% | 1.5% | 1% |
| Civic | Acres | 61.3 | 67.3 | 128.6 |
| | % | 11% | 25% | 12% |
| Open Space | Acres | 10.6 | 0 | 10.6 |
| | % | 2% | 0% | 1% |
| Undeveloped | Acres | 22.6 | 43.2 | 65.8 |
| | % | 4% | 16% | 6% |
| Total | Acres | 541.9 | 271.4 | 1115.9 |
| | % | 100% | 100% | 100% |

Environmental

The site is not located over the Edwards Aquifer Recharge Zone. The site is located in the Buttermilk Branch, Fort Branch, and Little Walnut Creek Watershed of the Colorado River Basin, which is classified as an Urban Watershed by Chapter 25-8 of the City's Land Development Code. It is in the Desired Development Zone.

Impervious cover is not limited in this watershed class; therefore the zoning district impervious cover limits will apply.

This site is required to provide on-site structural water quality controls (or payment in lieu of) for all development and/or redevelopment when 5,000 s.f. cumulative is exceeded, and detention for the two-year storm. At this time, no information has been provided as to whether this property has any pre-existing approvals which would preempt current water quality or Code requirements.

According to flood plain maps, there is a flood plain within the project area.

Numerous trees will likely be impacted with a proposed development associated with this rezoning case. Please be aware that an approved rezoning status does not eliminate a proposed development's requirements to meet the intent of the tree ordinances. If further explanation or specificity is needed, please contact the City Arborist at 974-1876. At this time, site specific information is unavailable regarding other vegetation, areas of steep slope, or other environmental features such as bluffs, springs, canyon rimrock, caves, sinkholes, and wetlands.

Standard landscaping and tree protection will be required in accordance with LDC 25-2 and 25-8 for all development and/or redevelopment.

Impervious Cover

Impervious cover is not limited in an urban watershed class; therefore the zoning district impervious cover limits listed below apply.

| | |
|--|---|
| MI, Major Industry | 80% |
| LI, Limited Industrial Service | 80 % |
| IP, Industrial Park | 80 % |
| CH, Commercial Highway | 85 % |
| CS, General Commercial Services | 95 % |
| CS-1, Commercial – Liquor Sales | 95 % |
| W/LO, Warehouse Limited Office | 70 % |
| GR, Community Commercial | 90 % |
| LR, Neighborhood Commercial | 80 % |
| CR, Community Recreation | 60 % |
| GO, General Office | 80 % |
| LO, Limited Office | 70 % |
| NO, Neighborhood Office | 60 % |
| MH, Mobile Home Residence | N/A – For site dev't stds., see 25-2-1205/1206 |
| MF-6, Multi-family Residence – Highest Density | 80 % |
| MF-5, Multi-family Residence – High Density | 70 % |
| MF-4, Multi-family Residence – Moderate-High Density | 70 % |
| MF-3, Multi-family Residence – Medium Density | 65 % |
| MF-2, Multi-family Residence – Low Density | 60 % |
| MF-1, Multi-family Residence – Large Lot | 55 % |
| SF-6, Townhouse & Condominium Residence | 55 % |
| SF-5, Urban Family Residence | 55 % |
| SF-4A/4B, Single Family Residence – Small Lot | 65%/60% |
| SF-3, Family Residence | 45 % |
| SF-2, Single Family Residence – Standard Lot | 45 % |
| SF-1, Single Family Residence – Large Lot | 40 % |
| P, Public | varies (refer to the <u>Land Development Code</u>) |

Site Plan/Compatibility Standards

Any new development is subject to Subchapter E. Design Standards and Mixed Use. Additional comments will be made when the site plan is submitted.

Any development which occurs in an SF-6 or less restrictive zoning district which is located 540-feet or less from property in an SF-5 or more restrictive zoning district will be subject to compatibility development regulations. Therefore, the following standards will apply:

- No structure may be built within 25 feet of the property line.
- No structure in excess of two stories or 30 feet in height may be constructed within 50 feet of the property line.
- No structure in excess of three stories or 40 feet in height may be constructed within 100 feet of the property line.
- No parking or driveways are allowed within 25 feet of the property line.
- A landscape area is required along the property line. In addition, a fence, berm, or dense vegetation must be provided to screen adjoining properties from views of parking, mechanical equipment, storage, and refuse collection.
- Additional design regulations will be enforced at the time a site plan is submitted.

Transportation

Additional right-of-way (ROW) necessary for future roadway improvements within the proposed zoning may be required during the subdivision review process or the site plan review process.

Since the rezoning of this area is being initiated by the City of Austin through the neighborhood planning process and does not reflect a specific development proposal, no trip generation calculations are provided on a tract-by-tract basis for any proposed land uses.

A Traffic Impact Analysis (TIA) will be required during the site plan review stage for any proposed land use that would generate over 2,000 vehicle trips per day. Additional ROW, participation in roadway improvements, and/or limitation on development intensity may also be recommended based on review of the TIA.

Water and Wastewater

FYI: The planning area is served by City of Austin water and wastewater utilities. The landowners, at their own expense, will be responsible for providing any water and wastewater utility improvements, offsite main extensions, utility relocations and or abandonments required by the proposed zoning. Water and wastewater utility plans must be reviewed and approved by the Austin Water Utility for compliance with City criteria. All water and wastewater construction must be inspected by the City of Austin. The landowner must pay the City inspection fee with the utility construction. The landowner must pay the tap and impact fee once the landowner makes an application for a City of Austin water and wastewater utility tap permit.

Overview of the St. John/Coronado Hills Combined Neighborhood Plan

Community Life

The Community Life goals, objectives and recommendations articulate a vision for enhancing the qualities that directly effect everyday life in SJCHCNPA. When discussing community life with the SJCHCNPA participants, several themes began to quickly emerge: neighborhood schools, community beautification, code compliance, and crime prevention/public safety. Special attention to these subject areas helps shape the community's approach to envisioning a better standard of living in SJCHCNPA.

Parks, Trees and Environment

The Parks, Trees and Environment chapter articulates the natural environment and recreational needs and desires of the St. John/Coronado Hills community. Emergent themes from the workshops include:

- Increasing parkland in Coronado Hills community
- Adding more amenities in the existing parks
- Encouraging creation of community gardens
- Protecting and enhancing the ecological assets of the community (creeks, watersheds, trees, etc.)

Transportation

The Transportation chapter articulates a vision for enhancing the infrastructure and systems that directly effect traveling in and around SJCHCNPA. To this end, the following outlines a comprehensive approach to maintaining and/or improving the conditions of traveling - whether in a car, riding a bus, walking, pedaling a bicycle or operating some form of motorized transport - in the SJCHCNPA community.

Through stakeholder discussions focused on various modes of transport (walking, biking, taking the bus, driving a car, etc.) several themes emerged. Residents articulated their priority to ensure safety for all modes of transportation and striking a balance between all modes. Residents also expressed concerns to proactively address areas or specific locations in their community where a combination of transportation issues challenges efficient and safe travel. Such areas include, but are not limited to the Cameron Road corridor and Blessing Avenue. Other dominant themes in transportation discussions included improved connectivity and accessibility in the current transportation network.

Land Use

The Land Use chapter articulates the SJCHCNPA stakeholders' vision for how the development and/or preservation of land in their community can enhance the overall quality of life in SJCHCNPA. Specifically, this chapter focuses on how land is preserved, developed or re-developed in the future. The information presented reflects the community dialogue that influenced decisions made on the SJCHCNPA Future Land Use Map (FLUM). The FLUM (Map 6, page 84) is a major component of the land use chapter. Themes include:

- Preservation of existing residential cores
- Enhancing community hubs

- Improving land use and transportation hubs
- Preservation of existing affordable housing

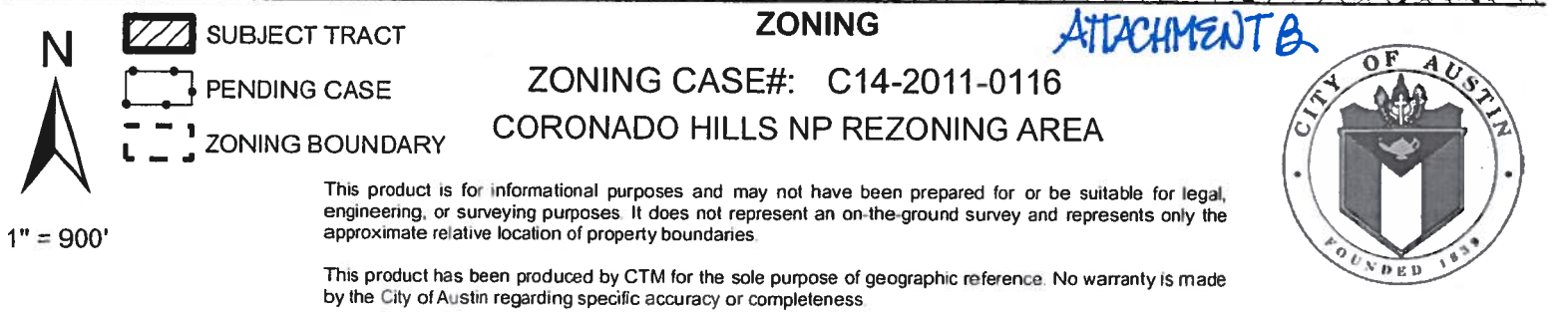



This product is for informational purposes and may not have been prepared for or be suitable for legal, engineering, or surveying purposes. It does not represent an on-the-ground survey and represents only the approximate relative location of property boundaries.

This product has been produced by the Planning and Development Review Department for the sole purpose of geographic reference. No warranty is made by the City of Austin regarding specific accuracy or completeness.

St. John/Coronado Hills Aerial Map

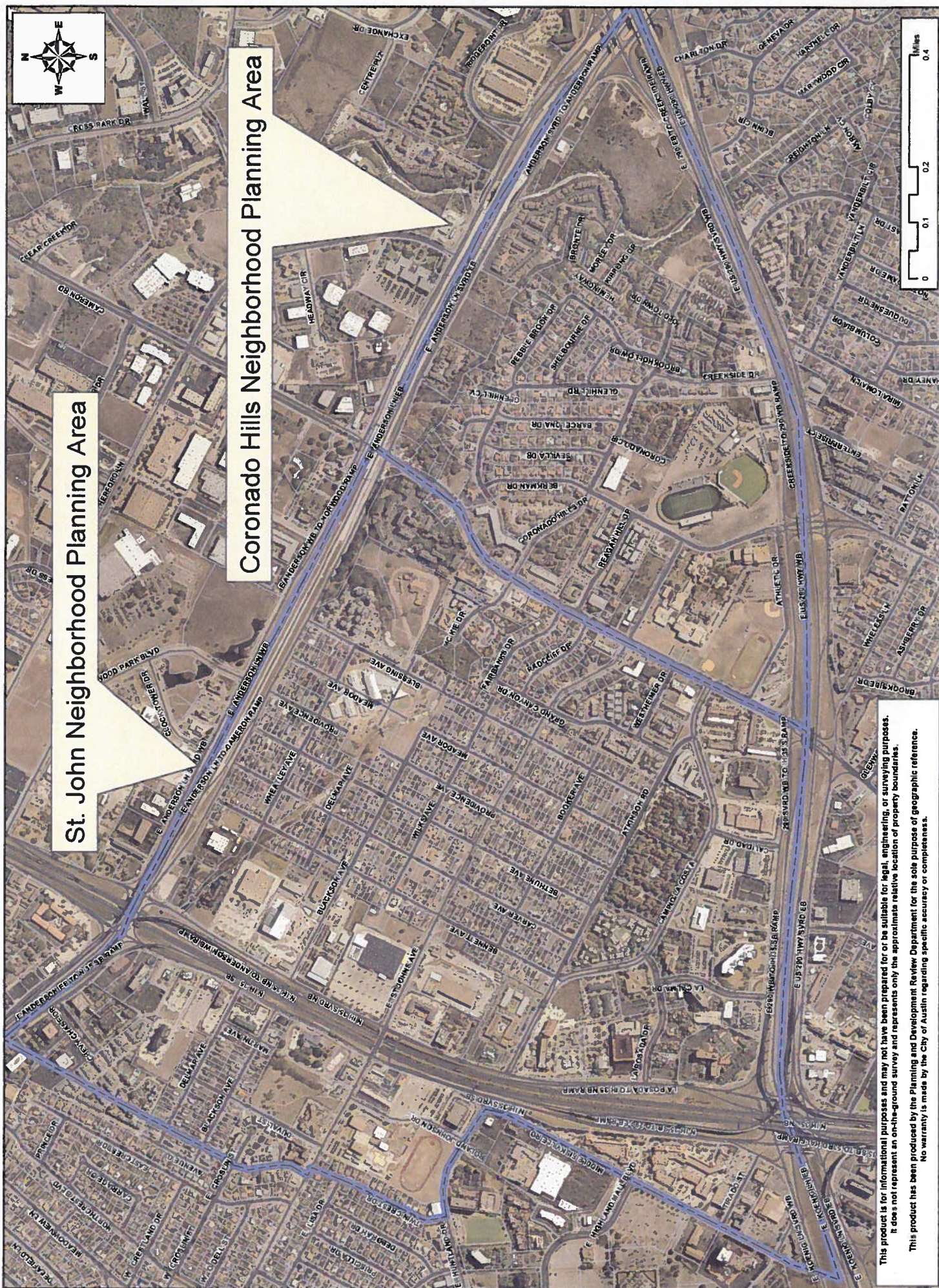

This product is for informational purposes and may not have been prepared for or be suitable for legal, engineering, or surveying purposes. It does not represent an on-the-ground survey and represents only the approximate relative location of property boundaries.

This product has been produced by the Planning and Development Review Department for the sole purpose of geographic reference. No warranty is made by the City of Austin regarding specific accuracy or completeness.

No warranty is made by the City of Austin regarding specific accuracy or completeness. No warranty is made by the Planning and Development Review Department for the sole purpose of goods produced by the Planning and Development Review Department for the sole purpose of goods.

St. John/Coronado Hills Combined Neighborhood Planning Area - Future Land Use Map

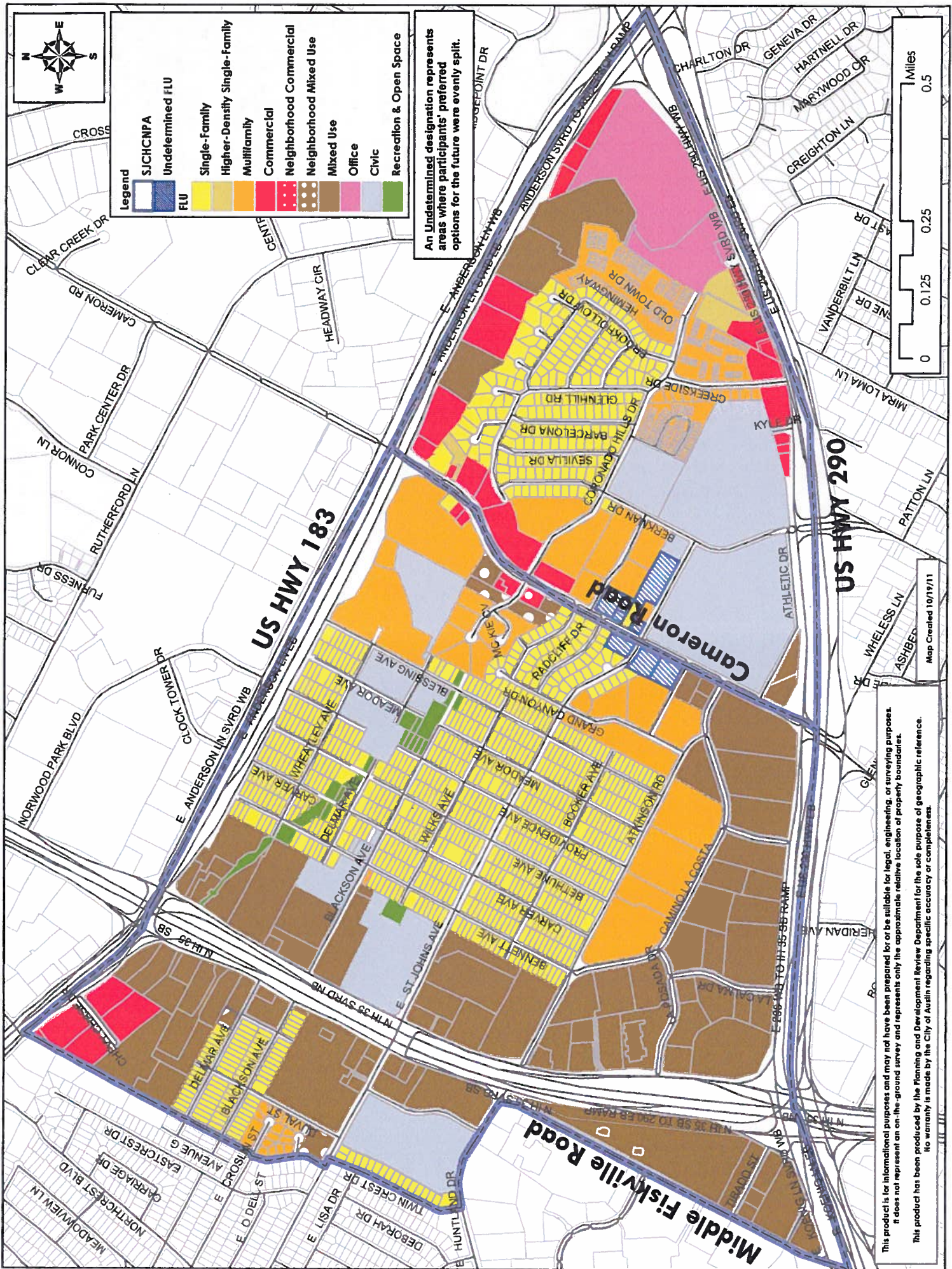

Coronado Hills Neighborhood Planning Area - Rezoning Tract Map

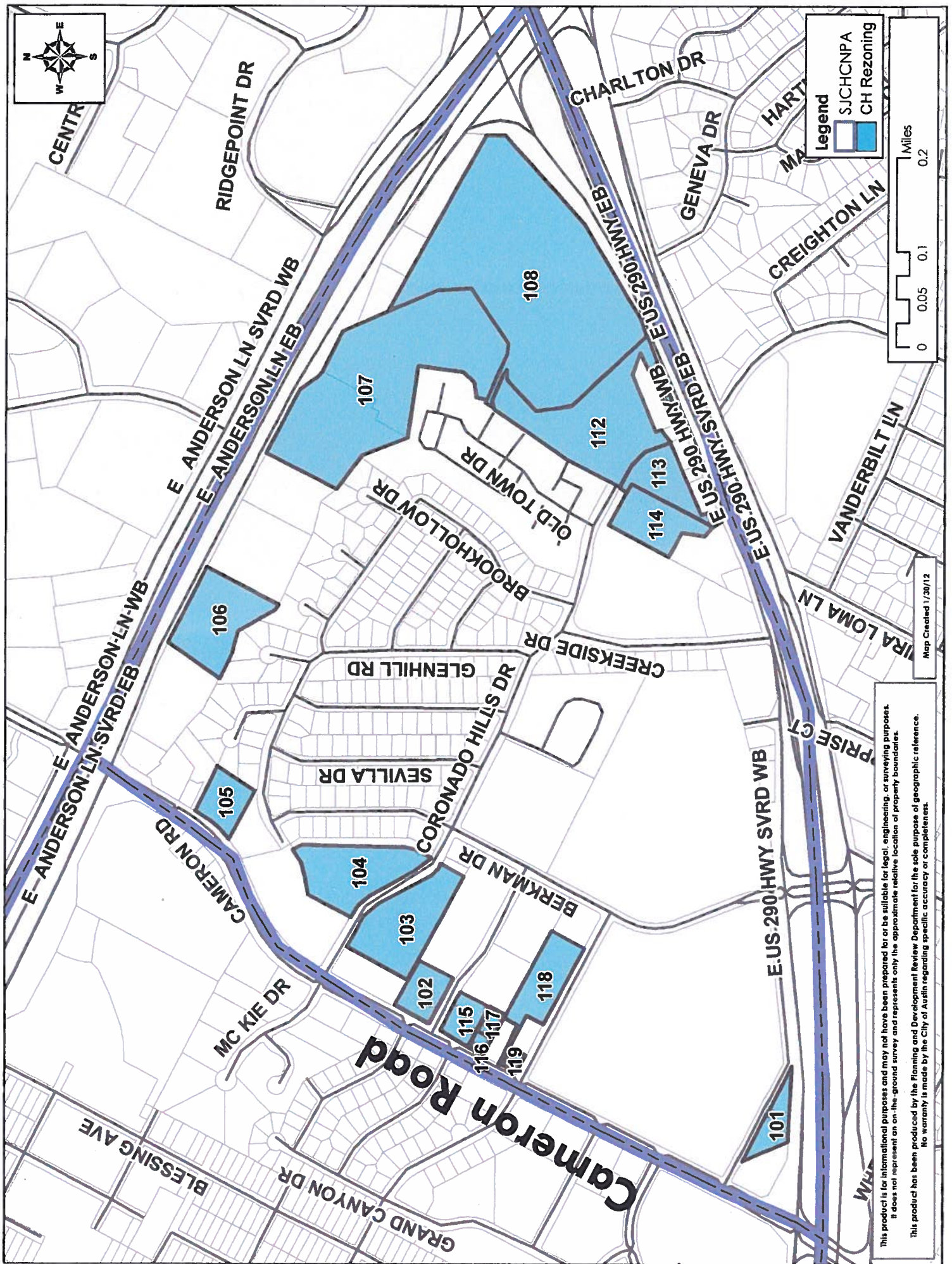

This product is for informational purposes and may not have been prepared for or be suitable for legal, engineering, or surveying purposes. It does not represent an on-the-ground survey and represents only the approximate relative location of property boundaries. This product has been produced by the Planning and Development Review Department for the sole purpose of geographic reference. No warranty is made by the City of Austin regarding specific accuracy or completeness.

**Coronado Hills Neighborhood Planning Area Rezoning Tract Chart
C14-2011-0116**

| Tract | TCAD # | COA Address | From | To (Proposed) |
|-------|---|------------------------|-----------------------------|---------------|
| 101 | 226767 | E 6640 U S HY 290 | GR | GR-V-NP |
| 102 | 228222 | 7247 CAMERON RD | GR | MF-4-NP |
| 103 | 230667 (portion) Approximately 4.505 acres, being a portion of LOT 1 SAINT GEORGE SUBD, as recorded in Volume 82, Page 270, of the Official Plat Records of Travis County | 1443 CORONADO HILLS DR | GR | MF-1-NP |
| 104 | 230586 (portion) Approximately 4.041 acres, being a portion of LOT 1 CORONADO PLACE, as recorded in Volume 82, Page 136, of the Official Plat Records of Travis County | 1438 CORONADO HILLS DR | GR | MF-2-NP |
| 105 | 230676 | 7601 CAMERON RD | GR | GR-CO-NP |
| 106 | 230698 | 1601 E ANDERSON LN | GR | GR-MU-NP |
| 107 | 230723 | 1901 E ANDERSON LN | GR | GR-MU-NP |
| | 230724 | 1901 E ANDERSON LN | | |
| 108 | 229476 | E 7424 U S HY 290 | SF-3 | GO-NP |
| 112 | 226844 (portion) Approximately 7.507 acres, being a portion of LOT 1 LESS S30.84FT AV PATTON'S ADDN SEC 3, as recorded in Volume 32, Page 14, of the Official Plat Records of Travis County, and ABS 29 SUR 58 APPEL GATE JACR 8.454 | E 7234 U S HY 290 | MF-3-CO; RR-CO; SF- 3 | GO-CO-NP |
| 113 | 228275 | 7142.5 E U S HY 290 | CS; GR | MH-NP |
| 114 | 228276 (portion) Approximately 2.617 acres, being a portion of ABS 789 SUR 57 WALLACE J P ABS 29 SUR 58 APPEL GATE JACR 4.392 *TOTAL | E 7100 U S HY 290 E | CS | MH-NP |

ATTACHMENT H

Coronado Hills Neighborhood Plan Combining District

Existing and Proposed Conditional Overlays

The following is a list of proposed conditional overlays (CO) for certain tracts within the Coronado Hills Neighborhood Plan Combining District. Conditional overlays are shown in the following tract list with a "CO" in the zoning string.

*Please note: For tracts with **existing** conditional overlays (conditions, prohibited uses, and conditional uses), City of Austin staff will recommend maintaining these conditional overlays as part of the rezonings for the Coronado Hills Neighborhood Plan Combining District, **with the exception of Tract 112.***

Tract 105 (PROPOSED)

Conditional Uses/Conditions:

A 25-foot wide vegetative buffer shall be provided and maintained along the eastern property line. Vegetative screening within the buffer is subject to the Screening Standards under Section 2.9.1 of the Environmental Criteria Manual.

Tract 112 (PROPOSED)

Conditional Uses/Conditions:

A 25-foot wide vegetative buffer shall be provided and maintained along southern 470 feet of the northwest property line. Vegetative screening within the buffer is subject to the Screening Standards under Section 2.9.1 of the Environmental Criteria Manual.

Special Use Infill Options & Design Tools

Neighborhood Special Uses

The following special uses are optional uses granted in addition to the uses allowed in the base-zoning district. The following special uses are being recommended as part of the St. John/Coronado Hills Combined Neighborhood Plan: Small lot amnesty (area wide), secondary apartments (entire St. John NPA), corner store (entire St. John NPA), cottage and urban home (entire St. John NPA and as a subdistrict in the Coronado Hills NPA - Coronado Hills Drive Subdistrict, boundary area shown in Attachment #10), residential infill (specific parcels, Attachment #8), and neighborhood urban center (specific parcels, Attachment #8). They are optional uses granted in addition to the uses allowed in the base-zoning district. Other special use options could be recommended by Planning Commission and approved by City Council.

Small Lot Amnesty

Small lot amnesty permits construction or major renovation of existing single-family homes on EXISTING legally-created lots that do not meet current minimum lot standards. To qualify, the lot must have a minimum area of 2,500 square feet and a minimum width of 25 feet. This special use applies to all zoning districts and overlays that permit single-family homes. Under existing regulations that apply city-wide, an existing, legally-created lot less than 5,750 square feet that does not comply with current zoning regulations cannot be legally developed or have substantial improvements made to existing buildings (unless it is a qualified substandard lot (LDC 25-2-943) with a minimum lot area of 4,000 square feet and platted before March 15, 1946). Many legally subdivided lots in older parts of the city that do not meet current standards or do not qualify as substandard lots are sitting vacant or the homes on those lots are deteriorating because major improvements are not allowed.

Cottage Lot

The cottage lot special use permits detached single-family homes on lots with a minimum area of 2,500 square feet and a minimum width of 30 feet (see below for exceptions) If chosen, the Cottage is permitted in SF-3, SF-5, SF-6, and MF-1 through MF-6 zoning districts, and in the mixed use (MU) combining district, in addition to the site development standards.

Urban Home

The urban home special use permits single-family homes on lots with a minimum area of 3,500 square feet and a minimum width of 35 feet. If chosen, the Urban Home is permitted in SF-3, SF-5, SF-6, and MF-1 through MF-6 zoning districts, and the mixed use (MU) combining district. Urban homes must comply with specific design requirements relating to front porches, garage placement, parking placement, driveway width, and the orientation of front entrances.

Residential Infill

The residential infill special use requires a diversity of housing types and open space and permits a limited amount of neighborhood compatible retail development. If chosen, this special use is applied to specific properties of at least two acres in the SF-3, SF-5, SF-6 and MF-1 through MF-6 zoning districts. For a proposed Residential Infill development, a development plan showing the location of land uses and the layout of streets, lots and open space must be approved by the Planning Commission.

Neighborhood Urban Center

Neighborhood Urban Center refers to the redevelopment of an existing retail or commercial center, or development of a vacant site, into a mixed use, pedestrian and transit-oriented center. The Neighborhood Urban Center would permit residential, multi-family, commercial and retail uses on certain sites with commercial zoning. The Neighborhood Urban Center includes limits on how

ATTACHMENT J

much of each type of development may occur. The goal of these standards is to ensure compatibility with existing neighborhoods while permitting flexibility in project design.

Secondary Apartment

The secondary apartment special use permits a second dwelling unit 850 square feet or less in size on a lot with a minimum area of 5,750 square feet. If chosen, this accessory unit is permitted in SF-1 through SF-3, SF-5, SF-6 and MF-1 through MF-6 zoning districts. Currently, a second unit with similar regulations as the secondary apartment is permitted city-wide on lots at least 7,000 square feet in the SF-3, SF-5 through MF-6 zoning districts. Choosing the secondary apartment special use opens up the opportunity for homeowners with lot sizes between 5,750 square feet and 7,000 square feet and those in the SF-1 and SF-2 zoning districts to build a second unit.

Corner Store

The corner store special use permits a small retail use on a residentially zoned property within a neighborhood. If chosen, the corner store is permitted at intersections in the SF-3 through SF-6 and MF-1 through MF-6 zoning districts. Only small-scale local-serving commercial uses are allowed. A Corner Store may not be approved within 600 feet of another Corner Store and operating hours are limited to 6am to 11pm.

Neighborhood Mixed-Use Building

The neighborhood mixed-use building special use permits a mix of uses, including residential, within a single building on a site measuring one acre or less. If chosen, this special use is applied to specific properties in the LO, GO, LR, GR, CS, CS-1, CH, and LI zoning districts. The standards for the mixed use building require pedestrian-oriented design. For example, buildings must be built closer to the street, and parking must be located to the rear of the building. A mixed use building may contain dwelling units in not more than 50% of the gross floor area of the ground floor.

Neighborhood Design Tools

The following design tools are being recommended as part of the St. John/Coronado Hills Combined Neighborhood Plan: parking placement (entire Coronado Hills NPA), Garage Placement (entire Coronado Hills NPA), front porch setback (entire St. John/Coronado Hills Combined Planning Area). Once adopted, the parking placement and impervious cover restrictions and garage placement" design tools are mandatory for all new residential construction and whenever there is a change of use (e.g., from single-family use to two-family use). The front porch setback design tool is optional.

Parking Placement and Impervious Cover Restrictions

The parking placement and impervious cover restrictions limit the number of parking spaces and the amount of impervious cover to be constructed in the front yard. Any single-family, two-family, or duplex use is subject to the following requirements:

1. No more than forty percent (40%) of the required front yard may be impervious cover (this may be waived if a circular driveway is needed for traffic safety purposes).
2. No more than 4 parking spaces may be located in a front yard, or, in the case of a corner lot, no more than 4 parking spaces may be located in the front and side-street yards combined.

Garage Placement

This option sets guidelines for developing and/or redeveloping lots in established neighborhoods where existing development emphasizes residential façades and minimizes the parking structure

aesthetics dominating single-family residential use of a property. It also allows for attached parking structures without width limitations to be constructed so that parking structure dominated development does not occur. This option allows for a side entry parking structure, which will accommodate residential design along the front wall.

For a Single-Family, Two-Family, or Duplex Residential Use:

1. Garages and carports must be located flush with the front façade, or behind the front façade of the house.
2. If a garage or carport is located less than 20 feet behind the front façade of the house, its width may not exceed 50% of the width of the house.

No maximum width is established for garages or carports that are 20 feet or more behind the front façade of the house, or for those that have side or rear entrances.

Front Porch Setback

Covered and uncovered front porches (defined as open-sided porches connected directly with the front entrance to a residence and with a permanent, exterior flooring material) shall henceforth be allowed to within 15 feet of the front property line. Roof overhangs and porch steps may extend an additional 24" toward the front property line. Structural columns (but not walls) are allowed within the footprint of the porch.

Affordable Housing Design Tools

In addition, affordable housing design tools are being recommended as part of the St. John/Coronado Hills Combined Neighborhood Plan: single family residence - standard lot (SF-2) district or family residence (SF-3) district (entire St. John NPA), duplex residential use (entire St. John NPA), secondary apartment special (entire St. John NPA). They are optional uses granted in addition to the uses allowed in the base-zoning district.

Single Family Residence - Standard Lot (SF-2) District or Family Residence (SF-3) District

Non-complying structures may be replaced with a new structure if it does not increase the existing degree of noncompliance with yard setbacks. Impervious surface may be increased to 50%.

Duplex Residential Use

The minimum lot size for duplexes is reduced to 5750 sq. ft. and up to eight bedrooms may be allowed; impervious cover may be increased to 50%.

Secondary Apartment Special

Increases allowable gross floor area to 850 sq. ft. and impervious cover to 50% for a secondary apartment special use. Units must comply with the City's S.M.A.R.T Housing Program for a period of at least 20 years at 60% Median Family Income (MFI).

Additional Regulations

The neighborhood planning process allows neighborhoods the option of additional regulations for mobile food establishments. This is being recommended area-wide as part of the St. John/Coronado Hills Combined Neighborhood Plan.

Mobile Food Establishment

This provision places additional regulations on mobile food establishments, most often trailers located in parking lots or vehicles that drive from one location to another. Please note: this

provision applies within the City of Austin city limits only, but does not apply to a mobile food establishment that is located on private property for 3 hours or less between the hours of 6:00 a.m. and 10:00 p.m. These additional regulations govern the location and hours of operation for mobile food establishments.

St. John/Coronado Hills Combined Neighborhood Planning Area - Special Use Infill Tracts

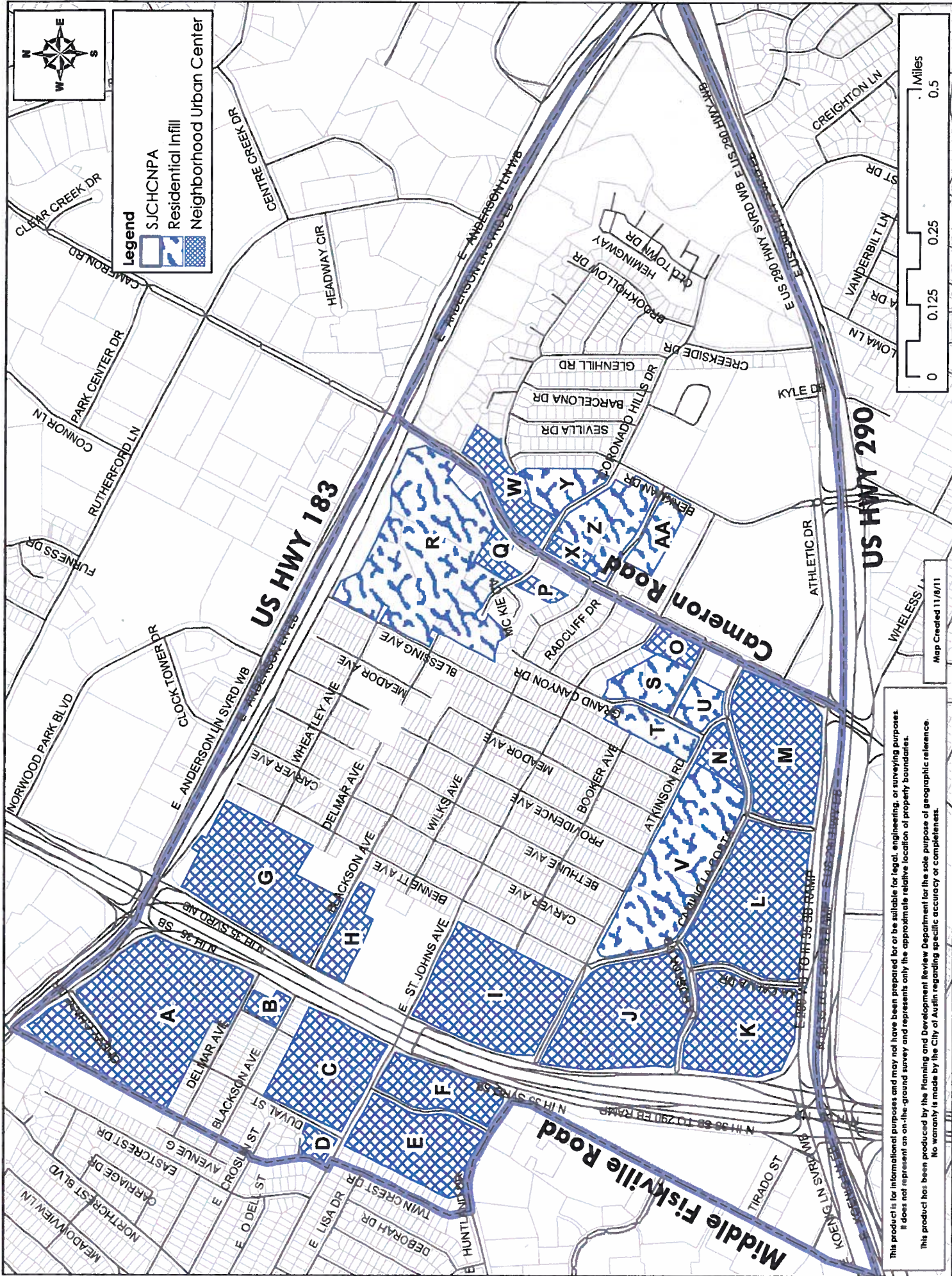

ATTACHMENT K

| Coronado Hills Neighborhood Planning Area Special Use Infill Tracts | | |
|---|--------------|--------------------------|
| Tract | TCAD Prop ID | Address |
| W | 230676 | 7601 CAMERON RD |
| | 230585 | 7537 CAMERON RD |
| | 230587 | 7517 CAMERON RD |
| X | 230668 | 1401.5 CORONADO HILLS DR |
| Y | 230586 | 1438 CORONADO HILLS DR |
| Z | 228222 | 7247 CAMERON RD |
| | 228220 | 1500 REAGAN HILL DR |
| | 230667 | 1443 CORONADO HILLS DR |
| AA | 228226 | 1501 REAGAN HILL DR |
| | 228229 | 1521 REAGAN HILL DR |

ATTACHMENT L

St. John/Coronado Hills Combined Neighborhood Planning Area - Coronado Hills Drive Subdistrict

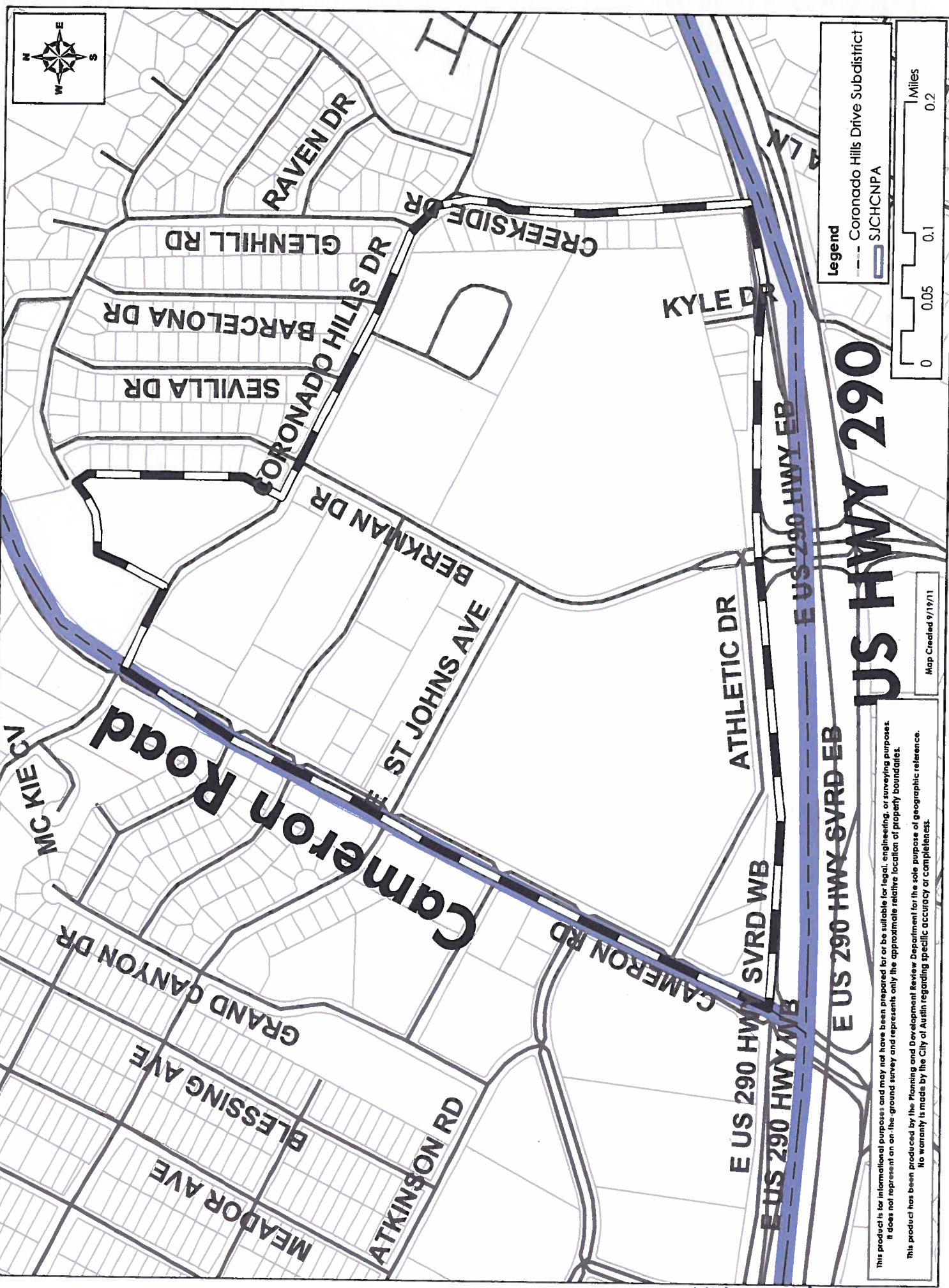

RESOLUTION OF THE OLD TOWN BOARD OF DIRECTORS
REGARDING ST JOHN/CORONADO HILLS NEIGHBORHOOD PLAN

Agenda
Item #s:
6, 7a, 8

I, Joe Colvin, President of the Old Town HOA, a not for profit entity duly organized and existing under the laws of the State of Texas, do hereby certify that the Board of Directors of said Corporation, by majority vote, do hereby and here within adopt into effect the following resolutions.

All restrictions of the declaration and bylaws are by reference incorporated into the rules. In addition to the declaration and bylaws, the Board adopts the following rules:

The St John/Coronado Hills Neighborhood Plan as the strategic planning document for the plan area and will participation in the Coronado Hills Neighborhood Plan Contact Team.

Approved this 17 day of January, 2012.

Old Town HOA, Inc.

By:

Title:

Joe C. Colvin
President

FURTHER RESOLVED, that these rules shall be effective upon execution.

IN WITNESS WHEREOF, I have hereunto set my hand as Team Lead of said Corporation, this

23rd day of January, 2012.

[Signature]
Secretary

ACKNOWLEDGEMENT

THE STATE OF TEXAS
COUNTY OF Travis

This instrument was acknowledged before me appeared

Joe C. Colvin and Jarleen M. Gilmore
in the capacity stated above.

GIVEN UNDER MY HAND AND SEAL OF OFFICE, this the 23rd day of
January, 2012.

Jerome J. Gilmore
Notary Public

ATTACHMENT N

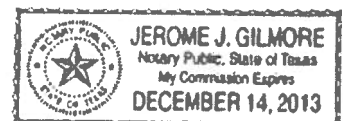

CITY COUNCIL HEARING

DATE: Thursday, February 9, 2012

TIME: 2:00 P.M.

LOCATION: 301 W. 2nd St., City Hall, Council Chambers, Austin

***Please Note:** If the Planning Commission does not take action on the St. John/Coronado Hills Combined Neighborhood Plan and subsequent zoning changes at the January 24, 2012 hearing, the City Council hearing will likely be postponed. Check the minutes from the February 9, 2012, City Council hearing for the new hearing date.

Contact Information

For questions regarding the St. John/Coronado Hills Combined Neighborhood Plan or proposed zoning changes, please call or email:

Dee Dee Quinnelly
(512) 974-2976

Greg Dutton
(512) 974-3509

Paul DiGiuseppe
(512) 974-2865

kathryn.quinnelly@austintexas.gov

greg.dutton@austintexas.gov

paul.digiuseppe@austintexas.gov

Si Ud. necesita información en español, favor de llamar a Pamela Larson al (512) 974-6404.

Office hours are 8:00 a.m. to 5:00 p.m. Monday through Friday. Please be sure to refer to the File Numbers on the first page when you call. See enclosed sheets for more information on public hearings.

PLANNING COMMISSION COMMENT FORM

File # C14-2011-0115
C14-2011-0116

Planning Commission Hearing Date: Tuesday, January 24, 2012

Comments: Sounds Great.

You may also send your written comments to the Planning and Development Review Department, P.O. Box 1088, Austin, TX 78767-8835 Attn: Greg Dutton

Name (please print) Charles DeBusk

Address 1044 Camino la Costa #1128
AUSTIN, TX 78752

☒ I am in favor

(Estoy de acuerdo)

☐ I object

(No estoy de acuerdo)

INFORMATION ON PUBLIC HEARINGS

The Planning and Development Review Department has filed an application for zoning/rezoning to implement a neighborhood plan. This notice has been mailed to you because City Ordinance requires that all property owners, registered environmental or neighborhood organizations and utility service

December 26, 2011

City of Austin
Planning and Development Review Department
Greg Dutton, Senior Planner
505 Barton Springs Road
Austin, TX. 78704

RE: 7424 U.S. HWY 290 E.

Dear Mr. Dutton;

I have been retained by the owners of the property located at 7424 HWY 290 E., also known as tract 108 in the St. Johns/Coronado Hills combined neighbor planning area.

The Coronado Hills Neighborhood Planning Area Rezoning Tract Chart (C14-2011-0116) indicated that tract 108 is proposed to be rezoned to GO-NP. It is the desire of my clients to have this tract rezoned to CS Commercial Services District during this neighborhood planning process. Please consider this a petition against the proposed GO-NP classification.

Please send all notifications to me at Jim Bennett, 11505 Ridge Dr. Austin, TX. 78748. My other contact information is cell 784-4961, fax 282-0959 or email at jb.rbconsulting@yahoo.com.

Please contact me if you require additional information.

Sincerely,



Jim Bennett

ATTACHMENT 0

P E T I T I O N

Date: 10/25/2011

File Number: C14-2011-0116

Address of

Rezoning Request: 7424 Hwy 290 E.

SJCH Neighborhood Plan
- Tract 108

To: Austin City Council

We, the undersigned owners of property affected by the requested zoning change described in the referenced file, do hereby protest against any change of the Land Development Code which would zone the property to any classification other than CS-MU.

(STATE REASONS FOR YOUR PROTEST)

(PLEASE USE BLACK INK WHEN SIGNING PETITION)

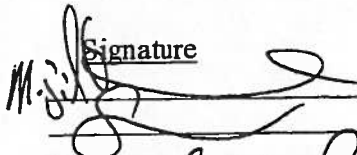
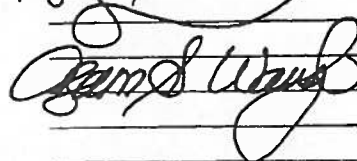
| <u>Signature</u> | <u>Printed Name</u> | <u>Address</u> |
|---|---------------------|---------------------------------|
|  | MAJID HEMMASI, P.E. | 6700 GUADALUPE, AUSTIN, TX |
| | SEJED MIRI | 5909 WAYMAKER CV. 78752 |
| | | AUSTIN, TX. 78746 |
|  | AZAM S. WAUGH, P.E. | P.O. BOX 2682, AUSTIN, TX 78768 |

Date: 10/25/2011

Contact Name:

Azam Waugh

Phone Number:

(512) 474-4470

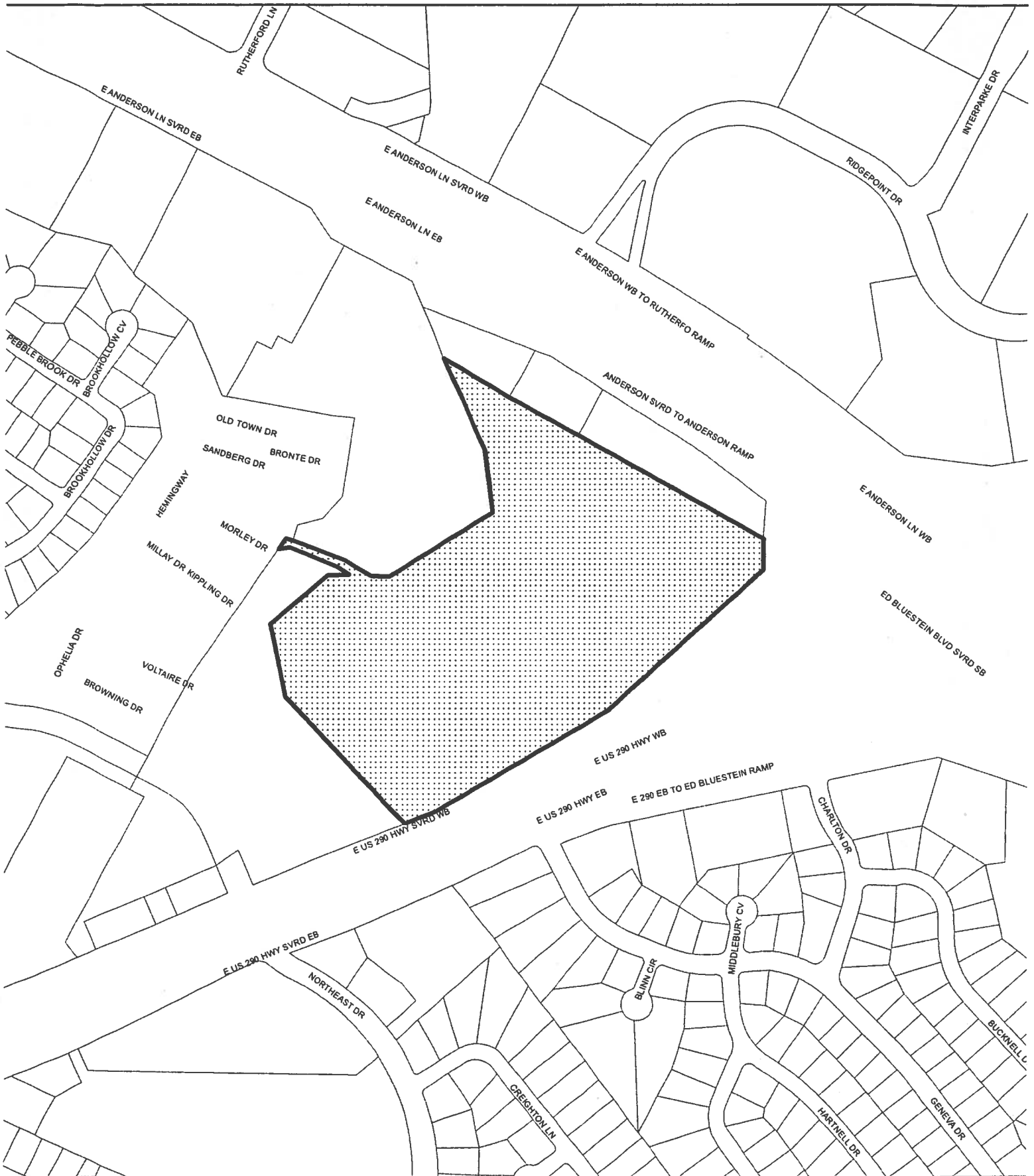

PETITION

CASE#: C14-2011-0116



This product is for informational purposes and may not have been prepared for or be suitable for legal, engineering, or surveying purposes. It does not represent an on-the-ground survey and represents only the approximate relative location of property boundaries.

This product has been produced by CTM for the sole purpose of geographic reference. No warranty is made by the City of Austin regarding specific accuracy or completeness.

PETITION

Case Number: **C14-2011-0116**
7424 Hwy 290 E.

Date: 2/14/2012

| | |
|--|------------|
| Total Square Footage of Buffer: | 1057728.26 |
| Percentage of Square Footage Owned by Petitioners Within Buffer: | 100.00% |



Calculation: The total square footage is calculated by taking the sum of the area of all TCAD Parcels with valid signatures including one-half of the adjacent right-of-way that fall within 200 feet of the subject tract. Parcels that do not fall within the 200 foot buffer are not used for calculation. When a parcel intersects the edge of the buffer, only the portion of the parcel that falls within the buffer is used. The area of the buffer does not include the subject tract.

RE: TRACT #108

Supports staff/neighborhood rec, opposed to prop owner rec

Agenda
Items:
6, 7a, 8

Owners have suggested to residents that a strip type mall could be built with their proposal. I will briefly list the current strip mall services currently surrounding our neighborhood. If two numbers are given for a store, it is because these businesses go in and out of business from month to month.

1. 4 -5 filling stations all are combo convenience store/station
2. Grocery stores
 - a. 4-5 small ethnic specialty stores,
 - b. 1 full service, large ethnic store
 - c. 1 old and somewhat run down full service store
3. 2-3 fingernail shops
4. 2 dry cleaners (some go in and out of business)
5. 3 pay day loan stores
6. 2 half way residential houses
7. 4-6 small restaurants
8. 2-3 beauty shops
9. 2 pawn shops
10. 2 Dept of Texas offices-rehabilitation & DOT
11. 2 Laundromats
12. 2 franchised dental offices
13. 2 insurance stores
14. 4 car repair or used tire stores
15. 1 liquor store
16. 1 very large night club set to open upon completion of remodeling
17. 1 mobile home park currently violating many city codes for mobile home parks
18. 1 strip mall church
19. 1 phone store
20. 2 video stores
21. 1 karate school
22. 1 health clinic for underserved citizens
23. 2 hair cutting stores
24. 1 bank
25. 2 Childcare facilities
26. 1 barber shop
27. 1 small business park

FROM: Ms Easterday

Rhoades, Wendy

From: Dutton, Greg
Sent: Wednesday, February 29, 2012 10:18 AM
To: Quinnelly, Kathryn; Rhoades, Wendy
Subject: FW: Zoning request

Hi guys,

Here's the email I got from the property owner on Tracts 113 and 114.

Greg

From: SHIRISH SHELAT [mailto:shshelat@yahoo.com]
Sent: Tuesday, February 28, 2012 8:54 PM
To: Dutton, Greg
Subject: Zoning request

Mr. Dutton.

I have discussed with you on phone. I will try to attend meeting personally but in case I cannot, I am sending you my request for the city council

We would like to keep the zoning as it is for the following reason.

1). we have small motel and restaurant in front of the mobile home park. This is same properties and land that has mobile home on the back side. We would like to keep the zoning for entire property same.

2) We also have option of selling entire property in future if it is same zoning area.

3) This business I am running since 1991 and we purchased entire business that was running with same zoning.

Please consider our request and keep the zoning same.

Thank you.

If you have any question please contact me on my mobile no 512-623-9579.

Satish bhatt .

2/28/12.

St John and Coronado Hills Neighborhood Plan Update

At the Planning Commission Meeting on Tuesday, January 9th the Neighborhood Plan and city staff recommendation to roll back the zoning of the mobile home park east of our Phase I homes from the current CR, General Commercial Services District which is intended for commercial and industrial activities of a service nature having characteristics or traffic service requirements generally incompatible with residential environment, to Mobile Home was not approved. Instead the Commission recommended to City Council that it stay zoned commercial. This not only allows the mobile home park to stay but would allow uses like auto repair, transportation terminals, adult oriented businesses, and pawn shops if the tracts are ever redeveloped.

We need to fight this and make sure we do not miss this opportunity to roll the zoning back to a residential use.

Staff recommended MH, mobile home, since it is current use. Some in Coronado Hills did not like the MH zoning. For that reason we are going to ask for SF-6 which is Townhouse and Condominium. Please note that changing the zoning does not change the current use as a mobile home park but would come into play if the site is ever redeveloped.

If you have questions please contact Teresa Reel at teresa.reel76@gmail.com.

By responding to this email you are expressing your opposition to Tract 113 and 114 (mobile home park east of Phase I) current zoning of GR/CS, commercial and supporting a request of SF-6, Townhouse and Condominium.

[Click Here to Support Statement Above](#)

PETITION

Date: January 31, 2012

File Number: C14-2011-0116

Address of Rezoning Request:

7142.5 US HY 290 (Tract#113)

E7100 US HY 290 E (Tract#114)

To: Austin City Council

We, the undersigned owners of property affected by the requested zoning change described in the referenced file, do hereby protest against any change of the Land Development Code which would zone the property to any classification other than SF-6.

We oppose Planning Commission recommendation to leave Tracts 113&114 the current CS/GR zoning.

1. The City Zoning Guide states that CS is "intended for commercial and industrial activities of a service nature having operating characteristics or traffic service requirements **generally incompatible with residential environments**"
2. Tracts 113&114 primary use is residential and has been for over 30 years.
3. To the immediate west of the CS zoned property is 75 residential units, the community clubhouse and community pool for Old Town HOA which were built in 1972.
4. The proposed Neighborhood Plan future land use map shows these Tracts as high density single family.
5. The Combined St John/Coronado Hills neighborhoods already have a high percentage of commercial land use in their planning area.
6. Planning Commission objected to the only zoning classification that would bring the tracts into conforming use and did not recommend zoning consistent with the proposed Neighborhood Plan future land use map.
7. Current use is grandfathered infinitely. The requested zoning of high density single family residential will guide any future redevelopment of the property beside Old Town HOA.

For the above stated reasons, we the Board of Old Town Homeowners Association oppose the Planning Commission recommendation for Tracts 113&114, and support the high density single family zoning consistent with the St John/Coronado Hills Neighborhood Plan land use map.

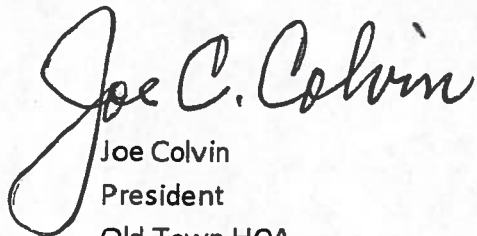

Joe Colvin
President
Old Town HOA
7524 Hemingway Street

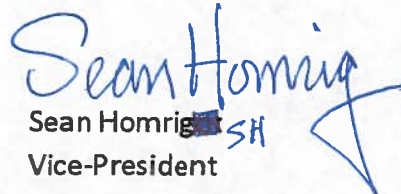

Sean Homrigh ^{SH}
Vice-President
Old Town HOA
1901 Browning Drive



Darleen Gilmore
Secretary
Old Town HOA
1851 Coronado Hills Drive



Scott MacEwan
Treasurer
Old Town HOA
7514 Hemingway Drive

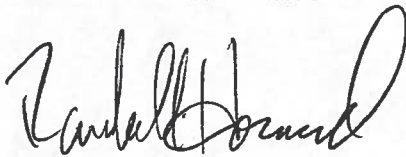

Randall Howard
Phase I Representative
Old Town HOA
7233 Creekside

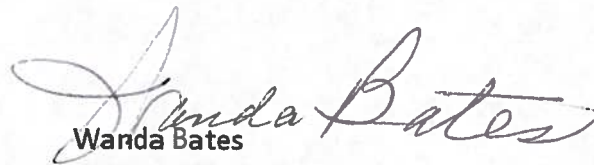

Wanda Bates
Phase II Representative
Old Town HOA
7400 Ophelia Drive

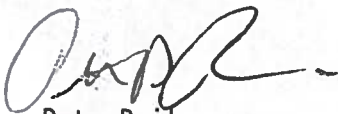

Peter Reid
Phase III Representative
Old Town HOA
2108 Kipling Drive

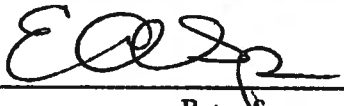

AFFORDABILITY IMPACT STATEMENT
NEIGHBORHOOD HOUSING AND COMMUNITY DEVELOPMENT
CITY COUNCIL AGENDA: CASE NUMBER:

| | |
|---|--|
| Proposed Code Amendment: | St. John/Coronado Hills Combined Neighborhood Plan. |
| Proposed Neighborhood Plan Impacting Housing Affordability: | <p>Proposed neighborhood plan has an overall positive impact of affordability by:</p> <ul style="list-style-type: none">• Adding 264 acres of mixed use to the neighborhood• Adopting small lot amnesty over the entire combined neighborhood planning area• Adopting Cottage Lot and Urban Home in an 881 acre sub-district• Adopting Secondary Apartment Infill Option over the entire St. John Neighborhood Planning Area• Adopting Residential Infill in a 100 acre sub-district• Adding 35 acres of MF zoning to the Combined Neighborhood Planning Area |
| Alternative Language to Maximize Affordable Housing Opportunities: | <p>Although the current draft neighborhood plan does have an overall positive impact on affordability, there are additional opportunities to maximize affordable housing in the combined neighborhood planning area. These are:</p> <ul style="list-style-type: none">- Adopt the Urban Home and Cottage infill options over all single family residential properties in the combined neighborhood planning area.- Adopt the Residential Infill option for all single family residential properties zoned SF-3 in the combined neighborhood planning area. |
| Other Recommendations: | None |
| Date Prepared: | January 31, 2012 |
| Director's Signature: <u></u> Betsy Spencer | |

ATTACHMENT P

Rhoades, Wendy

From: Quinnelly, Kathryn
Sent: Thursday, March 01, 2012 11:35 AM
To: Guernsey, Greg
Cc: Haywood, Carol; DiGiuseppe, Paul; Walters, Mark; Rhoades, Wendy; Dutton, Greg
Subject: FW: Requested Postponement of March 1 City Council Agenda Items #61 and #63
Importance: High

FYI, see below for Coronado Hills' request for postponement.

Kathryn D. "Dee Dee" Quinnelly, LEED AP

Senior Planner, City of Austin
Planning and Development Review Department
512.974.2976
kathryn.quinnelly@austintexas.gov



Please consider the environment before printing this email.

From: Teresa Reel [mailto:treel@clear.net]
Sent: Thursday, March 01, 2012 11:30 AM
To: Leffingwell, Lee; Cole, Sheryl; Spelman, William; Morrison, Laura; Riley, Chris; Martinez, Mike [Council Member]; Tovo, Kathie
Cc: Dutton, Greg; Quinnelly, Kathryn; Meredith Morningstar; Mike Wusterhausen
Subject: Requested Postponement of March 1 City Council Agenda Items #61 and #63

Late yesterday afternoon the Coronado Hills Neighborhood Planning group was notified by staff that they had been in discussions with the owner of Tracts 113 and 114 over the last week and that he is now contesting the neighborhood and staff recommended zoning of these Tracts. Since the property owner did not participate in the three year long Neighborhood Planning process nor respond to the legal notification of zoning change which was sent out prior to the Neighborhood Plan and the zoning changes going to the Planning Commission we have had no opportunity to discuss the future land use plan with the property owner. This is a major concern for us since the Mobile Homes in the park are all at end of life based on the tax records and the property is currently zoned CS/GR with only a 6 feet wood fence separating it from residential homes. The CS/GR zoning is not consistent with the Future Land Use Plan in the proposed Neighborhood Plan nor the actual use of the property for the last 46 years.

We are asking that agenda items #61 and #63 be postponed until April 5th so that we have an opportunity to meet and discuss the future land use plan with the property owner.

If there are any question please contact Teresa Reel at 694-2000 or Meredith Morningstar at 921-4832.

Thank you for your consideration.