

ORDINANCE NO. _____

AN ORDINANCE REZONING AND CHANGING THE ZONING MAP FOR THE PROPERTY LOCATED AT 7016 EAST BEN WHITE BOULEVARD WB IN THE MONTOPOLIS NEIGHBORHOOD PLAN AREA FROM LIMITED INDUSTRIAL SERVICE-NEIGHBORHOOD PLAN (LI-NP) COMBINING DISTRICT AND GENERAL COMMERCIAL SERVICES-NEIGHBORHOOD PLAN (CS-NP) COMBINING DISTRICT TO GENERAL COMMERCIAL SERVICES-MIXED USE-NEIGHBORHOOD PLAN (CS-MU-NP) COMBINING DISTRICT.

BE IT ORDAINED BY THE CITY COUNCIL OF THE CITY OF AUSTIN:

PART 1. The zoning map established by Section 25-2-191 of the City Code is amended to change the base district from limited industrial service-neighborhood plan (LI-NP) combining district and general commercial services-neighborhood plan (CS-NP) combining district to general commercial services-mixed use-neighborhood plan (CS-MU-NP) combining district on the property (the "Property") described in Zoning Case No. C14-2011-0169, on file at the Planning and Development Review Department, as follows:

Tract 1: From limited industrial service-neighborhood plan (LI-NP) combining district to general commercial services-mixed use-neighborhood plan (CS-MU-NP) combining district.

A 2.50 acre tract of land, more or less, out of Lot 1, AHC Addition Subdivision, a subdivision in the City of Austin, Travis County, Texas, according to map or plat of record in Volume 84, Page 48B of the Official Public Records of Travis County, Texas;

Tract 2: From general commercial services-neighborhood plan (CS-NP) combining district to general commercial services-mixed use-neighborhood plan (CS-MU-NP) combining district.

A 24.78 acre tract of land, more or less, out of Lot 1, Travis 51 Addition No. 2 Subdivision, a subdivision in the City of Austin, Travis County, Texas, according to map or plat of record in Document No. 200100312, of the Official Public Records of Travis County, Texas; and,

A 4.13 acre tract of land, more or less, out of Lot 1, Travis 51 Addition No. 2 Subdivision, a subdivision in the City of Austin, Travis County, Texas, according

1 to map or plat of record in Document No. 200100312, of the Official Public
2 Records of Travis County, Texas, SAVE AND EXCEPT the following tract of
3 land:
4

5 A 1.78 acre tract of land, more or less, out of Lot 1, Travis 51
6 Addition No. 2 Subdivision, a subdivision in the City of Austin,
7 Travis County, Texas, according to map or plat of record in
8 Document No. 2006021463, of the Official Public Records of Travis
9 County, Texas,
10

11 locally known as 7016 East Ben White Boulevard WB in the City of Austin, Travis
12 County, Texas, and generally identified in the map attached as Exhibit "A".
13

14 **PART 2.** Except as specifically provided in Part 3 of this ordinance, the Property may be
15 developed and used in accordance with the regulations established for the general
16 commercial services (CS) base district, the mixed use combining district and other
17 applicable requirements of the City Code.
18

19 **PART 3.** The Property is subject to Ordinance No. 20100927-28 that established the
20 Montopolis neighborhood plan combining district.
21

22 **PART 4.** This ordinance takes effect on _____, 2012.
23

24 **PASSED AND APPROVED**

25
26 §
27 §
28 _____, 2012 § _____
29

30 Lee Leffingwell
31 Mayor
32

33 **APPROVED:** _____ **ATTEST:** _____
34 Karen M. Kennard Shirley A. Gentry
35 City Attorney City Clerk

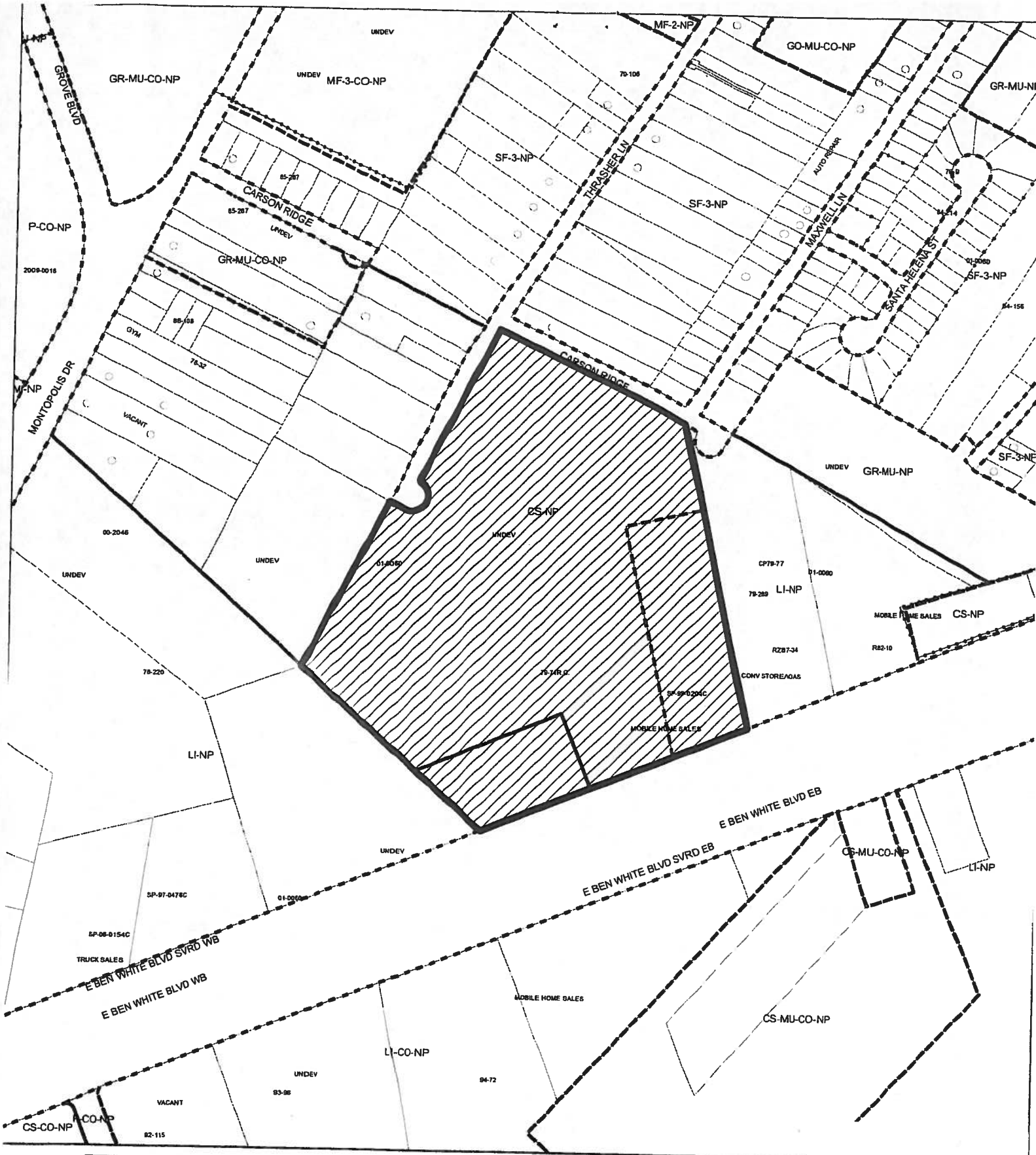



 SUBJECT TRACT

 PENDING CASE

 ZONING BOUNDARY

ZONING
 ZONING CASE#: C14-2011-0169

Exhibit A



1" = 400'

This product is for informational purposes and may not have been prepared for or be suitable for legal, engineering, or surveying purposes. It does not represent an on-the-ground survey and represents only the approximate relative location of property boundaries.

This product has been produced by CTM for the sole purpose of geographic reference. No warranty is made