

ARE SHALL BE TAKEN TO LOCATE ALL EXISTING UNDER GROUND OBSTRUCTIONS, UTILITIES AND/OR SEWERS BEFORE DIGGING OR DRILLING ON THE SITE.

ALL EXCAVATIONS SHALL BE BARRICADED FOR PERSONNEL PROTECTION, MEETING REQUIREMENTS OF OTHER TRADES PRIOR TO PROCEEDING WITH FABRICATION OR INSTALLATION OF MATERIALS.

OUTLET SHOP DRAWINGS SHALL BE PROVIDED FOR ALL FABRICATED ITEMS FOR REVIEW PRIOR TO FABRICATION. STRUCTURAL DRAWINGS SHALL NOT BE REPRODUCED FOR SHOP DRAWINGS.

IT CURRENT SHALL BE ACCOMPANIED WITH ALL APPLICABLE STATE, LOCAL AND NATIONAL CODES OF THE VARIOUS JURISDICTIONS. THESE CODES INCLUDE, BUT ARE NOT LIMITED TO THE FOLLOWING: THE AMERICAN INSTITUTE OF STEEL CONSTRUCTION - SPECIFICATION FOR THE DESIGN, FABRICATION AND ERECTION OF STRUCTURAL STEEL FOR BUILDINGS AND REINFORCEMENT OF CONCRETE FOR STRUCTURAL STEEL CONSTRUCTION - STEEL TOWER DESIGN - STANDARD PER AISC/A134 - 222-F SPECIFICATIONS

ALL BIDDERS SHALL VISIT THE SITE BEFORE BIDDING TO FAMILIARIZE THEMSELVES WITH EXISTING CONDITIONS.

HIS BUILDER/SUBCONTRACTOR SHALL BE RESPONSIBLE FOR THE REPAIR OF ANY DAMAGE TO EXISTING STRUCTURES AND SHALL REPLACE OR REPAIR TO THE ORIGINAL CONDITION AS DETERMINED BY THE PROJECT MANAGER.

OWNER OF THE SITE RETAINS SALVAGE RIGHTS TO ALL MATERIALS AND EQUIPMENT REMOVED FROM THE EXISTING WORK. MATERIALS AND EQUIPMENT NOT CLAIMED BY THE OWNER SHALL BECOME THE PROPERTY OF THE BUILDER/SUBCONTRACTOR WHO SHALL ASSUME COMPLETE RESPONSIBILITY FOR THE REMOVAL AND APPROPRIATE DISPOSAL THEREOF.

INTELLIGENCE NOTED AS "+" OR "VERY+" ARE BASED ON MATCHING EXISTING CONDITIONS, AND MAY BE SLIGHTLY FROM THE DIMENSIONS AS SHOWN, NOTIFY THE PROJECT MANAGER IF SIGNIFICANT VARIATIONS ARE ENCOUNTERED AT THE SITE.

THE MAJORITY OF THE SITE RELATED ACTIVITIES REQUIRES THAT ACCESS TO THE SITE MUST BE MAINTAINED AT ALL TIMES DURING HOURS OF OPERATION AND WHEN THE SITE IS UNATTENDED. WORK WITH THE OWNERS REPRESENTATIVE FOR SAFETY AND SECURITY AT ALL TIMES.

CONTRACTORS SHALL BE REQUIRED TO PICKUP ALL OWNER SUPPLIED EQUIPMENT AS DIRECTED BY THE PROJECT MANAGER WITH NO ADDITIONAL COST TO THE JOB.

TELECOMMUNICATION TOWERS MUST BE CONSTRUCTED IN ACCORDANCE WITH THE MOST RECENT AMERICAN NATIONAL STANDARD INSTITUTE STRUCTURAL STANDARDS FOR STEEL TOWER TOWERS.

THE MAXIMUM SLOPE OF A RAMP IN NEW CONSTRUCTION IS 1:12. THE MAXIMUM RISE FOR ANY RAMP IS 30 INCHES. PROVIDE A DETAIL OF THE RAMP. [TWS 4.8.2, FIG. 16]

ACCESSIBLE ROUTES MUST HAVE A CROSS-SLOPE NO GREATER THAN 1:50. [IAS 4.3.3.]

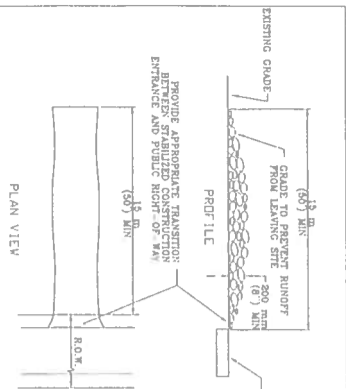

AT&T (N) 100'-0" ANTENNA MOUNTING HEIGHT

(N) ANTENNAS & SUPPORT SYSTEM
REFER TO RF CONFIGURATION
SHEET FOR ANTENNA MOUNTING
HEIGHTS, MODEL NUMBER
AZIMUTH, ETC.

TOWER VERIFICATION:
THE GENERAL CONTRACTOR SHALL VERIFY WITH OWNER, THE TOWER TYPE AND HEIGHT PRIOR TO ORDERING OR CONSTRUCTING THE TOWER.

NOTE:

1. SUBCONTRACTOR TO COMPLY WITH ALL FCC AND FAA REGULATIONS ON THIS PROJECT
 2. ON TOWERS OVER 200' TALL ADD AIRCRAFT WARNING LIGHTS AND CONTROLS PER FAA REGULATIONS
 3. THIS SITE ELEVATION IS A GENERALIZATION OF SITE AND THERE MAY BE OTHER RELATIONSHIPS WITH ONE ANOTHER
- REFER TO TOWER MANUFACTURER'S SPECIFICATIONS FOR GROUNDING OF TOP, MID & BOTTOM OF TOWER
CABLE RIGS, COORDINATE THROUGH LESSEE CONSTRUCTION SUPERVISOR

(N) 100'-0" TOWER - VERIFY (REFER TO TOWER VERIFICATION NOTE)

-100'-0"

SCALE: NTS

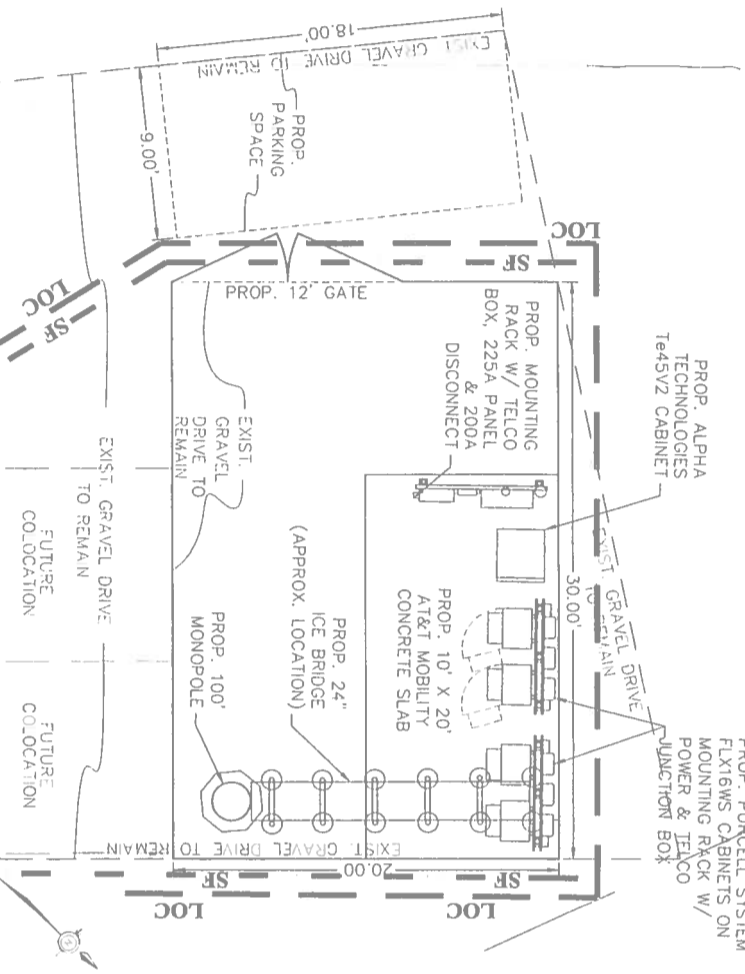

NOTE: LOCATION OF EQUIPMENT IS APPROXIMATE
NOTE: CONCRETE SLAB & EQUIPMENT ARE NOT

SCALE: 1" = 5'
WITHIN A BUILDING

[illegible]

SCALE: 1" = 100

[illegible]

EXHIBIT 1 AP OF

(19862) (JETS) OF LAND OUT OF THE JOSEPH HUDSON SURVEY, ABSTRACT: NO. 410, IN TRAVIS COUNTY, TEXAS, BEING ALL OF THE CERTAIN (19862 ACRES) TRACT OF LAND AS COMPLETED TO THE MAP BY DEED RECORDED IN VOLUME 12001, PAGE 2250 OF THE PUBLIC PROPERT RECORDS OF TRAVIS COUNTY, TEXAS

NOTES

1. This IRIS was prepared without the benefit of a current title commitment.
2. The title commitment was obtained from the County Clerk's Office, and the title was confirmed by the County Clerk's Office.
3. See Page 2 and 3 of the Tree List.
4. Elevation benchmark: 849.9
5. (a) 15 of Austin EUD 173 Elevation = 1038.99
6. (b) 15 of Austin EUD 173 Elevation = 1040.29
7. (c) 15 of Austin EUD 173 Elevation = 1042.75
8. A Tree "Crown" is shown as a function of one inch of trunk diameter and the "Crown" radius.

PREPARED
BY:

WASHED RIVER GRAVEL



BRICK PAVERS

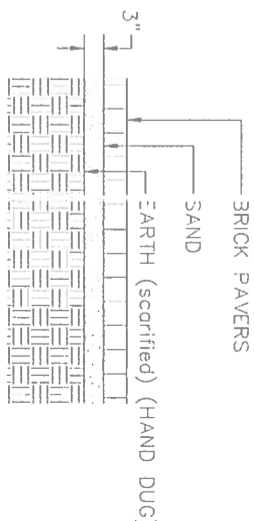

EXISTING SIGNAGE

TOWER MANAGER
XXX.XXX.XXXX

FCC LICENSE NO.
XXXXXXX

30"

SIGN SHALL BE LOCATED ON EXTERIOR OF THE FENCE GATE.

CASE #: SP-2011-0355CS
SUBMITTAL DATE: DECEMBER 29, 2011

1