

HISTORIC LANDMARK COMMISSION
APRIL 23, 2012
DEMOLITION AND RELOCATION PERMITS
HDP-2012-0101
4804 SHOALWOOD AVENUE

PROPOSAL

Demolish a ca. 1954 house.

ARCHITECTURE

One-story L-plan stone veneered frame ranch house with an integral garage, metal-framed multi-light casement windows, and a partial-width inset porch.

RESEARCH

The house was built in 1954 by Knox Kyler, the manager of a roofing company. Kyler had grown up in Arkansas, the son of the owner of a tin shop. By 1930, he and his wife Sally were living in Weslaco, Texas, where he was the superintendent for a roofing company. They built this house in 1954 and lived here until around 1960. The house was rented and then owned by Estelle Wolfe, a widow, until the early 1980s.

STAFF COMMENTS

The house does not appear in any city survey.

STAFF RECOMMENDATION

Encourage the applicant to consider rehabilitation and adaptive re-use of the house if its structural condition permits. The house is a good example of a mid-1950s sprawling ranch house with natural stone veneer, but does not warrant individual designation as a historic landmark. If rehabilitation and adaptive re-use are not feasible, staff recommends the completion of a City of Austin Documentation Package consisting of photographs of all four elevations, a dimensioned sketch plan, and a narrative history of the house for archiving at the Austin History Center, prior to release of any permit for removal of the structure.

LOCATION MAP

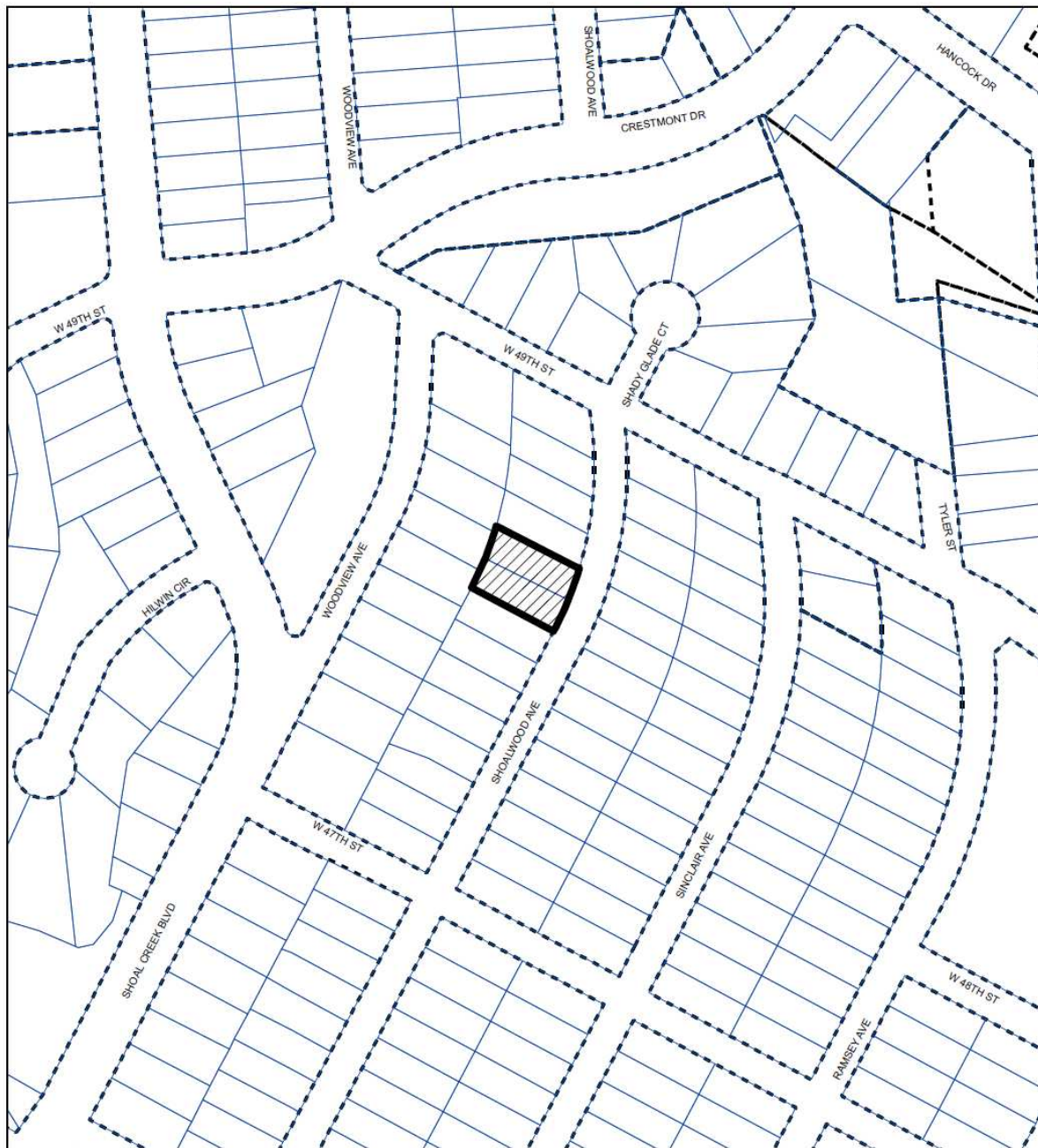

SUBJECT TRACT



ZONING BOUNDARY

CASE#: HDP-2012-0101
LOCATION: 4804 Shoalwood Avenue



This product is for informational purposes and may not have been prepared for or be suitable for legal, engineering, or surveying purposes. It does not represent an on-the-ground survey and represents only the approximate relative location of property boundaries.

This product has been produced by the Planning and Development Review Department for the sole purpose of geographic reference. No warranty is made by the City of Austin regarding specific accuracy or completeness.

4804 Shoalwood Avenue
ca. 1954



OCCUPANCY HISTORY 4804 Shoalwood Avenue

City Directory Research, Austin History Center
By City Historic Preservation Office
April, 2012

1992	Douglas Cunningham, renter No occupation listed NOTE: The directory indicates that Douglas Cunningham was a new resident at this address.
1985-86	Mark A. and Patricia Z. Wentworth, owners Physician, Austin Regional Clinic NOTE: The directory indicates that Mark A. and Patricia A. Wentworth were new residents at this address.
1981	Estelle Wolfe, owner No occupation listed
1977	Estelle Wolfe (not listed as owner) Widow, Jack Wolfe No occupation listed
1973	C.A. and Estelle Wolfe, renters Retired
1969	Jack and Estelle Wolfe, renters Retired
1963	Emery W. Nauert, owner NOTE: Emery Nauert is not listed in the directory. Also listed is Emogene S. Nauert, an accountant for the Veterans' Affairs Commission.
1958	E. Knox and Sallie C. Kyler, owners Manager, H.E. Little Company, sheet metal fabricators, roofers, 3500 E. 5 th Street. Also listed is Robert C. Kyler, a student.
1955	E. Knox and Sallie C. Kyler, owners Manager, Hamilton Roofing Company, 6225 Lamar Boulevard.
1952	The address is not listed in the directory.

Know. Kyler 4804 Shoalwood
 185 10 ~~and~~ ¹⁹ 11 30
 Rosedale H ts
 stone ven & frame res & carport attchd
 58005 9-3-54 11500/
 Logan Melton

5

Building permit to Knox Kyler for the construction of the house. Logan Melton is noted as the contractor (1954)

10 d 9

185

WATER SERVICE PERMIT

Austin, Texas

Received of L. MELTON E N^o 1805 Date 9-26-54

Address 4804 SHOALWOOD

Amount TWENTY \$ 20.00

Plumber I. H. MEISKAMP Size of Tap 3/4"

Date of Connection 9-24-54

Size of Tap Made 3/4"

Size Service Made 3/4"

Size Main Tapped 6" C.F.

From Front Prop. Line to Curb Cock 25'

From 5' Prop. Line to Curb Cock 29'

Location of Meter CURB

Type of Box 20 cu

Depth of Main in St. 3'

Depth of Service Line 2'

From Curb Cock to Tap on Main sew.

Checked by Engr. Dept. 10-5-54

No. Fittings	Size	Material
	Curb Cock	
	Elbow	
	St. Elbow	
	Bushing	
	Reducer	
3	Pipe	2 1/2" 3/4" C.F.
1	Lead Comp.	
1	Nipples	1/4"
1	Union	1/4"
1	Plug	
1	Tee	3/4" C.F.
1	Stop	3/4" ANGLE
1	Box	10 cu
1	Lid	
	Valves	
	Job No.	W 323502
	Req. No.	W 1000

INDEXED

Water service permit to L. Melton for this house (1954)

Receipt No. 2209f Application for Sewer Connection

N^o 2029-

Austin, Texas, 10-12 1954

To the Superintendent of Sanitary Sewer Division, City of Austin, Texas.

Sir:—

I hereby make application for sewer connection and instructions on premises owned by

L. Melton at 4804 Shoalwood Street,
further described as Lot 10 + 9 Block 30 Outlot _____ Division _____
subdivision Rosedale HTS Plat 195, which is to be used as a Residence

In this place there are to be installed 5 fixtures. Plumbing Permit No. 9645-a
I agree to pay the City of Austin, the regular ordinance charge.

Depth at Prop. Line 3 1/2

Sub-Out } 2' No/sec
Connected } (Location)

Date 10-26-54

By L. Swisher

NOTE: Connection Instruction 6' sewer @ SLT in SH A'ing
man 12.5' No/E R. Rock A-1357

Application for a sewer connection by L. Melton for the house at 4804 Shoalwood Avenue
(1954)

An addition was made to the house in 1985.

BIOGRAPHICAL NOTES:

Knox Kyler shows up as the 15-year old son of Hugh and Rosalie Kyler in the 1920 U.S. Census report. The family lived in Stuttgart, Arkansas, where Hugh Kyler was the owner of a tin shop. The 1930 U.S. Census shows Knox and Sally Kyler living in Weslaco, Texas. Knox was then 25 and had been born in Arkansas. He was the superintendent for a roofing company. Sally Kyler was then 26 and had also been born in Arkansas. She had no occupation listed. The couple had a young son and a young daughter. Knox Kyler died in Jefferson County, Texas in April, 1989.