

C21
1

SUBDIVISION REVIEW SHEET

CASE NO.: C8-2012-0077.0A

Z.A.P. DATE: 6-5-12

SUBDIVISION NAME: Wideman Subdivision; Resubdivision of lot 3

AREA: 0.3884

LOT(S): 2

OWNER/APPLICANT: Lisa Gray

AGENT: Lisa Gray

ADDRESS OF SUBDIVISION: 4708 BULL CREEK RD

GRIDS: MH27

COUNTY:

WATERSHED: Shoal Creek

JURISDICTION: Full Purpose

EXISTING ZONING:

MUD: N/A

NEIGHBORHOOD PLAN:

PROPOSED LAND USE: SF

ADMINISTRATIVE WAIVERS: None

VARIANCES: None

SIDEWALKS: Sidewalks will be provided on both sides of all internal streets and the subdivision side of boundary streets.

DEPARTMENT COMMENTS: The request is for approval of the Wideman Subdivision; Resubdivision of lot 3. The proposed plat is composed of 2 lots on 0.3884 acres.

STAFF RECOMMENDATION: The staff recommends disapproval of the plat. This plat does not meet all applicable State and City of Austin LDC requirements.

ZONING AND PLATTING ACTION:

Location Map

C21
2/2

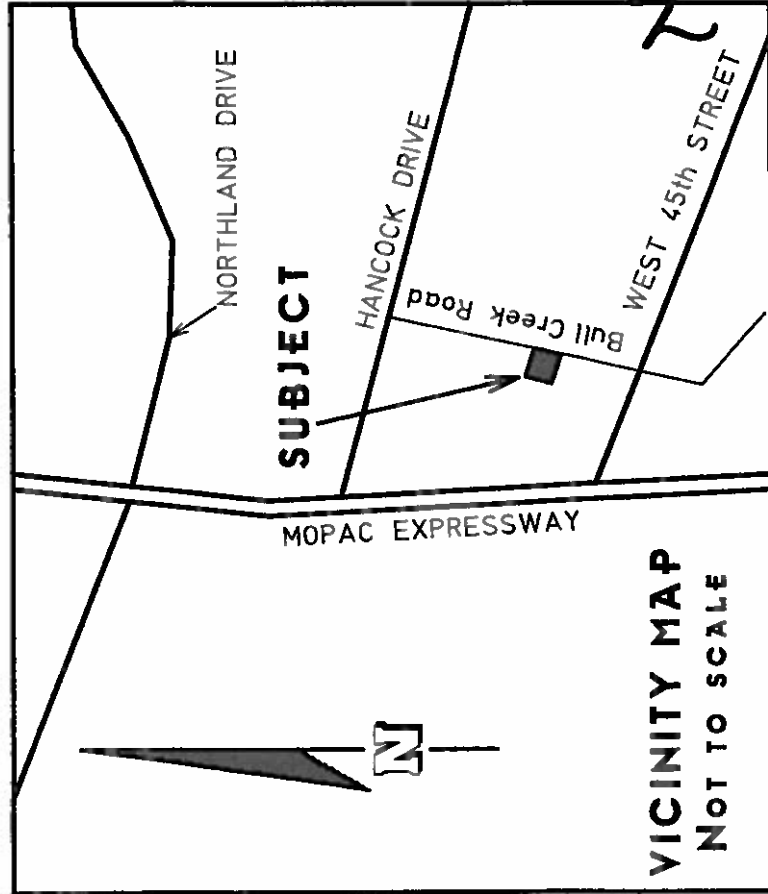

PAGE 2 of 2

895042.dgn

Zap 10768949