

**SUBDIVISION REVIEW SHEET**

C19  
1

**CASE NO.:** C8-2012-0096.0A

**P.C. DATE:** 7-10-12

**SUBDIVISION NAME:** Lady Bird Lake Village; Replat

**AREA:** 2.395

**LOT(S):** 1

**OWNER/APPLICANT:** 1620 East Riverside Drive, LLC  
(Marcy Phillips)

**AGENT:** Jacobs Engineering  
(Judd Willmann)

**ADDRESS OF SUBDIVISION:** 1620 E Riverside Dr

**GRIDS:** J20

**COUNTY:**

**WATERSHED:** Town Lake

**JURISDICTION:** Full Purpose

**EXISTING ZONING:**

**MUD:** N/A

**NEIGHBORHOOD PLAN:**

**PROPOSED LAND USE:** MF/RET

**ADMINISTRATIVE WAIVERS:** None

**VARIANCES:** None

**SIDEWALKS:** Sidewalks will be provided on both sides of all internal streets and the subdivision side of boundary streets.

**DEPARTMENT COMMENTS:** The request is for approval of the Lady Bird Lake Village; Replat. The proposed plat is composed of 1 lot on 2.395 acres.

**STAFF RECOMMENDATION:** The staff recommends disapproval of the plat. This plat does not meet all applicable State and City of Austin LDC requirements.

**PLANNING COMMISSION ACTION:**

#10784548-PC

© All Rights Reserved, Carter Burgess, Inc. 2007

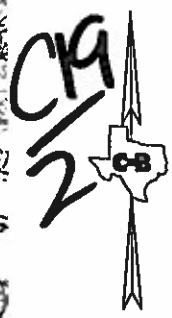
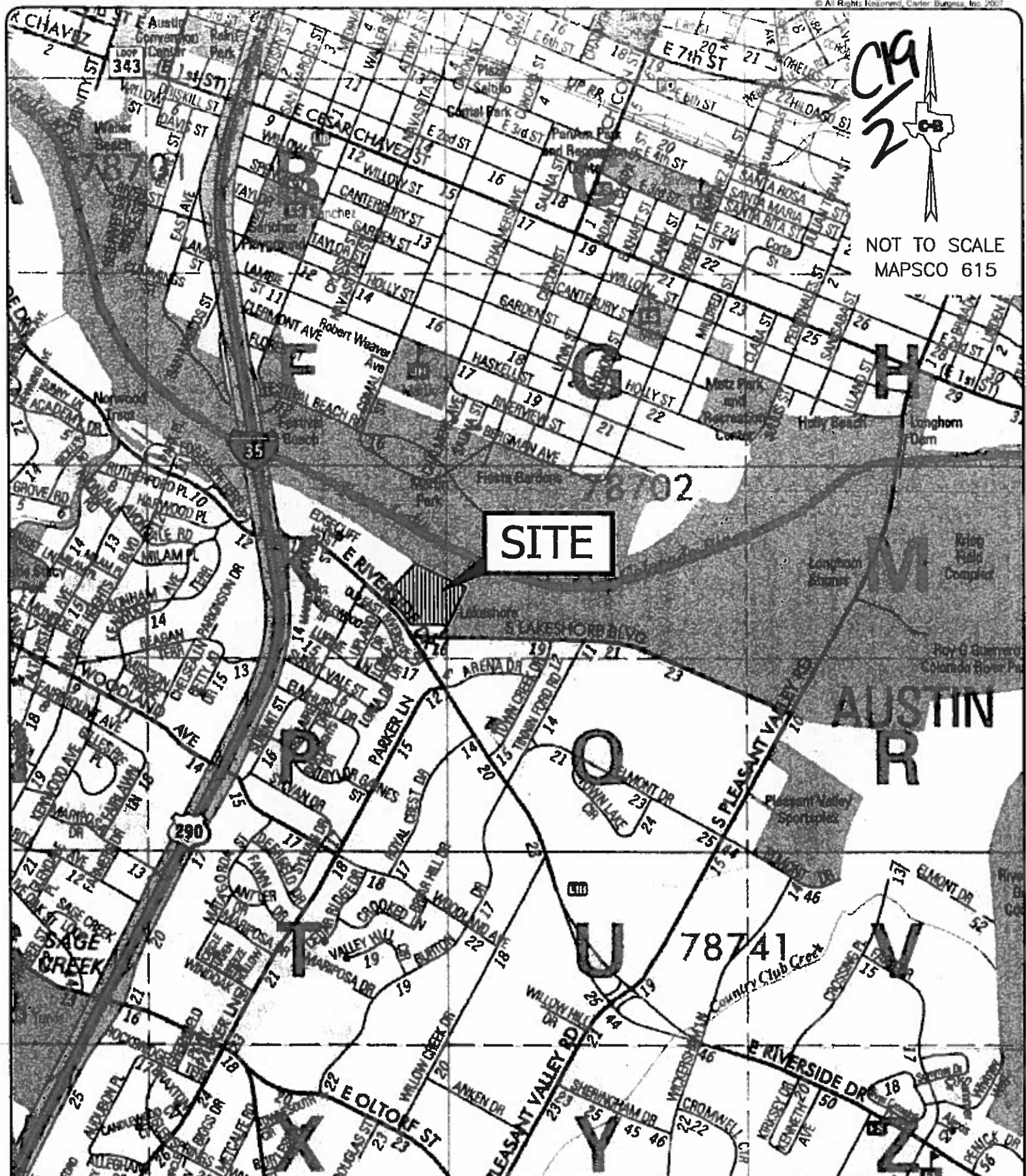

NOT TO SCALE  
MAPSCO 615

DATE: FEBRUARY 19, 2007  
DRAWN BY: C.T.  
DESIGNED BY: C.W.  
REVIEWED BY: C.W.  
C&B PROJECT NUM: 050872

AMLI RIVERSIDE CONDOMINIUMS  
RIVERSIDE AT S. LAKESHORE BLVD.  
AUSTIN, TEXAS

SITE  
LOCATION MAP

**Carter Burgess**  
Consultants in Engineering, Architecture,  
Construction Management and Related Services  
Carter and Burgess, Inc.  
2705 Bee Cave Road, Suite 300  
Austin, Texas 78746  
(512) 314-3100 Fax (512) 314-3135  
© COPYRIGHT 2007 Carter and Burgess, Inc.