

IRRIGATION NOTES

BUTLER SHORES TREE LIST

4123	HACKBERRY	16IN
1129	HACKBERRY	12IN/DAMAGE

IRRIGATION NOTES	
<p>The irrigation system shall be designed by a Texas licensed irrigation contractor. The Landscape Architect shall review the design prior to installation. The system shall comply with the following City of Austin criteria.</p>	
<p>SITE DEVELOPMENT PERMIT - IRRIGATION NOTES</p> <p>APPENDIX O:</p> <p>LANDSCAPE/IRRIGATION NOTES</p>	<p>Environmental Criteria Manual</p>
<p>Automatic irrigation systems shall comply with the following requirements. These requirements shall be noted on the Site Development Permit and shall be implemented as part of the landscape inspection:</p> <ol style="list-style-type: none"> 1. A new commercial and multi-family irrigation system must be designed and installed so that: 	

BUTLER SHORES TREE LIST	
1423	HACKBERRY 16IN
1129	HACKBERRY 12IN/DAMAGE
1130	HACKBERRY 14IN/DAMAGE
1131	HACKBERRY 14IN/DAMAGE
1136	HACKBERRY 22IN
1139	PAPER MULBERRY 9IN
1140	PAPER MULBERRY 9IN
1141	PAPER MULBERRY 9IN/8IN
1144	AMERICAN ELM 9IN/6IN
1145	AMERICAN ELM 16IN

BUTLER SHORES TREE LIST	
1423	HACKBERRY 16IN
1129	HACKBERRY 12IN/DAMAGE
1130	HACKBERRY 14IN8IN/DAM
1131	HACKBERRY 14IN8IN/DAM
1136	HACKBERRY 22IN
1139	PAPER MULBERRY 9IN
1140	PAPER MULBERRY 9IN
1141	PAPER MULBERRY 9IN8IN
1144	AMERICAN ELM 9IN6IN
1145	AMERICAN ELM 16IN
1173	PINE 12IN
1174	CHINBERRY 8IN8IN9IN

BUTLER SHORES TREE LIST	
1123	HACKBERRY 16IN
1129	HACKBERRY 12IN DAMAGE
1130	HACKBERRY 14IN8IN DAMAGE
1131	HACKBERRY 14IN8IN DAMAGE
1136	HACKBERRY 22IN
1139	PAPER MULBERRY 9IN
1140	PAPER MULBERRY 9IN
1141	PAPER MULBERRY 9IN8IN
1144	AMERICAN ELM 9IN6IN
1145	AMERICAN ELM 16IN
1173	PINE 12IN
1174	CHINABERRY 8IN8IN9IN
1175	HACKBERRY 7IN9IN

1. A new commercial and multi-family irrigation system must be designed and installed so that:
 - (a) there is not direct overspray onto non-irrigated areas;
 - (b) the system does not include spray/irrigation on areas less than six (6) feet wide (such as medians, buffer strips, and parking lot islands)
 - (c) above-ground irrigation emission devices are set back at least six (6) inches from impervious surfaces;
 - (d) the irrigation system has a meter valve;
 - (e) circular remote control valves have adjustable flow controls;
 - (f) serviceable in-head check valves are adjacent to paved areas where elevation differences may cause low head drainage;
 - (g) the irrigation system has a City-approved weather based controller;

- (iv) the average main stream velocity shall on the irrigation system automatically after not more than 6 one-half inch (1/2") rainfall;
- (i) zone valves and circuits are separated based on plant water requirements;
- (j) an irrigation emission device (such as spray, rotor, or drip emitter) does not exceed the manufacturer's

- (k) component of the irrigation system deviates from the manufacturer's recommended use of the product;
- (l) The maximum spacing between spray, or rotary sprinkler heads must not exceed the radius of flow of the nearest manufacturer of the sprinkler head specifically recommended a greater spacing. The radius determined by reference to the manufacturer's specifications for a specific nozzle at a specific operating pressure;
- (m) The irrigation installer shall develop and provide an as-built design plan and water budget to the City at the time the final punching inspection is performed. The water budget shall include:
 - (a) a chart containing zone numbers, precipitation rate, and gallons per minute; and

- (b) the location of the emergency irrigation system shut-off valve. A laminated copy of the water budget shall be permanently installed inside the irrigation controller door.
4. The irrigation installer shall provide a report to the City on a form provided by the Austin Water Utility Department certifying compliance with Subsection 1 when the final plumbing inspection is performed by the City.

1101	PECAN 29IN
1102	HACKBERRY 18IN
1103	CHINA BERRY 9IN
1104	HACKBERRY 20IN(DEAD)
1105	HACKBERRY 10IN
1106	HACKBERRY 18IN
1107	CHINA BERRY 9IN(7IN(7IN
1108	CHINA BERRY 9IN(7IN(0(DAMAGED)
1110	CHINA BERRY 7IN
1112	AMERICAN ELM 20IN
1114	HACKBERRY 14IN
1115	HACKBERRY 14IN(2IN
1116	CHINA BERRY 8IN
1117	CHINA BERRY 8IN
1118	CHINA BERRY 9IN
1119	HACKBERRY 12IN
1120	CHINA BERRY 9IN
1122	AMERICAN ELM 12IN(5IN
1124	HACKBERRY 18IN
1125	HACKBERRY 16IN(4IN
1126	ELM 9IN
1127	HACKBERRY 12IN
1128	HACKBERRY 14IN(6IN(0(DEAD)
1132	HACKBERRY 14IN(6IN(0(DAMAGED)
1133	HACKBERRY 18IN
1134	HACKBERRY 14IN(0(DEAD)
1135	HACKBERRY 26IN
1142	PAPER MULBERRY 5IN(4IN(3IN
1143	CHINA BERRY 8IN
1159	PALM TREE 14IN
1160	PECAN 14IN
1166	PECAN 17IN
1167	PECAN 25IN
2665	PECAN 45IN

LANDSCAPE CALCULATIONS PER P.A.R.D. AGREEMENT EFFECTIVE MARCH 2008

712 Congress Avenue, Suite 300
Austin, Texas 78701
(512) 480-0032 fax (512) 480-0617

FOR
TION

NOT FOR
STRUCTURE

W

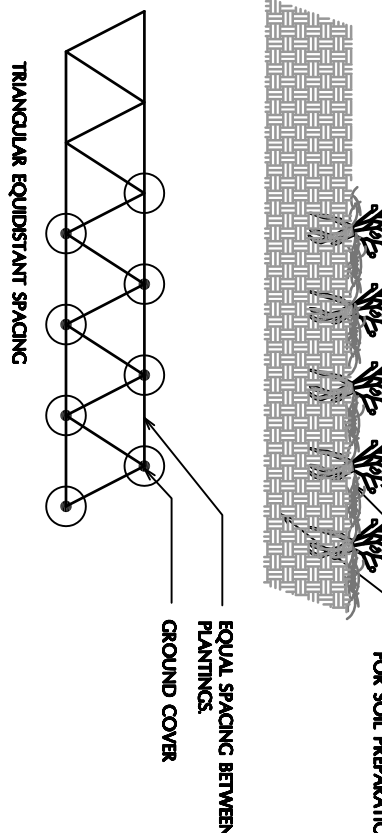

GROUND COVER

*A 2" LAYER OF CLEAN UNCOMPACTED DG MULCH MAY BE USED AS MULCH IN SELECT LOCATIONS.

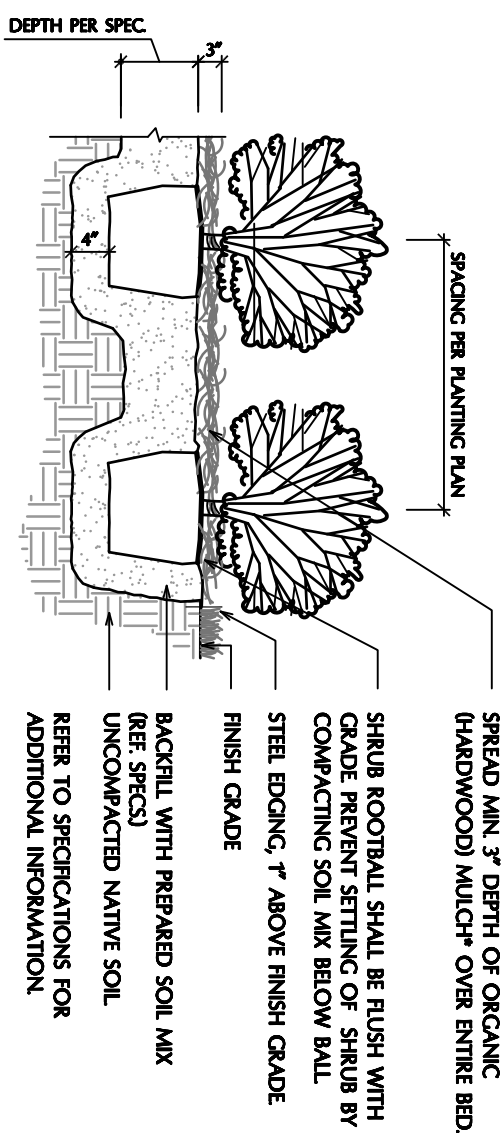

SHRUB BED PLANTING

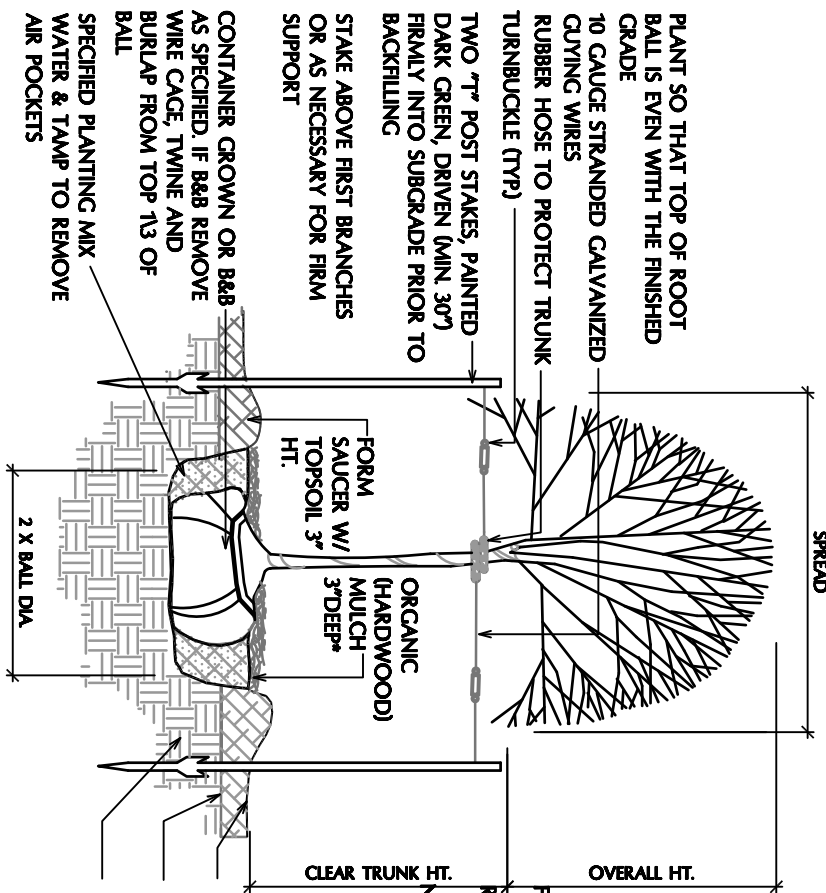

TREE PLANTING