

ORDINANCE NO. _____

1 AN ORDINANCE REZONING AND CHANGING THE ZONING MAP FOR THE
2 PROPERTY LOCATED AT 9310 GEORGIAN DRIVE IN THE GEORGIAN
3 ACRES NEIGHBORHOOD PLAN AREA FROM FAMILY RESIDENCE-
4 NEIGHBORHOOD PLAN (SF-3-NP) COMBINING DISTRICT TO
5 NEIGHBORHOOD COMMERCIAL-MIXED USE-CONDITIONAL OVERLAY-
6 NEIGHBORHOOD PLAN (LR-MU-CO-NP) COMBINING DISTRICT.
7

8 BE IT ORDAINED BY THE CITY COUNCIL OF THE CITY OF AUSTIN:
9

10 **PART 1.** The zoning map established by Section 25-2-191 of the City Code is amended to
11 change the base district from family residence-neighborhood plan (SF-3-NP) combining
12 district to neighborhood commercial-mixed use-conditional overlay-neighborhood plan
13 (LR-MU-CO-NP) combining district on the property described in Zoning Case No. C14-
14 2012-0101, on file at the Planning and Development Review Department, as follows:
15

16 Lot 1, Johnson Subdivision, a subdivision in the City of Austin, Travis County,
17 Texas, according to the map or plat of record in Plat Book 11, Page 31 of the Plat
18 Records of Travis County, Texas (the "Property"), SAVE AND EXCEPT being
19 out of and a part of Lot 1, Johnson Subdivision, a subdivision in the City of Austin,
20 Travis County, according to the map or plat of record in Volume 5081, Page 1276
21 and Volume 5814, Page 1573, of the Official Public Records of Travis County,
22 Texas,
23

24 locally known as 9310 Georgian Drive in the City of Austin, Travis County, Texas, and
25 generally identified in the map attached as Exhibit "A".
26

27 **PART 2.** Except as specifically provided in Part 3 and Part 4 of this ordinance, the
28 Property may be developed and used in accordance with the regulations established for the
29 neighborhood office (LR) base district and other applicable requirements of the City Code.
30

31 **PART 3.** The Property within the boundaries of the conditional overlay combining district
32 established by this ordinance is subject to the following conditions:
33

- 34 A. A site plan or building permit for the Property may not be approved, released,
35 or issued, if the completed development or uses of the Property, considered
36 cumulatively with all existing or previously authorized development and uses,
37 generate traffic that exceeds 500 trips per day.

- B. Residential treatment use and service station use are prohibited uses of the Property.
- C. Drive-in service use is prohibited as an accessory use to commercial uses.

Except as specifically restricted under this ordinance, the Property may be developed and used in accordance with the regulations established for the neighborhood office (LR) base district, the mixed use combining district and other applicable requirements of the City Code.

PART 4. The Property is subject to Ordinance No. 20100624-112 that established the Georgian Acres neighborhood plan combining district.

PART 5. This ordinance takes effect on _____, 2013.

PASSED AND APPROVED

www

, 2013

Lee Leffingwell
Mayor

APPROVED: _____ **ATTEST:** _____
 Karen M. Kennard Janette Goodall
 City Attorney City Clerk

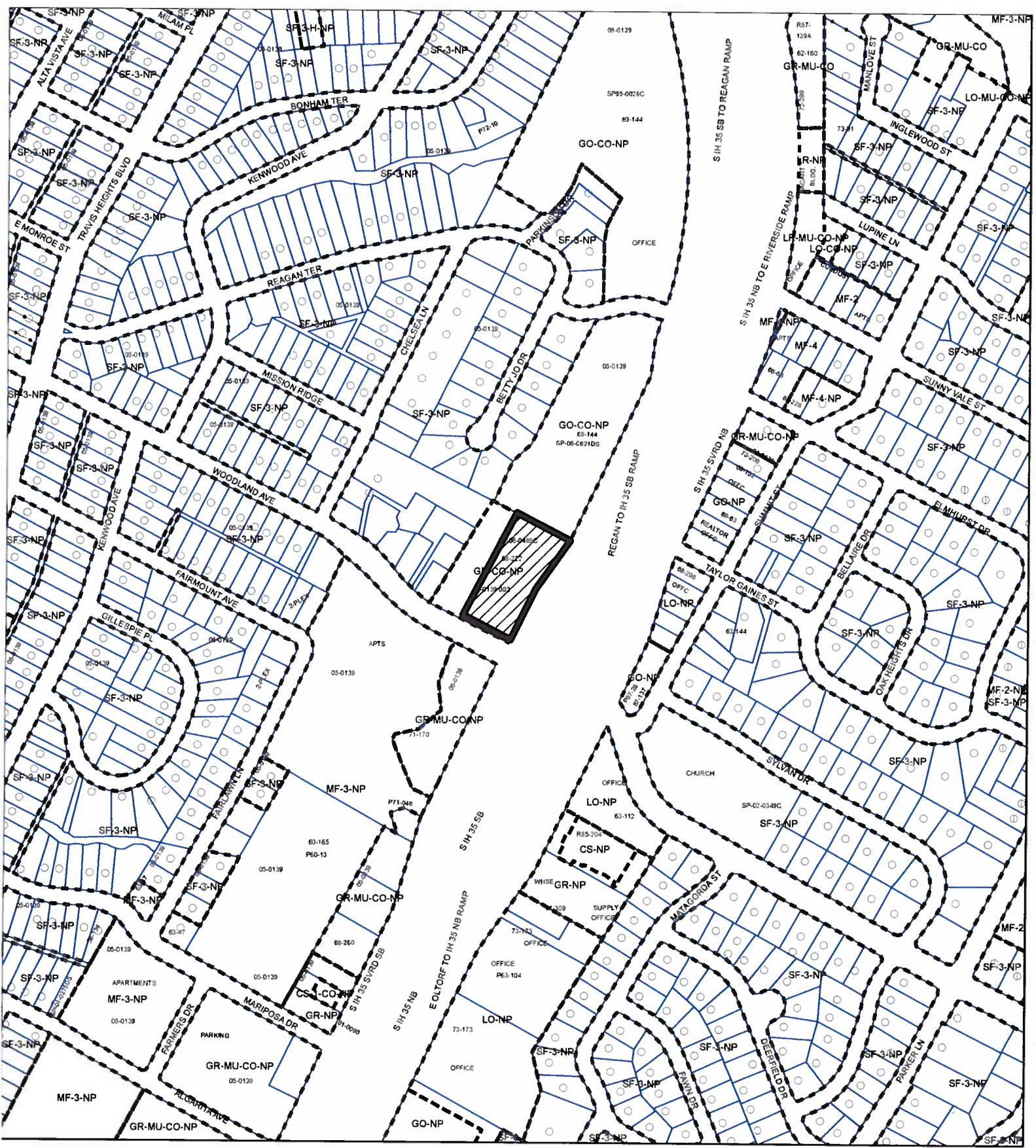





1" = 400'



SUBJECT TRACT



PENDING CASE



ZONING BOUNDARY

ZONING
ZONING CASE#: C14-2012-0100

This product is for informational purposes and may not have been prepared for or be suitable for legal, engineering, or surveying purposes. It does not represent an on-the-ground survey and represents only the approximate relative location of property boundaries.

This product has been produced by CTM for the sole purpose of geographic reference. No warranty is made by the City of Austin regarding specific accuracy or completeness.

