

09/1

SUBDIVISION REVIEW SHEET

CASE NO.: C8-2013-0065.0A

ZAP DATE: May 7, 2013

SUBDIVISION NAME: Arnold Subdivision at Walden Park, Replat of Lot 1

AREA: 1.317

LOT(S): 1

OWNER/APPLICANT: CBL Walden Park, LLC
(Kenneth Wittler)

AGENT: Bury & Partners, Inc.
(Jonathan Neslund)

ADDRESS OF SUBDIVISION: SH 45 EB

GRIDS: F39

COUNTY: Travis

WATERSHED: Lake Creek

JURISDICTION: Full-Purpose

EXISTING ZONING: N/A

MUD: N/A

NEIGHBORHOOD PLAN: N/A

PROPOSED LAND USE: Commercial

ADMINISTRATIVE WAIVERS:

VARIANCES: None

SIDEWALKS: Sidewalks will be provided on both sides of all internal streets and the subdivision side of boundary streets.

DEPARTMENT COMMENTS: The request is for approval of the Arnold Subdivision at Walden Park, Replat of Lot 1. The proposed plat is composed of 1 lot on 1.317 acres.

STAFF RECOMMENDATION: The staff recommends disapproval of the plat. This plat does not meet all applicable State and City of Austin LDC requirements.

PLANNING COMMISSION/ZONING AND PLATTING ACTION:

Kow Jot 10925984

ZAP

09/2

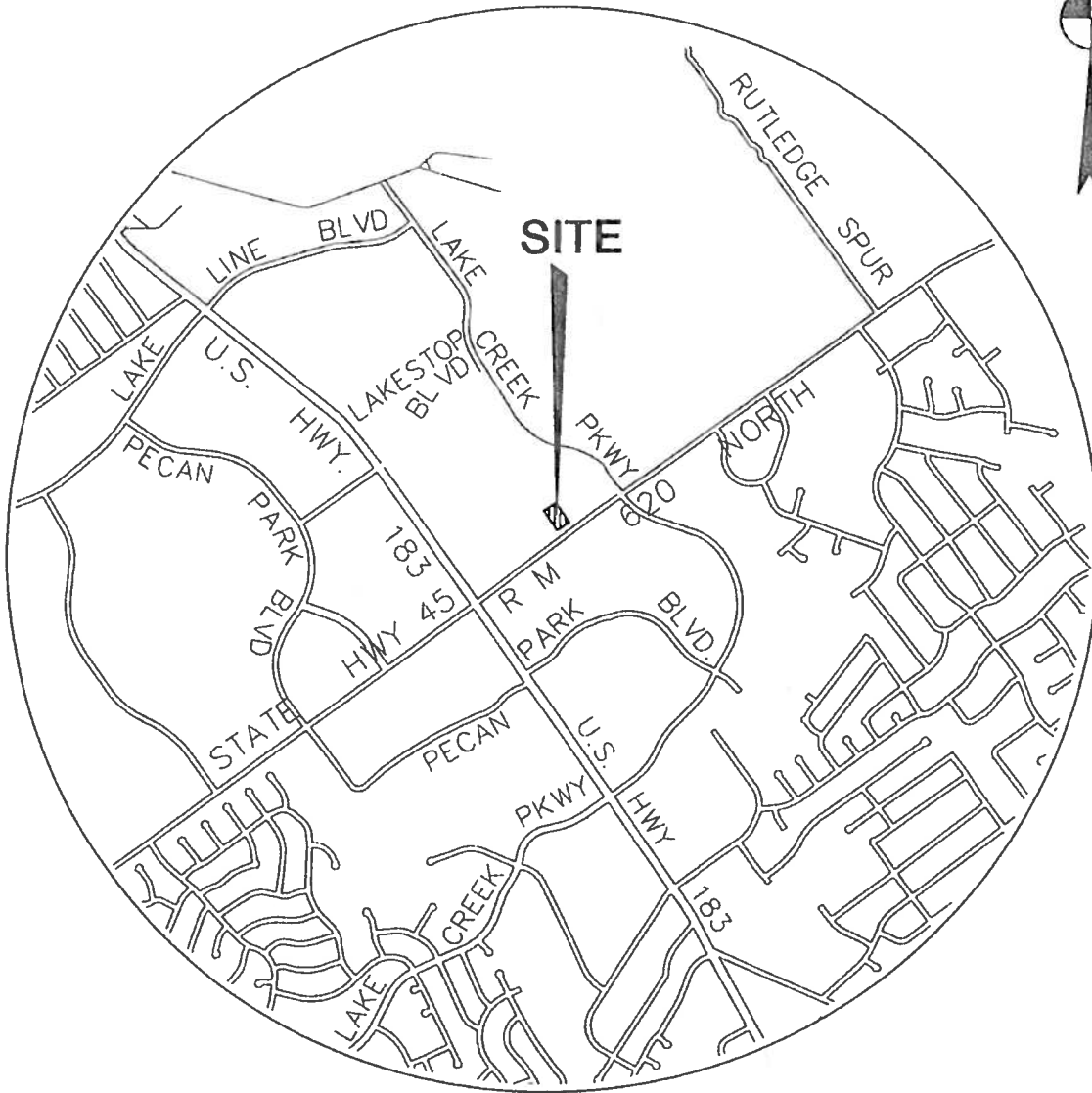

N.T.S.
GRID NUMBER: F39
MAPSCO PAGE: 433D

Bury+Partners
ENGINEERING SOLUTIONS
221 West Sixth Street, Suite 600
Austin, Texas 78701
Tel. (512)328-0011 Fax (512)328-0325
Bury+Partners, Inc. ©Copyright 2012

N. Lake Creek Pkwy & S. H. 45

REPLAT OF LOT 1, BLOCK A
THE ARNOLD SUBDIVISION AT
WALDEN PARK

SITE LOCATION MAP

DATE: 04/04/2013

DRAWN BY: AN

FILE: G:\100653\10002\EXH\VIC.DWG

PROJECT No.: 100653.10002