

SUBDIVISION REVIEW SHEET

C14
1

CASE NO.: C8J-06-0141.2A

Z.A.P. DATE: 8-6-13

SUBDIVISION NAME: Ridgeview Phase II

AREA: 31.857

LOT(S): 78

OWNER/APPLICANT: Ashton Austin Residential, LLC (Keith Pearson)

AGENT: LJA Engineering & Surveying, Inc. (Dan Ryan)

ADDRESS OF SUBDIVISION: SOUTH VIEW RD

GRIDS: A19

COUNTY:

WATERSHED: Slaughter/Williamson Creek

JURISDICTION: 2 Mile ETJ

EXISTING ZONING:

NEIGHBORHOOD PLAN:

PROPOSED LAND USE: SF, ROW, GRBL

ADMINISTRATIVE WAIVERS: None

VARIANCES: None

SIDEWALKS: Sidewalks will be provided on both sides of all internal streets and the subdivision side of boundary streets.

DEPARTMENT COMMENTS: The request is for approval of the Ridgeview Phase II. The proposed plat is composed of 78 lots on 31.857 acres.

STAFF RECOMMENDATION: The staff recommends disapproval of the plat. This plat does not meet all applicable State and City of Austin LDC requirements.

ZONING AND PLATTING ACTION:

ZAP

16979851

RIDGEVIEW PHASE II

C14 1/2

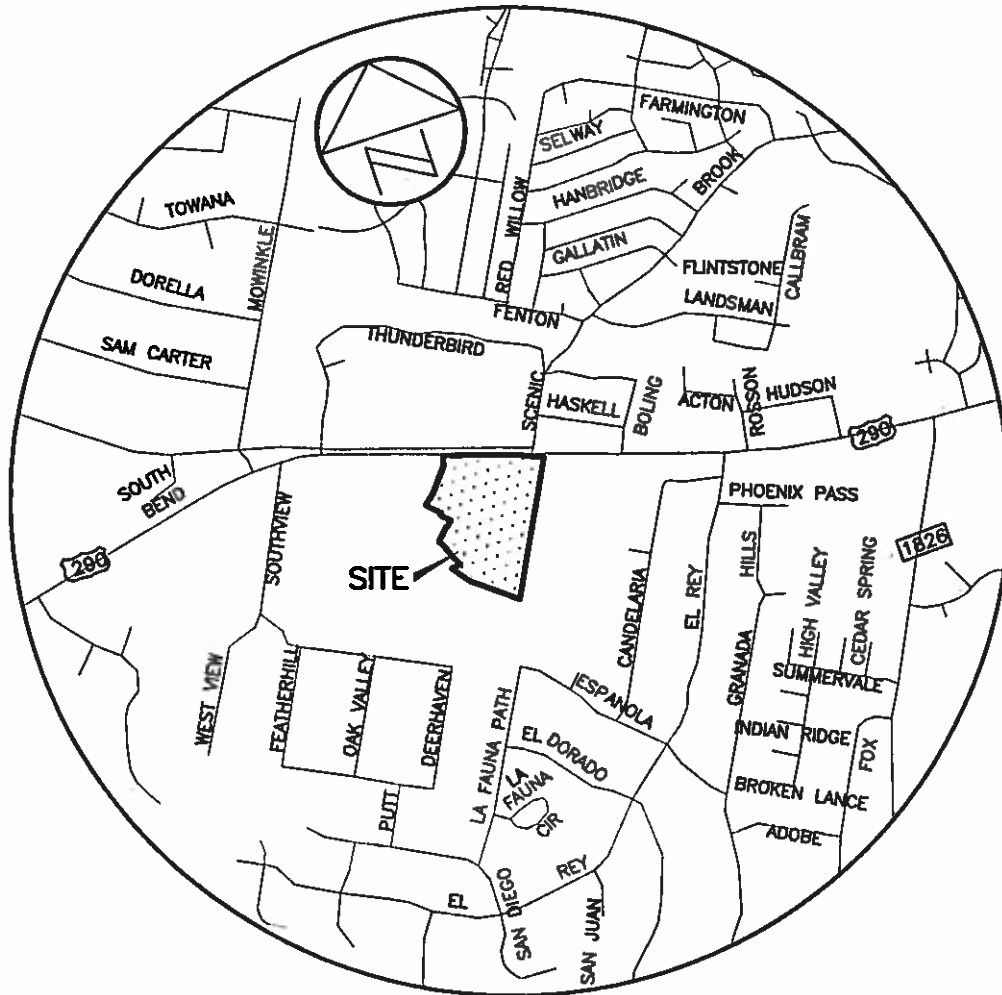

LOCATION MAP
NOT TO SCALE