

C16  
1

**SUBDIVISION REVIEW SHEET**

**CASE NO.:** C8-07-0043.02.3A

**ZAP DATE:** August 6, 2013

**SUBDIVISION NAME:** Avery Station Section 11-A

**AREA:** 29.817

**LOT(S):** 91

**OWNER/APPLICANT:** Northwoods Avery Ranch LLC  
(Gary L. Newman)

**AGENT:** Bury & Partners, Inc.  
(David Miller, P.E.)

**ADDRESS OF SUBDIVISION:** N Lakeline Blvd.

**GRIDS:** G40, G41

**COUNTY:** Travis

**WATERSHED:** South Brushy Creek

**JURISDICTION:** Full-Purpose

**EXISTING ZONING:** N/A

**MUD:** N/A

**NEIGHBORHOOD PLAN:** N/A

**PROPOSED LAND USE:** SF, GRBLT, ROW

**ADMINISTRATIVE WAIVERS:**

**VARIANCES:** None

**SIDEWALKS:** Sidewalks will be provided on both sides of all internal streets and the subdivision side of boundary streets.

**DEPARTMENT COMMENTS:** The request is for approval of the Avery Station Section 11-A. The proposed plat is composed of 91 lots on 29.817 acres.

**STAFF RECOMMENDATION:** The staff recommends disapproval of the plat. This plat does not meet all applicable State and City of Austin LDC requirements.

**PLANNING COMMISSION/ZONING AND PLATTING ACTION:**

C16  
2

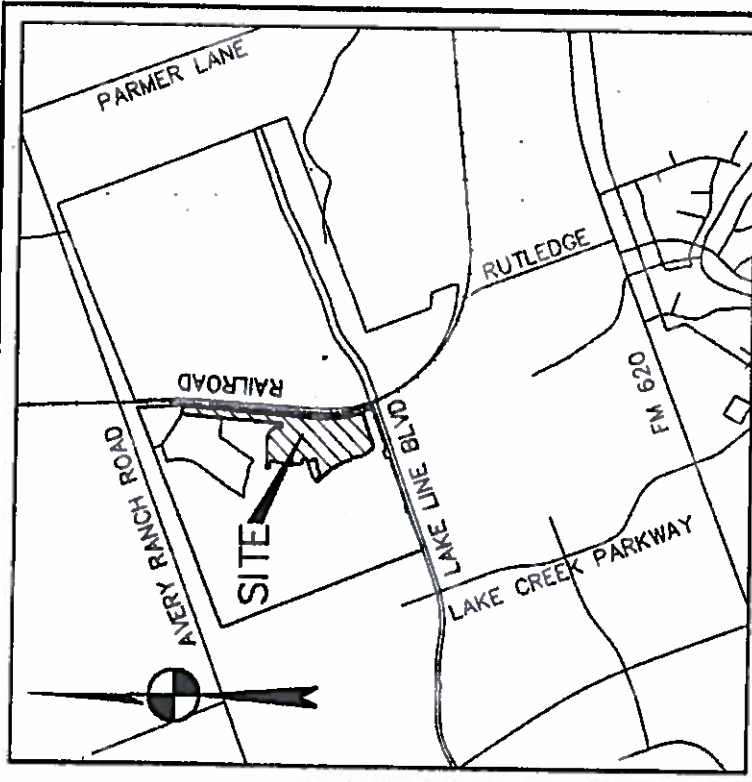

**VICINITY MAP**  
NOT TO SCALE

**LEGEND**

- 1/2" IRON ROD FOUND (UNLESS NOTED)
- 1/2" IRON ROD WITH YELLOW CAP
- ⊙ STAMPED "BURY+PARTNERS" SET
- ⊙ 1" IRON PIPE FOUND
- P.O.B. POINT OF BEGINNING
- ... SIDEWALK
- OS OPEN SPACE
- P PUBLIC UTILITY EASEMENT
- DUE DRAINAGE UTILITY EASEMENT

50 200

ZAP#10986323