

CITY OF AUSTIN DEVELOPMENT WEB MAP-1100 E 11TH STREET

Attachment 2

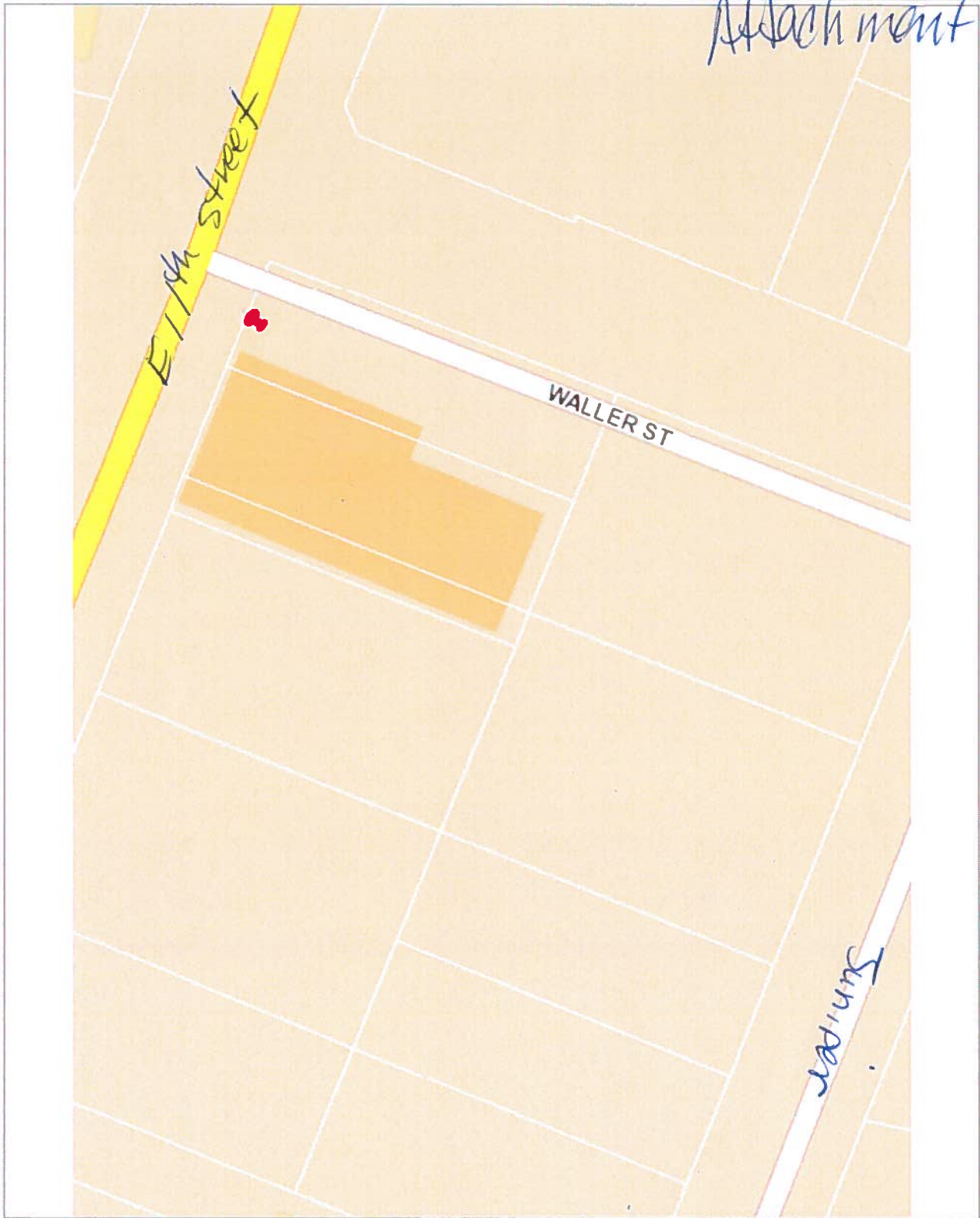

- Legend
- Lot Lines
 - Streets
 - Building Footprints
 - Named Creeks
 - Lakes and Rivers
 - Parks
 - County

THIS PRODUCT IS FOR INFORMATIONAL PURPOSES AND MAY NOT HAVE BEEN PREPARED FOR OR BE SUITABLE FOR LEGAL, ENGINEERING, OR SURVEYING PURPOSES. IT DOES NOT REPRESENT AN ON-THE-GROUND SURVEY AND REPRESENTS ONLY THE APPROXIMATE RELATIVE LOCATION OF PROPERTY BOUNDARIES. THIS PRODUCT HAS BEEN PRODUCED BY THE CITY OF AUSTIN FOR THE SOLE PURPOSE OF GEOGRAPHIC REFERENCE. NO WARRANTY IS MADE BY THE CITY OF AUSTIN REGARDING SPECIFIC ACCURACY OR COMPLETENESS.