

SUBDIVISION REVIEW SHEET

C29
1

CASE NO.: C8-2013-0146.0A

P.C. DATE: 9-24-13

SUBDIVISION NAME: RREEF Domain Block K Subdivision

AREA: 120.172

LOT(S): 2

OWNER/APPLICANT: RREEF Domain, LP
(Chad Marsh)

AGENT: Bury & Partners, INC.
(Nick Brown)

ADDRESS OF SUBDIVISION: 11824 BURNET RD

GRIDS: MK34

COUNTY:

WATERSHED: Walnut Creek

JURISDICTION: Full Purpose

EXISTING ZONING:

MUD: N/A

NEIGHBORHOOD PLAN:

PROPOSED LAND USE: Commercial

ADMINISTRATIVE WAIVERS: None

VARIANCES: None

SIDEWALKS: Sidewalks will be provided on both sides of all internal streets and the subdivision side of boundary streets.

DEPARTMENT COMMENTS: The request is for approval of the RREEF Domain Block K Subdivision. The proposed plat is composed of 2 lots on 120.172 acres.

STAFF RECOMMENDATION: The staff recommends disapproval of the plat. This plat does not meet all applicable State and City of Austin LDC requirements.

PLANNING COMMISSION ACTION:

C29
2

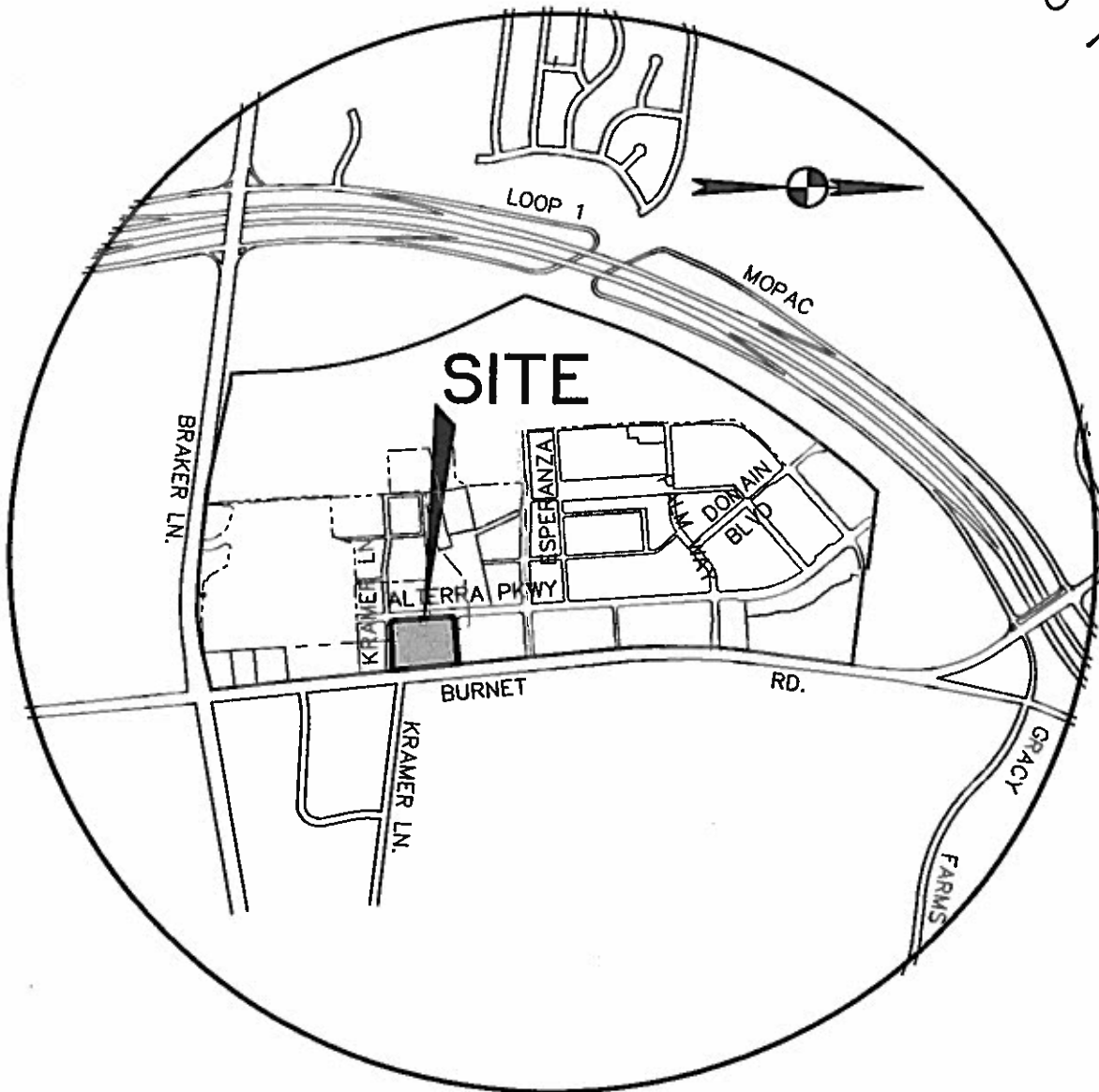

11012445

b Bury+Partners
ENGINEERING SOLUTIONS
221 West Sixth Street, Suite 800
Austin, Texas 78701
Tel. (512)328-0011 Fax (512)328-0325
TSP# Registration Number F-1048
Bury+Partners, Inc. © Copyright 2013

RREEF DOMAIN BLOCK K SUBDIVISION

RREEF DOMAIN LP.

LOCATION MAP

DATE: 07/30/2013

SCALE: N.T.S.

DRAWN BY: ENA

FILE: aue-nce-03\cad\100872\06\EXHIBITS

PROJECT No.: 10087210008