

RECAP OF PARKING CHANGES:

- A** NEW CONRAC UNDER CONSTRUCTION:  
ELIMINATES THE 742 SURFACE PARKING SPACES IN LOT A EAST
- B** NEW LOT J AND LOT G EXPANSION:  
1,714 ADDITIONAL SURFACE SPACES
- C** NEW PPP LOT UNDER PROCUREMENT:  
2,000 SURFACE SPACES TO BE BUILT IN A PUBLIC-PRIVATE PARTNERSHIP  
BETWEEN THE CITY OF AUSTIN AND A DEVELOPER TEAM  
NOTE: THERE ARE THREE POTENTIAL SITE FOR THIS PROJECT. THE SITE WILL BE  
DETERMINED AFTER COORDINATION BETWEEN DEVELOPMENT TEAM AND ABIA.
- D** LOT I REMOVAL:  
583 EMPLOYEE SURFACE SPACES REMOVED FROM INVENTORY TO  
ALLOW FOR GATE EXPANSION PLANS

PARKING COUNT	
LOT A WEST	1,061
LOT B	1,238
LOT C	1,482
LOT D	1,421
LOT E	534
LOT F	1,117
LOT G	1,403
LOT J	1,464
LOT I	0
SHORT TERM GARAGE	2,384
TOTAL:	12,104







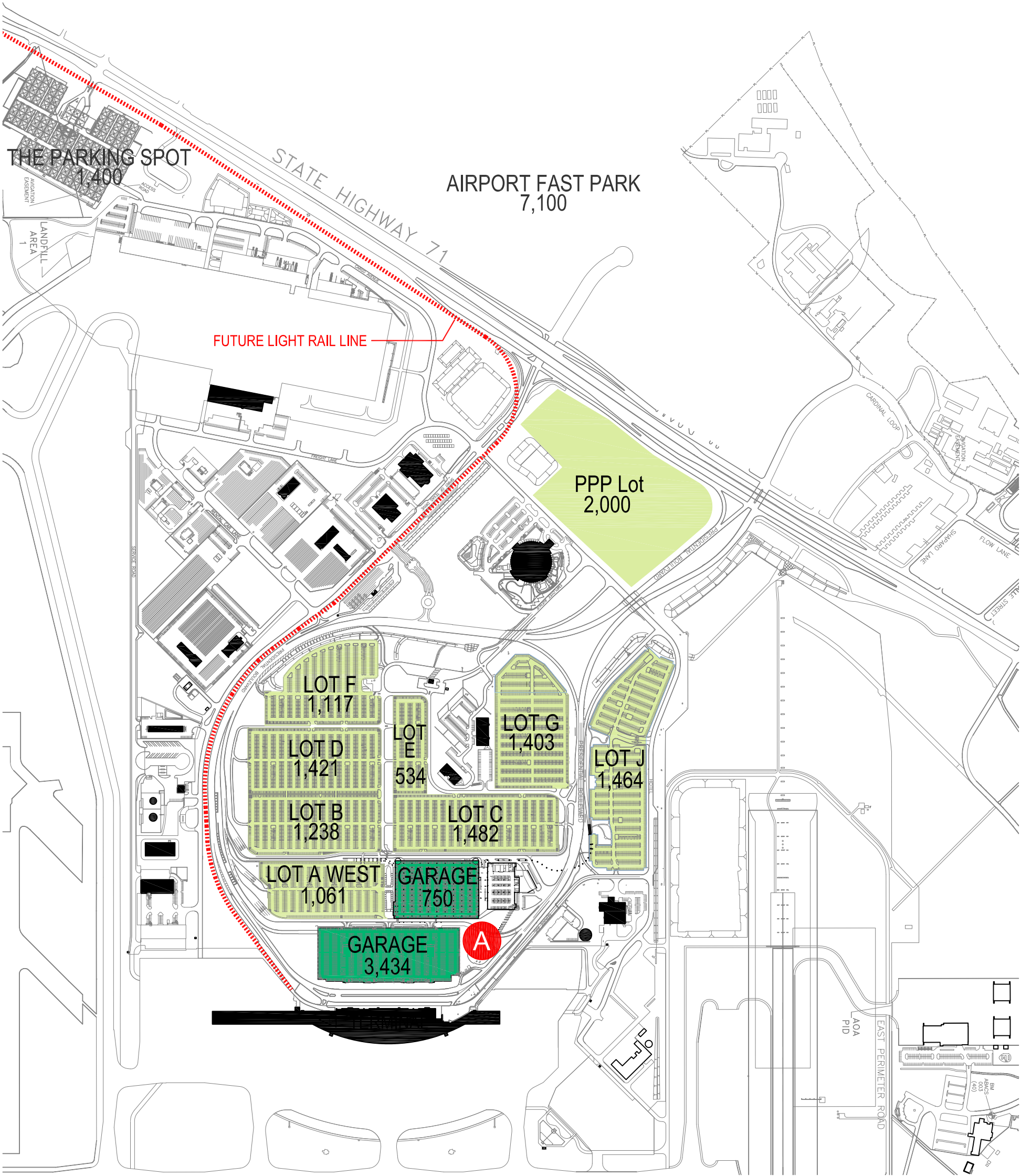

RECAP OF PARKING CHANGES:

**A** NEW CONRAC COMPLETE:  
1,800 SPACES ADDED TO ABIA GARAGE INVENTORY

PARKING COUNT	
LOT A WEST	1,061
LOT B	1,238
LOT C	1,482
LOT D	1,421
LOT E	534
LOT F	1,117
LOT G	1,403
LOT J	1,464
LOT I	0
PPP LOT	2,000
SHORT TERM GARAGE	4,184
TOTAL:	15,904



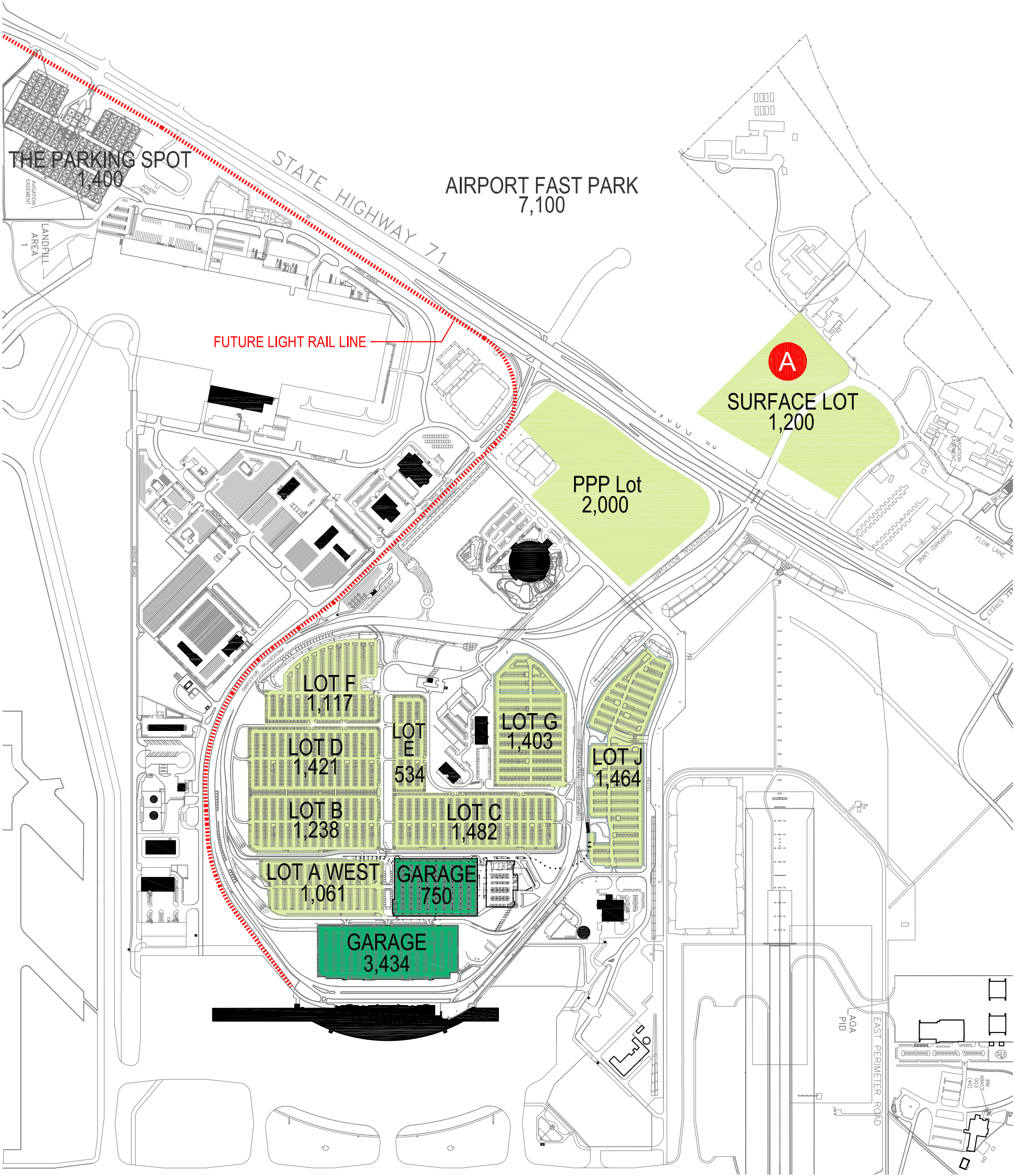

RECAP OF PARKING CHANGES:

**A** NEW SURFACE LOT:  
1,200 SPACES OF SURFACE SPACES CONSTRUCTED ON ABIA  
PROPERTY.

PARKING COUNT	
LOT A WEST	1,061
LOT B	1,238
LOT C	1,482
LOT D	1,421
LOT E	534
LOT F	1,117
LOT G	1,403
LOT J	1,464
LOT I	0
PPP LOT	2,000
SHORT TERM GARAGE	4,184
NEW SURFACE LOT	1,200
TOTAL:	17,104



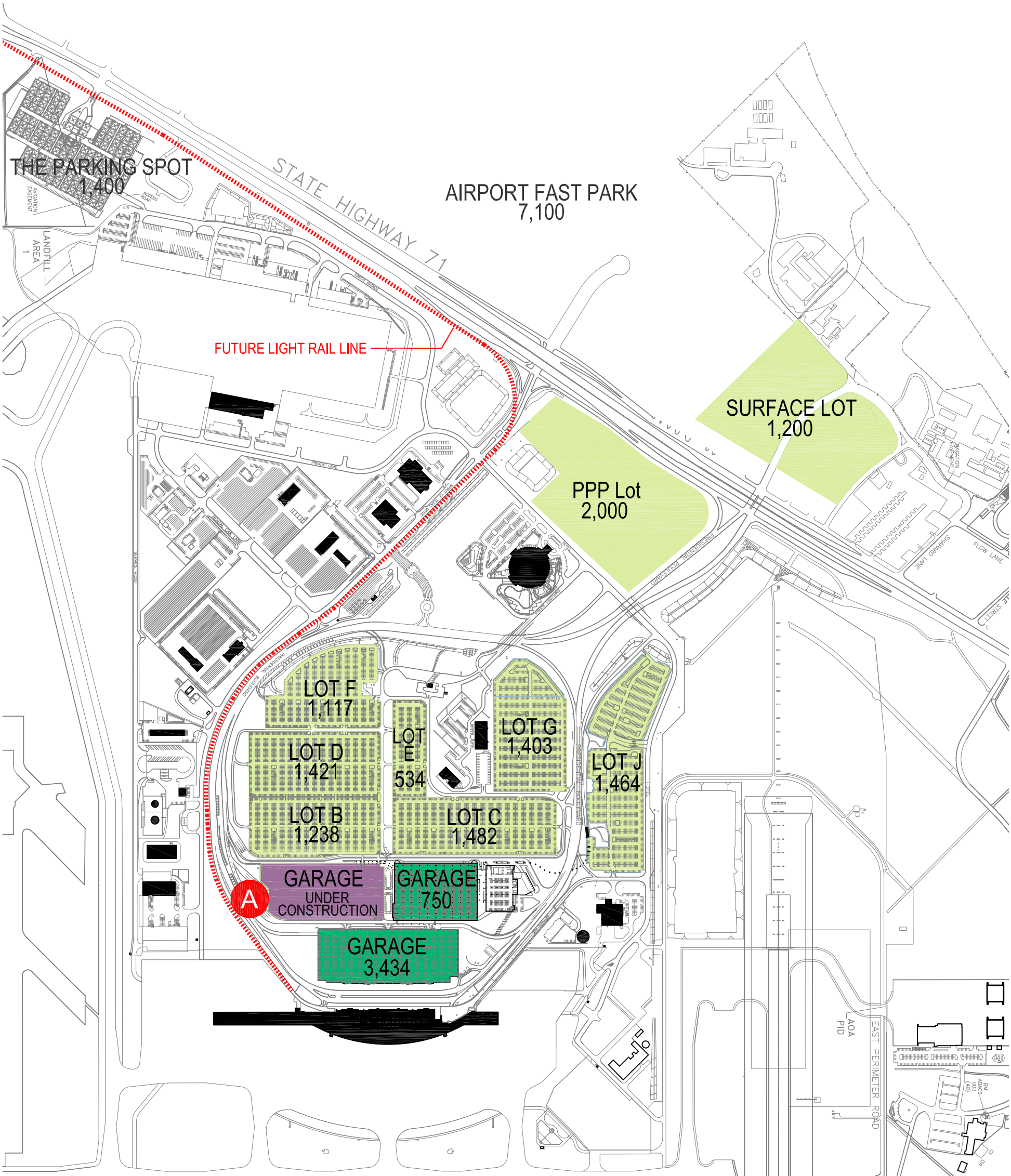

RECAP OF PARKING CHANGES:

**A** NEW SHORT TERM UNDER CONSTRUCTION:  
ELIMINATES THE 1,061 SURFACE PARKING SPACES IN LOT A WEST

PARKING COUNT	
LOT A WEST	0
LOT B	1,238
LOT C	1,482
LOT D	1,421
LOT E	534
LOT F	1,117
LOT G	1,403
LOT J	1,464
LOT I	0
PPP LOT	2,000
SHORT TERM GARAGE	4,184
NEW SURFACE LOT	1,200
TOTAL:	16,043



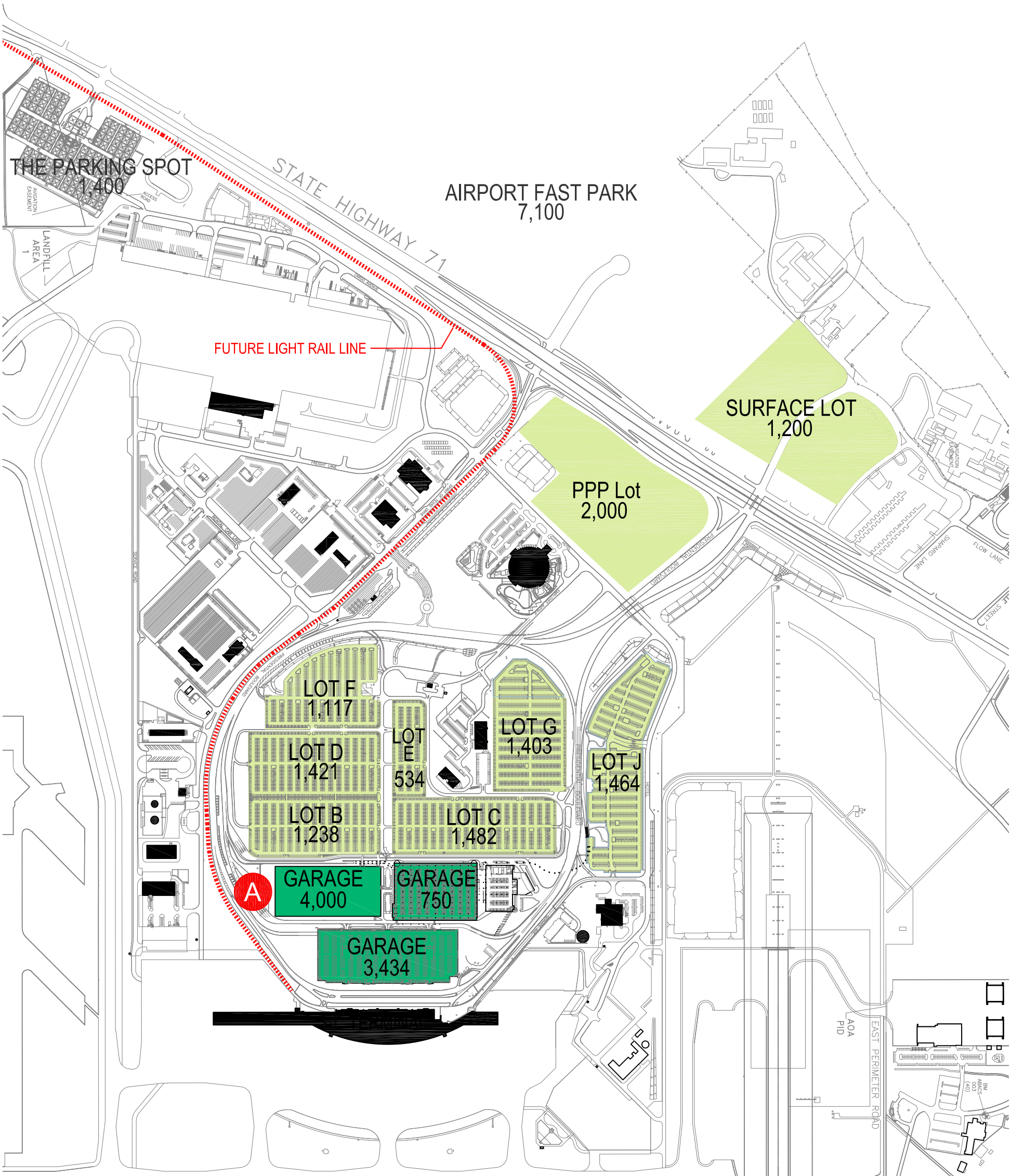

RECAP OF PARKING CHANGES:

- A

NEW SHORT TERM GARAGE COMPLETE:  
4,000 SPACE INCREASE TO GARAGE PARKING CAPACITY

PARKING COUNT	
LOT B	1,238
LOT C	1,482
LOT D	1,421
LOT E	534
LOT F	1,117
LOT G	1,403
LOT J	1,464
LOT I	0
PPP LOT	2,000
SHORT TERM GARAGE	4,184
NEW SURFACE LOT	1,200
NEW SHORT TERM GARAGE	4,000
TOTAL:	20,043



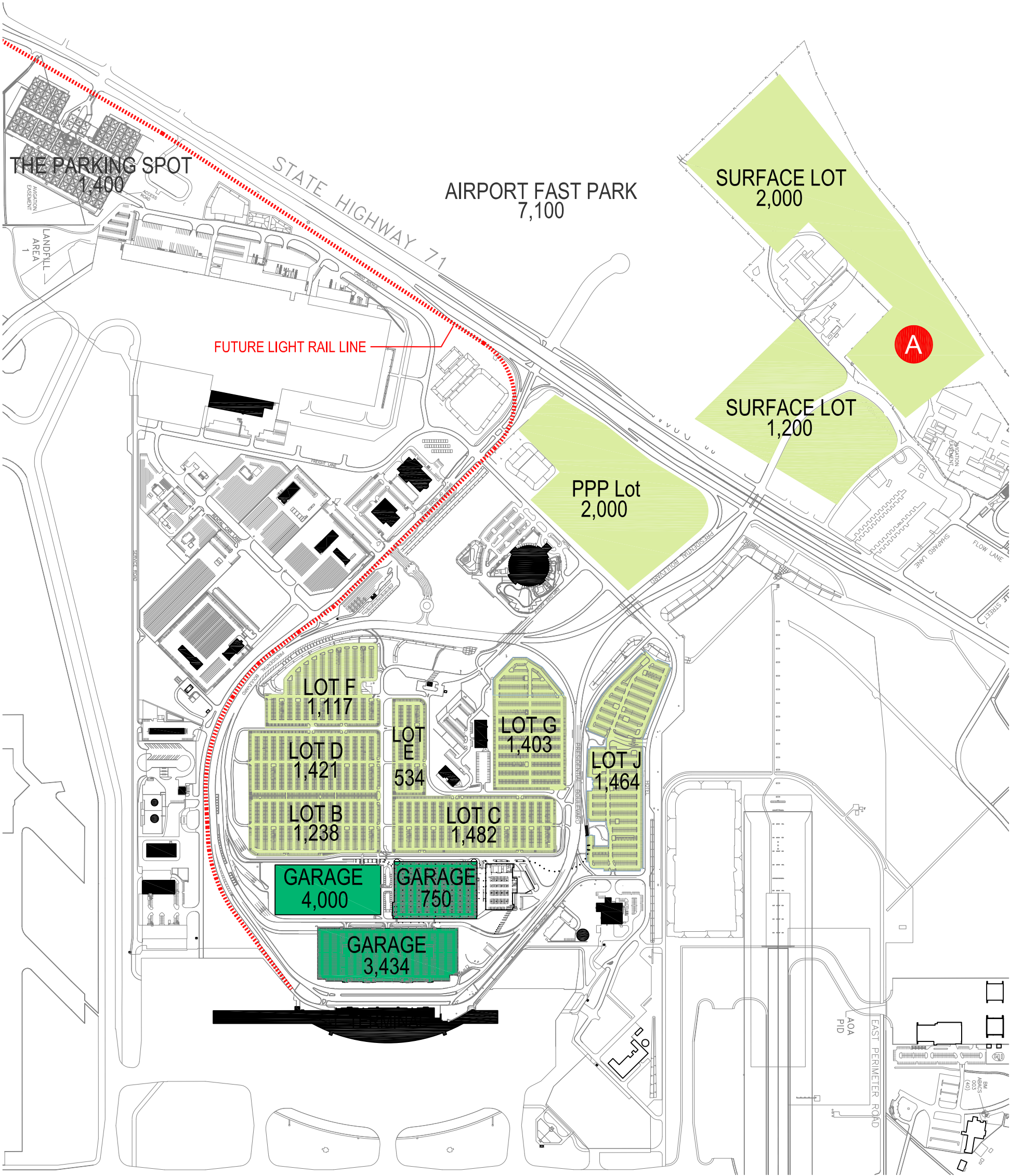

RECAP OF PARKING CHANGES:

- A

NEW SURFACE LOT:  
2,000 SPACES OF SURFACE SPACES CONSTRUCTED ON ABIA  
PROPERTY.

PARKING COUNT	
LOT B	1,238
LOT C	1,482
LOT D	1,421
LOT E	534
LOT F	1,117
LOT G	1,403
LOT J	1,464
LOT I	0
PPP LOT	2,000
SHORT TERM GARAGE	4,184
NEW SURFACE LOT	1,200
NEW SURFACE LOT	2,000
NEW SHORT TERM GARAGE	4,000
TOTAL:	22,043



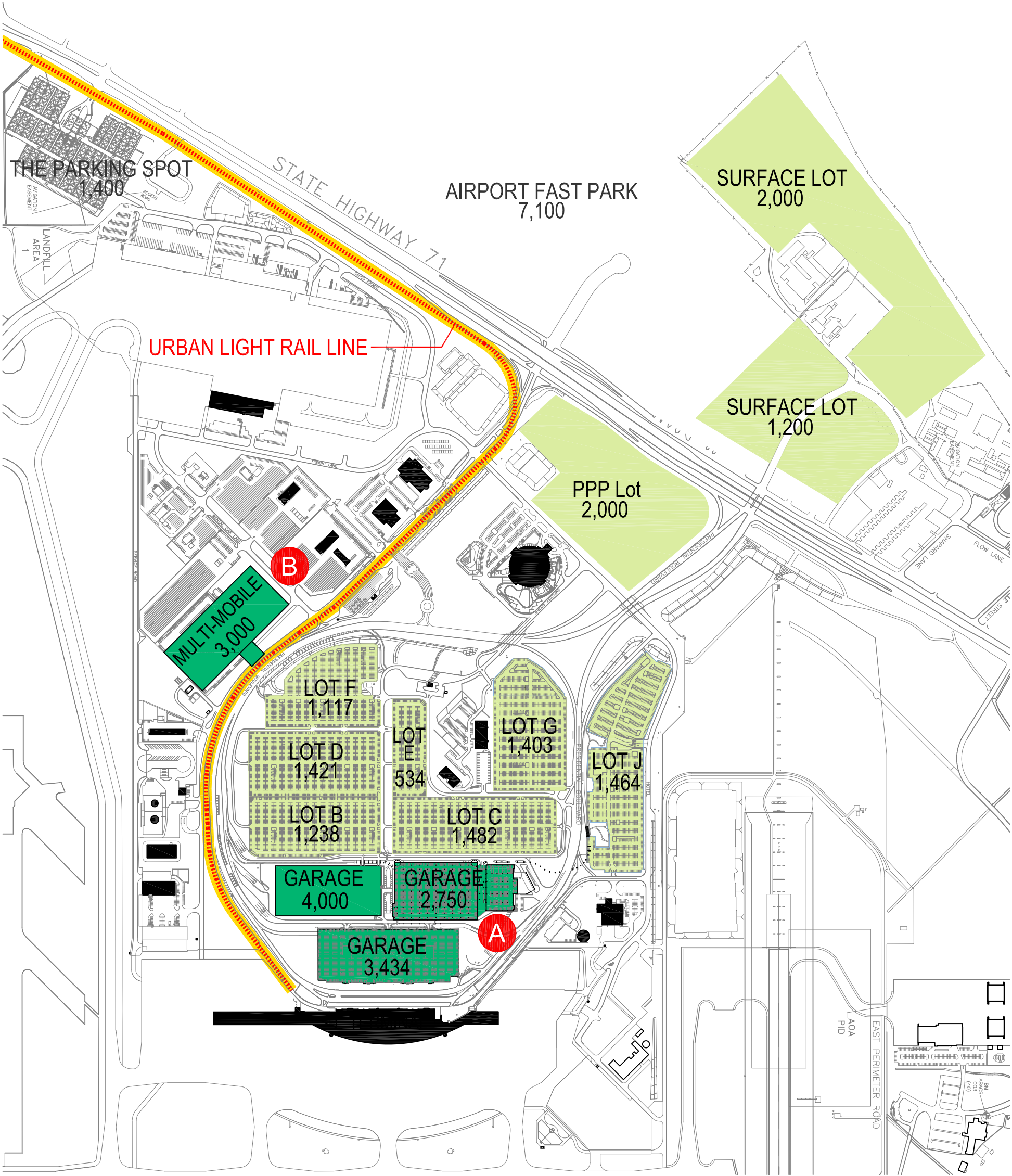

RECAP OF PARKING CHANGES:

- A** CONRAC CONVERSION GARAGE: 2,750 SPACES ADDED TO GARAGE INVENTORY BY CONVERTING RENTAL CAR PARKING AND OPERATION SPACE.
- B** NEW CONRAC & MULTI-MOBILE FACILITY: 3,000 SPACES ADDED TO GARAGE INVENTORY. THESE SPACES WOULD BE INTEGRATED INTO A NEW CONRAC FACILITY TO REPLACE THE EXISTING CONRAC NEAR THE TERMINAL (SEE PROJECT ABOVE). THE NEW FACILITY COULD POTENTIALLY CONNECT TO THE TERMINAL VIA AN URBAN RAIL LINE.

PARKING COUNT	
LOT B	1,238
LOT C	1,482
LOT D	1,421
LOT E	534
LOT F	1,117
LOT G	1,403
LOT J	1,464
LOT I	0
PPP LOT	2,000
SHORT TERM GARAGE	4,184
NEW SURFACE LOT	1,200
NEW SURFACE LOT	2,000
NEW SHORT TERM GARAGE	4,000
CONRAC CONVERSION GARAGE	2,750
NEW CONRAC & MULTI-MOBILE	3,000
TOTAL:	27,793