

A man with short brown hair, wearing a patterned short-sleeved shirt and brown trousers, is sitting in a blue folding chair on a grassy area. To his left is another empty blue folding chair. Behind them is a chain-link fence. To the left of the man, there is a wooden display board with several papers and a blue sign that reads "AUSTIN ART IN PUBLIC PLACES". A large white banner with black text is attached to the fence on the right. The background shows trees and a clear sky.

Barton Springs Grounds
Improvement AIPP project

Hawkeye Glenn

Mid Design Presentation

10.07.13

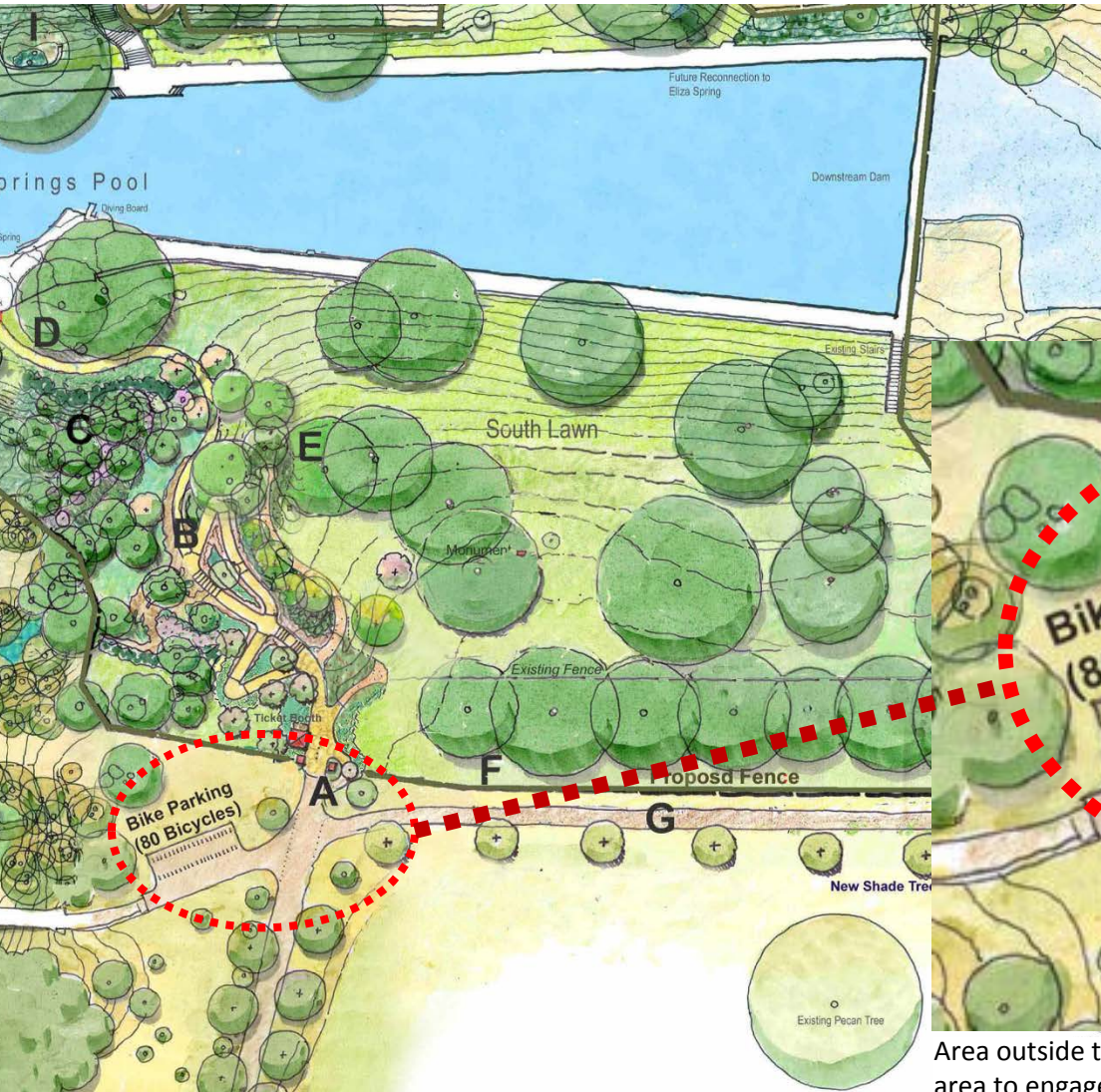

Area outside the south gate: the artist was free to select a location within this area to engage with his artwork.



That's
My ring
tone

Tokyo

TRUE

As unobtrusive
as possible, The
Spring IS the art.



↓
Ditto!



↑ 1 second/
third
that.

please make it
w/ natural materials

July 19-22.
AIPP and the artist held a 4 day event on the south side of Barton Springs to gather inspiration and comments regarding people's concerns/hopes/expectations/needs for artwork associated with the Barton Springs Grounds Improvement Project.

ent
IRINS

Narrative

Barton Springs Pool Grounds Improvement AIPP Project
Hawkeye Glenn

For this project, I am proposing to create a seating area with an incorporated art element.

The bench is made from native Texas pink granite with a native limestone base. The bench is to be built into the existing earth berm and anchored by native limestone to naturally integrate it into the site. Hopefully the artwork will be able to be sited so that a tree planned to be installed in the spring will provide shade for people sitting on the installation.

Mounted off-center on the bench is an ovalesque, metal form (possibly steel or copper), finished with porcelain enamel. The colors of the enamel reflect the joining of water and sky and earth. The form can be rotated when pushed gently. The shape of the spinning form is reflective of both a water carrier and water itself. When spun gently, the visitor has time to stop and reflect.

The act of turning creates a moment of connection with the piece - a meditation on water - and a moment of silence before entering a place that has been considered sacred by many people throughout time. A reminder of the preciousness of the springs.

Existing Tree - artist's work to be placed outside the CRZ.

native limestone integrated into existing berm

ADA compliant DG or paved dry laid stone path

New Tree, to be planted by others

12' long granite bench

30" enameled metal 'water carrier'



Site Plan

Place artwork so that the bench
can be in shade at least part of
the time

ADA compliant DG or paved dry
laid stone path

native limestone integrated into
existing berm

Existing berm on trail side of ball
fields

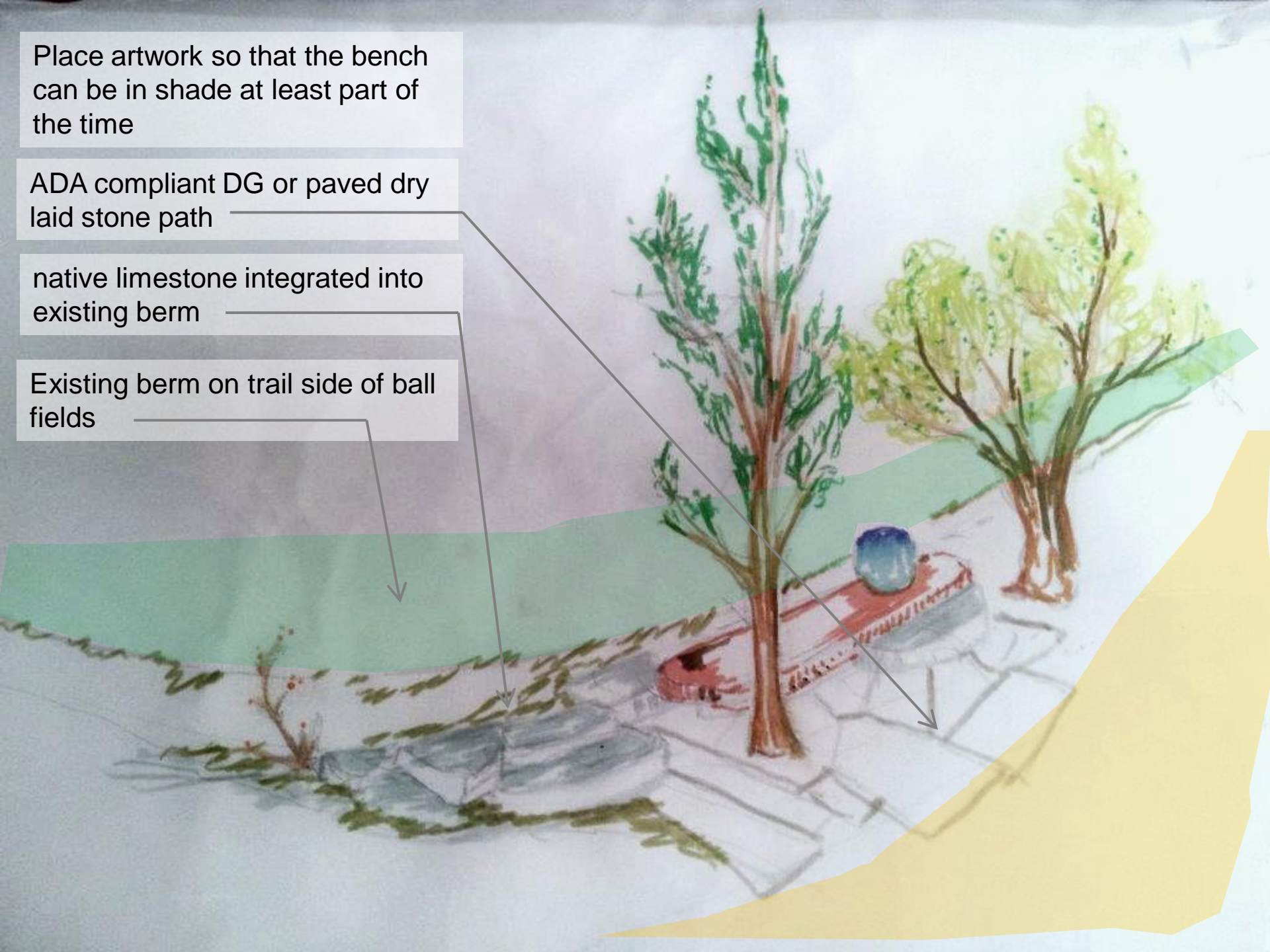

30" enameled metal 'water carrier' _____





Water Carrier

- Metal form (possibly steel or copper), finished with porcelain enamel.
- The colors of the enamel reflect the joining of water and sky and earth.
- The form can be rotated when pushed gently.
- The shape of the spinning form is reflective of both a water carrier and water itself.

The act of turning creates a moment of connection with the piece - a meditation on water - and a moment of silence before entering a place that has been considered sacred by many people throughout time.

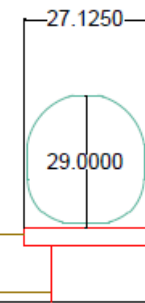
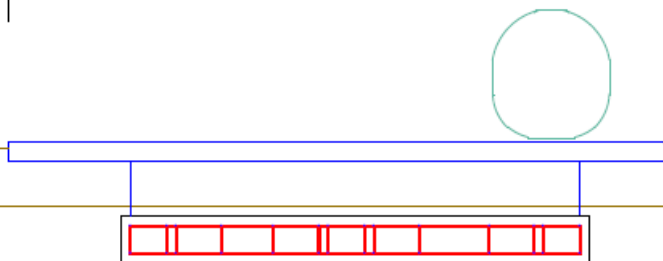
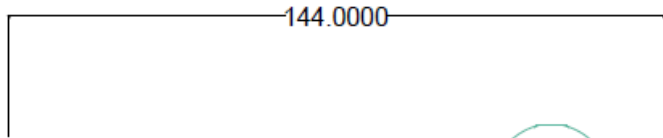

2.2439

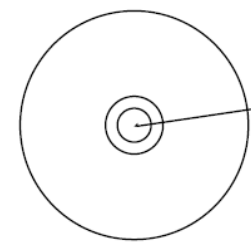
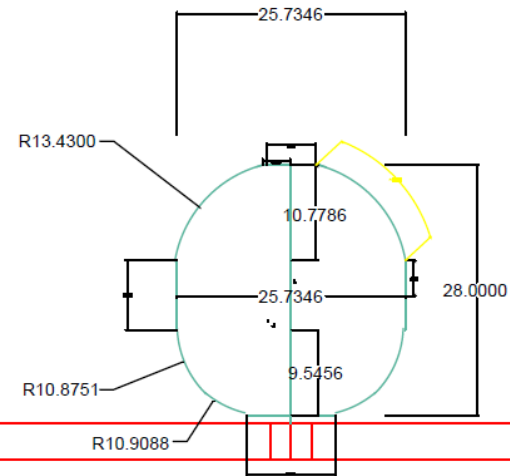
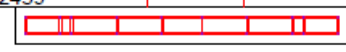

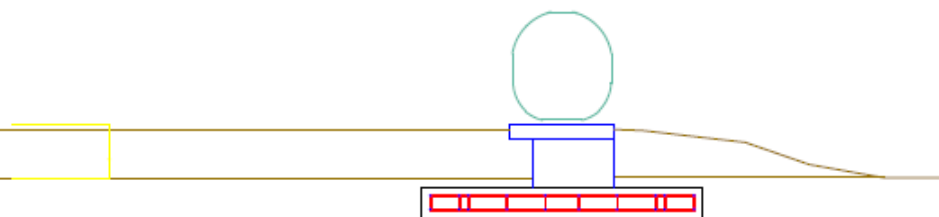
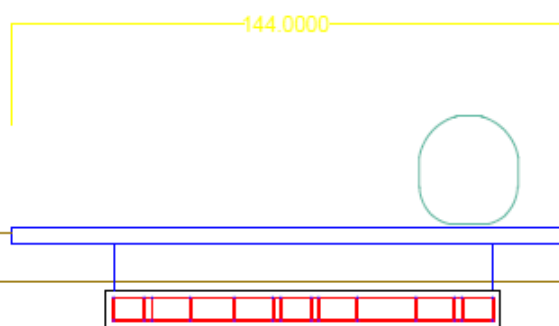
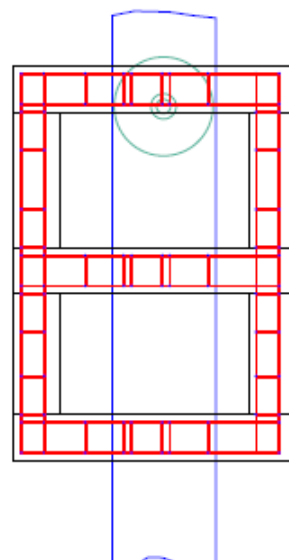
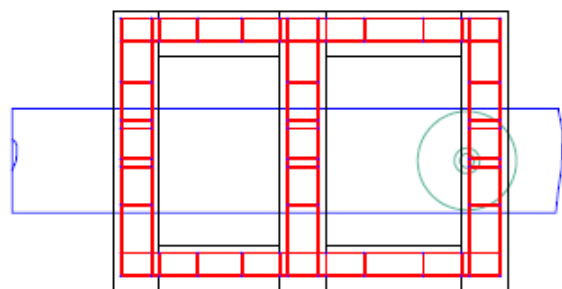

Travel Expense		\$	100.00	
Studio Overhead		\$	1,300.00	
Insurance		\$	800.00	
Labor + Materials	lime stone material	\$	200.00	
	granite material	\$	200.00	
	mortar	\$	50.00	
	Tree, by PARD	\$	-	
	Fabrication Labor	\$	3,300.00	
				Option 2 copper
"Water Carrier"		Option 1 steel		
Cost for material	Option 1 Alloy 424 (enamelling steel) OR 1018 cold rolled steel	\$	1,000.00	
	Copper Option 2			
Metal spinning	Forming (make 4) - Steel Option 1	\$	2,960.00	
	Forming (make 1) - Copper Option			
Color finish	Porcelain enameling	\$	1,000.00	
	Travel + artist time	\$	2,000.00	
Transportation	Shipping to studio	\$	400.00	
	Finished work to site	\$	300.00	
	Site Prep (construction fence around work area)	\$	100.00	
Installation	Equipment rental (SkyTrak)*	\$	1,200.00	
	Concrete foundation, installation by PARD contractor	\$	3,500.00	
	Installation Labor	\$	3,000.00	
20% Artist fee	To include engineering documentation/stamp and Registered Accessibility Review	\$	5,000.00	
Total		\$	26,410.00	

Project Budget = \$26,500
Contract Amendment No. 1 - Add'l.
design services \$1300

Schedule – *subject to change*

October 7, 2013 - AIPP Panel meeting - Hawkeye meets with the AIPP Panel for mid-design review.

Schedule for review by boards and commissions:

Send out mid-design for review by permitting bodies:

- Texas Historic Commission Archaeological District (Elizabeth Brumette).
- Historic Landmark Commission -Certificate of Appropriateness Committee (Historic Landmarks Advisory Review Nat'l Registry) (Alyson McGee)

October 28 - Present mid design work to the Joint Committee (Parks Board and Environmental Board)

November 18 - Present final design work to Land and Facilities Committee

December 10 - Present final design work to Parks and Recreation Board

MEMO - Urban Forestry Board

MEMO - Waterfront Planning Advisory Board

Site Plan permit modification. Work with Robin Camp, Public Works project manager.

January 6, 2013 - Final design approval from AIPP Panel

January 20, 2013 - Arts Commission.

January to March 2014 – Fabrication.

March/April 2014. Installation during final phase of construction; time so that the contractor can handle any concrete work needed for the artwork foundation.