

C23
/1

SUBDIVISION REVIEW SHEET

CASE NO.: C8J-2013-0192

Z.A.P. DATE: November 5, 2013

SUBDIVISION NAME: Braker Valley

AREA: 164.05 acres

LOT(S): 422

OWNER/APPLICANT: Williams, Ltd.
(Evan Williams)

AGENT: Carlson, Brigance &
Doering, Inc.
(Geoff Guerrero)

ADDRESS OF SUBDIVISION: 11317 Cameron Rd

GRIDS: P30

COUNTY: Travis

WATERSHED: Walnut Creek

JURISDICTION: 2-Mile ETJ

EXISTING ZONING: N/A

MUD: N/A

NEIGHBORHOOD PLAN: N/A

PROPOSED LAND USE: Single Family

ADMINISTRATIVE WAIVERS: None

VARIANCES: None

SIDEWALKS: Sidewalks will be provided on both sides of all internal streets and the subdivision side of boundary streets.

DEPARTMENT COMMENTS: The request is for approval of the Braker Valley. The proposed plat is composed of 422 lots on 164.05 acres.

STAFF RECOMMENDATION: The staff recommends disapproval of the plat. This plat does not meet all applicable State and City of Austin LDC requirements.

PLANNING COMMISSION / ZONING AND PLATTING ACTION:

C23
/2

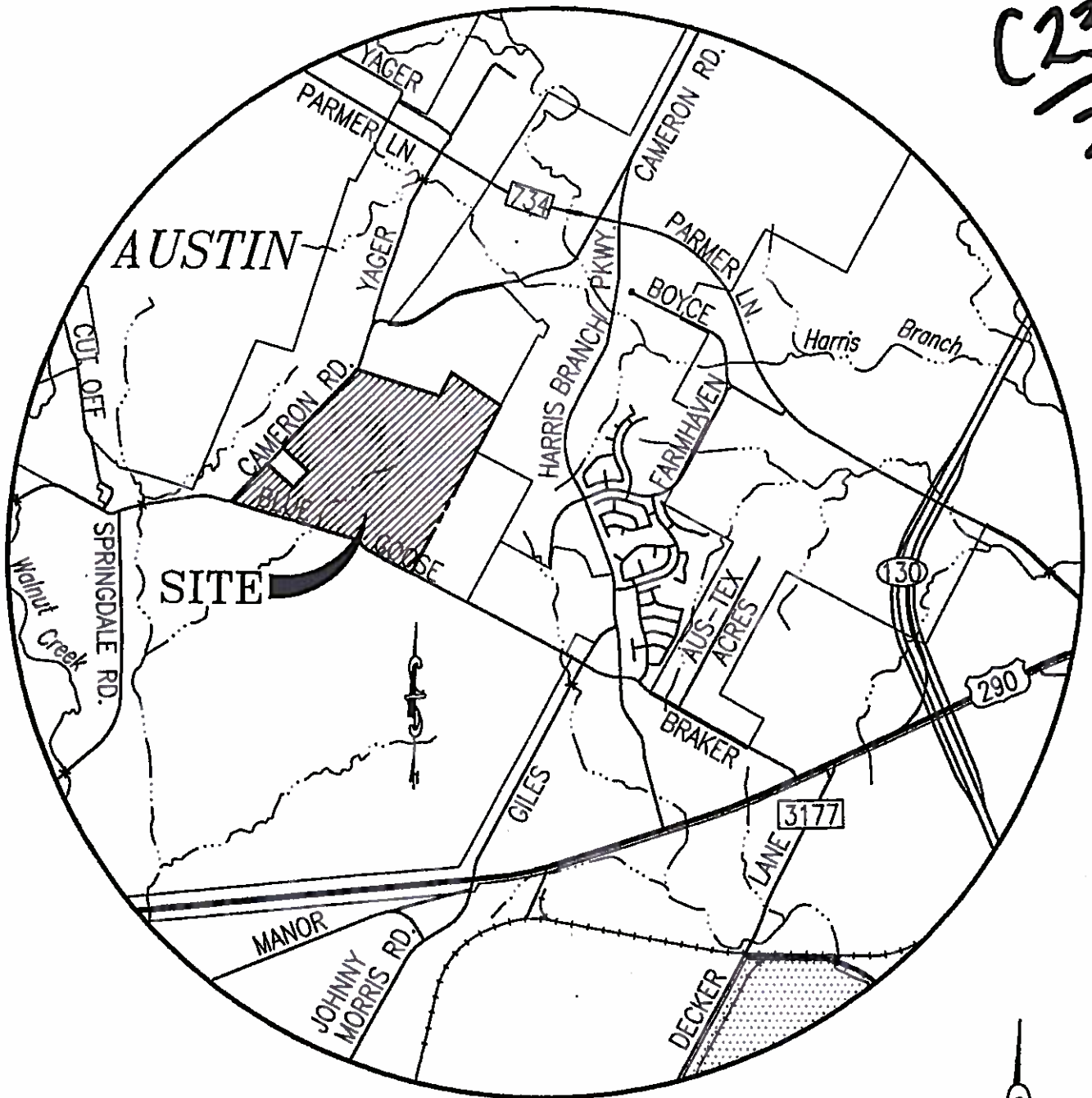

PRELIMINARY PLAN

BRAKER VALLEY

LOCATION MAP

SCALE: 1" = 3000'

MAPSCO BOOK PAGES 527-528

ZAP

11039220

	Carlson, Brigance & Doering, Inc.	
	Civil Engineering 5501 West Wilkes Canyon Drive Phone No. (512) 280-5160	Surveying Austin, Texas 78749 Fax No. (512) 280-5165