

C15
/

SUBDIVISION REVIEW SHEET

CASE NO.: C8J-2013-0224

ZAP DATE: 01/07/14

SUBDIVISION NAME: Whisper Valley, Village 1

AREA: 80.15

LOT(S): 258

OWNER/APPLICANT: Club Deal 120 Whisper Valley TX **AGENT:** Bury + Partners
(Douglas Gilliland) (Paulo Misi, P.E.)

ADDRESS OF SUBDIVISION: N FM 973 Rd.

GRIDS: MQ20

COUNTY: Travis

WATERSHED: Gilleland Creek

JURISDICTION: Limited-Purpose

EXISTING ZONING: PUD

MUD: N/A

NEIGHBORHOOD PLAN: N/A

PROPOSED LAND USE: SF

ADMINISTRATIVE WAIVERS:

VARIANCES: None

SIDEWALKS: Sidewalks will be provided on both sides of all internal streets and the subdivision side of boundary streets.

DEPARTMENT COMMENTS: The request is for approval of the Whisper Valley, Village 1 . The proposed plat is composed of 258 lots on 80.15 acres.

STAFF RECOMMENDATION: The staff recommends disapproval of the plat. This plat does not meet all applicable State and City of Austin LDC requirements.

PLANNING COMMISSION / ZONING AND PLATTING ACTION:

C15
2

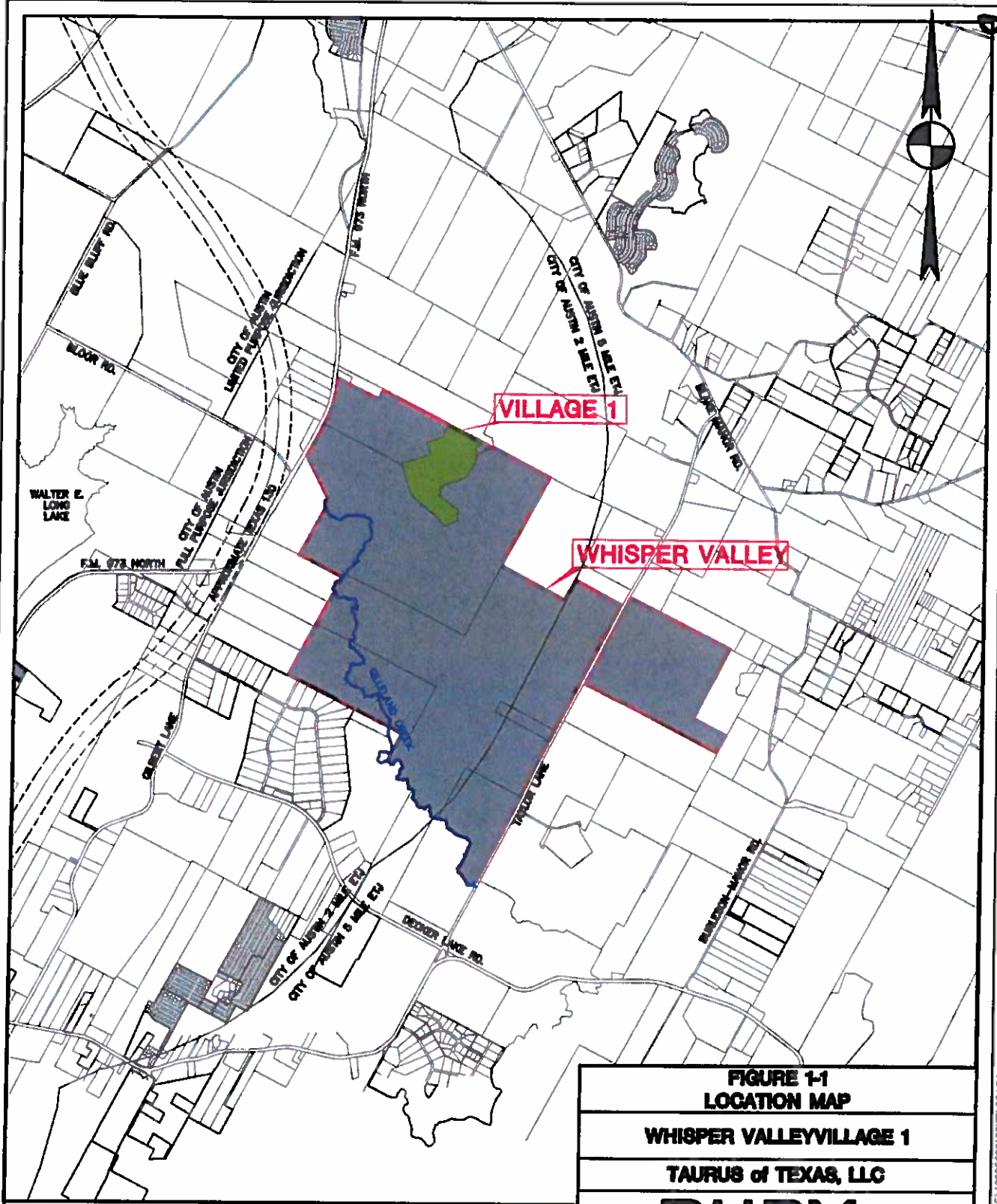

FIGURE 1-1 LOCATION MAP
WHISPER VALLEY VILLAGE 1
TAURUS of TEXAS, LLC
BURY
221 West Sixth Street, Suite 600 Austin, Texas 78701 Tel. (512) 328-0011 Fax (512) 328-0325 TBPE # F-1048 T0PLS # F-10107500 Copyright © 2013

#71062314 ZAP