

SUBDIVISION REVIEW SHEET

C15/1

CASE NO.: C8J-2014-0006.0A

ZAP DATE: 1/21/14

SUBDIVISION NAME: Austin Christian Faith Center

AREA: 47.156

LOT(S): 2

OWNER/APPLICANT: Austin Christian Faith Center
(D.R. Dickey)

AGENT: Garrett-Ihnen Civil
(Steve Ihnen)

ADDRESS OF SUBDIVISION: Shoreline Drive

GRIDS: L38

COUNTY: Travis

WATERSHED: Walnut Creek

JURISDICTION: 2-Mile ETJ

EXISTING ZONING: Church

MUD: N/A

NEIGHBORHOOD PLAN: N/A

PROPOSED LAND USE: School, Religious Assemble, Public/Quasi-Public

ADMINISTRATIVE WAIVERS:

VARIANCES: None

SIDEWALKS: Sidewalks will be provided on both sides of all internal streets and the subdivision side of boundary streets.

DEPARTMENT COMMENTS: The request is for approval of the Austin Christian Faith Center. The proposed plat is composed of 47.156 lots on 2 acres.

STAFF RECOMMENDATION: The staff recommends disapproval of the plat. This plat does not meet all applicable State and City of Austin LDC requirements.

PLANNING COMMISSION / ZONING AND PLATTING ACTION:

CL 15/2

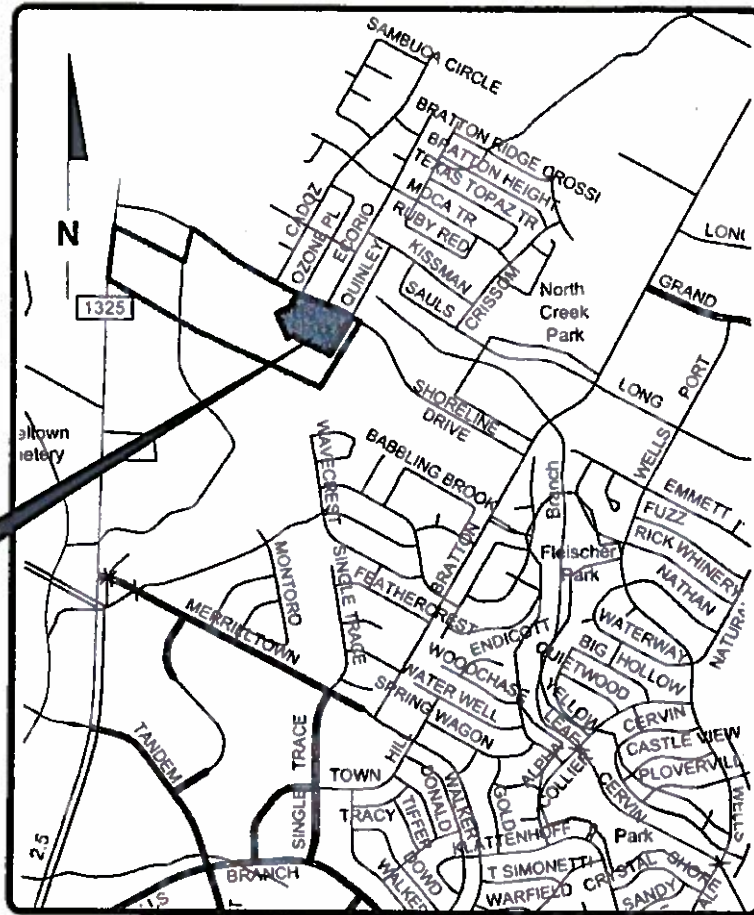

**PROJECT
LOCATION**

Project Location Map
N.T.S.

*2ap
11074260*

Replat of Austin Christian Faith Center