

**SUBDIVISION REVIEW SHEET**

C8/1

**CASE NO.:** C8-2014-0038.0A

**P.C. DATE:** 3-11-14

**SUBDIVISION NAME:** Kimbrough and Lisa Gray Addition

**AREA:** .655

**LOT(S):** 2

**OWNER/APPLICANT:** Grayland LLC  
(Lisa Gray)

**AGENT:** Grayland LLC  
(Lisa Gray)

**ADDRESS OF SUBDIVISION:** 5912 HAROLD CT

**GRIDS:** MM22

**COUNTY:**

**WATERSHED:** Boggy Creek

**JURISDICTION:** Full Purpose

**EXISTING ZONING:**

**MUD:** N/A

**NEIGHBORHOOD PLAN:**

**PROPOSED LAND USE:** SF

**ADMINISTRATIVE WAIVERS:** None

**VARIANCES:** None

**SIDEWALKS:** Sidewalks will be provided on both sides of all internal streets and the subdivision side of boundary streets.

**DEPARTMENT COMMENTS:** The request is for approval of the Kimbrough and Lisa Gray Addition. The proposed plat is composed of 2 lots on .655 acres.

**STAFF RECOMMENDATION:** The staff recommends disapproval of the plat. This plat does not meet all applicable State and City of Austin LDC requirements.

**PLANNING COMMISSION ACTION:**

BY: \_\_\_\_\_  
Deputy

NOTE:  
THE WATER AND/OR WASTEWATER EASEMENTS INDICATED ON THIS PLAT ARE FOR THE  
PURPOSE OF CONSTRUCTION, OPERATION, MAINTENANCE, REPAIR, REPLACEMENT, UPGRADE,  
DECOMMISSIONING AND REMOVAL OF WATER AND/OR WASTEWATER FACILITIES AND  
APPURTENANCES. NO OBJECTS, INCLUDING BUT NOT LIMITED TO, BUILDINGS, FENCES,  
RETAINING WALLS, TREES OR OTHER STRUCTURES ARE PERMITTED IN WATER AND/OR  
WASTEWATER EASEMENTS EXCEPT AS APPROVED BY THE CITY OF AUSTIN.

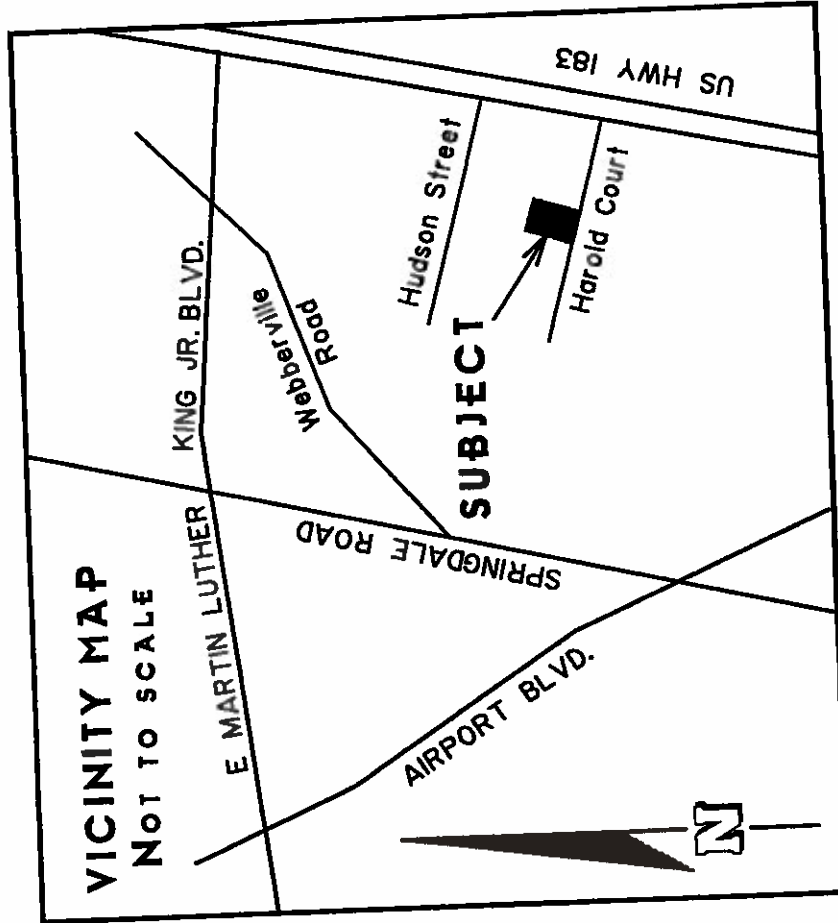

# 11094014  
PC  
C8/2

899148.dgn