

SUBDIVISION REVIEW SHEET

CG/1

CASE NO.: C8J-2013-0224.1A

ZAP DATE: March 18, 2014

SUBDIVISION NAME: Whisper Valley, Village 1

AREA: 80

LOT(S): 239

OWNER/APPLICANT: Club Deal 120 Whisper Valley
(Douglas Gilliland)

AGENT: Bury & Partners
(Marcelo Salce)

ADDRESS OF SUBDIVISION: N FM 973 Rd.

GRIDS: T24, T25

COUNTY: Travis

WATERSHED: Gilleland Creek

JURISDICTION: Limited-Purpose

EXISTING ZONING: N/A

MUD: N/A

NEIGHBORHOOD PLAN: N/A

PROPOSED LAND USE: PUD

ADMINISTRATIVE WAIVERS:

VARIANCES: None

SIDEWALKS: Sidewalks will be provided on both sides of all internal streets and the subdivision side of boundary streets.

DEPARTMENT COMMENTS: The request is for approval of the Whisper Valley, Village 1. The proposed plat is composed of 239 lots on 80 acres.

STAFF RECOMMENDATION: The staff recommends disapproval of the plat. This plat does not meet all applicable State and City of Austin LDC requirements.

PLANNING COMMISSION / ZONING AND PLATTING ACTION:

copy

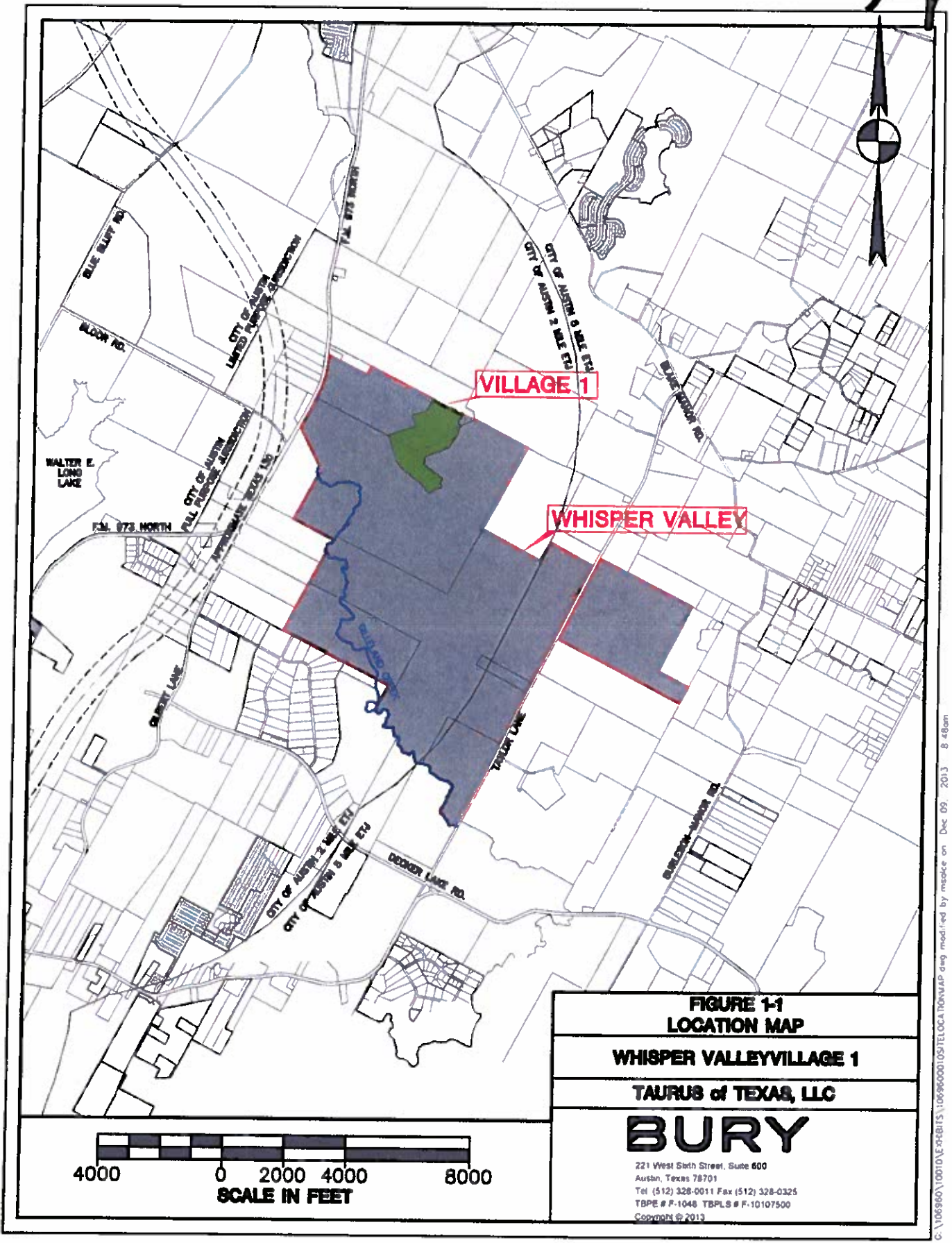

**FIGURE 1-1
LOCATION MAP**

WHISPER VALLEY VILLAGE 1

TAURUS of TEXAS, LLC

BURY

221 West Sixth Street, Suite 600
Austin, Texas 78701
Tel: (512) 328-0011 Fax: (512) 328-0325
TBPE # F-1046 TBPLS # F-10107500
Copyright © 2013

PC 11102428