

**SUBDIVISION REVIEW SHEET**

C16  
7

**CASE NO.:** C8-2014-0068.0A

**P.C. DATE:** 5-13-14

**SUBDIVISION NAME:** RREEF Domain Lot P Subdivision

**AREA:** 79.413

**LOT(S):** 2

**OWNER/APPLICANT:** RREEF Domain LP  
(Ben Bufkin)

**AGENT:** Bury-AUS, Inc.  
(Cole Popp)

**ADDRESS OF SUBDIVISION:** NEWMAN DR

**GRIDS:** K33, K34

**COUNTY:**

**WATERSHED:** Walnut Creek

**JURISDICTION:** Full Purpose

**EXISTING ZONING:**

**MUD:** N/A

**NEIGHBORHOOD PLAN:**

**PROPOSED LAND USE:** Commercial

**ADMINISTRATIVE WAIVERS:** None

**VARIANCES:** None

**SIDEWALKS:** Sidewalks will be provided on both sides of all internal streets and the subdivision side of boundary streets.

**DEPARTMENT COMMENTS:** The request is for approval of the RREEF Domain Lot P Subdivision. The proposed plat is composed of 2 lots on 79.413 acres.

**STAFF RECOMMENDATION:** The staff recommends disapproval of the plat. This plat does not meet all applicable State and City of Austin LDC requirements.

**PLANNING COMMISSION ACTION:**

C16 1/2

Tracking #  
11126590  
PC

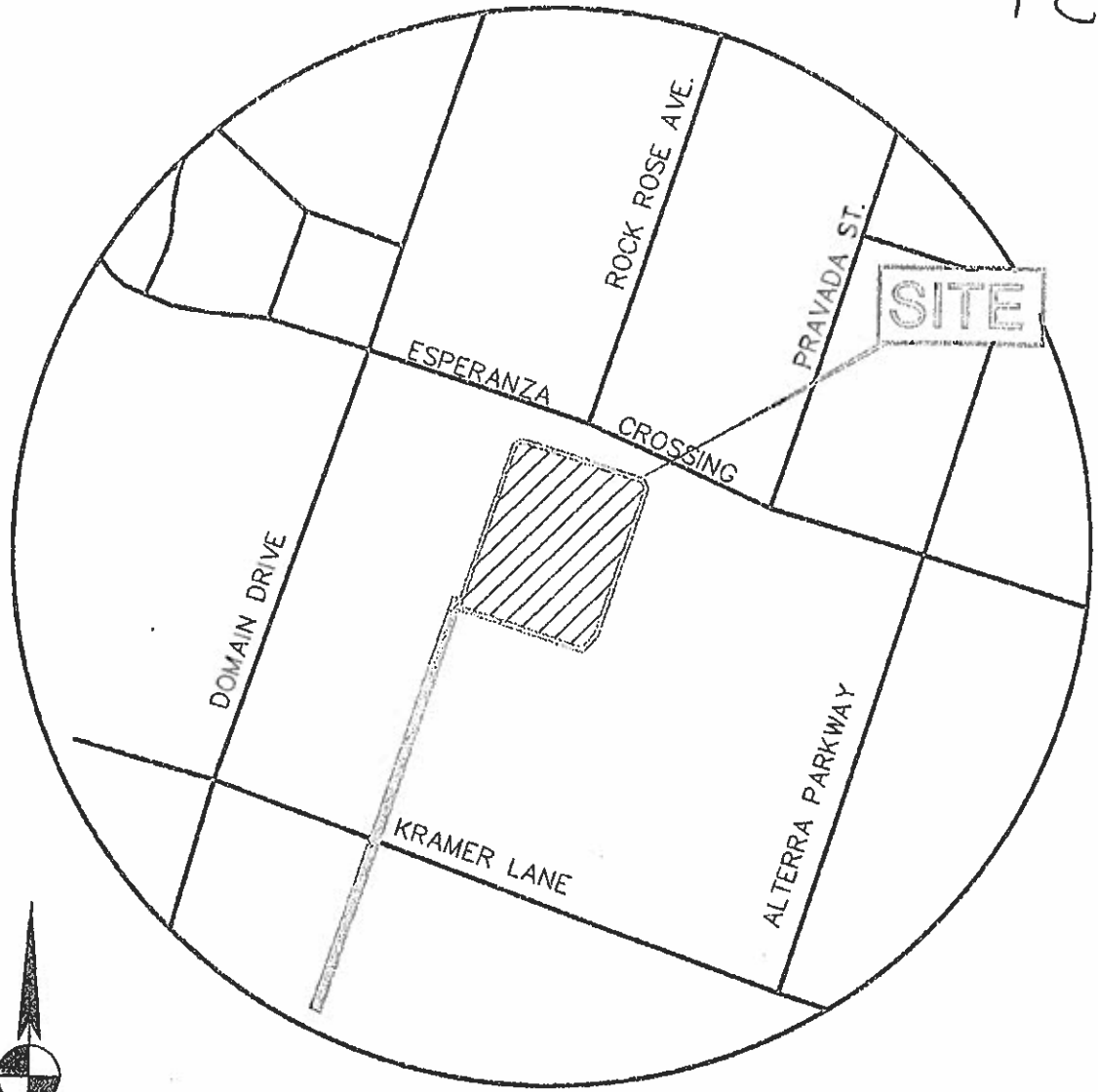

**BURY**

221 West Sixth Street, Suite 600  
Austin, Texas 78701  
Tel. (512) 328-0011 Fax (512) 328-0025  
TBPE # F-1048 TDPLS # F-10107500  
Copyright © 2014

DOMAIN LOT P PLAT  
RETAIL DISTRICT SUBDIVISION

ENDEAVOR REAL ESTATE GROUP

SITE LOCATION MAP

DATE: 4/15/2014

SCALE: N.T.S.

DRAWN BY: WCP

FILE:

PROJECT No. 101231.110056