

C14
1

SUBDIVISION REVIEW SHEET

CASE NO.: C8-2014-0074.0A

P.C. DATE: May 13, 2014

SUBDIVISION NAME: Juliet Estates Resub of the West 100' x 150' of Lot 9, Blk A Barton Heights Sub

AREA: .3444

LOT(S): 2

OWNER/APPLICANT: (Stephane Godevais)

AGENT: Land Answers
(Jim Wittliff)

ADDRESS OF SUBDIVISION: 1606 JULIET ST

GRIDS: MH21

COUNTY: Travis

WATERSHED: Town Lake

JURISDICTION: Full-Purpose

EXISTING ZONING: SF

MUD: N/A

NEIGHBORHOOD PLAN: Zilker

PROPOSED LAND USE: SF

ADMINISTRATIVE WAIVERS:

VARIANCES: None

SIDEWALKS: Sidewalks will be provided on both sides of all internal streets and the subdivision side of boundary streets.

DEPARTMENT COMMENTS: The request is for approval of the Juliet Estates Resub of the West 100' x 150' of Lot 9, Blk A Barton Heights Sub. The proposed plat is composed of 2 lots on .3444 acres.

STAFF RECOMMENDATION: The staff recommends disapproval of the plat. This plat does not meet all applicable State and City of Austin LDC requirements.

PLANNING COMMISSION/ZONING AND PLATTING ACTION:

Taccling # 11129616
PC

1606 JULIET ST

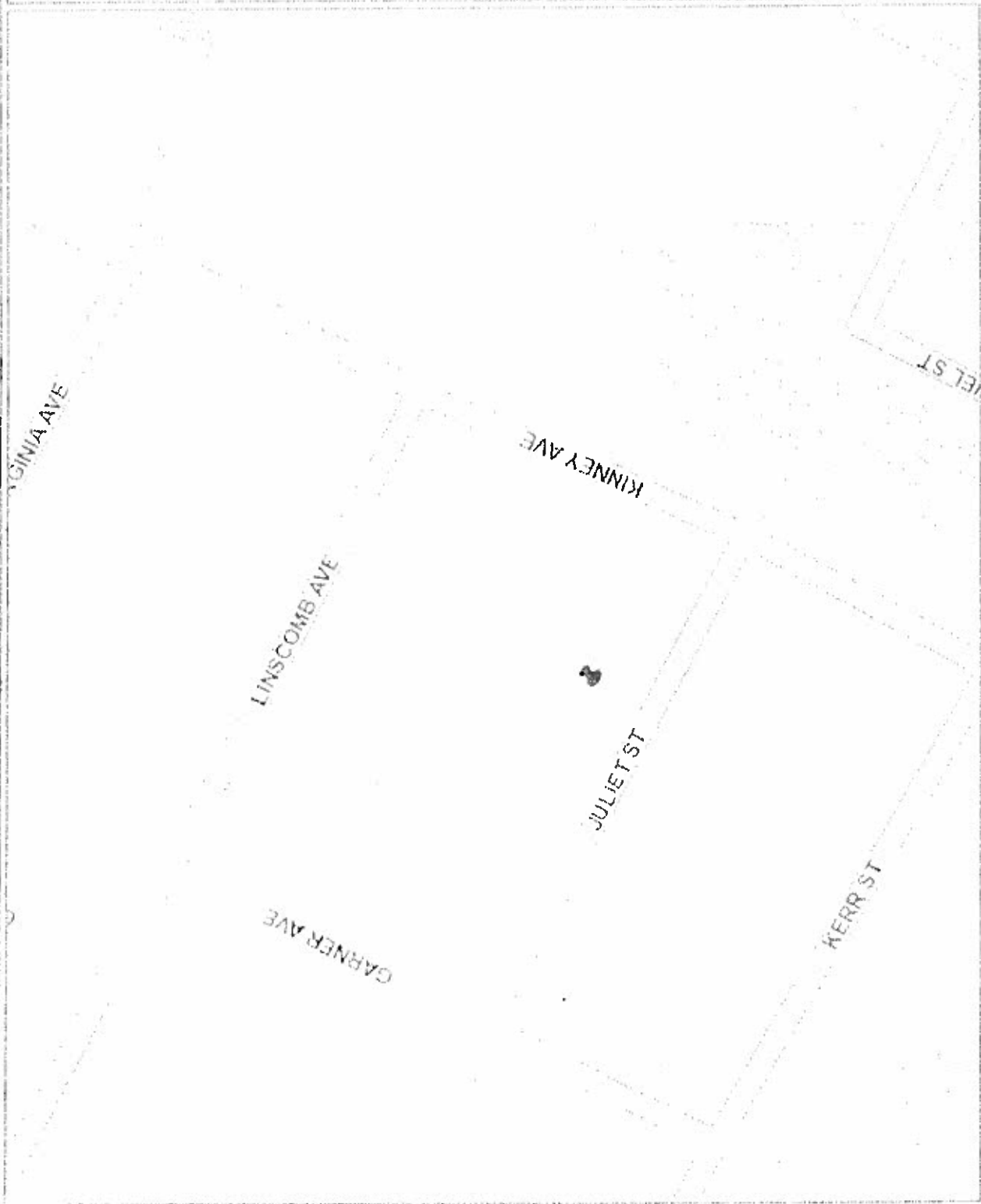

Legend

- Lot Lines
- Streets
- Building Footprints
- Named Creeks
- Lakes and Rivers
- Parks
- County

CLY
2/14

THIS PRODUCT IS FOR INFORMATIONAL PURPOSES AND MAY NOT HAVE BEEN PREPARED FOR OR BE SUITABLE FOR LEGAL, ENGINEERING, OR SURVEYING PURPOSES. IT DOES NOT REPRESENT AN ON-THE-GROUND SURVEY AND REPRESENTS ONLY THE APPROXIMATE RELATIVE LOCATION OF PROPERTY BOUNDARIES. THIS PRODUCT HAS BEEN PRODUCED BY THE CITY OF AUSTIN FOR THE SOLE PURPOSE OF GEOGRAPHIC REFERENCE. NO WARRANTY IS MADE BY THE CITY OF AUSTIN REGARDING SPECIFIC ACCURACY OR COMPLETENESS.