

C15/1

SUBDIVISION REVIEW SHEET

CASE NO.: C8-2014-0065.0A

P.C. DATE: 5-13-14

SUBDIVISION NAME: Borders Subdivision

AREA: 1.469

LOT(S): 3

OWNER/APPLICANT: Thomas P & Mary C Borders

AGENT: Land Strategies
(Paul Linehan)

ADDRESS OF SUBDIVISION: 2500 MATTHEWS DR

GRIDS: MG25

COUNTY:

WATERSHED: Lake Austin

JURISDICTION: Full Purpose

EXISTING ZONING:

MUD: N/A

NEIGHBORHOOD PLAN:

PROPOSED LAND USE: SF

ADMINISTRATIVE WAIVERS: None

VARIANCES: None

SIDEWALKS: Sidewalks will be provided on both sides of all internal streets and the subdivision side of boundary streets.

DEPARTMENT COMMENTS: The request is for approval of the Borders Subdivision. The proposed plat is composed of 3 lots on 1.469 acres.

STAFF RECOMMENDATION: The staff recommends disapproval of the plat. This plat does not meet all applicable State and City of Austin LDC requirements.

PLANNING COMMISSION ACTION:

C5
C1/2

The Borders Subdivision

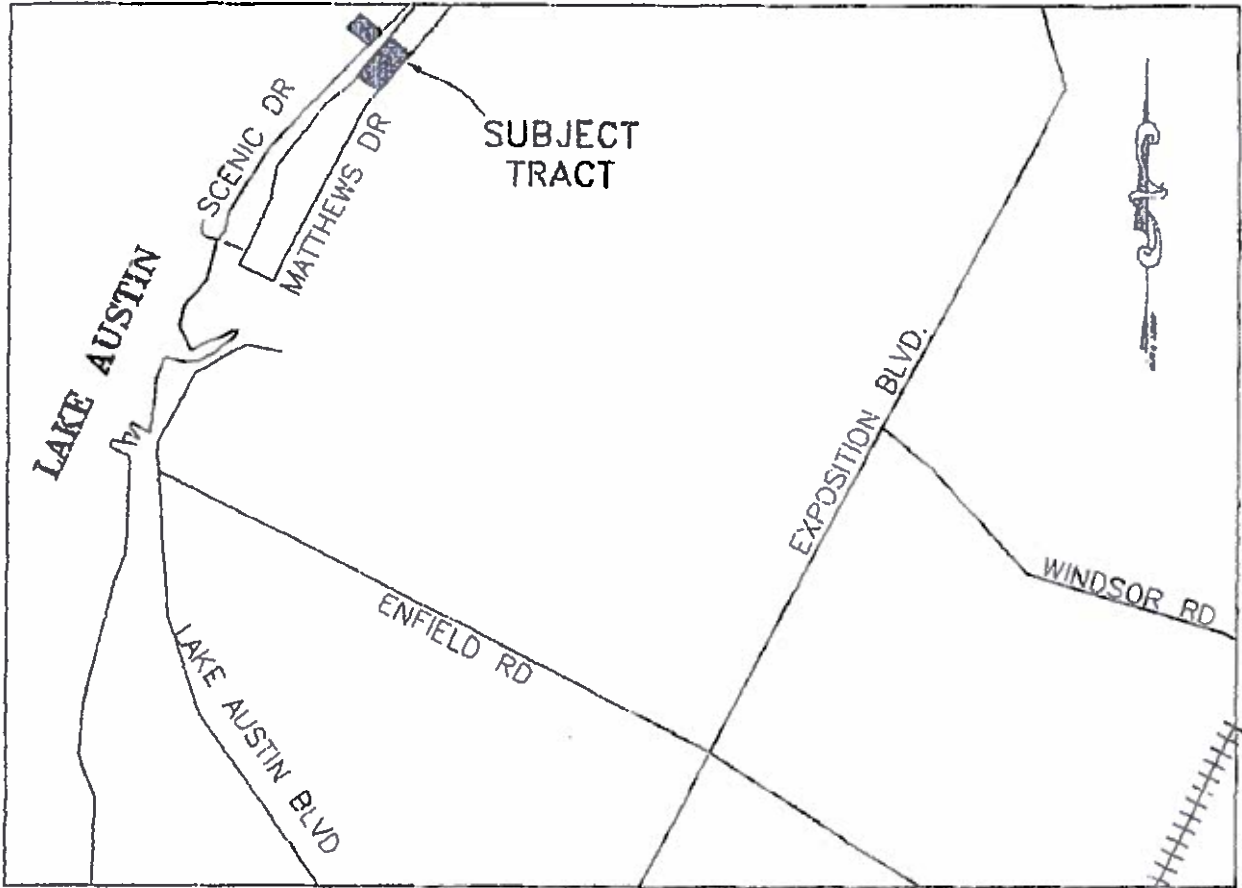

VICINITY MAP
NOT TO SCALE

PC#11123347