

018

**SUBDIVISION REVIEW SHEET**

**CASE NO.:** C8-2014-0127

**Z.A.P. DATE:** 8-5-14

**SUBDIVISION NAME:** Circle C Ranch Tract 8C

**AREA:** 14.227

**LOT(S):** 11

**OWNER/APPLICANT:** Standard Pacific Homes of Texas (Jay Byler)

**AGENT:** LJA Engineering & Surveying Inc Austin Office (John Clark)

**ADDRESS OF SUBDIVISION:** La Crosse Ave

**GRIDS:** A16, A17, WZ16

**COUNTY:**

**WATERSHED:** Slaughter Creek

**JURISDICTION:** Full Purpose

**EXISTING ZONING:**

**MUD:** N/A

**NEIGHBORHOOD PLAN:**

**PROPOSED LAND USE:** SF

**ADMINISTRATIVE WAIVERS:** None

**VARIANCES:** None

**SIDEWALKS:** Sidewalks will be provided on both sides of all internal streets and the subdivision side of boundary streets.

**DEPARTMENT COMMENTS:** The request is for approval of the Circle C Ranch Tract 8C. The proposed plat is composed of 11 lots on 14.227 acres.

**STAFF RECOMMENDATION:** The staff recommends disapproval of the plat. This plat does not meet all applicable State and City of Austin LDC requirements.

**ZONING AND PLATTING ACTION:**

ZAP

Tracking #  
11180218

0182

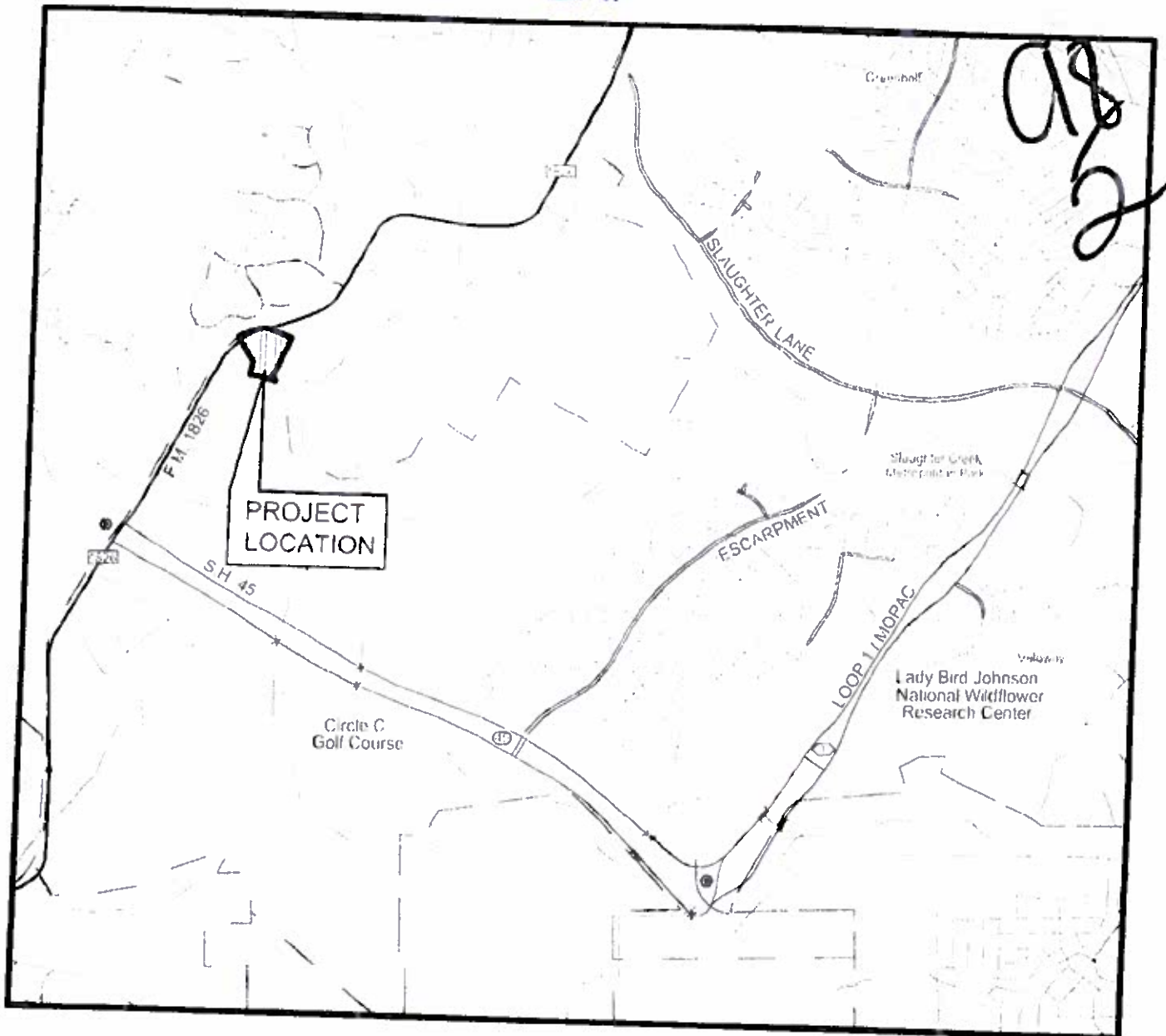

## LOCATION MAP

(N.T.S.)

C.O.A. GRID NO.s A16, A17, AND WZ16  
MAPSCO PAGE NO. 641