

C121

**SUBDIVISION REVIEW SHEET**

**CASE NO.:** C8-2014-0136

**ZAP DATE:** August 5, 2014

**SUBDIVISION NAME:** Beaver Creek Preliminary

**AREA:** 59.25

**LOT(S):** 175

**OWNER/APPLICANT:** Sealy & Company  
(Michael Sealy)

**AGENT:** Garrett-Ihnen Civil Eng.  
(Norma Divine)

**ADDRESS OF SUBDIVISION:** 300 E Wells Branch Pkwy

**GRIDS:** MN36

**COUNTY:** Travis

**WATERSHED:** Harris Branch

**JURISDICTION:** Full-Purpose

**EXISTING ZONING:** N/A

**MUD:** N/A

**NEIGHBORHOOD PLAN:** N/A

**PROPOSED LAND USE:** Mixed

**ADMINISTRATIVE WAIVERS:**

**VARIANCES:** None

**SIDEWALKS:** Sidewalks will be provided on both sides of all internal streets and the subdivision side of boundary streets.

**DEPARTMENT COMMENTS:** The request is for approval of the Beaver Creek Preliminary. The proposed plat is composed of 175 lots on 59.25 acres.

**STAFF RECOMMENDATION:** The staff recommends disapproval of the plat. This plat does not meet all applicable State and City of Austin LDC requirements.

**PLANNING COMMISSION / ZONING AND PLATTING ACTION:**

2AP 11185412

CD 2

**Submittal Date: July 2014**

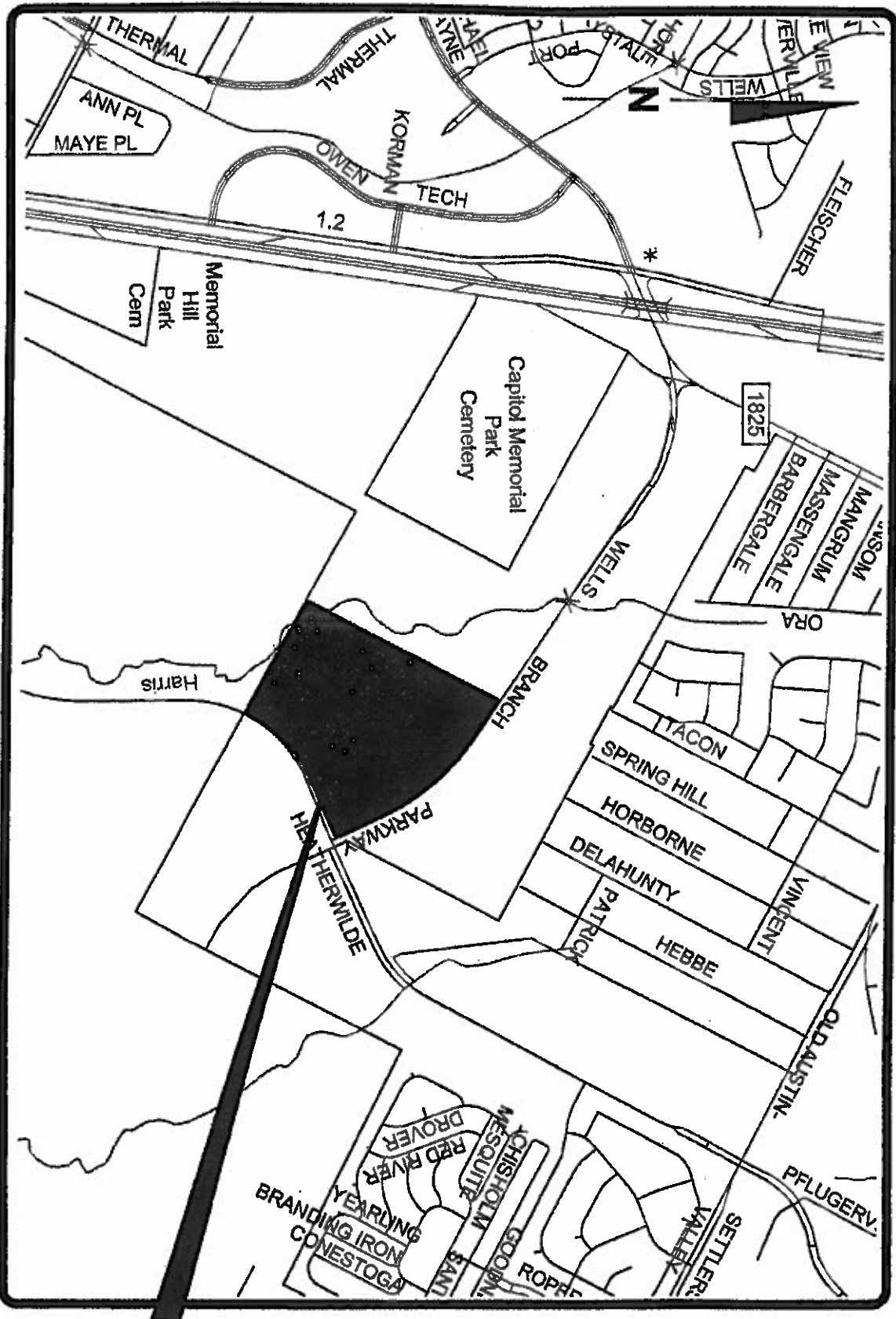

**Project Location Map**

**N.T.S.**