

017
1

SUBDIVISION REVIEW SHEET

CASE NO.: C8-85-067.13.2A

ZAP DATE: August 19, 2014

SUBDIVISION NAME: Lakeline at Ridgeline

AREA: 4.1291

LOT(S): 1

OWNER/APPLICANT: 183 BLW LP
(Matt Harris)

AGENT: John Lewis Company
(John C. Lewis)

ADDRESS OF SUBDIVISION: 2610-1/2 S. Lakeline Blvd.

GRIDS: ME40

COUNTY: Travis

WATERSHED: Buttercup Creek

JURISDICTION: Full-Purpose

EXISTING ZONING: Commercial

MUD: N/A

NEIGHBORHOOD PLAN: N/A

PROPOSED LAND USE: Commercial

ADMINISTRATIVE WAIVERS:

VARIANCES: None

SIDEWALKS: Sidewalks will be provided on both sides of all internal streets and the subdivision side of boundary streets.

DEPARTMENT COMMENTS: The request is for approval of the Lakeline at Ridgeline. The proposed plat is composed of 1 lot on 4.1291 acres.

STAFF RECOMMENDATION: The staff recommends disapproval of the plat. This plat does not meet all applicable State and City of Austin LDC requirements.

PLANNING COMMISSION/ZONING AND PLATTING ACTION:

C17/2

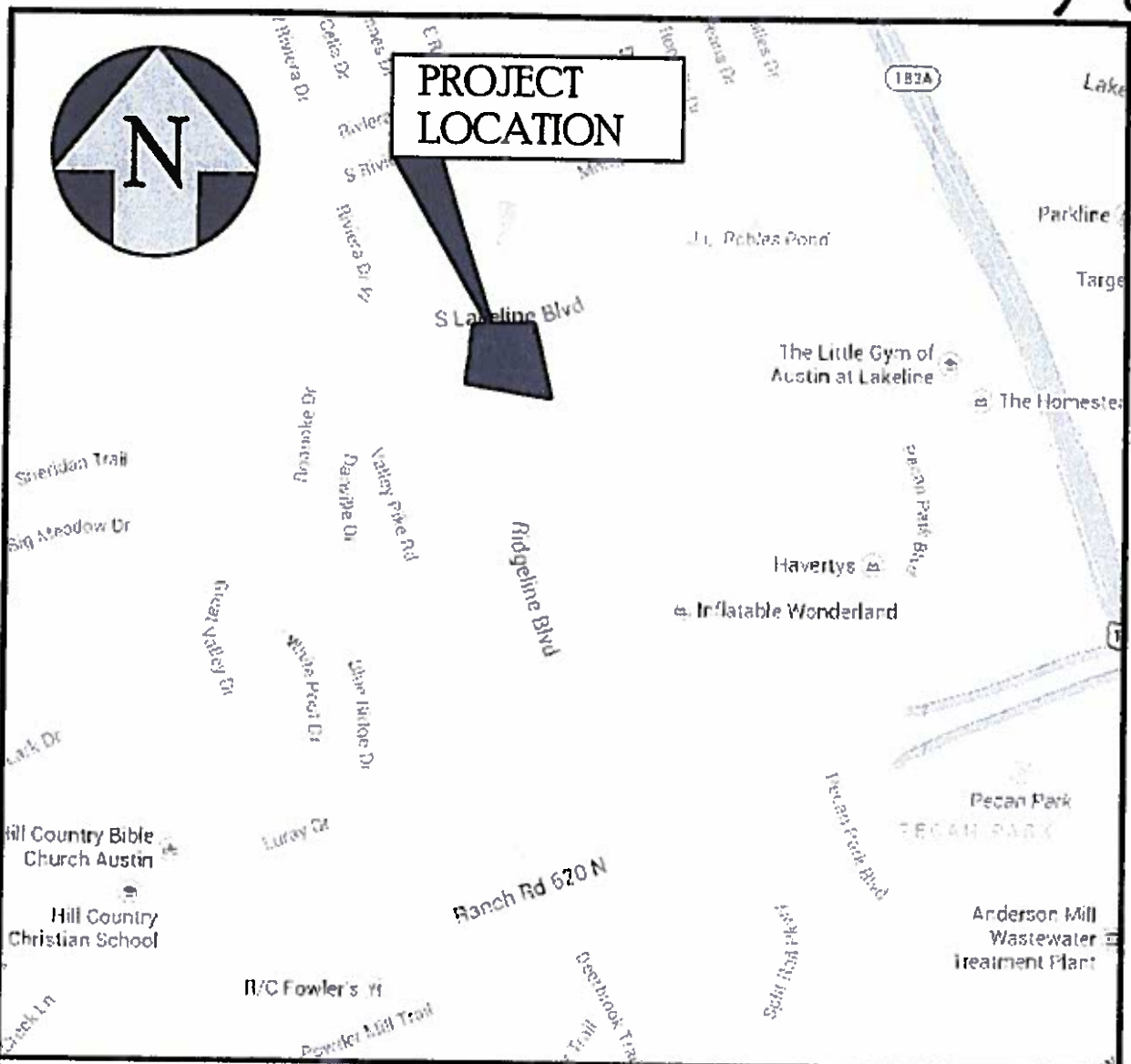

Address: 2727 S. Lakeline Blvd., Austin, TX 78613

183 BLW - RIDGELINE LOCATION MAP

LC LONGARO & CLARKE
Consulting Engineers

Land Development • Stormwater Management • Water Resources

3839 Bee Cave Road • Suite 150 • Austin, Texas 78746

(512) 306-0228 ~ www.LongaroClarke.com ~ TBPE Reg. No. P-544

ZAP
#11191565