

C2
T



MEMORANDUM

TO: Betty Baker, Chairperson
Zoning and Platting Commission Members

FROM: Sherri Sirwaitis
Planning and Development Review Department

DATE: September 10, 2014



RE: C14-2014-0037 (The Sealy) Postponement Request

The staff would like to request an additional postponement of the above mentioned case to October 21, 2014. The staff is asking for this postponement because the Transportation Impact Analysis (TIA) review for case is incomplete as some of the Transportation staff's comments have yet to be addressed by the applicant's traffic consultant.

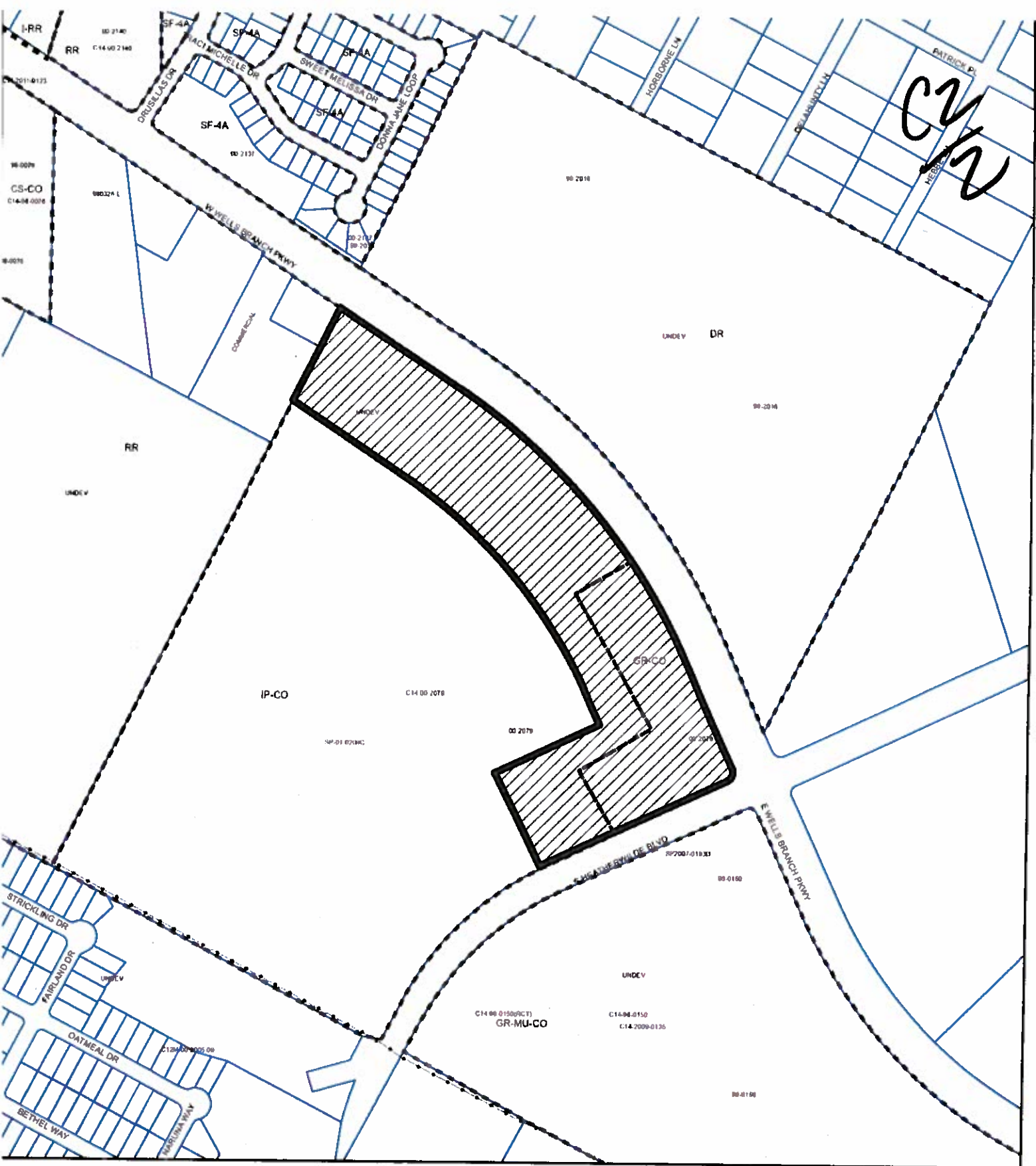
The postponement request was made in a timely manner and meets the Zoning and Platting Commission's policy.



CV
CV

-  SUBJECT TRACT
-  PENDING CASE
-  ZONING BOUNDARY

ZONING

ZONING CASE#: C14-2014-0035

1" = 400'

This product is for informational purposes and may not have been prepared for or be suitable for legal, engineering, or surveying purposes. It does not represent an on-the-ground survey and represents only the approximate relative location of property boundaries.

This product has been produced by CTM for the sole purpose of geographic reference. No warranty is made by the City of Austin regarding specific accuracy or completeness.

