

C26
/

SUBDIVISION REVIEW SHEET

CASE NO.: C8-2014-0177

ZAP DATE: October 7, 2014

SUBDIVISION NAME: East Parke Subdivision

AREA: 37.46

LOT(S): 124

OWNER/APPLICANT: HK Jr. Investment Partnership
(Richard Maier)

AGENT: Gray Engineering, Inc
(Steve Bertke, P.E.)

ADDRESS OF SUBDIVISION: 5002-1/2 Purple Sage Dr.

GRIDS: MN26

COUNTY: Travis

WATERSHED: Walnut Creek

JURISDICTION: Full-Purpose

EXISTING ZONING: Vacant

MUD: N/A

NEIGHBORHOOD PLAN: N/A

PROPOSED LAND USE: SF

ADMINISTRATIVE WAIVERS:

VARIANCES: None

SIDEWALKS: Sidewalks will be provided on both sides of all internal streets and the subdivision side of boundary streets.

DEPARTMENT COMMENTS: The request is for approval of the East Parke Subdivision. The proposed plat is composed of 124 lots on 37.46 acres.

STAFF RECOMMENDATION: The staff recommends disapproval of the plat. This plat does not meet all applicable State and City of Austin LDC requirements.

PLANNING COMMISSION / ZONING AND PLATTING ACTION:

C26
2

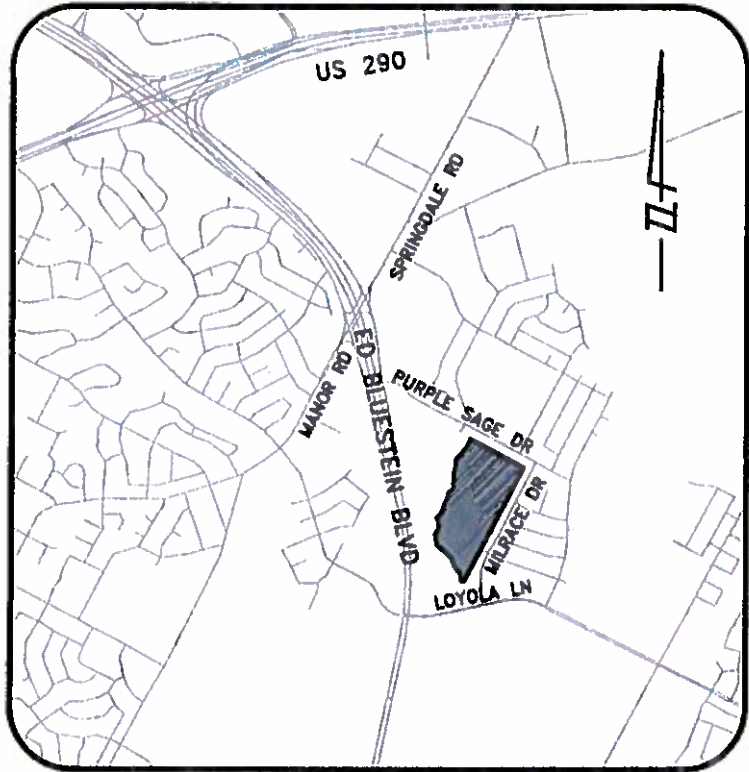

LOCATION
MAP
N.T.S.

APR # 11214018