



C1-2
—
1

MEMORANDUM

TO: Ms. Danette Chimenti, Chair, and
Planning Commission Members

FROM: Maureen Meredith, Senior Planner (512-974-2695)
Planning and Development Review Department *Maureen Meredith*

DATE: October 8, 2014

RE: NPA-2014-0022.01 – 110 Academy Dr. (Terrace Hotel)
C14-2014-0117 – Associated zoning case (Lee Heckman case manager)

Due to a notification error, the above plan amendment and zoning cases will be re-notified for the October 28, 2014 Planning Commission hearing date.

Attachment: Map of property

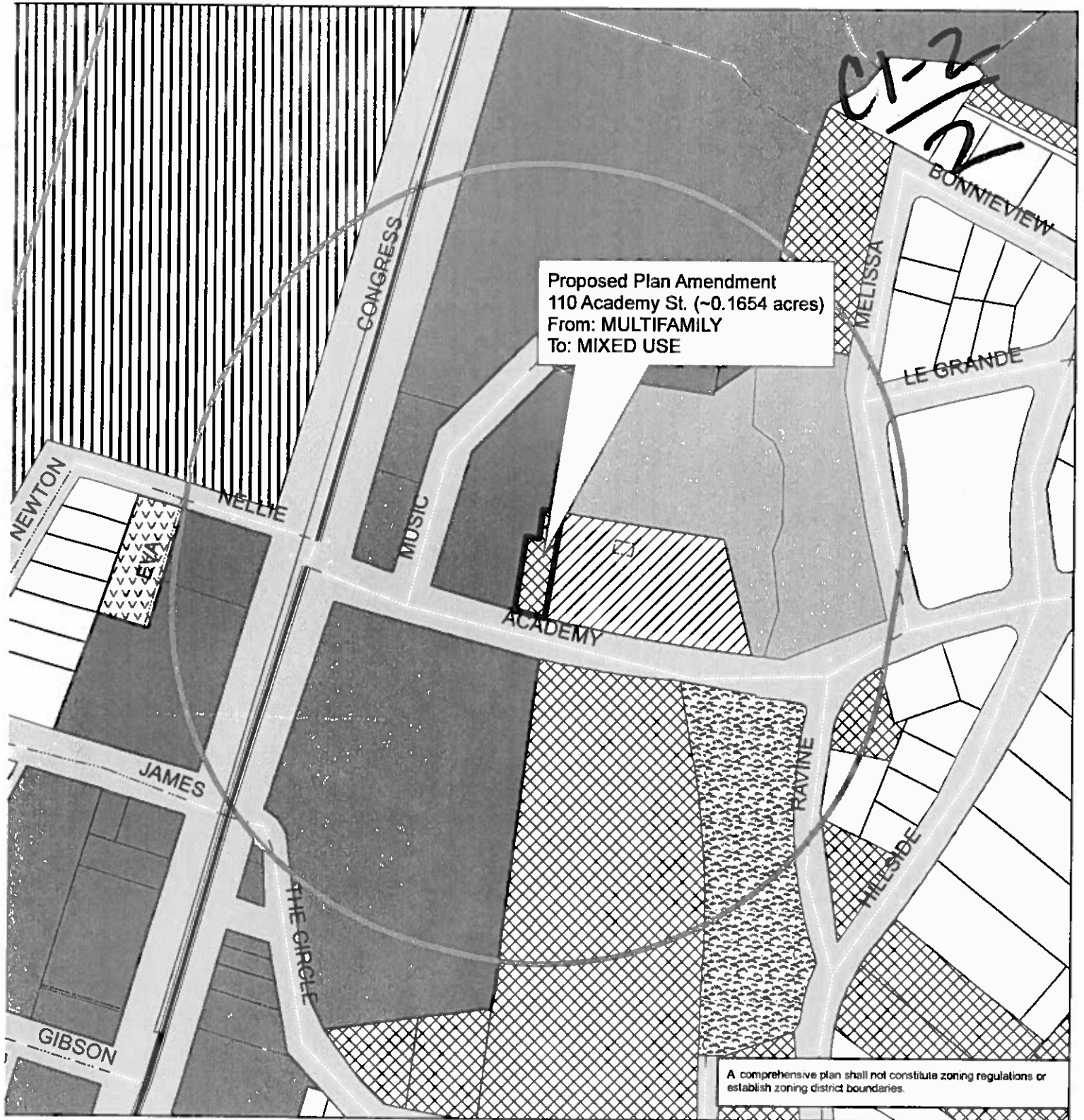

**Greater South River City Combined Neighborhood Plan
NPA-2014-0022.02**

This product is for informational purposes and may not have been prepared for or be suitable for legal action, engineering, or surveying purposes. It does not represent an on-the-ground survey and represents only the approximate relative location of property boundaries.

This product has been produced by the Planning and Development Review for the purpose of geographic reference. No warranty is made by the City of Austin regarding specific accuracy or completeness.

- Legend**
- Core Transit Corridors
 - 500ft notification boundary
 - NPA Callouts
 - ▨ Civic
 - ▧ Commercial
 - ▤ Higher-Density Single-Family
 - Mixed Use
 - Mixed Use/Office
 - ▩ Multi-Family
 - Recreation/Open Space
 - Single-Family
 - Transportation



City of Austin
Planning and Development Review Department
Created on July 15, 2014_M Meredith

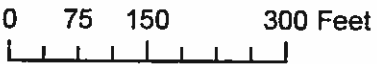

C14-2014-0117

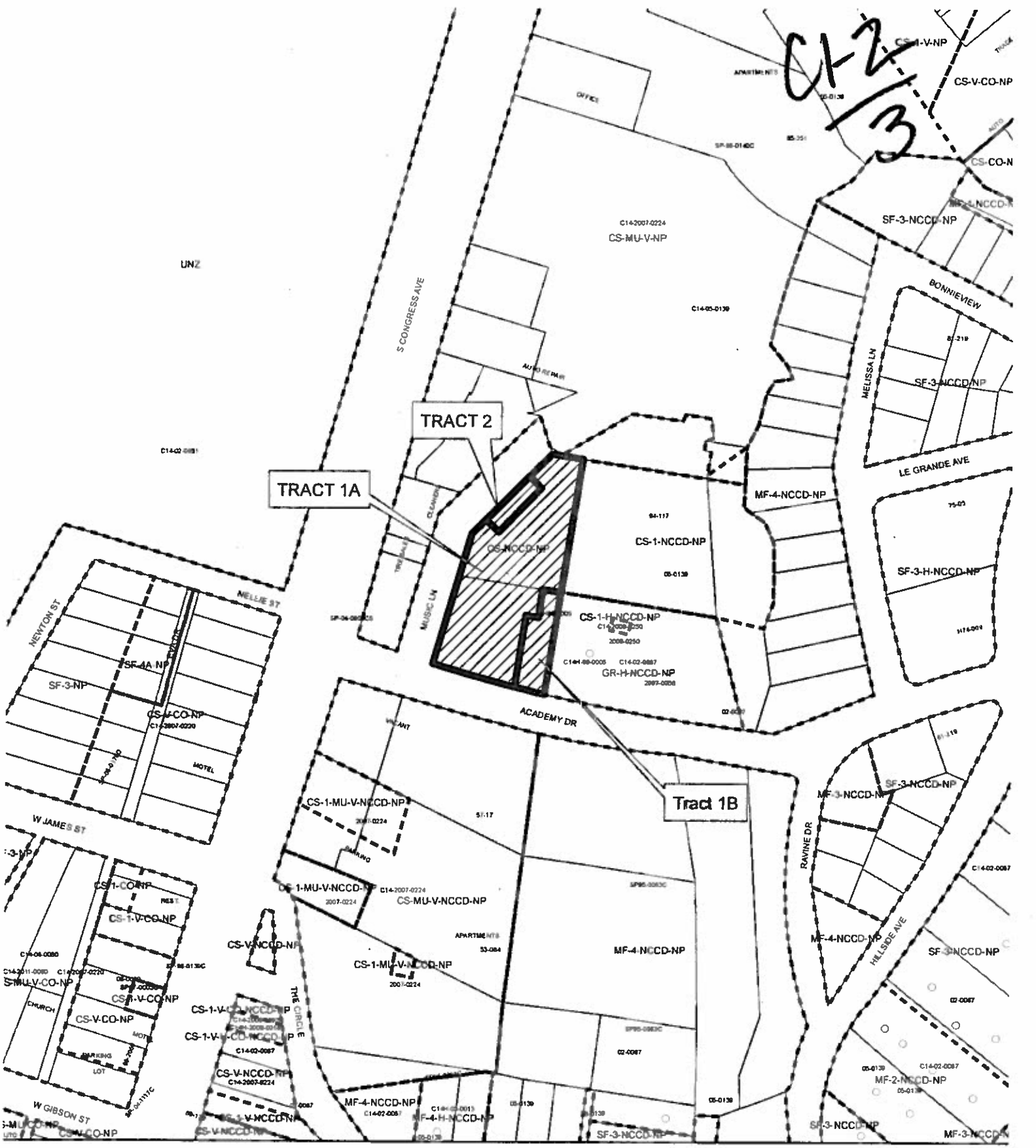

TRACT 1A

TRACT 2

Tract 1B

ZONING

ZONING CASE#: C14-2014-0117

- SUBJECT TRACT
- PENDING CASE
- ZONING BOUNDARY

1" = 200'

This product is for informational purposes and may not have been prepared for or be suitable for legal, engineering, or surveying purposes. It does not represent an on-the-ground survey and represents only the approximate relative location of property boundaries.

This product has been produced by CTM for the sole purpose of geographic reference. No warranty is made by the City of Austin regarding specific accuracy or completeness.

