



C3  
T

**MEMORANDUM**

**TO:** Ms. Danette Chimenti, Chair, and  
Planning Commission Members

**FROM:** Maureen Meredith, Senior Planner (512-974-2695)  
Planning and Development Review Department *Maureen Meredith*

**DATE:** October 8, 2014

**RE:** NPA-2014-0027.02 – 1018 W. 31<sup>st</sup> Street (St. Andrew's Episcopal School)

---

Due to a notification error, the above plan amendment case will be re-notified for the October 28, 2014 Planning Commission hearing date.

Attachment: Map of property

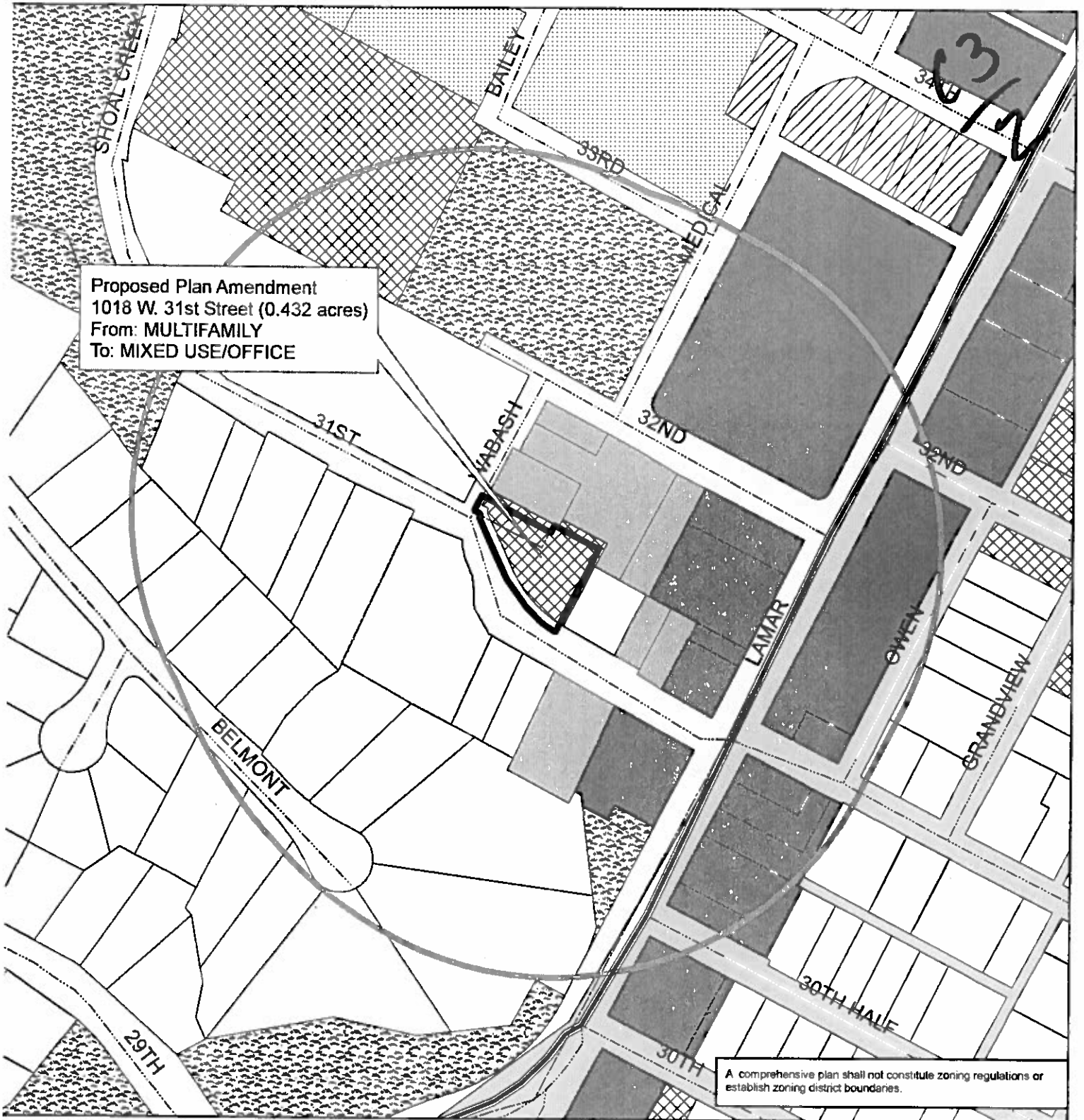

**Central West Austin Combined Neighborhood Plan  
 NPA-2014-0027.02**

This product is for informational purposes and may not have been prepared for or be suitable for legal, engineering, or surveying purposes. It does not represent an on-the-ground survey and represents only the approximate relative location of property boundaries.

This product has been produced by the Planning and Development Review for the sole purpose of geographic reference. No warranty is made by the City of Austin regarding specific accuracy or completeness.

**Legend**

N

- Core Transit Corridors
- 500ft notification boundary
- NPA CASES
- Commercial
- Mixed Use
- Mixed Use/Office
- Multi-Family
- Office
- Recreation & Open Space
- Single-Family
- Transportation

