

C 24
7

SUBDIVISION REVIEW SHEET

CASE NO.: C8J-2014-0187.0A

ZAP DATE: October 21, 2014

SUBDIVISION NAME: Paradigm Metals Final Plat; with Replat

AREA: 9.04

LOT(S): 2

OWNER/APPLICANT: Peripheral Investment
(Joe Caihoun)

AGENT: Garrett-Ihnen Civil Eng.
(Norma Divine)

ADDRESS OF SUBDIVISION: 801 W. Wells Branch Parkway

GRIDS: N38

COUNTY: Travis

WATERSHED: Gilleland Creek

JURISDICTION: Full-Purpose

EXISTING ZONING: N/A

MUD: N/A

NEIGHBORHOOD PLAN: N/A

PROPOSED LAND USE: Commercial

ADMINISTRATIVE WAIVERS:

VARIANCES: None

SIDEWALKS: Sidewalks will be provided on both sides of all internal streets and the subdivision side of boundary streets.

DEPARTMENT COMMENTS: The request is for approval of the Parmer Crossing. The proposed plat is composed of 2 lots on 9.04 acres.

STAFF RECOMMENDATION: The staff recommends disapproval of the plat. This plat does not meet all applicable State and City of Austin LDC requirements.

PLANNING COMMISSION / ZONING AND PLATTING ACTION:

C24
/2

Paradigm Metals Final Plat

TRAVIS COUNTY, TEXAS

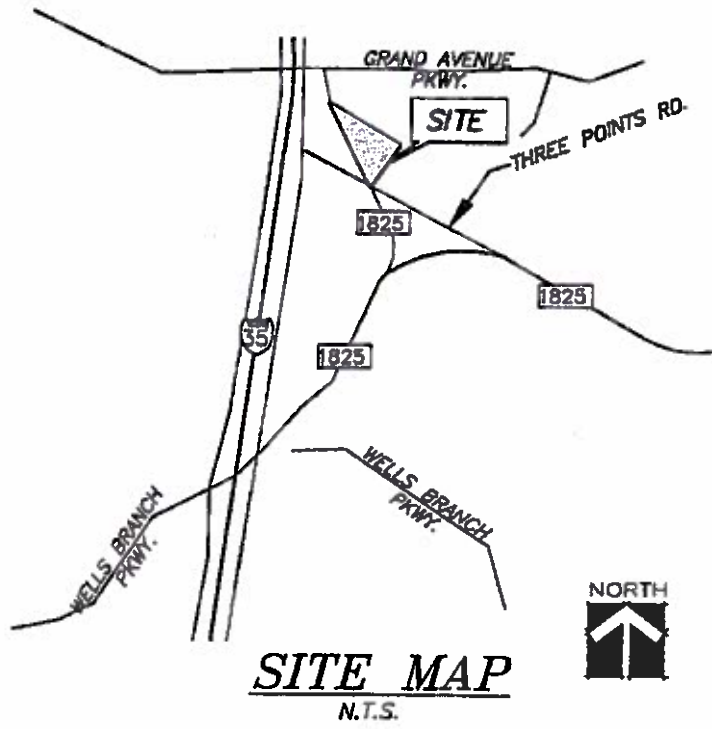

ZAP
#11223089