

C-18
/

SUBDIVISION REVIEW SHEET

CASE NO.: C8J-2013-0162.1A

Z.A.P. DATE: 11-4-14

SUBDIVISION NAME: Elpampero

AREA: 28.84

LOT(S): 2

OWNER/APPLICANT: Daniel Larocca &
ELPAMPERO LLC

AGENT: Carlson, Brigance & Doering, Inc.
(Geoff Guerrero)

ADDRESS OF SUBDIVISION: 14115 GREGG MANOR RD

GRIDS: MR32

COUNTY:

WATERSHED: Gilleland/Wilbarger Creek

JURISDICTION: 2 Mile ETJ

EXISTING ZONING:

MUD: N/A

NEIGHBORHOOD PLAN:

PROPOSED LAND USE: Commercial

ADMINISTRATIVE WAIVERS: None

VARIANCES: None

SIDEWALKS: Sidewalks will be provided on both sides of all internal streets and the subdivision side of boundary streets.

DEPARTMENT COMMENTS: The request is for approval of the Elpampero. The proposed plat is composed of 2 lots on 28.84 acres.

STAFF RECOMMENDATION: The staff recommends disapproval of the plat. This plat does not meet all applicable State and City of Austin LDC requirements.

ZAP ACTION:

C-18
2/18

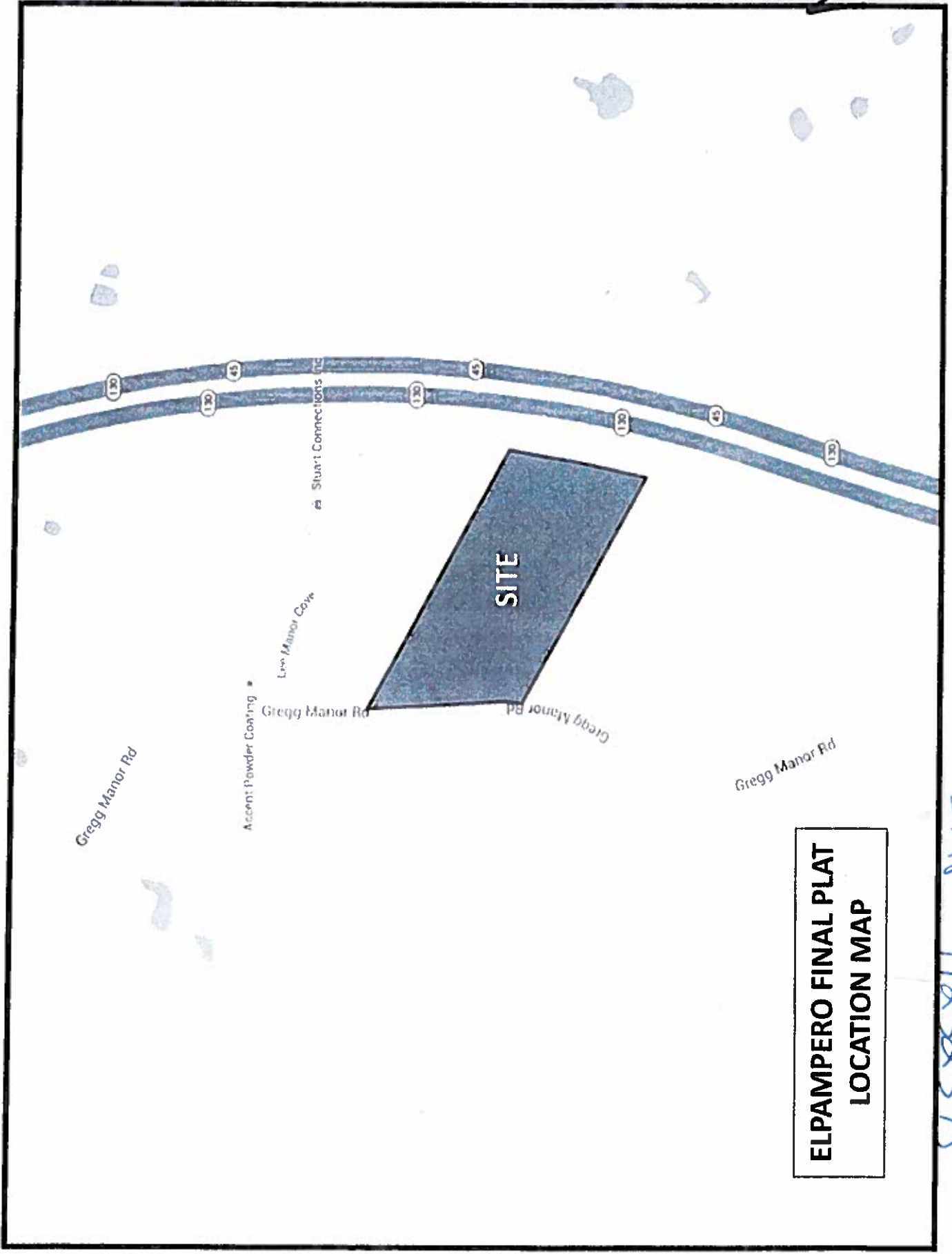

**ELPAMPERO FINAL PLAT
LOCATION MAP**

24P 11232375