

C14
7

SUBDIVISION REVIEW SHEET

CASE NO.: C8-2014-0227.0A

Z.A.P. DATE: 12-2-14

SUBDIVISION NAME: CST Austin 1570

AREA: 17.229

LOT(S): 3

OWNER/APPLICANT: Haviland Lake Partners, LP
(Jeff Drinkard)

AGENT: Mercury Permits Inc
(Denise Reid)

ADDRESS OF SUBDIVISION: 11206 S IH 35 SVRD SB

GRIDS: MF11

COUNTY:

WATERSHED: Onion Creek

JURISDICTION: Full Purpose

EXISTING ZONING:

MUD: N/A

NEIGHBORHOOD PLAN:

PROPOSED LAND USE: Commercial

ADMINISTRATIVE WAIVERS: None

VARIANCES: None

SIDEWALKS: Sidewalks will be provided on both sides of all internal streets and the subdivision side of boundary streets.

DEPARTMENT COMMENTS: The request is for approval of the CST Austin 1570. The proposed plat is composed of 3 lots on 17.229 acres.

STAFF RECOMMENDATION: The staff recommends disapproval of the plat. This plat does not meet all applicable State and City of Austin LDC requirements.

ZONING AND PLATTING ACTION:

C14
1/2

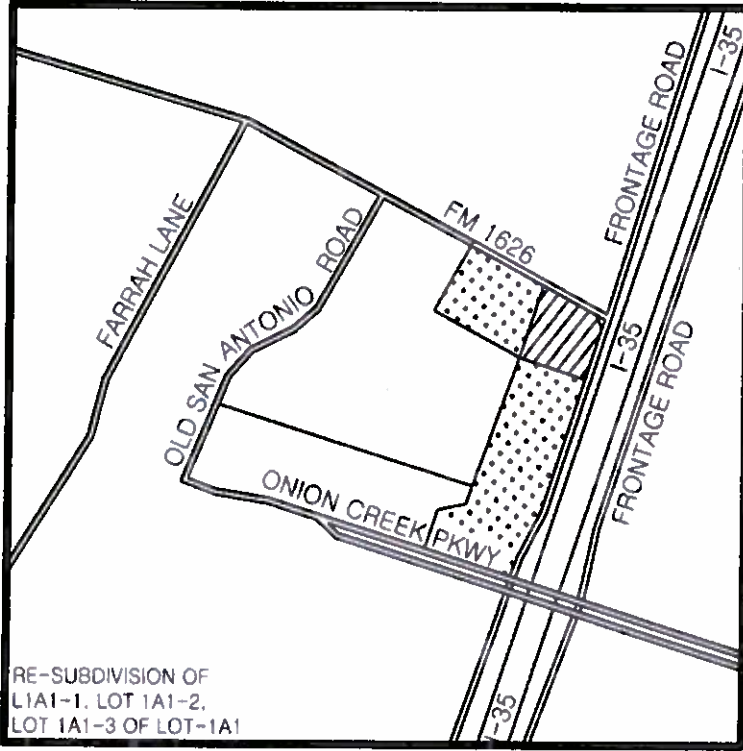

Vicinity Map

Not to Scale

28278	10/10/14	ADS	TLC	DAH	DAH
CEI PROJECT NO.	INITIAL DATE	DPOR	PM	DES	DRW



Engineering Associates, Inc.

ENGINEERS • PLANNERS • SURVEYORS
LANDSCAPE ARCHITECTS • ENVIRONMENTAL SCIENTISTS

3030 LBJ Freeway, Suite 100
Dallas, TX 75234

(972)488-3737
FAX(972)488-6732



CORNER STORE
1570

CST BRANDS, INC.

#1570 SWC FM 1626 & US IH 35
AUSTIN TX

VICINITY MAP

ZAD
#11252300