

**SUBDIVISION REVIEW SHEET**

C17  
/1

**CASE NO.:** C8-2014-0097.0A

**P.C. DATE:** December 9, 2014

**SUBDIVISION NAME:** Austin Mall, Lot 2 Resubdivision

**AREA:** 18.5

**LOT(S):** 4

**OWNER/APPLICANT:** Austin Community College  
(William Mullane)

**AGENT:** BURY-AUS  
(Jonathan McKee)

**ADDRESS OF SUBDIVISION:** 5901 Airport Blvd.

**GRIDS:** K27

**COUNTY:** Travis

**WATERSHED:** Tannehill Branch/Waller Creek

**JURISDICTION:** Full-Purpose

**EXISTING ZONING:** CS-Mu-V-NP

**MUD:** N/A

**NEIGHBORHOOD PLAN:** Highland

**PROPOSED LAND USE:** Commercial-ACC

**VARIANCES:** None

**SIDEWALKS:** Sidewalks will be provided on both sides of all internal streets and the subdivision side of boundary streets.

**DEPARTMENT COMMENTS:** The request is for approval of the Austin Mall, Lot 2 Resubdivision. The proposed plat is composed of 4 lots on 18.5 acres. The applicant proposes to resubdivide the existing Lot 2 into 4 lots, (Lot 2A-2D). The 18.5 acre subject lot is currently developed as surface parking for the existing mall. City of Austin utilities are available. The developer will be responsible for all costs associated with any required improvements.

**STAFF RECOMMENDATION:** The staff recommends approval of the plat. This plat meets all applicable State and City of Austin LDC requirements.

**PLANNING COMMISSION ACTION:**

**CITY STAFF:** David Wahlgren  
Don Perryman

**PHONE:** 512-974-6455  
512-974-2786

**e-mail:** david.wahlgren@austintexas.gov  
don.perryman@austintexas.gov

City

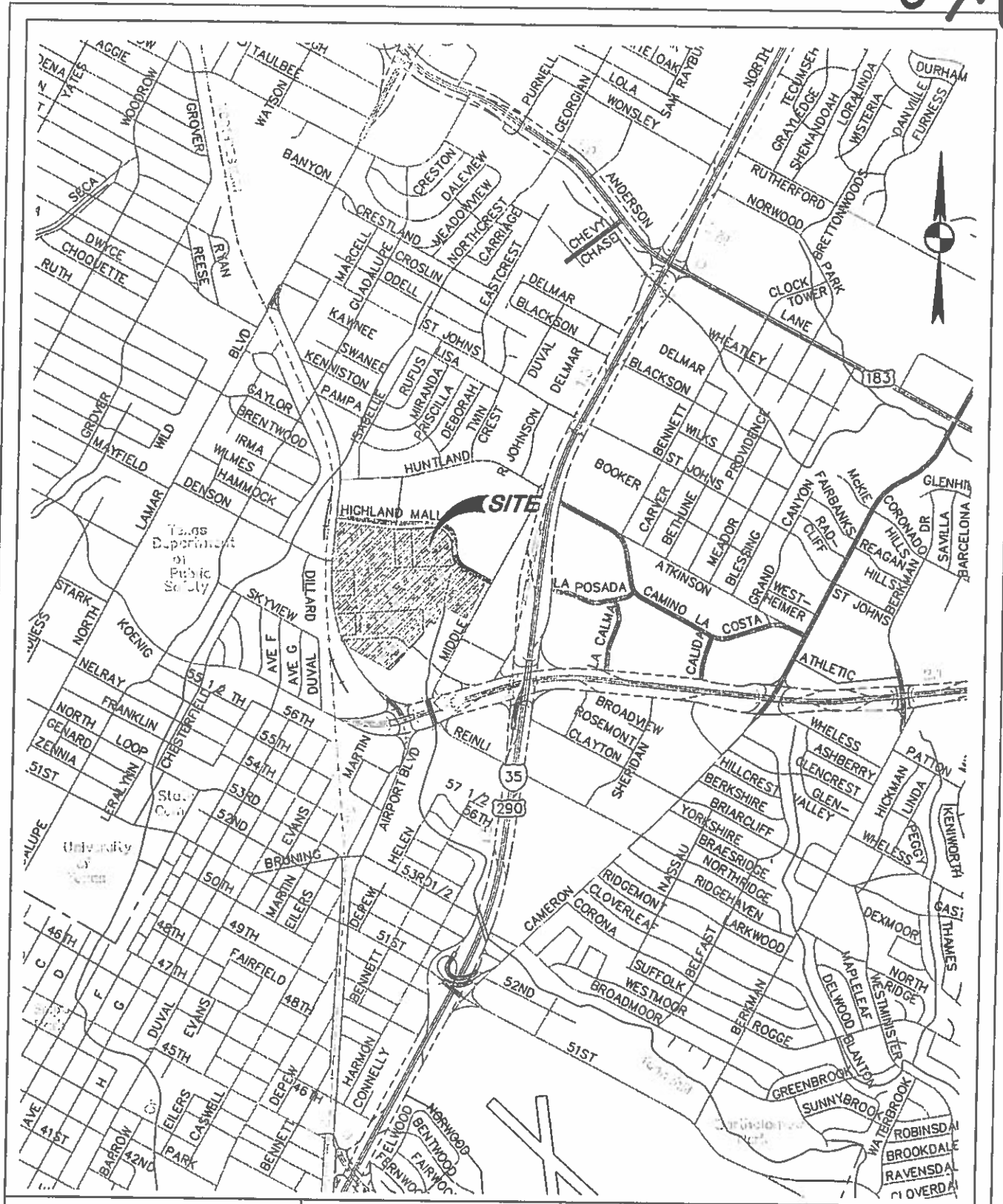

# BURY

221 West Sixth Street, Suite 600  
 Austin, Texas 78701  
 Tel: (512) 328-0011 Fax: (512) 328-0325  
 TBP# F-1048 TDPLS # F-10107500  
 Copyright © 2014

HIGHLAND MALL  
 6001 AIRPORT BLVD

AUSTIN COMMUNITY COLLEGE

SITE LOCATION  
 MAP

DATE: MAY 06, 2014	SCALE: 1:2000	DRAWN BY: BIL	FILE: 103017004-MAP.DWG	PROJECT No. R0103017-10004
--------------------	---------------	---------------	-------------------------	----------------------------

J:\1030171\10004\Embed\SITE LOCATION MAP\103017004 MAP.dwg modified by billy on 5 May 2014 14:52:33 PM

