

**HISTORIC LANDMARK COMMISSION  
DECEMBER 15, 2014  
DEMOLITION AND RELOCATION PERMITS  
HDP-2014-1020  
1516 KINNEY AVENUE**

**PROPOSAL**

---

Demolish a ca. 1961 house.

**ARCHITECTURE**

---

One-story, rectangular-plan, side-gabled frame cottage with single and paired 1:1 fenestration.

**RESEARCH**

---

The house was built in 1961 by Bertha H. Walker, a former school teacher, who lived here until her death in 1967. The house has been a rental unit since that time.

**STAFF COMMENTS**

---

The house does not appear in any City survey.

**STAFF RECOMMENDATION**

---

Encourage re-use if possible; then relocation over demolition, but release the permit. While the house lacks the requisite historical or architectural significance for individual designation as a historic landmark, it is very much in keeping with the scale of the neighborhood.

## LOCATION MAP

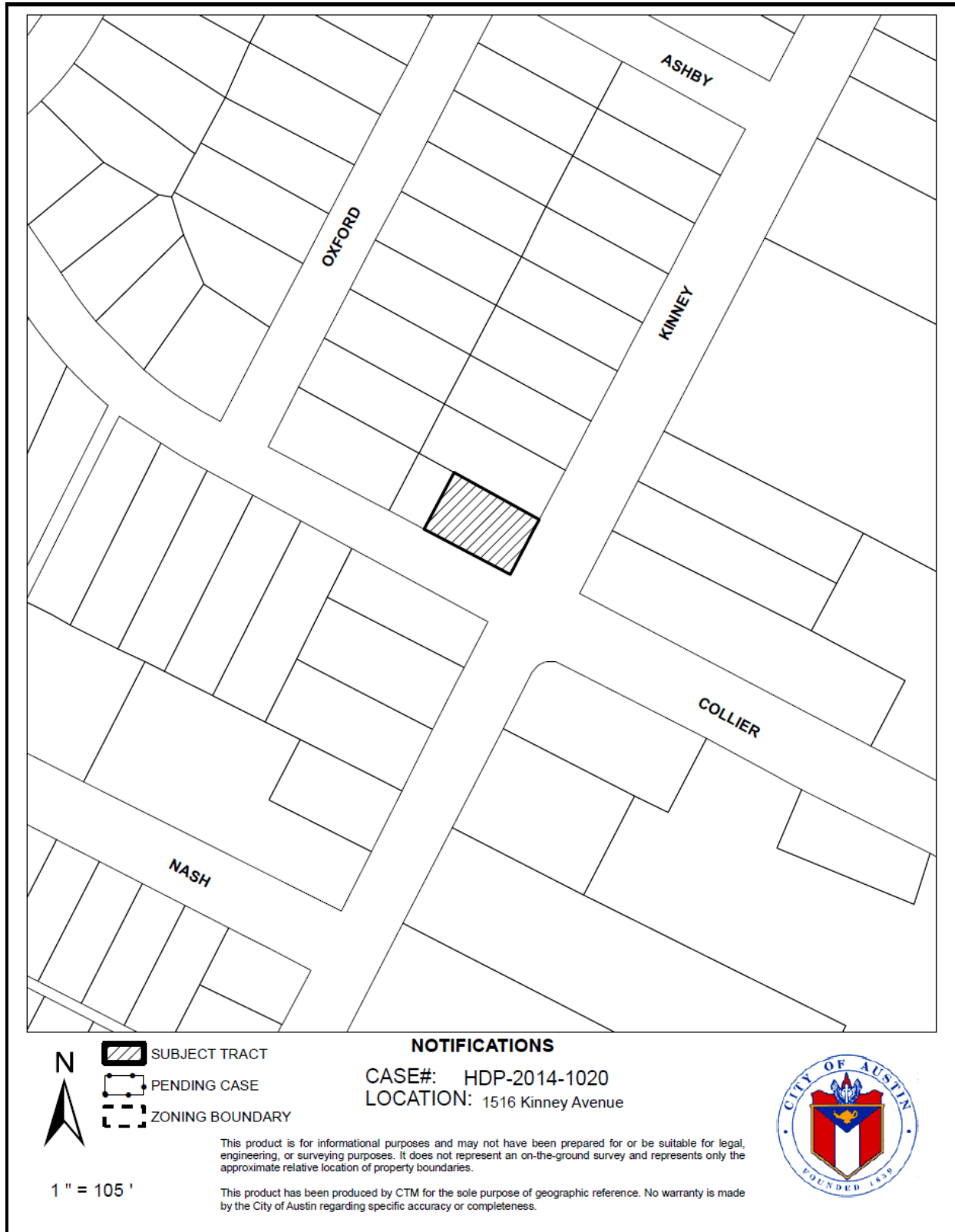

1516 Kinney Avenue  
ca. 1961



## OCCUPANCY HISTORY 1516 Kinney Avenue

City Directory Research, Austin History Center  
By City Historic Preservation Office  
December, 2014

1992	Mary K. Woods, renter Retired
1985-86	Mary K. Woods, renter Retired
1981	Dennis E. and Debbie Treadaway, renters No occupation listed NOTE: The directory indicates that Dennis and Debbie Treadaway were new residents at this address.
1977	B.J. and Marilyn Berry, renters Employed by the State Highway Department
1973	Vacant
1968	Charles A. and Patricia Ladowski, renters Student

- 1962      Bertha H. Walker, owner  
             Widow, John F. Walker  
             No occupation listed
- 1959      The address is not listed in the directory.  
             NOTE: Neither John F. nor Bertha Walker are listed in the directory.

**BIOGRAPHICAL NOTES****Bertha Harkey Walker (ca. 1961 – ca. 1967)**

According to her 1967 death certificate, Bertha Harkey Walker was born in 1891 in Halton, Arkansas. She was a widowed school teacher, and was living at 1516 Kinney Avenue at the time of her death at the age of 75.

- Bertha H. Walker		1516 Kinney Ave.
107	1	A
Bartin Heights B		
Frame Residence and Attached Garage		
81549	10-10-61	7400.00
Texas Lumber Co.		5
w 29357		s 36481
RESIDENCE		

Building permit to Bertha H. Walker for the construction of this house (1961)

5-1-126 H-  
PARTIAL 149 to

## WATER SERVICE PERMIT

Austin, Texas

E<sup>MM</sup> No. 29357 107

Received of BERTHA H. WALKER Date 10-11-61

Address 1516 Kinnery Ave

Amount FIFTY 100 \$ 50.00

Plumber PETERSON Size of Tap 3/4"

Date of Connection	<u>10-25-61</u>
Size of Tap Made	<u>3/4"</u>
Size Service Made	<u>3/4"</u>
Size Main Tapped	<u>2" C.I.</u>
From Front Prop. Line to Curb Cock	<u>7'</u>
From North Prop. Line to Curb Cock	<u>17'</u>
Location of Meter	<u>curb</u>
Type of Box	<u>Round</u>
Depth of Main in Street	<u>4'</u>
Depth of Service Line	<u>3'</u>
From Curb Cock to Tap on Main	<u>6'</u>
Checked by Engr. Dept.	<u>J.M.D. 11-6-61</u>

No. Fittings	Size
8	3/4" copper
1	Corp. Cock
	Cop. to Iron ell
	Cop. to Cop. ell
	Cop. to Iron Coupling
	Cop. to Cop. Coupling
1	Angle Stop
	Stop
	Bushing
1	Nipples 9" x 3/4" Brass
1	Service Clamp 2" x 3/4"
	Valve
1	Meter Box Round
1	Lock Lid
1	Drain Tile
1	Drain Tile Lid
	Stop & Drain
	Job No. W-323-502
	Foreman A. Schlab

Water service permit to Bertha H. Walker for this address (1961)

488772  
Matthew

## SANITARY SEWER SERVICE PERMIT

Austin, Texas

No. 36481 ✓

Received of BERTHA H. WALKER Date 10-11-61

Address 1516 Kinnery Ave

Amount FIFTY 100 \$ 50.00

Builder or Owner B. Peterson Plumber PETERSON

Lot 1 Block A Subdivision Bertha H. Walker Plat No. 107

Date of Connection	<u>10-30-61</u>
By City	<u>53 1/2' S of N &amp; L</u>
By Plumber	
Checked By	<u>H. Peterson</u>
Size Main	<u>6"</u> Depth <u>6' Rock</u>
Main Assgn.	<u>11.5' E of W of Kinnery Ave</u>
Stub Depth	<u>8'</u> Prop. Line <u>2 1/2'</u>
Stub Location	<u>to be any and from house</u>
Book No.	<u>B-1986</u>
Paying Cut	No. <u>2</u>
	<u>10-23-61</u>

No. Fittings	Size	Price
1	1.5" Pipe	3.75
	6" Con	
2	Bends	1.98
	6" Con	
	Reducers	
	Plugs	
	Sand	
	Gravel	
	Remix	
	Stoppers	
1	Other TAP 6" Con	.99
	Castings	
	Labor: 2.0 - 25.00	
	Subcontract 1 - 40	1.50
	Ordinance - 42.5	1.90
	Total	35.52

Sewer service permit to Bertha H. Walker for this address (1961)