



C1/4



-  SUBJECT TRACT
-  PENDING CASE
-  ZONING BOUNDARY

PLANNED UNIT DEVELOPMENT
ZONING CASE#: C814-2014-0120

Exhibit A



1" = 400'

This product is for informational purposes and may not have been prepared for or be suitable for legal, engineering, or surveying purposes. It does not represent an on-the-ground survey and represents only the approximate relative location of property boundaries.

This product has been produced by CTM for the sole purpose of geographic reference. No warranty is made by the City of Austin regarding specific accuracy or completeness.

C1/5

Exhibit B

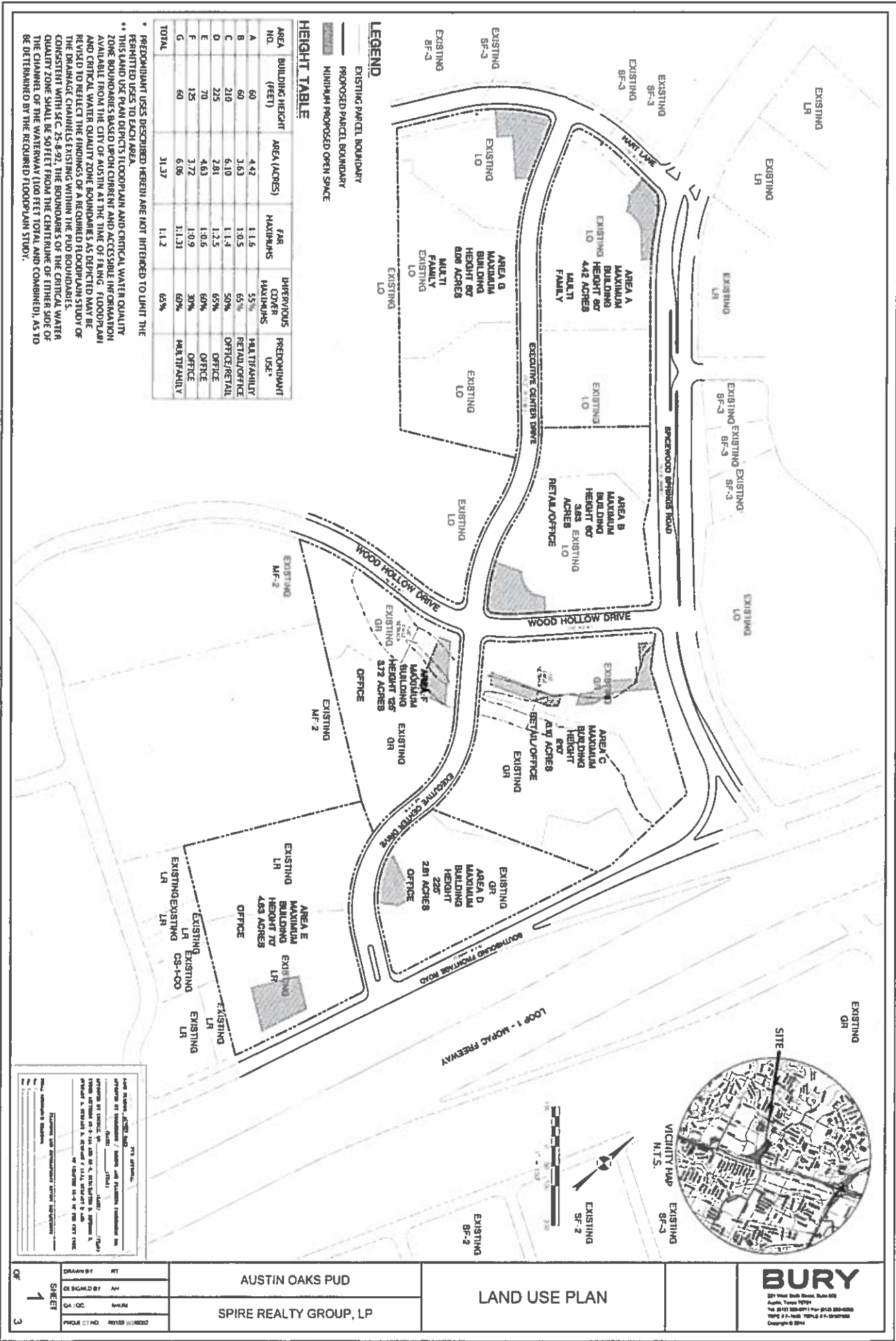

DATE: 08/14/2013
 TIME: 10:00 AM
 DRAWN BY: [Name]
 CHECKED BY: [Name]
 PROJECT: [Name]
 SHEET: 1 OF 3

AUSTIN OAKS PUD
 SPIRE REALTY GROUP, LP

LAND USE PLAN

BURY
 221 West Sixth Street, Suite 600
 Austin, Texas 78701
 Tel: 512.476.1111
 Fax: 512.476.1112
 www.bury.com