

**HISTORIC LANDMARK COMMISSION
FEBRUARY 23, 2015
DEMOLITION AND RELOCATION PERMITS
HDP-2015-0060
5400 SHOALWOOD AVENUE**

PROPOSAL

Demolish a ca. 1948 house.

ARCHITECTURE

One-story, irregular-plan, side-gabled, frame house with a projecting front-gabled bay containing a paired set of 6:6 windows and a partial-width inset porch; other fenestration in the house consists of paired 6:6 and single 1:1 windows; front-gabled garage attached to the house via a breezeway.

RESEARCH

The house was built in 1948 by Douglas and Sadie Lou Ware. Douglas Ware was a building contractor, and built this house; his wife Sadie is listed as the owner of the property on the 1948 building permit. He was born in Stockdale, Texas, and was the son of a justice of the peace. They lived here until they divorced in 1976. The house was then owned and occupied by Neal Evans, II, a professor of astronomy at the University of Texas, who has specialized his research on the origins of stars and planets. He has taught at UT since 1975.

STAFF COMMENTS

The house is beyond the bounds of any City survey.

STAFF RECOMMENDATION

Encourage rehabilitation and re-use if feasible; otherwise, release the permit upon completion of a City of Austin Documentation Package, consisting of photographs of all elevations, a dimensioned sketch plan, and a narrative history, for archiving at the Austin History Center.

LOCATION MAP

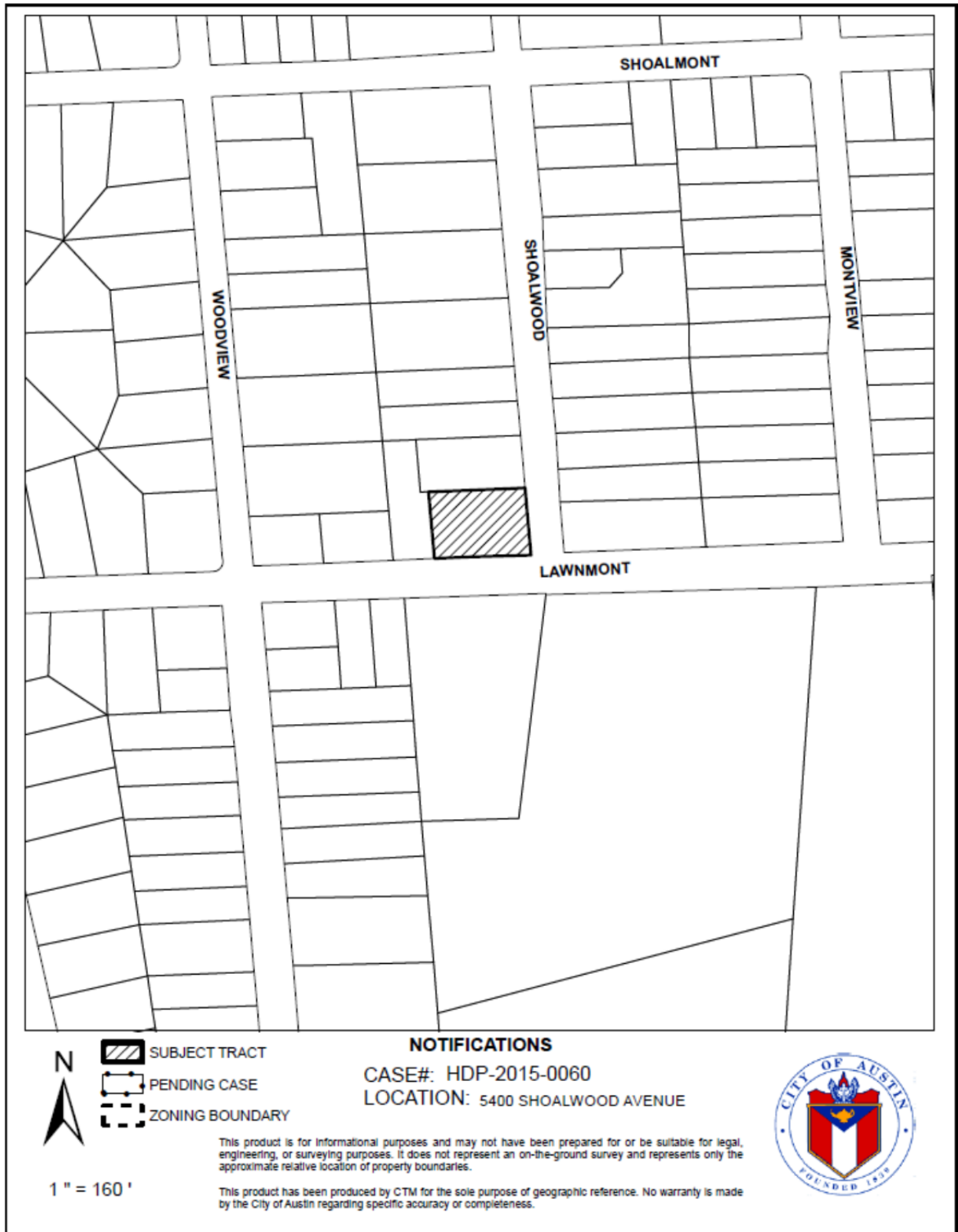

5400 Shoalwood Avenue
ca. 1948



OCCUPANCY HISTORY
5400 Shoalwood Avenue

City Directory Research, Austin History Center
By City Historic Preservation Office
February, 2015

1992	Neal J. Evans, II, owner Professor, University of Texas
1985-86	Neal J. Evans, II, owner Associate professor, University of Texas
1981	Neal J. Evans, II, owner Associate professor, University of Texas
1977	Doug B. Ware, owner Proprietor, D.B. Ware Construction Company (not separately listed)
1973	Doug B. and Sadie Lou Ware, owners Proprietor, D.B. Ware Construction Company (not separately listed)
1968	Andrey W. and Nelle DuBose, owners Proprietor, Jimmie Connally Company (not listed in the directory)
1962	Douglas B. and Sadie L. Ware, owners Contractor (office at the house)

- 1959 Douglas B. and Sadie L. Ware, owners
Building contractor, 1605½ Trinity Street.
- 1955 Douglas B. and Sadie L. Ware, owners
Building contractor, 1605½ Trinity Street.
- 1952 Douglas B. and Sadie L. Ware, owners
Construction superintendent
- 1949 Douglas B. and Sadie L. Ware, owners
Construction foreman
- 1947 The address is not listed in the directory.
NOTE: Douglas B. and Sadie Ware are listed at 5307 Martin Avenue; he was a carpenter.

BIOGRAPHICAL NOTES

Douglas B. and Sadie Lou Ware (ca. 1948 – ca. 1977)

Douglas B. and Sadie Lou Ware appear in the 1940 U.S. Census for Vineville, Bibb County, Georgia. Douglas B. Ware was 32, had been born in Texas, and was a construction contractor. Sadie Lou Ware was 30, had been born in Texas, and had no occupation listed. They had 3 children: Maurice, 8; Thomas, 6; and Janice, an infant. All of the children except Janice had been born in Texas; Janice had been born in Georgia. The family had lived in Stockdale, Wilson County, Texas, in 1935.

The 1930 U.S. Census shows Douglas B. Ware as the 22-year old son of B.J. and Lela E. Ware of Stockdale, Texas. Douglas was single, and the manager of a hatchery. His father was a justice of the peace. Douglas was the oldest of the Wares' 3 sons listed in the census report, and the only one of the sons with an occupation listed.

Douglas B. and Sadie Lou Ware were married in 1930 and divorced in 1976. He then married Myra Grantland in Bastrop County in 1977. He died in Bastrop County in 1981; his death certificate shows that he was born in 1907 in Texas, was married to Myra Grantland, and was a general contractor. He was living at Lake Bastrop at the time of his death.

WARE, Douglas Bartlette, 73, of Bastrop, died Thursday. Services 1:30 p.m. Sunday at Cook-Walden Funeral Home. Burial, Austin Memorial Park. Survivors: wife, Myra Ware of Lake Bastrop Estates; son, Melvin Ware of Austin; daughter, Janice Ware of Austin; brother, Thomas Ware of Waco.

Obituary of Douglas Ware
Austin American-Statesman, August 1, 1981

Neil J. Evans, II (ca. 1977 -)

Neil J. Evans is a professor of astronomy at the University of Texas.

Neal J. Evans, II has been a pioneer in the study of how stars form within this Galaxy and others. To recognize his outstanding and distinguished career, Prof. Evans' colleagues and former students will meet on the campus of The University of Texas at Austin, April 25-26, 2013, at ACES [[map](#)], to discuss the numerous advances he has made, placing them in context with our current understanding of star formation in the Universe.

Dr. Neal J. Evans, II

Prof. Neal J. Evans, II has focused his research on the origins of stars and planets. He earned his bachelor's degree and doctorate in physics at the University of California, Berkeley and did a year and a half of post-doctoral work at Caltech. Although initially interested in high-energy and particle physics, he later became interested in astrophysics and worked with a research group started at Berkeley by Nobel laureate Charles Townes. Evans joined The University of Texas faculty in 1975, and teaches several astronomy courses there, including a class about the search for extraterrestrial life. One of his overarching goals in teaching is to share his interest in how things have come to be. For Evans, the journey is more important than the destination. Evans has worked with an international team of scientists that is using data from NASA's Spitzer Space Telescope to study the formation of low-mass stars and their accompanying planets. He also leads a team executing a large key project on the ESA Herschel Space Observatory and he is working with a team to map the plane of our Galaxy in the emission from dust at 1 mm. He is presently the Edward Randall, Jr. M.D. Centennial Professor in Astronomy for the Department of Astronomy at UT Austin.

Mrs. Sadie Ware

5400 Shoalwood Ave.

1 and So. 25' of 2

6

Shoalmont

Frame residence with garage attached.

38282 7-13-48

\$7500.00

D. B. Ware

5

Building permit to Mrs. Sadie Ware for the construction of this house (1948). Douglas B. Ware is noted as the contractor.

WATER SERVICE PERMIT

Austin, Texas

C N° 574Received of **D. B. WARE**Date **4-16-48**Address **5400 SHOALWOOD**Amount **TWENTY & NO/100****\$20.00**Plumber **PORTER PLBG. CO.**Size of Tap **3/4"**Date of Connection **4-23-48**Size of Tap Made **3/4" COP**Size Service Made **3/4" COP**Size Main Tapped **6" G.I.**From Front Prop. Line to Curb Cock **7.5'**From **CS** Prop. Line to Curb Cock **3.6'**Location of Meter **CURB**Type of Box **WOOD**Depth of Main in St. **30"**Depth of Service Line **2'**From Curb Cock to Tap on Main **1.5' main**Checked by Engr. Dept. **5/20/49-RB**

No. Fittings Size

1 Curb Cock 3/4" COP

1 Elbow 3/4" COP

1 St. Elbow 3/4" COP

1 Bushing 3/4" COP

1 Reducer 2" X 3/4" TAP

4 Pipe 2" X 3/4" COP

1 Lead Comp.

1 Nipples

1 Union

1 Plug

1 Tee

1 Stop

1 Box

1 Lid

1 Valves

Job No. **623-502**

Req. No.

CHANGED TO "MAIN AND RENEWED SERVICE WITH CONNECTION 700-867"

INDEXED

Water service permit to Douglas B. Ware for this house (1948)

Receipt No. 10185

Application for Sewer Connection

No. 24700Austin, Texas, July 14 19 48

To the Superintendent of Sanitary Sewer Division, City of Austin, Texas.

Sir:—

I hereby make application for sewer connection and instructions on premises owned by

D. B. Ware

at

5400 Shoalwood

Street,

further described as Lot 1 & 25' of 2 Block 6 Outlot Division
subdivision Shoalmont Replat Plat 195, which is to be used as aIn this place there are to be installed 5 fixtures. Plumbing Permit No. 30187

I agree to pay the City of Austin, the regular ordinance charge.

Depth at Prop. Line 3'- 4' at curb Respectfully,~~State Out~~ Connected 100' W of ELL or 100' E of WLL (Location)Date 7-19-48By B. Hernandez

NOTE: Connection Instruction

main 13.5' S of 1' E, 6" stub 100' E of WLL B-1756

Sewer connection application by Douglas B. Ware for this house (1948)

OWNER D. B. WareADDRESS 5400 Shoalwood Ave.PLAT 105 LOT 1 and S 25 ' of 26

BLK

SUBDIVISION ShoalmontOCCUPANCY denBLD PERMIT # 113767 DATE 7-22-69 OWNERS ESTIMATE 1200.00CONTRACTOR owner NO. OF FIXTURES noneWATER TAP REC # ==== SEWER TAP REC # -----

Frame addn to rear of res

240 sq ft

Building permit to Douglas B. Ware for the construction of a rear frame addition (1969)