

# JUNETEENTH MONUMENT

## APRIL 1, 2015



George  
Washington  
Carver  
Museum  
& Cultural  
Center

# PURPOSE

- **Project Briefing Update**
- **Background**
- **Project Timeline**
- **Project Design**
- **Project Budget**



# BACKGROUND

- The Juneteenth Memorial Monument (JMM) is composed of five large bronze figures of 19<sup>th</sup> Century Texans.
- The JMM was commissioned and paid for by the State of Texas through the Texas Legislative Black Caucus (TLBC).
- TLBC recognized the George Washington Carver Museum (Carver) as the ideal location for these monuments.
- The Carver is renown as “*a key source of information on the history and celebration of Juneteenth*”.
- The Carver and the Texas Facilities Commission (TFC) accepted joint custodianship of the JMM after a discussion with State Rep. Dawnna Dukes in 2012.



# BACKGROUND

- City Council authorized the negotiation and execution of an inter-local agreement with the Texas Facilities Commission (TFC) on August 22, 2013 to accept custodial possession of the JMM for a term of 99 years, executed 9/20/2013.
- The City will pay for the siting and installation of the JMM and will also provide a plaque recognizing the State of Texas.
- The City is responsible for the maintenance of the JMM bronze sculptures.



# PROJECT TIMELINE

- Jan 2014: PARD selects “The Lawrence Group” from rotation list
- Feb 2014: Contracting of architect
- May 2014: Conceptual design work
- June 2014: Design finalized
- July-September 2014: Permitting process
- October-December 2014: Request for Proposal, Proposal Review and Revision
- January 20, 2015: Proposal Acceptance, Notice to Proceed
- January 26, 2015: Construction initiated
- May 2015: Sculpture installation
- June 2015: Proposed completion of project and opening celebration

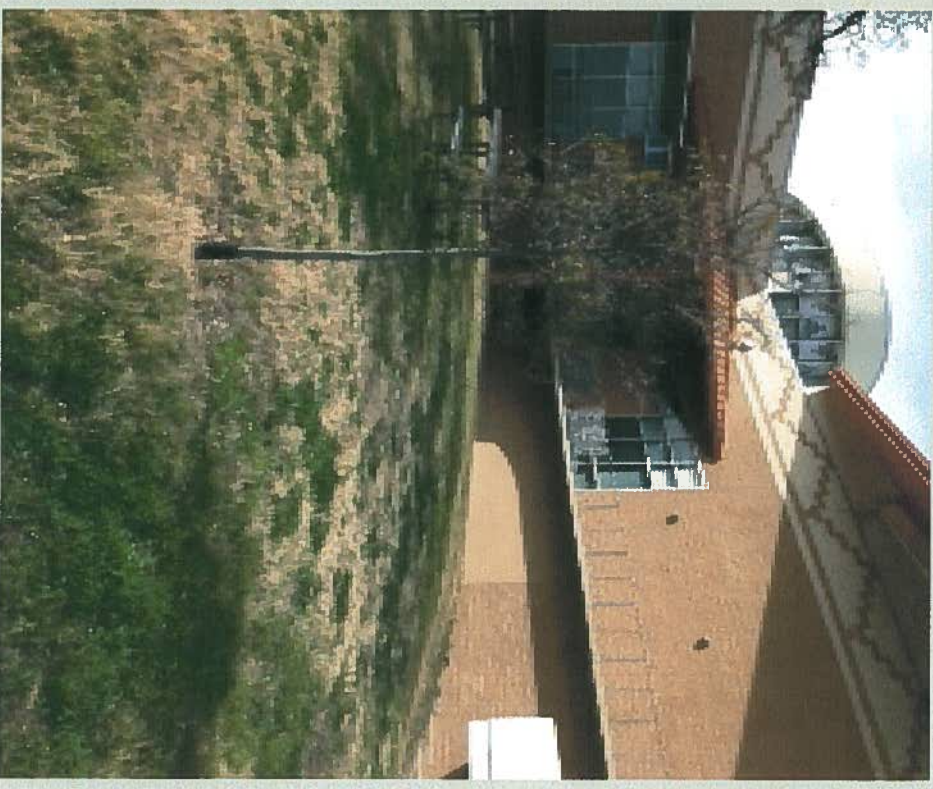



# PROJECT DESIGN & PREPARATION

- The Lawrence Group architectural firm selected to design the setting of the JMM at the Carver location.
- The monument will feature a park-like setting with seating, interpretive panels, landscaping and ADA accessibility.
- Heart of Texas Art Foundry, originally cast the work and participated in the planning process with the artists in 2000, was selected with a sole source requisition to apply final patina to the sculpture and place them on individual mounts.





# JUNETEENTH MEMORIAL PROJECT DESIGN-PLAN

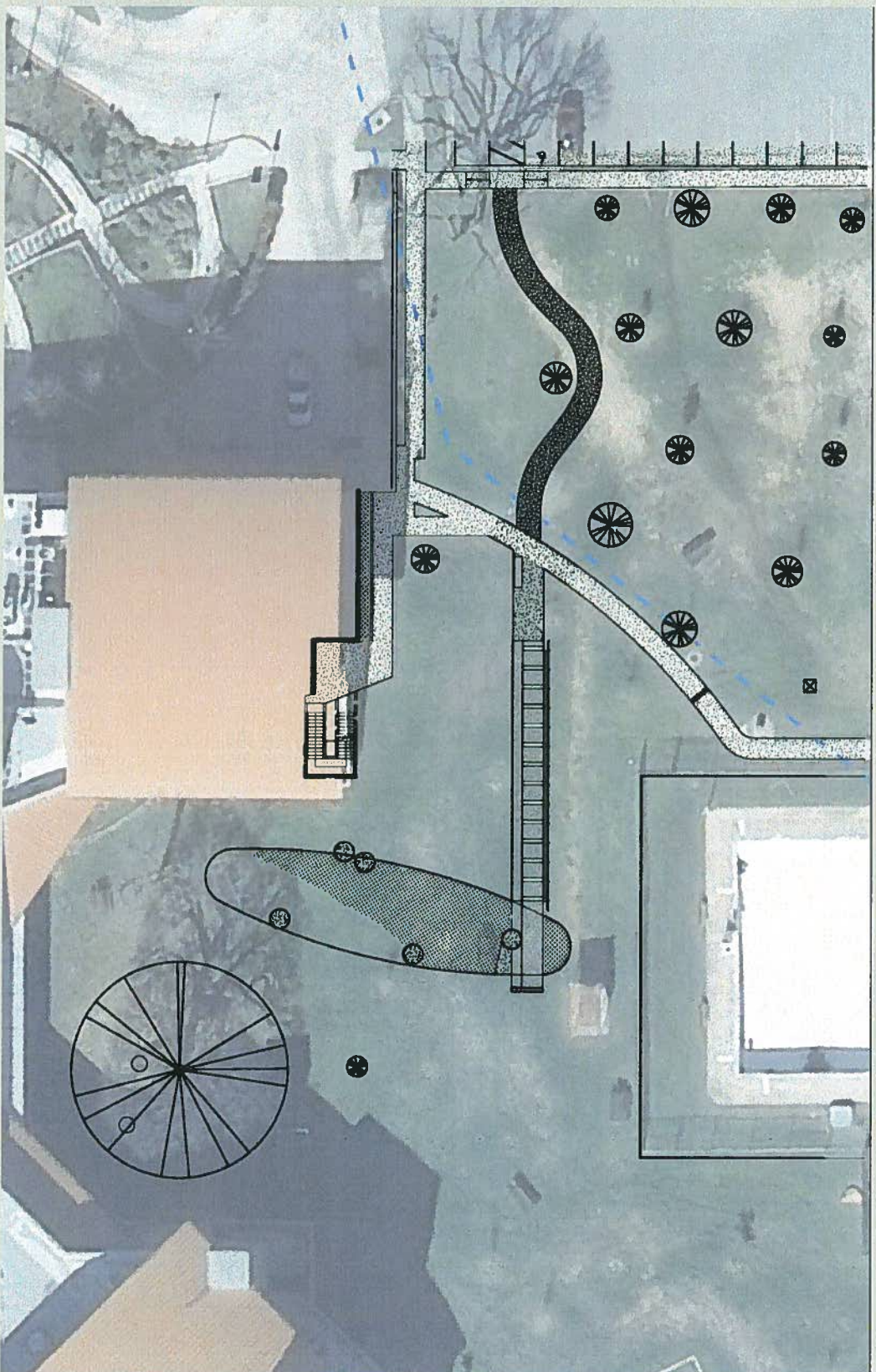



# JUNETEENTH MEMORIAL PROJECT DESIGN-EAST VIEW





# JUNETEENTH MEMORIAL PROJECT DESIGN-DETAIL

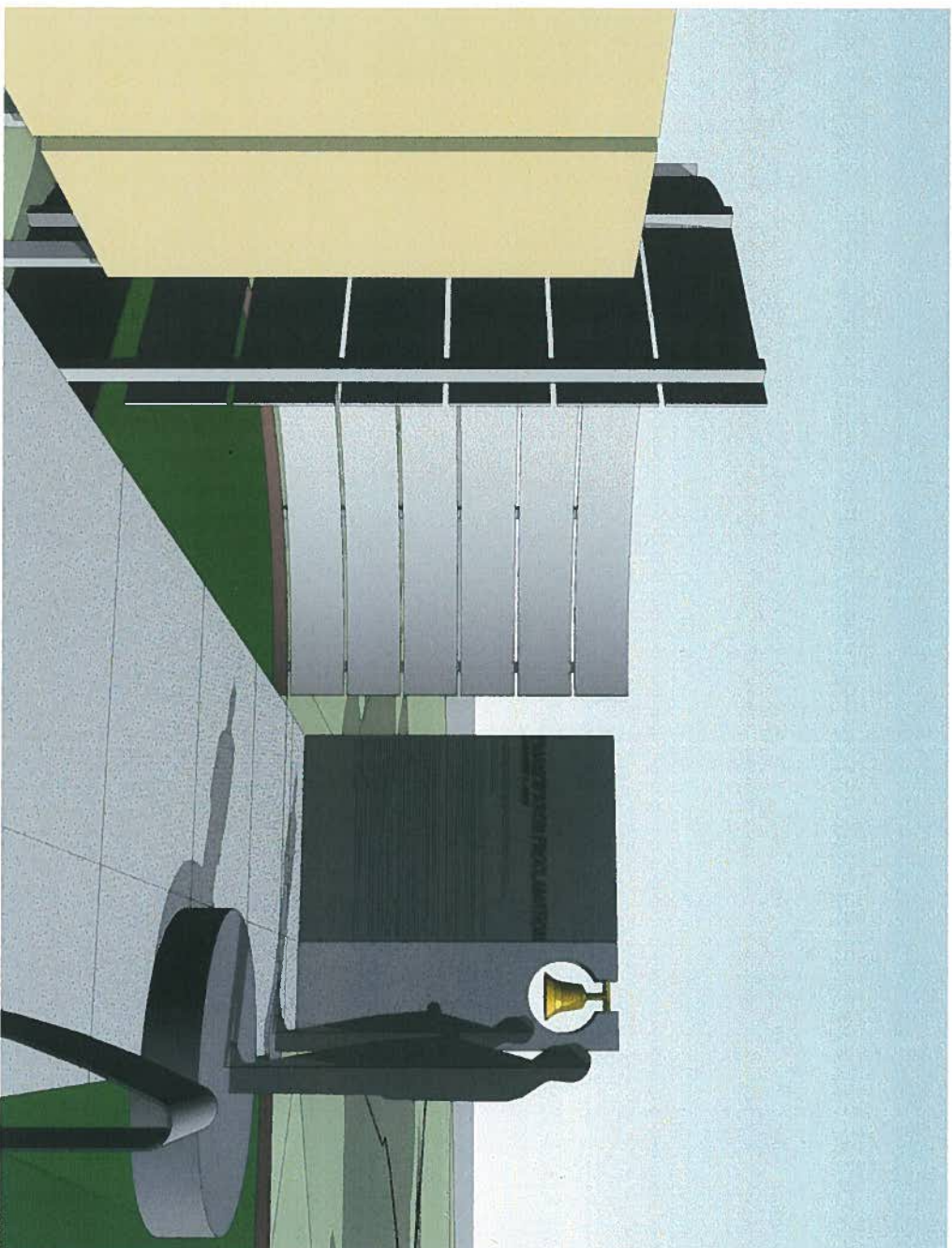



# BUDGET

- Total budget for this project is \$236,000 for design, permitting, construction and landscaping.
- The budget source is Parkland Dedication Funds
- The JMM is insured by the City of Austin
- The contract's only plaque requirement is to recognize the Texas Legislative Black Caucus





# FOR MORE INFORMATION

- **Bernadette Phifer**

Curator & Program Manager

George Washington Carver Museum

512.974-4926

- **D'Anne Williams**

Project Manager

Planning and Design Division

512.974-9456

- **Laura Esparza**

Division Manager

History, Arts and Nature Division

512.974-4001

